

# ADJUSTING THE BRAKE MASTER CYLINDER

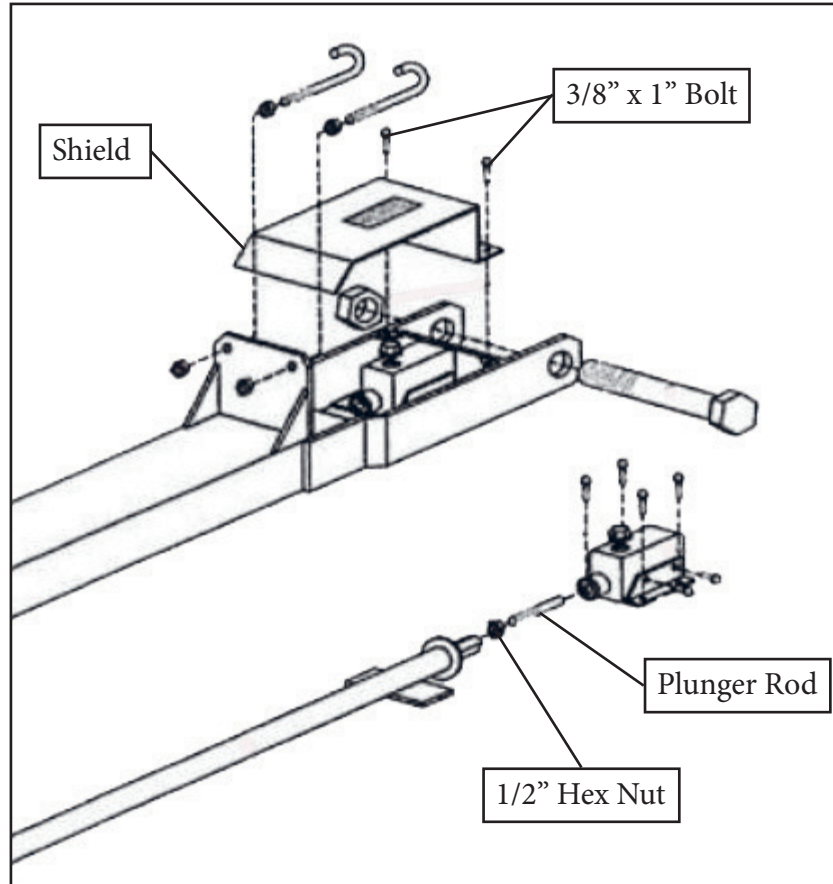

- 1) Remove the shield. Use a 9/16" wrench to remove the (2) 3/8" x 1" serrated hex head bolts from shield.
- 2) Loosen the 1/2" nut on the plunger pin. Use a 3/4" wrench to loosen the 1/2" hex nut.
- 3) Turn the plunger rod to adjust.

- For *more* aggressive braking action turn the plunger rod counterclockwise. (this will lengthen the assembly.

- For *less* aggressive braking action turn the plunger rod clockwise. (this will shorten the assembly)

**DO NOT ADJUST ALL THE "PLAY" OUT OF THE PLUNGER SYSTEM. THIS WILL CAUSE THE BRAKES TO BE ACTIVATED AT ALL TIMES AND OVER HEAT THE DRUMS CAUSING FAILURE.**

*(This braking system is to assist the pull vehicle in the braking mode, not to take the place of it.)*

The braking plunger system should have approximately a 1/4" of "play" when adjusted for level road travel.

- 4) Tighten the 1/2" hex nut to keep plunger rod in place.

- 5) Put the shield back on and tighten both 3/8" x 1" serrated hex head bolts.



J&M MANUFACTURING  
Phone: (419) 375 2376 Fax: (419) 375-2708  
E-mail: sales@jm-inc.com Website: www.jm-inc.com

