

Spring Return Assembly

Grain Cart

Opposite
Auger End

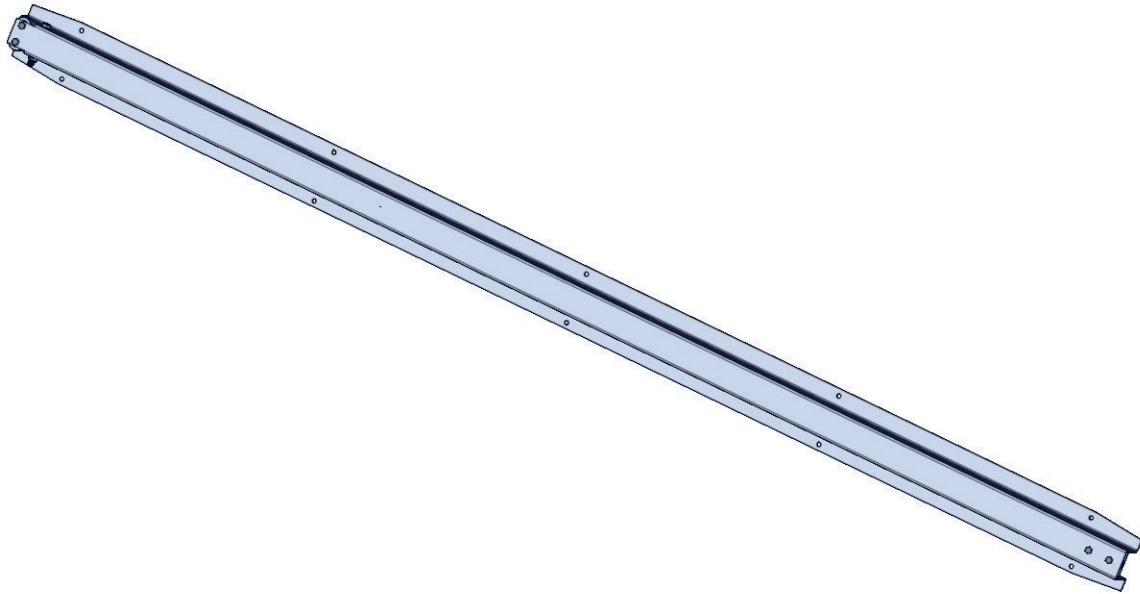

Auger End



J. & M. Mfg. Co., Inc.

P.O. Box 547 Ft. Recovery, OH 45846

Ph: (419) 375-2376 Fax: (419) 375-2708

www.jm-inc.com

Spring Return Assembly Parts List

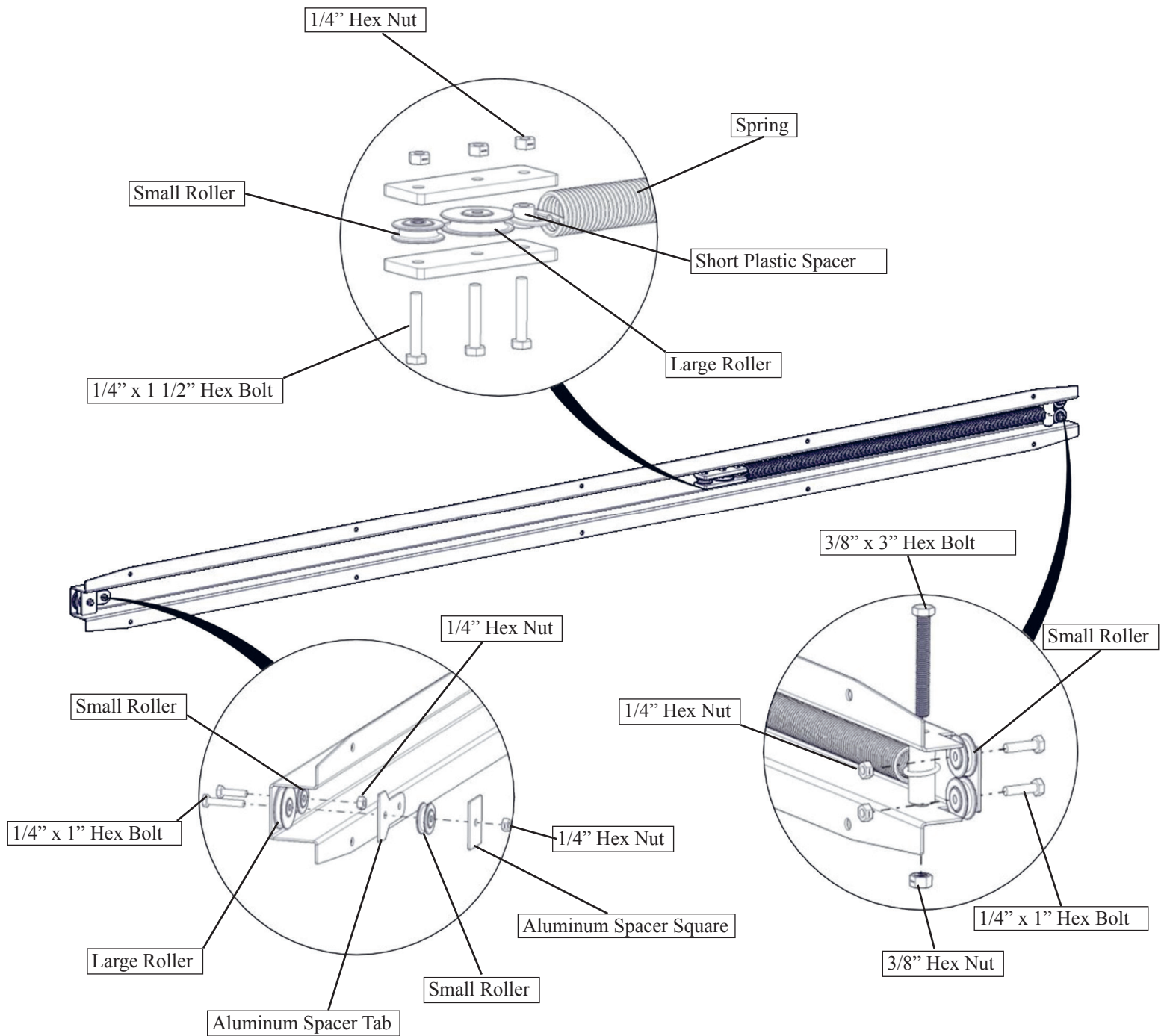

Cable Routing



#	Part. No.	Description
1	JM0000197	1/4" x 1" Hex Bolt
2	JM0000198	1/4" x 1 1/2" Hex Bolt
3	JM0000199	Roller Large
4	JM0000200	Roller Small
5	JM0000201	Aluminum Spacer Tab
6	JM0000202	Aluminum Spacer Square
7	JM0000203	1/4" Lock Nut
8	JM0000198	1/4" x 1 1/2" Hex Bolt
9	JM0000205	Rectangular Plastic Spacer
10	JM0000206	Short Plastic Spacer
11	JM0000207	Spring Return Spring
12	JM0000208	3/8" x 3" Hex Bolt
13	JM0000209	Tall Plastic Spacer
14	JM0000210	3/8" Lock Nut
15	JM0000211	Spring Return Housing

Step 1

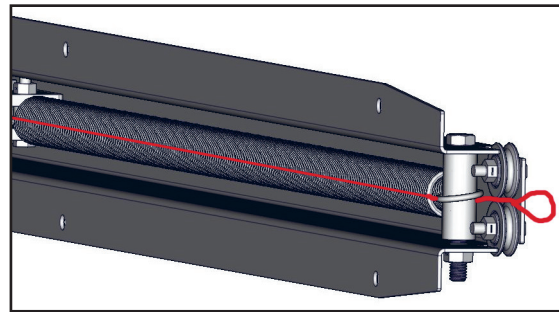

Step 2 through 8

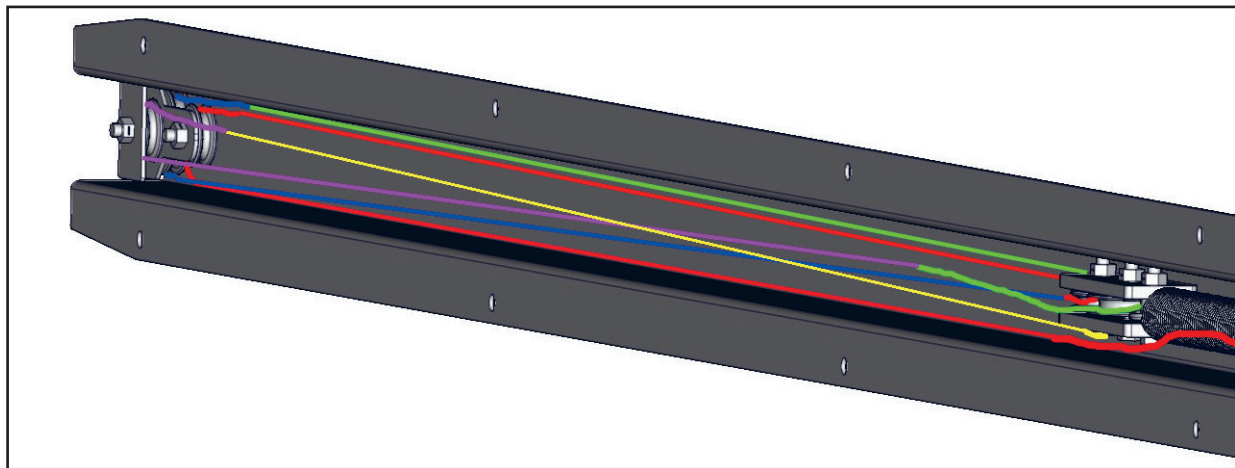

1. Go through opposite auger side pulleys (Red)
2. Go through the spring (Red)
3. Go around the small inner pulley on the auger end. (Red)
4. Go around the small pulley in the center of the spring return (Red)
5. Go around the large pulley on the auger end. (Blue)
6. Go around the large pulley in the center of the spring return. (Green)
7. Go around the small pulley on the auger side. (Pulley sits on top of the large pulley) (Purple)
8. Attach to the rectangular plastic spacer located in the middle of the spring return. (Yellow)