



Grain Cart

Lower Auger Liner

INSTALLATION MANUAL

Xtended Reach

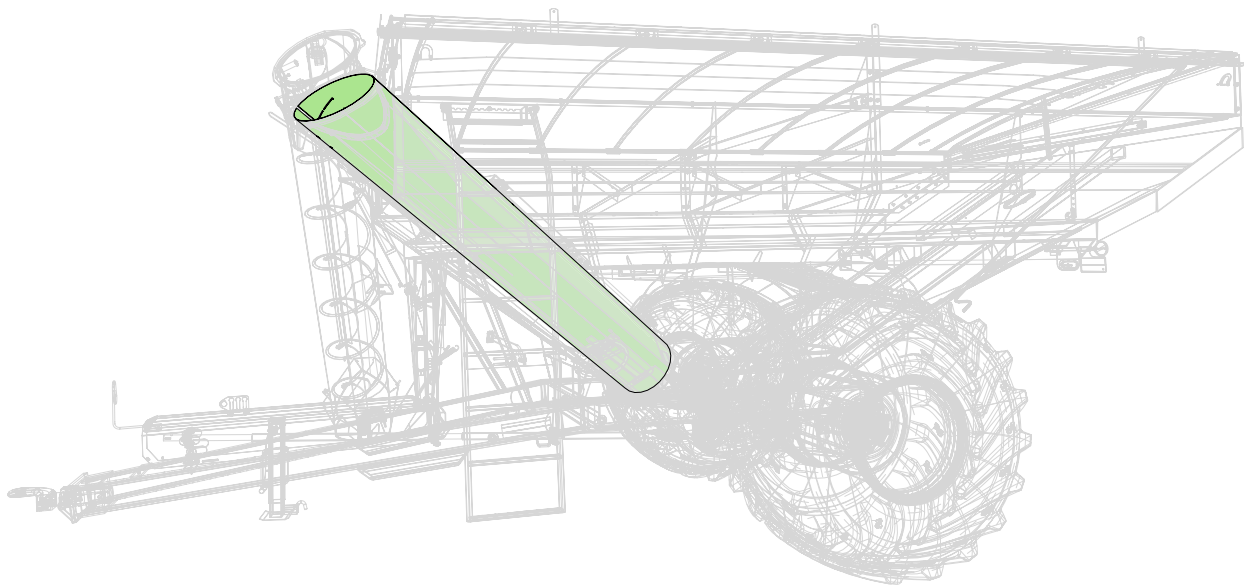

Rev. 8.25.2021

J&M Manufacturing Co, Inc

284 Railroad Street - P.O. Box 547 | Fort Recovery, OH 45846 | Ph: (419) 375-2376 | Fax: (419) 375-2708

www.jm-inc.com

Installing Lower Auger Liner

Unbolt the Hanger Bushing Assembly. Use a 3/4" socket to remove the 1/2" x 1-1/4" hex head bolts. Keep the 1/2" bolts and washers, they will be used in a later step.

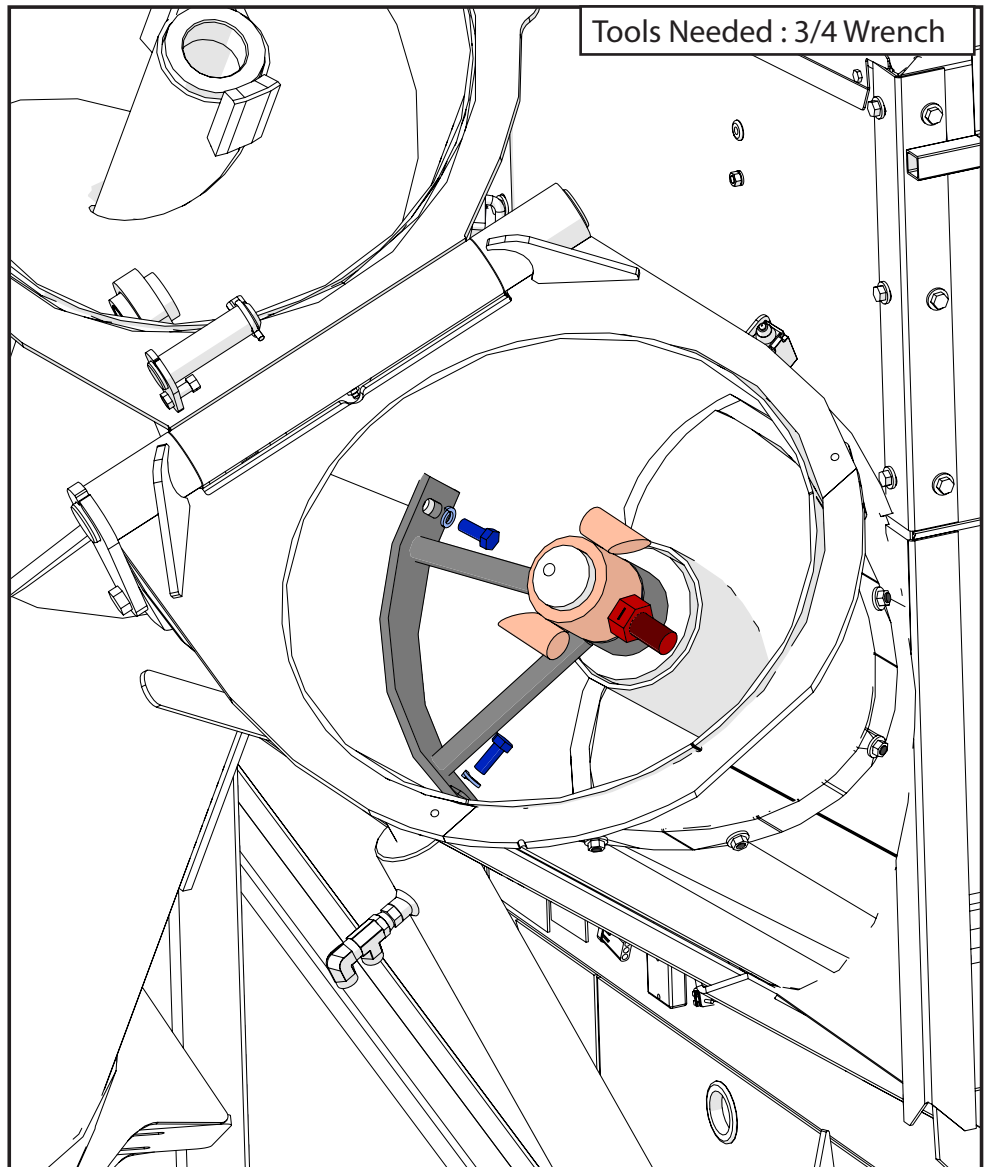

Installing Lower Auger Liner

Remove the lower auger. Place one end of a 4x4 post under the threaded end of the drive dog bolt and pry against the outer diameter of the auger tubing to lift the auger off the gearbox shaft. Once lifted above the lower auger housing, attach a chain to the lower auger and a forklift. Slowly raise the lower auger out of the tube. If your forklift will not raise high enough, only go half way up, and regrip. Set the lower auger on the ground out of the way.

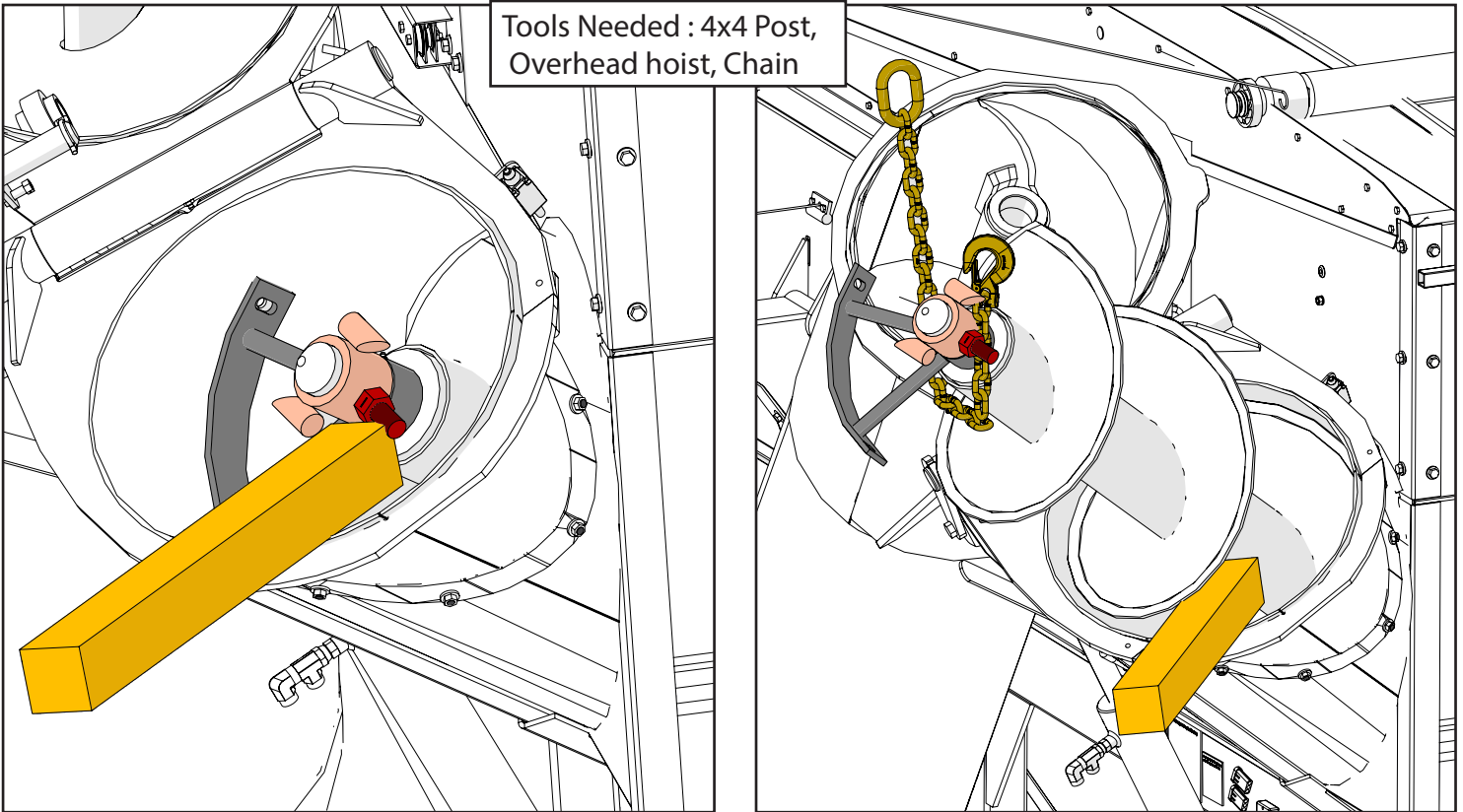

Installing Lower Auger Liner

IF NECESSARY Remove the 4 pan head bolts and 3/8" flange nuts shown in the image to the right.

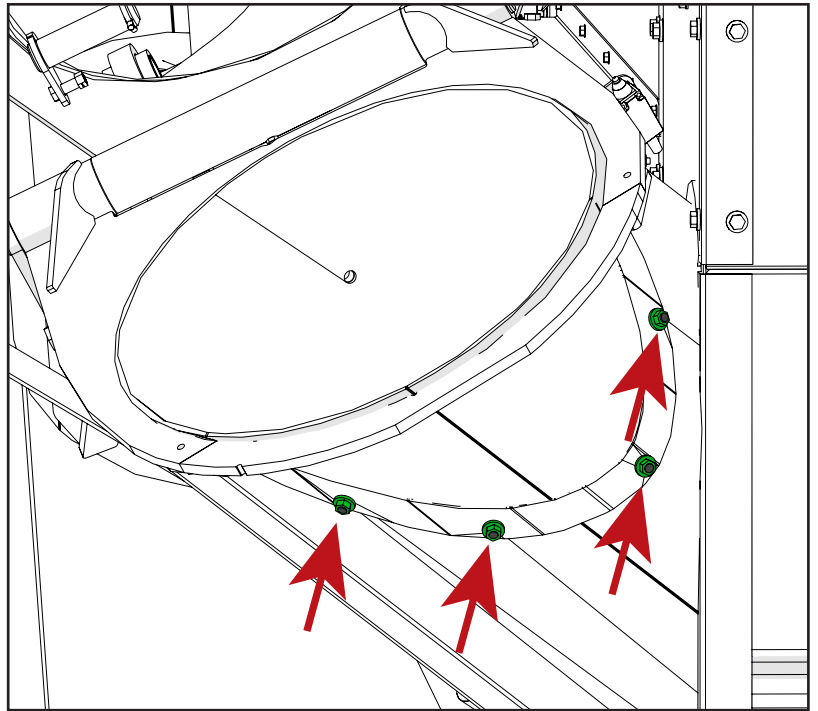

Place the replacement liner inside of the tube. Align the top of the liner and make sure that the hole for the hanger bushing assembly is lined up with where it will need to be bolted back in place (shown by the blue arrows).

Pop the two welds of the long seam to fit it into place. There will be one weld towards the top and one towards the bottom of the liner.

Drill holes through the tube where pan head bolts were taken out previously. Reinsert the bolts and tighten them down.

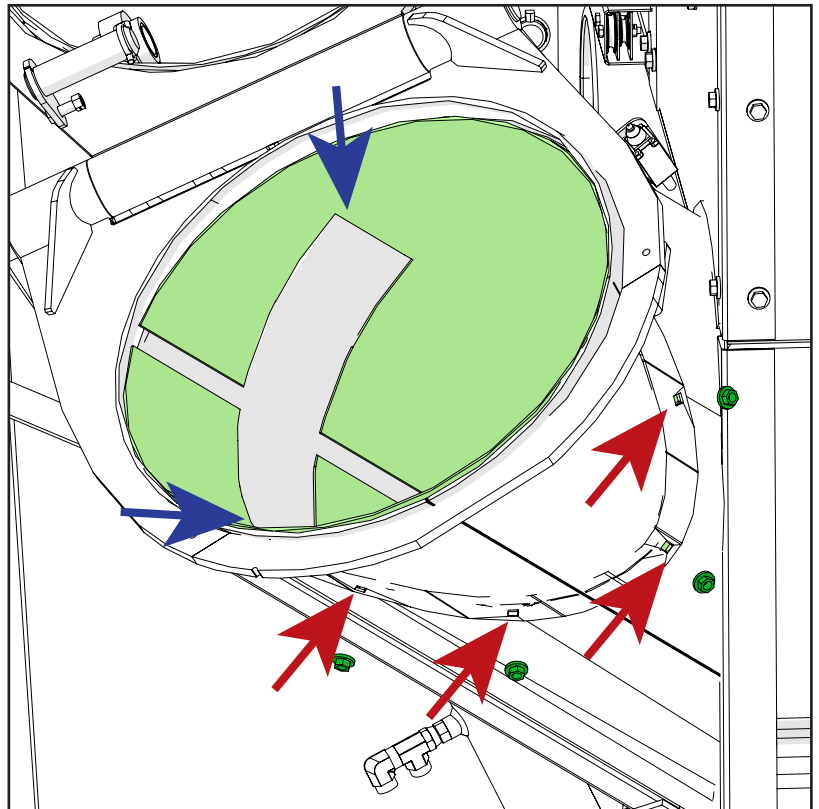

Installing Lower Auger Liner

Open the cleanout door. Weld top and bottom ends of the liner. Welds should be placed every 6-8 inches with a 1/2" weld. When welding make sure the liner is sitting flush against the original tube. **If needed, put pressure on the liner and tack in place before welding.**

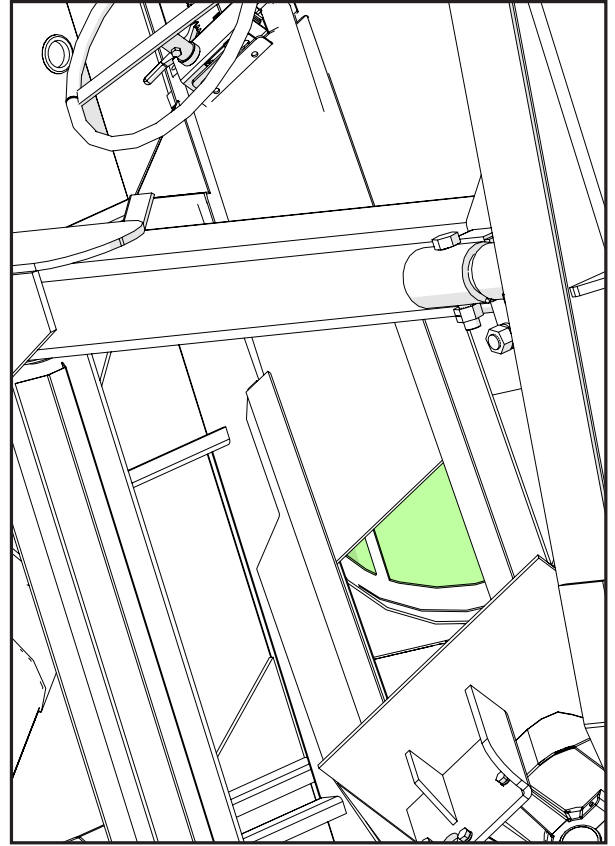

Reinsert the lower auger, if necessary, put never sieze product on the gearbox shaft before lowering back onto it. Re-bolt the Hanger Bushing Assembly to the existing tube. Use a 3/4" wrench to tighten the 1/2" x 1-1/4" bolts and 1/2" washer.

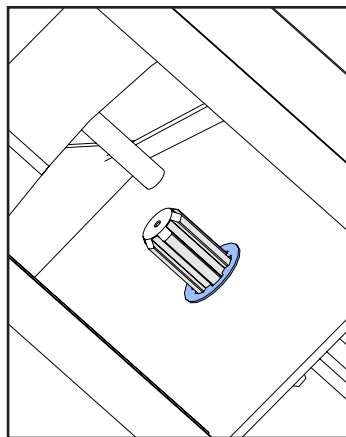

Gearbox splined washer
812 = JM0000083
1012 - 1522 = JM0020638
1132 - 2332 = JM0020638

