



## REPAIR PARTS LIST

For Gravity Boxes, Running Gears, Header Transports, Augers,  
Elevators, Combine Grain Tank Extensions and Attachments

March 25, 2011

PLEASE GIVE TO PARTS DEPARTMENT



**J. & M. Mfg. Co. Inc.**

284 Railroad St. - P.O. Box 547

Ft. Recovery, OH 45846

Ph: (419) 375-2376 Fax: (419) 375-2708

[www.jm-inc.com](http://www.jm-inc.com)

3/8/2011

**EXPRESS WARRANTY:**

J. & M. Mfg. Co. Inc. warrants against defects in construction or materials for a period of ONE year. We reserve the right to inspect and decide whether material or construction was faulty or whether abuse or accident voids our guarantee.

Warranty service must be performed by a dealer or service center authorized by J. & M. Mfg. Co. Inc. to sell and/or service the type of product involved, which will use only new or remanufactured parts or components furnished by J. & M. Mfg. Co. Inc. Warranty service will be performed without charge to the purchaser for parts or labor based on the Warranty Labor Times schedule. Under no circumstance will allowable labor times extend beyond the maximum hours indicated in the Warranty Labor Times schedule for each warranty procedure. The purchaser will be responsible, however, for any service call and/or transportation of the product to and from the dealer or service center's place of business, for any premium charged for overtime labor requested by the purchaser, and for any service and/or maintenance not directly related to any defect covered under the warranty. Costs associated with equipment rental, product down time, or product disposal are not warrantable and will not be accepted under any circumstance.

Each warranty term begins on the date of product delivery to the purchaser. Under no circumstance will warranty be approved unless the product warranty registration card (attached to the inside of the Operator's Manual) has been properly completed and submitted to the equipment manufacturer. This Warranty is effective only if the warranty registration card is returned within 30 days of purchase.

This warranty does not cover a component which fails, malfunctions or is damaged as a result of (i) improper modification or repair, (ii) accident, abuse or improper use, (iii) improper or insufficient maintenance, or (iv) normal wear or tear. This warranty does not cover products that are previously owned and extends solely to the original purchaser of the product. Should the original purchaser sell or otherwise transfer this product to a third party, this Warranty does not transfer to the third party purchaser in any way. J. & M. Mfg. Co. Inc. makes no warranty, express or implied, with respect to tires or other parts or accessories not manufactured by J. & M. Mfg. Co. Inc. Warranties for these items, if any, are provided separately by their respective manufacturers.

THIS WARRANTY IS EXPRESSLY IN LIEU OF ALL OTHER WARRANTIES OR CONDITIONS, EXPRESS, IMPLIED OR STATUTORY, INCLUDING ANY IMPLIED WARRANTY OF MERCHANTABILITY OR FITNESS FOR PARTICULAR PURPOSE.

In no event shall J. & M. Mfg. Co. Inc. be liable for special, direct, incidental or consequential damages of any kind. The exclusive remedy under this Warranty shall be repair or replacement of the defective component at J. & M. Mfg. Co. Inc.'s option. This is the entire agreement between J. & M. Mfg. Co. Inc. and the Owner about warranty and no J. & M. Mfg. Co. Inc. employee or dealer is authorized to make any additional warranty on behalf of J. & M. Mfg. Co. Inc.

The manufacturer reserves the right to make product design and material changes at any time without notice. They shall not incur any obligation or liability to incorporate such changes and improvements in products previously sold to any customer, nor shall they be obligated or liable for the replacement of previously sold products with products or parts incorporating such changes.

**SERVICE:**

The equipment you have purchased has been carefully manufactured to provide dependable and satisfactory use. Like all mechanical products, it will require cleaning and upkeep. Lubricate the unit as specified. Observe all safety information in this manual and safety signs on the equipment.

For service, your authorized J. & M. dealer has trained mechanics, genuine J. & M. service parts, and the necessary tools and equipment to handle all your needs.

Use only genuine J. & M. service parts. Substitute parts may void the warranty and may not meet standards required for safe and satisfactory operation.

**PRODUCT CHANGES:**

The manufacturer reserves the right to make product design and material changes at any time without notice. They shall not incur any obligation or liability to incorporate such changes and improvements in products previously sold to any customer, nor shall they be obligated or liable for the replacement of previously sold products with products or parts incorporating such changes.

# TABLE OF CONTENTS

<b>Express Warranty</b>	2
<b>Safety Decals</b>	4 - 5
<b>Miscellaneous Items</b>	5
<b>Gravity Boxes</b>	
250-7S - 165 and 250 Bushel Capacity	6
385-24 - 385 Bushel Capacity	6
385-24-Divider - 385 Bu. Dual Compartment	7
425-22 - 425 Bushel Capacity	7
440SD - 440 Bushel Capacity	8
440SD-Divider - 440 Bu. Dual Compartment	8
540SD - 540 Bushel Capacity	8
540SD-Divider - 540 Bu. Dual Compartment	8
525-24 - 525 Bushel Capacity	9
525-24-Divider - 525 Bu. Dual Compartment	9
525-20, 525-30 or 525-40 Center Dump	10
650SD - 650 Bushel Capacity	10
750SD - 750 Bushel Capacity	10
680SD - 680 Bushel Capacity	11
680SD-Divider - 680 Bu. Dual Compartment	11
760SD - 760 Bushel Capacity	11
760SD-Divider - 760 Bu. Dual Compartment	11
<b>Chute, Door and Wheel Assembly</b>	12
<b>Window Kit</b>	12
<b>Adjustable Chute Assembly</b>	12
<b>Gear Reduction Door Opener</b>	13
<b>Gravity Box Light Kit</b>	13
<b>Roll Tarp</b>	14 - 15
<b>Running Gears</b>	
8 Ton	16 - 17
6 Ton	17
7 Ton	17
10 Ton	18
12 Ton	19
13 Ton and 14 Ton	19 - 20
Hydraulic Disc or Drum Brakes	21 - 23
15 Ton	24
Hydraulic Disc or Drum Brakes	25 - 27
16 Ton	28
Hydraulic Drum Brakes	29
24 Ton	30
Hydraulic Disc or Drum Brakes	31 - 32
24 Ton Short Turn	33
Hydraulic Disc or Drum Brakes	34 - 36
Fender Kit for 16T and 24T Running Gears	36

<b>Header Transports</b>	
HT-874, HT-874L, HT-874XL, HT-874XL-36	37 - 38
HT-974, HT-974XL, HT-974XL-36	38 - 40
HT-8 or HT-8L	41 - 42
HT-1082	42 - 44
Light Kit for HT-874, HT-974, HT-8 & HT-1082	45
HC-30, HC-36 or HC-41 Trail Blazer (Ag)	46 - 47
HS-30B, HS-36B or HS-41B Trail Blazer (Hwy)	48 - 50
HHC-32, HHC-38, HHC-42 or TB-3500A or TB-6000A Trail Blazer (Ag)	51 - 54
HHS-32B, HHS-38B, HHS-42B or TB-3500H or TB-6000H Trail Blazer (Hwy)	55 - 58
<b>Hydraulic Augers</b>	
6" Hydraulic Auger (10'L, 12'L or 14'L-Old Style)	59
6" New Style Uni-Swivel Auger	60 - 61
Electric Solenoid Switch Kit	61
Portable Hydraulic Augermate	61
<b>Combine Grain Tank Extensions</b>	
Case IH	62 - 65
New Holland	66 - 69
John Deere STS	70 - 71
John Deere Walker Series	72 - 74
Tip Up Kit for Deere 60 Series Extensions	75

## Safety Decals

**Attention! Become Alert! Your Safety Is Involved!**  
**Replace Immediately If Damaged or Missing!**

**IMPORTANT:** Install new safety signs if the old signs are destroyed, lost, painted over or cannot be read. When parts are replaced that have safety signs, make sure you install a new sign with each new part. New signs are available from the manufacturer or your authorized dealer.

All Safety Decals - \$1.25 LIST Each



DD-101



DD-102



DD-103



DD-104



DW-105



DW-106



DW-107



DW-108



DC-109



DC-110



DC-111



DC-112



DC-113



**FOR FARM USE ONLY**

DI-115

DI-114 (Medium, 8 1/2" x 5 1/2")  
 DI-114L (Large, 15" x 9 1/2")

**IMPORTANT**  
 WHEN MOUNTING GRAVITY BOX TO WAGON GEAR BE SURE TO POSITION THE OUTER LEG ASSYS. DIRECTLY OVER THE WAGON GEAR AXLES.  
**J & M ALSO RECOMMENDS**  
 10 TON WAGON GEAR FOR 250-7 GRAVITY BOX WITH SIDES,  
 8 TON WAGON GEAR FOR 250-7 GRAVITY BOX LESS SIDES.

DI-116

## Safety Decals

**Attention! Become Alert! Your Safety Is Involved!**  
**Replace Immediately If Damaged or Missing!**

**IMPORTANT:** Install new safety signs if the old signs are destroyed, lost, painted over or cannot be read. When parts are replaced that have safety signs, make sure you install a new sign with each new part. New signs are available from the manufacturer or your authorized dealer.

### All Safety Decals - \$1.25 LIST Each

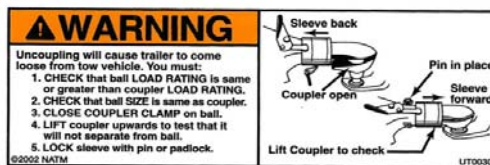

DW-117

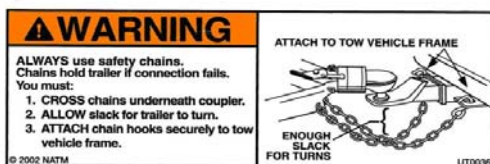

DW-118



DW-119

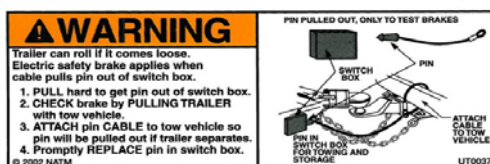

DW-120



DW-121

### COMPLETE DECAL PACKAGES FOR GRAVITY WAGONS

#	Part #	Description
	DKGW-1C	Decal Package for current model Gravity Wagons complete with striping (please specify model). Does not include red, orange or amber reflective decals or SMV Emblem (see Light Kit Parts List)
	DKGW-1	Decal Package for current model Gravity Wagons LESS striping (please specify model). Does not include red, orange or amber reflective decals or SMV Emblem (see Light Kit Parts List)

### PAINT PRODUCTS

Paint products WILL NOT be shipped via third party carrier. Any paint products ordered through J&M will need to be picked up or shipped on a J&M truck when delivering whole good items to your store.

- \* The paint we use is the same formula used for John Deere Green, Case IH Red and New Holland Blue.
- \* Touch up paint can be obtained through your local John Deere, Case or New Holland dealerships.
- \* Off-White, Black and Graphite can be easily matched and obtained from a local paint distributor.

#	Part #	Description	#	Part #	Description
1	RP-1	Red Paint (gallon)	6	GSP-12	Green Spray Can (12 oz)
2	GP-1	Green Paint (gallon)	7	BSP-12	Blue Spray Can (12 oz)
3	GRP-1	Graphite Paint (gallon)	8	BLSP-12	Black Spray Can (12 oz)
4	BP-1	Blue Paint (gallon)	9	OWSP-12	Off-White Spray Paint (12 oz)
5	RSP-12	Red Spray Can (12 oz)			

## Repair Parts List for 250-7S Gravity Box, Sideboards, Braces and Ladder

### GRAVITY BOX PARTS LIST

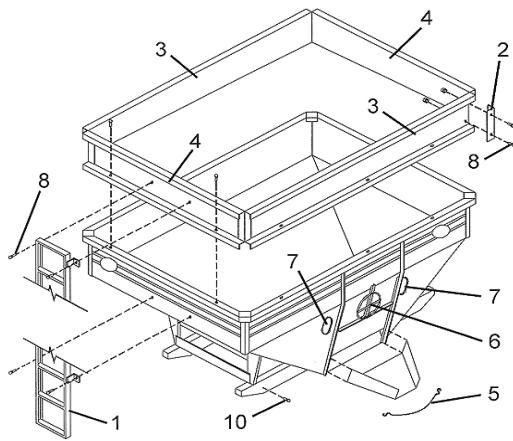

#	Part #	Description	
1	SL-5	Ladder Assembly, 5 Step	
2	C-15	Corner for 15" sideboards	
3	S-1510	Sideboard, 15" x 10'	
4	E-157	Endboard, 15" x 7'	
5	TF-21	Chute Fastener, 21"	
6	CWA-250	Complete Wheel Assembly	
7	IWK-1	Inspection Window Kit	
8	381-HBN-F	3/8" x 1" Flange Bolt with nut	
9	381-HBN	3/8" x 1" Bolt with nut	
10	12412BN	1/2" x 4 1/2" Bolt with nut	
11	RCA-250	Reinforcing Chain Assembly	
12	ST-120B	Steel Runner	
13	AH-142	Angle to hold timber	
14	SB-7	Set of 15" Boards Complete	
15	ELA-2	Extension Ladder Assy (2-step)	

### ROCKING BOLSTER ASSEMBLY

#	Part #	Description	
1	URB-250	Upper Rocking Bolster	
2	LRB-250	Lower Rocking Bolster	
3	RR-250	Rear Riser	
4	78-BNW	7/8" Bolt with Nut & Washer	
5	38412-BNW	3/8" x 4 1/2" Bolt with Nut & Washer	
6	RB-38	Rocking Bolster Complete	

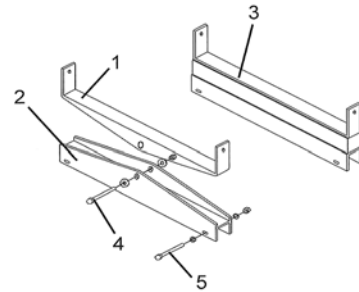

## Repair Parts List for 385SD Gravity Box, Sideboards, Braces and Ladder

### GRAVITY BOX PARTS LIST

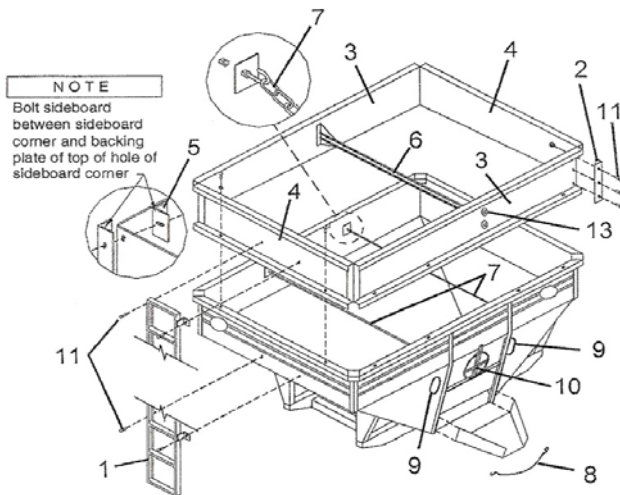

### Sideboard Brace

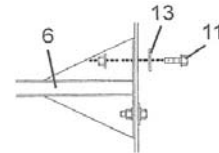

#	Part #	Description	
1	LL-7	Ladder Assembly, 7 step	
2	C-24	Corner for 24" sideboard	
2	C-20	Corner for 20" sideboard	
3	S-2412	Sideboard, 24" x 12'	
3	S-2012	Sideboard, 20" x 12'	
4	E-24712	Endboard, 24" x 7 1/2'	
4	E-20712	Endboard, 20" x 7 1/2'	
5	ICB-4	Inside Corner Bracket	
6	CB-385	Center Brace for sideboards	
7	RCA-385	Reinforcing Chain Assembly	
8	TF-31	Tarp Fastener x 31"	
9	IWK-1	Inspection Window Kit	
10	CWA-250	Complete Wheel Assembly	
11	381-HBN-F	3/8" x 1" Flange Bolt with nut	
12	381-HBN	3/8" x 1" Bolt with nut	
13	12LFW	Large Flat Washer	
14	S-385-24	Set of Boards Complete (24")	
15	S-350-20	Set of Boards Complete (20")	



## Repair Parts List for 385SD-Divider Gravity Box, Sideboards, Braces and Ladder

**NOTE**  
Bolt sideboard  
between sideboard  
corner and backing  
plate of top of hole of  
sideboard corner

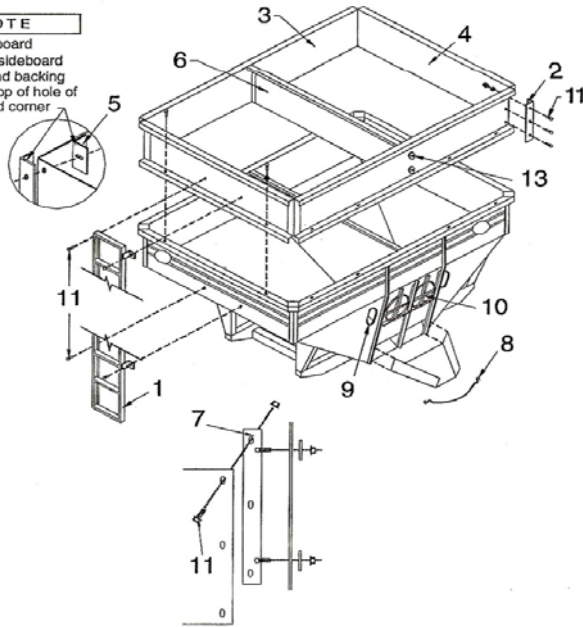

### OLD STYLE ROCKING BOLSTER ASSEMBLY FOR 385SD GRAVITY BOXES (1997 and Older)

#	Part #	Description
1	URB-385	Upper Rocking Bolster
2	LRB-385	Lower Rocking Bolster
3	RCM-385	Rear Channel Mount
4	12512-HBN	1/2" x 5 1/2" Bolt (G5) with lock nut and washer
5	78812-BNW	7/8" x 8 1/2" Bolt with nut and washer
6	RB-42	Rocking Bolster Complete (o/s)

### GRAVITY BOX PARTS LIST

#	Part #	Description
1	LL-7	Ladder Assembly, 7 step
2	C-24	Corner for 24" sideboard
3	S-2412	Sideboard, 24" x 12'
4	E-24712	Endboard, 24" x 7 1/2'
5	ICB-4	Inside Corner Bracket
6	DB-2475	Center Divider Board, 24" x 7 1/2'
7	DBB-24	Divider Board Bracket
8	TF-31	Tarp Fastener x 31"
9	IWK-1	Inspection Window Kit
10	CWA-250	Complete Wheel Assembly
11	381-HBN-F	3/8" x 1" Bolt with nut (Flange)
12	381-HBN	3/8" x 1" Bolt with nut
13	12LFW	Large Flat Washer

### NEW STYLE ROCKING BOLSTER ASSEMBLY FOR 385SD AND 425SD GRAVITY BOXES

#	Part #	Description
1	142-US	1/4" x 2" U-Strap
2	URBCM	Upper Rocking Bolster
3	LRBCM	Lower Rocking Bolster
4	12512-HBN	1/2" x 5 1/2" Bolt (G5) with lock nut and washer
5	126HBN	1/2" x 6" Bolt with nut
6	RCM-385N	Rear Channel Mount
7	RB-42N	Rocking Bolster Complete (n/s)

FRONT  
VIEW

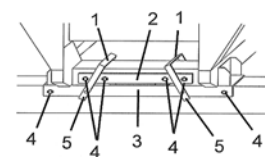

REAR  
VIEW

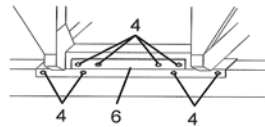

## Repair Parts List for 425-22SD Gravity Box, Sideboards, Braces and Ladders

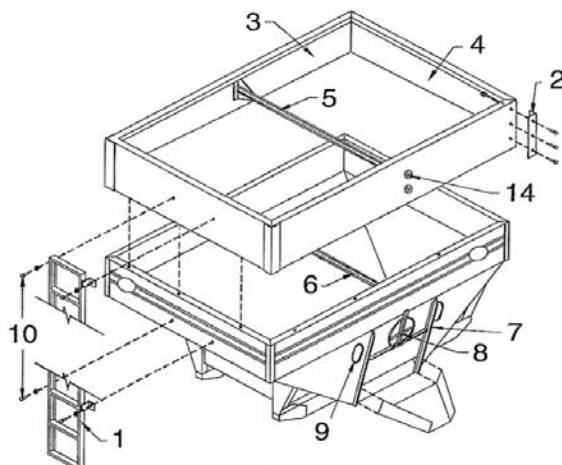

### GRAVITY BOX PARTS LIST

#	Part #	Description
1	LL-7	Ladder Assembly, 7 step
2	C-22	Corner for 22" sideboard
3	S-22126	Sideboard, 22" x 12' 6"
4	E-2284	Endboard, 22" x 8' 4"
5	CSB-425	Center Brace for sideboard
6	CBB-425	Center Box Brace
7	CH-425	Chain Hook
8	CWA-750	Complete Wheel Assembly
9	IWK-1	Inspection Window Kit
10	381-HBN-F	3/8" x 1" Bolt with nut (Flange)
11	381-HBN	3/8" x 1" Bolt with nut
12	38-FW	3/8" Flat Washer
13	38512BN	3/8" x 5 1/2" Bolt with nut
14	12LFW	Large Flat Washer
15	S-425-22	Set of Boards Complete (22")

## Repair Parts List for 440SD/540SD Gravity Box, Sideboards, Braces and Ladders

### GRAVITY BOX PARTS LIST

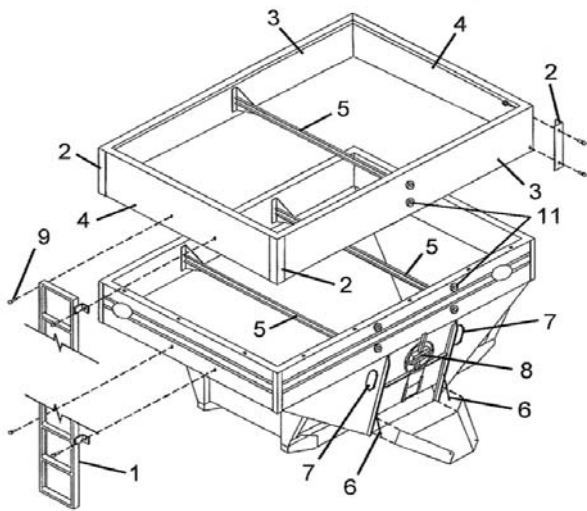

Sideboard Brace

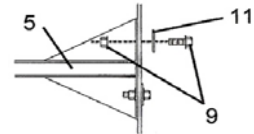

#	Part #	Description
1	LL-7	Ladder Assembly, 7 step
2	C-13	Corner for 13" sideboard (540SD)
3	S-1315	Sideboard, 13" x 15' (540SD)
4	E-1384	Endboard, 13" x 8' 4" (540SD)
5	CB-540	Center Brace (2 - 440SD / 3 - 540SD)
6	31617-CS	3/16" x 17" Chain with S-Hook
7	IWK-1	Inspection Window Kit
8	CWA-540	Complete Wheel Assembly
9	381-HBN-F	3/8" x 1" Flange Bolt with Nut
10	381-HBN	3/8" x 1" Bolt with nut
11	12LFW	Large Flat Washer
12	S-540-13	Set of Boards Complete (13")

### STYLE ROCKING BOLSTER ASSEMBLY (2006 and Older)

#	Part #	Description
1	142-USL	1/4" x 2" U-Strap (Long)
2	URBCM	Upper Rocking Bolster
3	LRBCM-540	Lower Rocking Bolster
4	12512-HBN	1/2" x 5 1/2" Bolt (G5) with lock nut and washer
5	126HBN	1/2" x 6" Bolt with nut
6	RCM-385N	Rear Channel Mount
7	RB-540	Rocking Bolster Assy Complete

FRONT VIEW

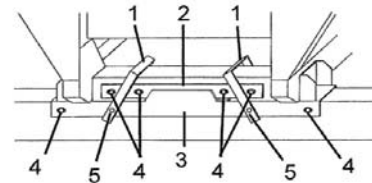

REAR VIEW

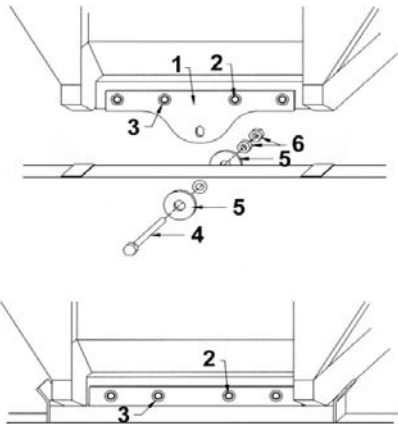

### ROCKING BOLSTER ASSEMBLY (2007 and Newer)

#	Part #	Description
1	URB-540	Upper Rocking Bolster (2 pcs)
2	346G5BLN	3/4" x 6" Grade 5 Bolt with lock nut
3	34-LW	3/4" Large Washer
4	78812-BNW	7/8" x 8 1/2" Bolt with Nut
5	78-LW	7/8" Large Washer

### Repair Parts List for 440SD-D/540SD-D Divider Gravity Box, Sideboards, Braces and Ladders

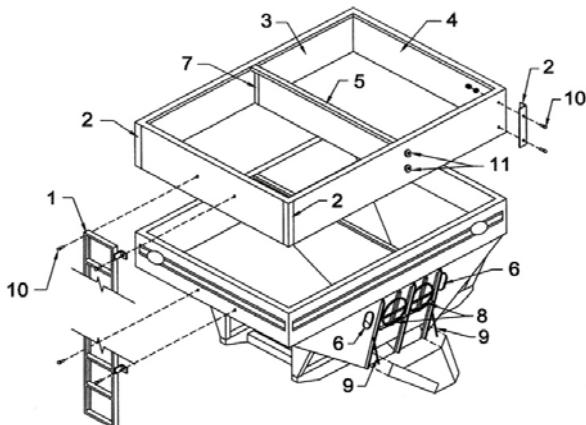

#	Part #	Description
1	LL-7	Ladder Assembly, 7 step
2	C-13	Corner for 13" sideboard (540SD)
3	S-1315	Sideboard, 13" x 15' (540SD)
4	E-1384	Endboard, 13" x 8' 4" (540SD)
5	DB-540	Divider Board
6	IWK-1	Inspection Window Kit
7	DBB-13	Divider Board Bracket
8	CWA-540	Complete Wheel Assembly
9	31617-CS	3/16" x 17" Chain with S-Hook
10	381-HBN-F	3/8" x 1" Flange Bolt with nut
11	12LFW	Large Flat Washer
12	381-HBN	3/8" x 1" Bolt with nut



## Repair Parts List for 525SD Gravity Box, Sideboards, Braces and Ladders

### GRAVITY BOX PARTS LIST

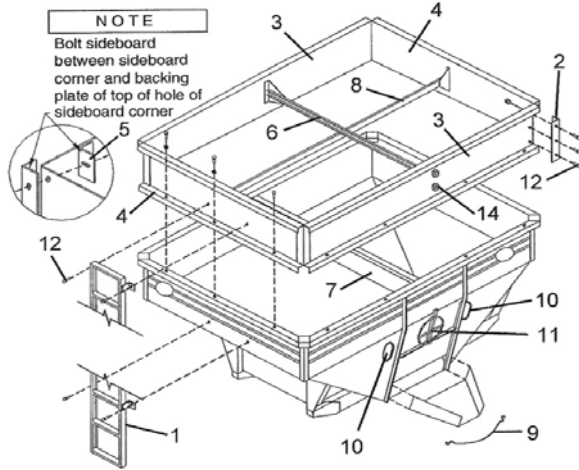

**FRONT VIEW**

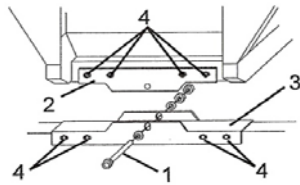

**REAR VIEW**

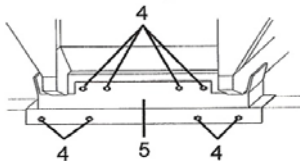

**Sideboard Brace**

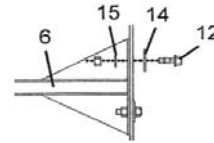

#	Part #	Description	
1	LL-7	Ladder Assembly, 7 step	
2	C-24	Corner for 24" sideboard	
2	C-20	Corner for 20" sideboard	
3	S-2414	Sideboard, 24" x 14'	
3	S-2014	Sideboard, 20" x 14'	
4	E-249	Endboard, 24" x 9'	
4	E-209	Endboard, 20" x 9'	
5	ICB-4	Inside Corner Bracket	
6	CB-500	Center Sides Brace	
7	RP-500	Center Box Brace	
8	EB-500	Center End Brace	
9	TF-31	Chute Fastener	
10	IWK-1	Inspection Window Kit	
11	CWA-250	Complete Wheel Assembly	
12	381-HBN-F	3/8" x 1" Flange Bolt with Nut	
13	381-HBN	3/8" x 1" Bolt with Nut	
14	12LFW	Large Flat Washer	
15	38-FW	3/8" Flat Washer	
16	S-525-24	Set of Boards Complete (24")	
17	S-525-20	Set of Boards Complete (20")	

### ROCKING BOLSTER ASSEMBLY

#	Part #	Description	
1	78812-BNW	7/8" x 8 1/2" Bolt with Nut and Washer	
2	URB-525	Upper Rocking Bolster	
3	LRB-525	Lower Rocking Bolster	
4	12512-HBN	1/2" x 5 1/2" Bolt (G5) with lock nut and washer	
5	RCM-525	Rear Channel Mount	
6	RB-525	Rocking Bolster Assy Complete	

## Repair Parts List for 525SD Divider Gravity Box, Sideboards, Braces and Ladders

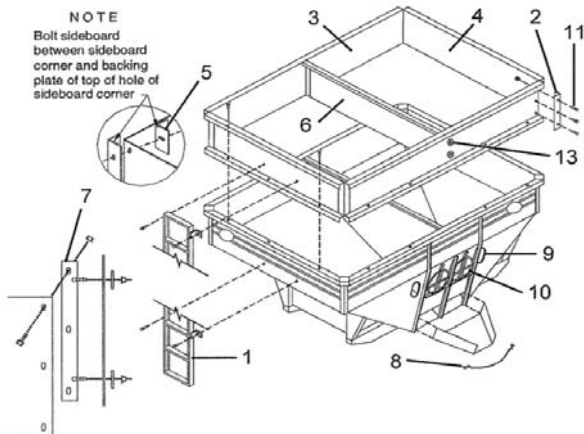

#	Part #	Description	
1	LL-7	Ladder Assembly, 7 step	
2	C-24	Corner for 24" sideboard	
3	S-2414	Sideboard, 24" x 14'	
4	E-249	Endboard, 24" x 9'	
5	ICB-4	Inside Corner Bracket	
6	DB-249	Center Divider Board, 24" x 9'	
7	DBB-24	Divider Board Bracket	
8	TF-31	Tarp Fastener x 31"	
9	IWK-1	Inspection Window Kit	
10	CWA-250	Complete Wheel Assembly	
11	381-HBN-F	3/8" x 1" Bolt with nut (Flange)	
12	381-HBN	3/8" x 1" Bolt with nut	
13	12LFW	Large Flat Washer	

### Repair Parts List for 525CD Gravity Box, Sideboards, Braces and Ladders

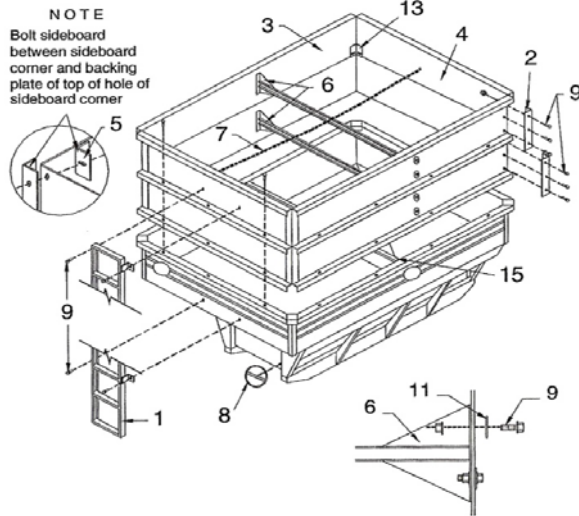

#	Part #	Description	
1	LL-7	Ladder Assembly, 7 step	
2	C-15	Corner for 15" sideboard	
2	C-20	Corner for 20" sideboard	
3	S-1514	Sideboard, 15" x 14'	
3	S-2014	Sideboard, 20" x 14'	
4	E-158	Endboard, 15" x 8'	
4	E-208	Endboard, 20" x 8'	
5	ICB-4	Inside Corner Bracket	
6	CB-525	Center Brace, 8' Long for 15" board	
6	CB-525S	Center Brace, 8' Long for 20" board	
7	EC-525	Reinforcing Chain	
8	WPS-CD	Wheel Pin & Strap Assembly	
9	381-HBN-F	3/8" x 1" Bolt with nut (Flange)	
10	38-FW	3/8" Flat Washer	
11	12LFW	Large Flat Washer	
12	D-525CD	Door for Center Dump	
13	ICB-CD	Inside Corner Bracket	
14	CSPA-1	Cable, Spring & Pulley Assembly	
15	RP-525	Reinforcing Brace	

### Repair Parts List for 650SD and 750SD Gravity Box, Sideboards, Braces and Ladders

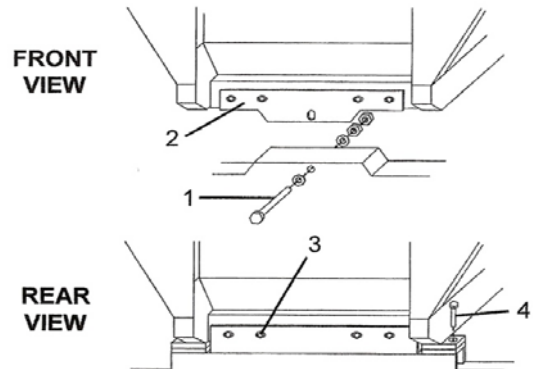
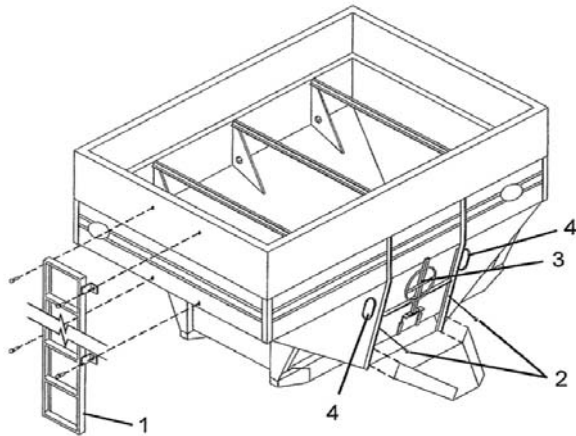

#### ROCKING BOLSTER ASSEMBLY FOR 650SD AND 750SD GRAVITY BOXES

650SD GRAVITY BOX PARTS LIST		
#	Part #	Description
1	LL-8	Ladder Assembly, 8 Step
2	31617-CS	3/16" x 17" Chain with S-Hook
3	CWA-750	Complete Wheel Assembly
4	IWK-1	Inspection Window Kit
5	381-HBN-F	3/8" x 1" Flange Bolt with Nut
6	381-HBN	3/8" x 1" Bolt with Nut

#	Part #	Description	
1	78812-BNW	7/8" X 8 1/2" Bolt with Nut and Washer	
2	URB-6750	Upper Rocking Bolster	
3	12512-HBN	1/2" x 5 1/2" Bolt (G5) with lock nut and washer	
4	782B-LN	7/8" x 2 1/4" Bolt with Lock Nut and Lock Washer	

750SD GRAVITY BOX PARTS LIST		
#	Part #	Description
1	LL-8	Ladder Assembly, 8 Step
2	31617-CS	3/16" x 17" Chain with S-Hook
3	CWA-750	Complete Wheel Assembly
3	CWA-540	Complete Wheel Assy (Gear Reduction) (2005 and Newer)
4	IWK-1	Inspection Window Kit
5	381-HBN-F	3/8" x 1" Flange Bolt with Nut
6	381-HBN	3/8" x 1" Bolt with Nut

# Repair Parts List for 680SD / 760SD Gravity Box and 680SD-D / 760SD-D Divider Gravity Box

## 680SD / 760SD GRAVITY BOX

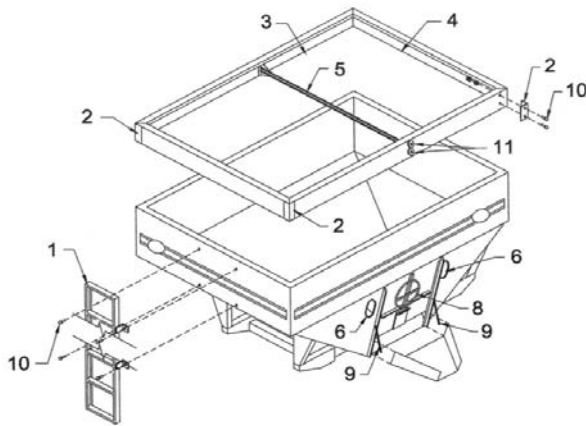

#	Part #	Description
1	LL-8	Ladder Assembly, 8 step
2	C-8	Corner for 8" Sideboard (760SD)
3	S-8166	Sideboard, 8" x 16'-6" (760SD)
4	E-896	Endboard, 8" x 9'-6" (760SD)
5	CB-760	Center Brace for Sideboard
6	IWK-1	Inspection Window Kit Complete
7	S-760-8	Set of Boards Complete (8")
8	CWA-540	Complete Wheel Assembly
9	31617-CS	3/16" x 17" Chain Assembly
10	381-HBN-F	3/8" x 1" Flange Bolt and Nut
11	12LFW	Large Flat Washer

## 680SD / 760SD DIVIDER GRAVITY BOX

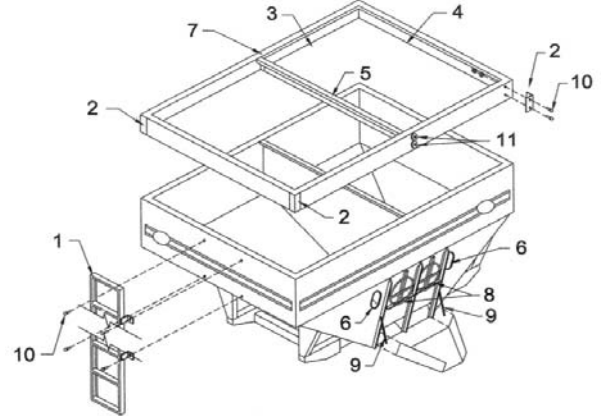

#	Part #	Description
1	LL-8	Ladder Assembly, 8 step
2	C-8	Corner for 8" Sideboard (760SD)
3	S-8166	Sideboard, 8" x 16'-6" (760SD)
4	E-896	Endboard, 8" x 9'-6" (760SD)
5	DB-896	Center Divider Board, 8" x 9'-6"
6	IWK-1	Inspection Window Kit Complete
7	DBB-8	Divider Board Bracket, 8"
8	CWA-540	Complete Wheel Assembly
9	31617-CS	3/16" x 17" Chain Assembly
10	381-HBN-F	3/8" x 1" Flange Bolt and Nut
11	12LFW	Large Flat Washer

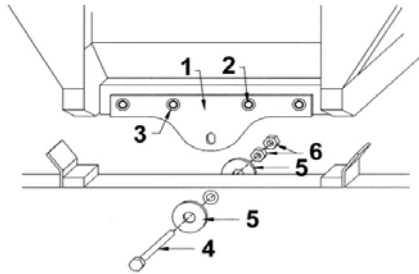

## ROCKING BOLSTER ASSEMBLY

#	Part #	Description
1	URB-680	Upper Rocking Bolster
2	346G5BLN	3/4" x 6" Grade 5 Bolt with Lock Nut
3	34-LW	3/4" Large Washer
4	78812-BNW	7/8" x 8 1/2" Bolt with Nut
5	78-LW	7/8" Large Washer



## Chute, Door and Wheel Assembly & Window Kits for Gravity Boxes

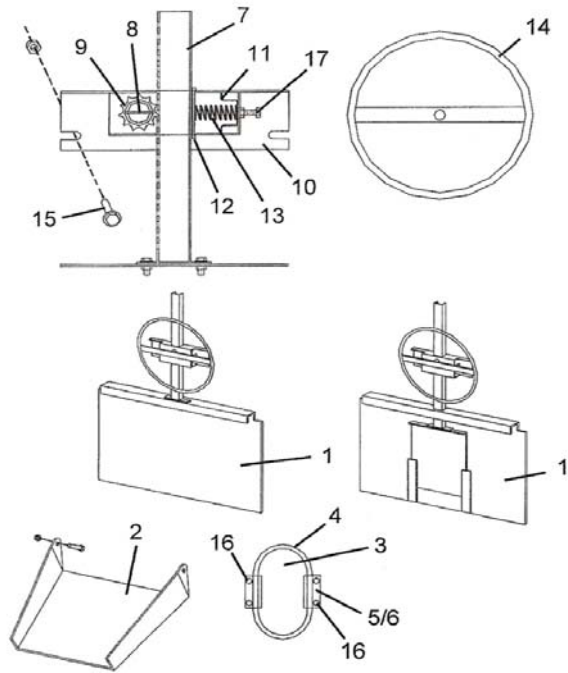

**Item # 7 Door Track Types**

TA-2014  
and TA-28  
Style Track

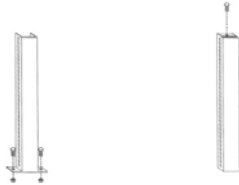

TA-2012,  
and TA-2712  
Style Track

**Adjustable Chute Assembly**

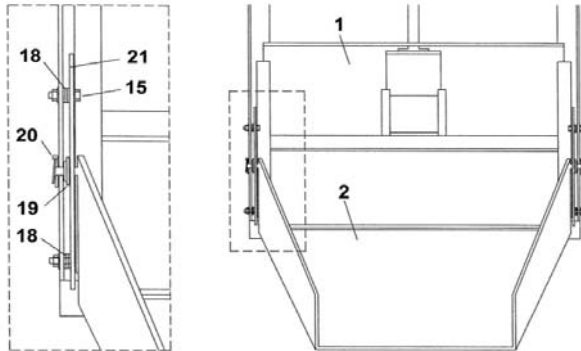

**Center Diverter Chute**

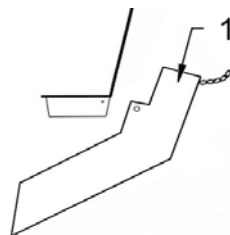

#	Part #	Description	
1	D-210	Door only for 210 & Old Style 250	
1	D-250	Door only for New Style 250	
1	D-350	Door only for 385, 500 or 525 Box	
1	D-350D	Divider Door for 385 & 525 Box	
1	D-385M	Metering Door for 385SD	
1	D-425	Door Assembly for 425SD Box	
1	D-450	Door with slide for Old Style 450CD	
1	D-540D	Divider Door for 440SD / 540SD	
1	D-540M	Metering Door for 440SD/540SD	
1	D-650	Door only for 650 Box	
1	D-680	Metering Door for 680SD/760SD	
1	D-750	Door only for 440SD, 540SD, 750SD	
2	GC-24-6	Grain Chute for 6' Box (24" Door)	
2	GC-24-7	Grain Chute for 7' Box (24" Door)	
2	GC-30	Grain Chute for 250-7S	
2	GC-36	Grain Chute for 350, 385SD	
2	GC-36L	Grain Chute for 500, 525SD	
2	GC-425	Grain Chute for 425SD Box	
2	GC-48	Grain Chute (440SD, 540SD, 750SD)	
2	GC-650	Grain Chute for 650 Box	
2	GC-680	Adj. Grain Chute for 680SD/760SD	
3	IW-71212	Inspection Window	
4	62095-7	Window Molding	
5	WB-4	Window Brace - Inside (each)	
6	WB-4B	Window Brace - Outside (each)	
7	TA-2014	Track Assembly (starting 1976) (20 1/4" long, 2 bolt)	
7	TA-26	Track Assembly (26" long)	
7	TA-2712	Track Assembly (27 1/2" long, 1 bolt)	
7	TA-2012	Track Assembly (20 1/2" long, 1 bolt)	
7	TA-28	Track Assembly (28" long, 2 bolt)	
8	138RP	1 3/8" Roll Pin	
9	11T40	11 Tooth Sprocket	
10	WGA-1034	Welded Guide Assembly for Track (started in 1976)	
10	WGA-2612	Welded Guide Assembly for Track (1963 thru 1973)	
10	WGA-3212	Welded Guide Assembly for Track (1974 thru 1975)	
11	MC-250	Metal Clip in Door Assembly	
12	GL-250	Galvanized Clip in Door Assy	
12	WB-250	Wood Block (Old Style Door Lift)	
13	DS-250	Spring in Door Assembly	
14	WPS-250	Wheel Pin & Strap Assembly	
14	WPS-CD	Wheel Pin & Strap Assy for CD Box	
15	381-HBN-F	3/8" x 1" Flange Bolt and Nut	
16	3834-HBN	3/8" x 3/4" Bolt with Nut	
17	38112BN	3/8" x 1 1/2" Bolt with Nut	
18	38-FW	3/8" Washer	
19	38-LW	3/8" Large Washer	
20	CTE-LP	Lynch Pin	
21	ACB-1	Adjustable Chute Bracket	

#	Part #	Description	
1	CDC-425	Center Diverter Chute (425SD)	
1	CDC-1	Center Diverter Chute (525SD)	
1	CDC-650	Center Diverter Chute (650SD)	
1	CDC-750	Center Diverter Chute (750SD)	

### Gear Reduction Wheel Assembly

For All 440SD, 540SD, 680SD and 760SD Gravity Wagons and 750SD Gravity Wagons (2005 and newer)

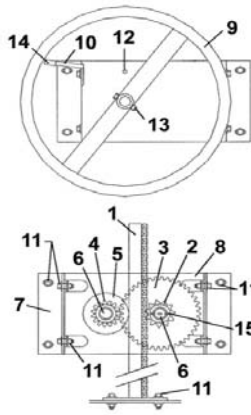

#	Part #	Description
1	TCA-28	Track and Chain Assembly
2	10T50B	10 Tooth Sprocket
3	38TSS	38 Tooth Sprocket
4	15TSS	15 Tooth Sprocket
5	TS-1	Stabilizer with Bronze Bushing
6	BB-34	3/4" Bronze Bushing
7	RMP-1	Rear Mounting Plate
8	FCP-1	Front Cover Plate
9	WPS-1	Wheel, Pin and Strap Assembly
10	DLR-1	Door Locking Rod
11	381-HBN-F	3/8" x 1" Flange Bolt with Nut
12	141HBLN	1/4" x 1" Hex Bolt with Lock Nut
13	38134HBN	3/8" x 1 3/4" Hex Bolt with Nut
14	REC-1	Rubber End Cap
15	14112RP	1/4" x 1 1/2" Roll Pin

### Repair Parts List for Gravity Box Light Kit

(New Style - On Gravity Wagons 2001 and Newer)

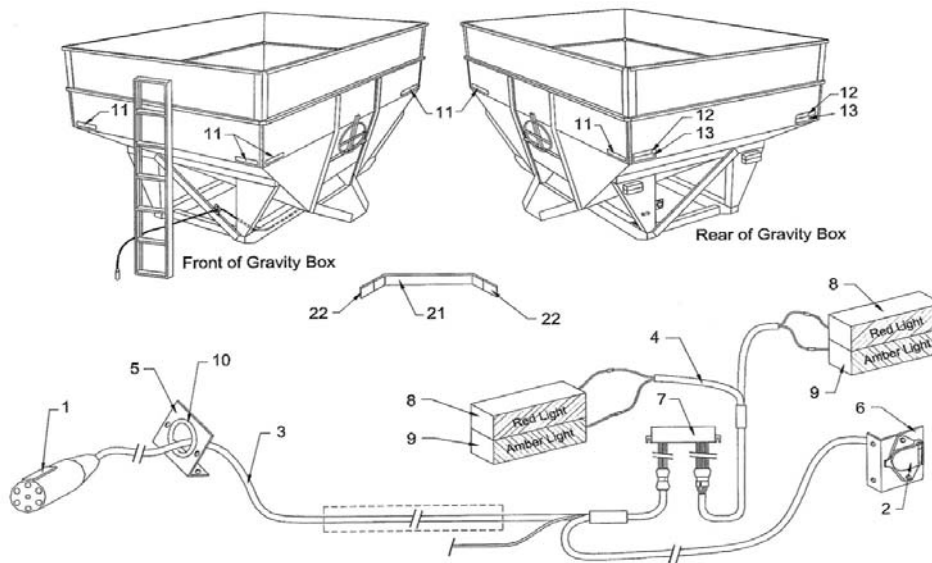

#	Part #	Description
1	7-WCE	7-Wire Connector End
2	7-WNB	7-Wire Nose Box
3	WH-1N	Main Wiring Harness
4	LH-1	Light Harness
5	AB-1F	Front Angle Bracket
6	AB-1R	Rear Angle Bracket
7	LE-1B	Light Enhancer
8	LT-R1	Red Light
9	LT-A1	Amber Light
10	PG-1L	Plastic Grommet
11	RD-A1	Amber Reflective Decal
12	RD-R1	Red Reflective Decal
13	RD-O1	Orange Reflective Decal
14	141-CB	1/4" x 1" Carriage Bolt
15	14-FN	1/4" Flange Nut
16	181-HB	1/8" x 1" Hex Bolt
17	18-HN	1/8" Hex Nut
18	1434-SDST	1/4" x 3/4" Self-Tapping Screw
19	WLC-1	Wire Loom Clamp
20	SMV-2	Slow Moving Vehicle Emblem
21	WHB-1	Wire Harness Storage Bracket
22	RCW-1	Rubber Cap
23	OFL-1	Flood Light over door

#	Part #	Description
24	OMST-1	Manual Storage Container
27	WG-2	Wire Guard for Rear Lights
28	LK-NI-B	Light Kit Complete

### Repair Parts List for Gravity Box Light Kit

(Old Style - On Gravity Wagons 2000 and Older)

#	Part #	Description
1	7-WCE	7-Wire Connector End
2	7-WNB	7-Wire Nose Box
3	WH-1	Main Wiring Harness
4	LT-1L	Flashing/Turn Light (left)
4	LT-1R	Flashing/Turn Light (right)
5	PTD-1	Plastic Tie Down
6	PG-1	Plastic Grommet
7	RD-A1	Amber Reflective Decal
8	RD-R1	Red Reflective Decal
9	141-HB	1/4" x 1" Bolt
10	HN-14	1/4" Hex Nut
11	WC-1	Wire Clip
12	AB-1	Angle Bracket
13	1434-SDST	1/4" x 3/4" Self Tapping Screw



# Repair Parts List for Gravity Box True-Lock Roll Tarp

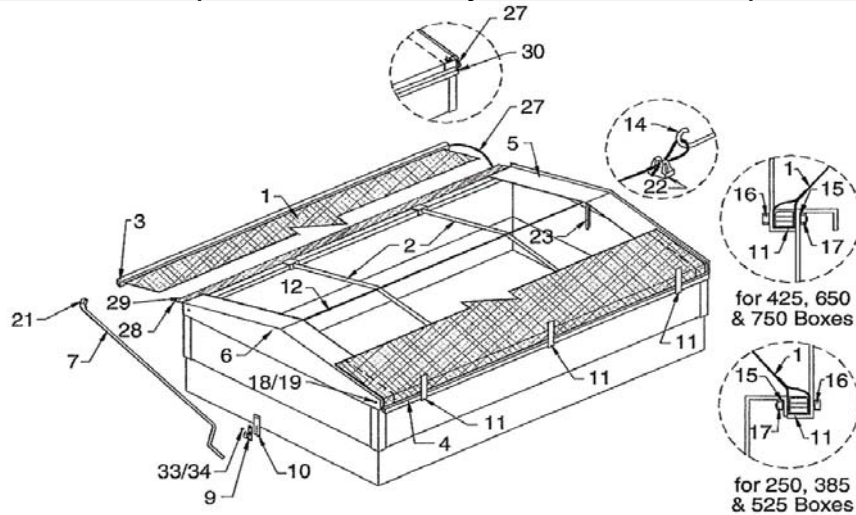

#	Part #	Description
1	250-7T	Tarp w/Rivets (250-7S)
1	385T	Tarp w/Rivets (385SD)
1	425T	Tarp w/Rivets (425SD)
1	440T	Tarp w/Rivets (440SD/540SD)
1	525BT	Tarp w/Rivets (525SD, 525CD)
1	650T	Tarp w/Rivets (650SD)
1	680T	Tarp w/Rivets (680SD/760SD)
1	750T	Tarp w/Rivets (750SD)
2	85TB	Bow for Tarp (250-7S)
2	91TB	Bow for Tarp (385SD)
2	94TB	Bow for Tarp (440SD)
2	97TB	Bow for Tarp (425SD, 525CD, 540SD)
2	109TB	Bow for Tarp (525SD, 650SD, 750SD)
2	109TB-1	Bow for Tarp (680SD)
2	110TB	Bow for Tarp (760SD)
3	126RT	1 1/4" Sq. Roll Tube (250-7S)
3	150RT	1 1/4" Sq. Roll Tube (385SD)
3	156RT	1 1/4" Sq. Roll Tube (425SD)
3	174RT	1 1/4" Sq. Roll Tube (525SD, 525CD)
3	186RT	1 1/4" Sq. Roll Tube (440SD, 540SD, 650SD)
3	198RT	1 1/4" Sq. Roll Tube (750SD)
3	204RT	1 1/4" Sq. Roll Tube (680-760SD)
4	120TT	1" Sq. Tie-Down Tube (250-7S)
4	144TT	1" Sq. Tie-Down Tube (385SD)
4	150TT	1" Sq. Tie-Down Tube (425SD)
4	168TT	1" Sq. Tie-Down Tube (525SD, 525CD)
4	180TT	1" Sq. Tie-Down Tube (440SD, 540SD, 650SD)
4	192TT	1" Sq. Tie-Down Tube (750SD)
4	198TT	1" Sq. Tie-Down Tube (680/760)
5	8612FP	Front End Panel (250-7S)
5	93FP	Front End Panel (385SD)
5	99FP	Front End Panel (425SD, 525CD)
5	110FP	Front End Panel (440SD, 540SD)
5	112FP	Front End Panel (525SD, 650-750SD, 680SD/760SD)
6	8612RP	Rear End Panel (250-7S)
6	93RP	Rear End Panel (385SD)
6	99RP	Rear End Panel (425SD, 525CD)
6	110RP	Rear End Panel (440SD, 540SD)
6	112RP	Rear End Panel (525SD, 650-750SD, 680SD/760SD)

#	Part #	Description
7	CUJ-1N	Crank w/splined u-joint (250-7S through 540SD)
7	CUJ-1LN	Crank w/splined u-joint (650SD, 750SD)
9	CH-1N	Crank Holder
10	ABCH-1	Adjustable Bar for Crank Holder
11	TSB-1	Tarp Stop Bracket with Sleeve
12	316C-126	3/16" Cable x 126" (250-7S)
12	316C-150	3/16" Cable x 150" (385SD)
12	316C-156	3/16" Cable x 156" (425SD)
12	316C-174	3/16" Cable x 174" (525SD, 525CD)
12	316C-186	3/16" Cable x 186" (440SD, 540SD, 650SD)
12	316C-198	3/16" Cable x 198" (750SD)
12	316C-204	3/16" Cable x 204" (680/760SD)
13	381-HB	3/8" x 1" Hex Bolt
14	384JB	3/8" J-Bolt
15	38-FW	3/8" Flat Washer
16	382-HB	3/8" x 2" Hex Bolt
17	HLN-38	3/8" Hex Lock Nut
18	1434-HB	1/4" x 3/4" Hex Bolt
19	HLN-14	1/4" Hex Lock Nut
21	14212-HB	1/4" x 2 1/2" Hex Bolt
22	316CC	3/16" Cable Clamp
23	EPB-1	End Panel Brace
24	381-SB	3/8" x 1" Stove Bolt
25	PT-93	1/2" Plastic Tube x 105" (250-7S)
25	PT-99	1/2" Plastic Tube x 111" (385SD)
25	PT-105	1/2" Plastic Tube x 111" (525CD)
25	PT-108	1/2" Plastic Tube x 129" (425SD)
25	PT-117	1/2" Plastic Tube x 129" (525SD)
25	PT-123A	1/2" Plastic Tube x 135" (440-540SD)
25	PT-123	1/2" Plastic Tube x 135" (650-750SD, 680/760SD)
26	CT-18	1/2" Clear Tube x 18" (250-7S)
26	CT-24	1/2" Clear Tube x 24" (for all boxes except model 250-7S)
27	BC-111	3/8" Bungee Cord x 125" (250-7S)
27	BC-123	3/8" Bungee Cord x 131" (385SD)
27	BC-129	3/8" Bungee Cord x 131" (525CD)
27	BC-132	3/8" Bungee Cord x 149" (425SD)
27	BC-132A	3/8" Bungee Cord x 155" (440-540SD)
27	BC-141	3/8" Bungee Cord x 149" (525SD)

### Repair Parts List for Gravity Box True-Lock Roll Tarp (continued)

#	Part #	Description		#	Part #	Description	
27	BC-147	3/8" Bungee Cord x 155" (650SD, 750SD, 680SD, 760SD)		29	PM-148	Plastic Molding x 148" (385SD)	
28	TL-123	Tightening Lip x 123" (250-7S)		29	PM-150	Plastic Molding x 150" (425SD)	
28	TL-148	Tightening Lip x 148" (385SD)		29	PM-172	Plastic Molding x 172" (525SD, 525CD)	
28	TL-150	Tightening Lip x 150" (425SD)		29	PM-180	Plastic Molding x 180" (440SD, 540SD, 650SD)	
28	TL-172	Tightening Lip x 172" (525SD, 525CD)		29	PM-192	Plastic Molding x 192" (750SD)	
28	TL-180	Tightening Lip x 180" (540SD, 650SD)		30	SPG-1	Square Plastic Grommet	
28	TL-180S	Tightening Lip x 180" (440SD)		31	14STS	1/4" Self Tapping Screw	
28	TL-192	Tightening Lip x 192" (750SD)		32	BCC-1	Bungee Cord Clip	
28	TL-198	Tightening Lip x 198" (680/760SD)		33	121HB	1/2" x 1" Hex Bolt	
29	PM-123	Plastic Molding x 123" (250-7S)		34	12LN	1/2" Lock Nut	
				35	516EB	5/16" Eyebolt	

### Repair Parts List for Gravity Box Roll Tarp (Ratchet-Strap Type Old Style)

#	Part #	Description		#	Part #	Description	
1	250-7T	Tarp w/Tiedown Straps, Rivets (250-7S)		6	8612RP	Rear End Panel (250-7S)	
1	385T	Tarp w/Tiedown Straps, Rivets (385SD)		6	93RP	Rear End Panel (385SD)	
1	425T	Tarp w/Tiedown Straps, Rivets (425SD)		6	99RP	Rear End Panel (425SD, 525CD)	
1	525BT	Tarp w/Tiedown Straps, Rivets (525SD, 525CD)		6	111RP	Rear End Panel (525SD)	
1	650T	Tarp w/Tiedown Straps, Rivets (650SD)		6	11212RP	Rear End Panel (650SD, 750SD)	
1	750T	Tarp w/Tiedown Straps, Rivets (750SD)		7	CUJ-1	Crank w/Universal Joint (250-7S, 385SD, 425SD, 525SD, 525CD)	
2	85TB	Bows for Tarp (250-7S)		7	CUJ-1L	Crank w/Universal Joint (650SD, 750SD)	
2	91TB	Bows for Tarp (385SD)		9	CH-1	Crank Holder w/hair pin (250-7S, 385SD, 425SD, 525SD, 525CD)	
2	97TB	Bows for Tarp (425SD, 525CD)		9	CH-1L	Crank Holder w/hair pin (650SD, 750SD)	
2	109TB	Bows for Tarp (525SD, 650SD, 750SD)		10	RA-1	Ratchet	
3	126RT	1 1/4" Sq. Roll Tube (250-7S)		11	TSB-1	Tarp Stop Bracket with sleeve	
3	150RT	1 1/4" Sq. Roll Tube (385SD)		12	316C-126	3/16" Cable x 126" (250-7S)	
3	156RT	1 1/4" Sq. Roll Tube (425SD)		12	316C-150	3/16" Cable x 150" (385SD)	
3	174RT	1 1/4" Sq. Roll Tube (525SD, 525CD)		12	316C-156	3/16" Cable x 156" (425SD)	
3	186RT	1 1/4" Sq. Roll Tube (650SD)		12	316C-174	3/16" Cable x 174" (525SD, 525CD)	
3	198RT	1 1/4" Sq. Roll Tube (750SD)		12	316C-186	3/16" Cable x 186" (650SD)	
4	120TT	1" Sq. Tiedown Tube (250-7S)		12	316C-198	3/16" Cable x 198" (750SD)	
4	144TT	1" Sq. Tiedown Tube (385SD)		13	381-HB	3/8" x 1" Hex Bolt	
4	150TT	1" Sq. Tiedown Tube (425SD)		14	384EB	3/8" Eye Bolt	
4	168TT	1" Sq. Tiedown Tube (525SD, 525CD)		15	38-FW	3/8" Flat Washer	
4	180TT	1" Sq. Tiedown Tube (650SD)		16	382-HB	3/8" x 2" Hex Bolt	
4	192TT	1" Sq. Tiedown Tube (750SD)		17	HLN-38	3/8" Hex Lock Nut	
5	8612FP	Front End Panel (250-7S)		18	1458-HB	1/4" x 5/8" Hex Bolt	
5	93FP	Front End Panel (385SD)		19	HLN-14	1/4" Hex Lock Nut	
5	99FP	Front End Panel (425SD, 525CD)		21	14134-HB	1/4" x 1 3/4" Hex Bolt	
5	111FP	Front End Panel (525SD)		22	316CC	3/16" Cable Clamp	
5	11212FP	Front End Panel (650SD, 750SD)		23	EPB-1	End Panel Brace	
				24	381-SB	3/8" x 1" Stove Bolt	

# Repair Parts List for 8 Ton (Model 868) Running Gear

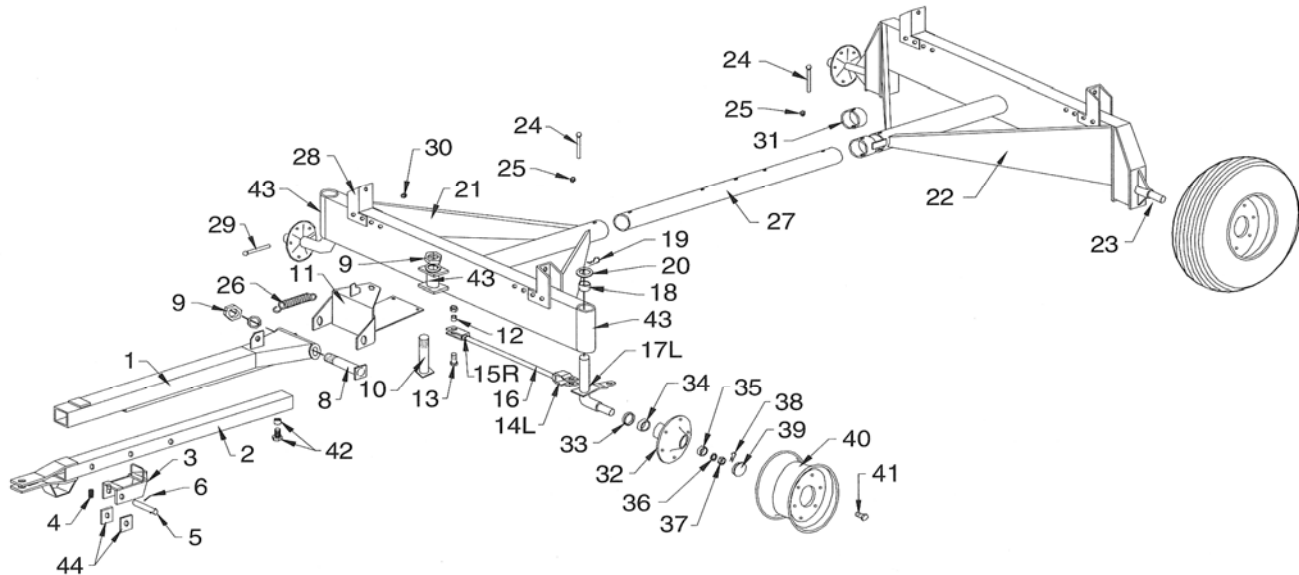

#	Part #	Description
1	OT-610NS	Adj. Outer Tongue Weldment, square latch (replaces outer tongue weldment prior to 1995 w/round latch)
2	IT-610NS	Adj. Inner Tongue Weldment
3	TL-610NS	Tongue Latch Weldment, square hole (replaces tongue latch weldment prior to 1995 w/round hole)
4	SS-615	Small Latch Spring (prior to 1995)
4	SS-615NS	Small Latch Spring (since 1995)
5	LS-610	Latch Pivot Shaft, 1" Dia. x 5 3/4"
6	CP-112	Cotter Pin
7	ST-610	Standard Tongue
7	TT-610	Telescoping Tongue w/spring
8	TB-610	Tongue Bolt 1 1/4" Rd x 11 3/4"
9	HN-114	1 1/4" Hex Nut
10	KP-610	King Pin Vertical Hitch Bolt 1 1/4" x 7 3/4"
11	HW-68	Hitch Weldment Complete
12	BB-58	5/8" ID Bronze Bushing for step bolt
13	SB-58	Special Step Bolt for Tie Rod End
14L	TRE-78L	Tie Rod End, Left (clevis type) new style fits 7/8" round
14R	TRE-78R	Tie Rod End, Right (clevis type) new style fits 7/8" round
15L	HN-78L	7/8"-14 N/F Nuts, L/H for Tie Rod
15R	HN-78R	7/8"-14 N/F Nuts, R/H for Tie Rod
16	TR-2114	Tie Rod, 7/8" x 21 1/4"
17L	SA-78L	Bent Spindle, 1 3/4" Dia. w/bent steering arm, Left (new style)
17R	SA-78R	Bent Spindle, 1 3/4" Dia. w/bent steering arm, Right (new style)
18	EB-134	1 3/4"ID End Spindle Bronze Bushing
19	CP-212	Cotter Pin 3/16" x 2 1/2"
20	MB-134	Machine Bushing (top of spindle) 1 3/4" ID

#	Part #	Description
21	FA-8	Running Gear, Front only less hitch, tongue, tie rods, hub and spindles (A-Frame)
22	RA-8	Running Gear, Back only, less wheels, standards
22	FA-8C	Running Gear, Front only, less wheels, tongue and standards
23	RS-78	Spindle (rear) Straight 105708-X 1 3/4" Dia. x 13 1/4"
24	MB-345	3/4" x 5" Hex Head Machine Bolt
25	LN-34	3/4" Lock Nut
26	TS-615	Large Tongue Spring
27	CP-3	Coupling Pole, 3" OD x 73 3/4"
27	CP-3L	Coupling Pole, 3" OD x 110 3/4"
28	ST-68	Standard
29	MB-384	3/8" x 4" Bolt for Standard
30	HN-38	3/8" Hex Nut
31	CL-312	3" Collar to Coupling Pole
32	105218	Hub, w/studs, nuts & cups (F&H 105218) (also replaces EW-Q-709) (287 802)
32	105218-SSA	Hub & Straight spindle assy complete
32	105218-RSA	Hub & Bent spindle assembly, R/H
32	105218-LSA	Hub & Bent spindle assembly, L/H
33	103953	Grease Seal (#0205435)
34	104579	Cone (large) 104579 or LM-48548 Inner
35	104082	Cone (small) 104082 or LM-67048 Outer
36	104581	Spindle Washer
37	103289	Slotted Spindle Nut
38	CP-316	Cotter Pin
39	103969	Dust Cap
40	WR-146	Wheel Rim, 6 hole 14" x 6"
40	WR-156	Wheel Rim, 6 hole 15" x 6"
40	WR-166	Wheel Rim, 6 hole 16" x 6"
40	WR-158	Wheel Rim, 6 hole 15" x 8"

### Repair Parts List for 8 Ton (Model 868) Running Gear (continued)

#	Part #	Description	
41	4187	Studs (#4187) for (F&H 105218) (1/2"-20)	
42	78214-BS	7/8" x 2 1/4" HHMB with spacer	
43	1633	Grease Fitting	
44	SB-212	Spacer Blocks	

#	Part #	Description	
45	TSB-2	Tongue Spring Brackets (2 pcs)	
46	104580	Cup (large) 104580 or LM-48510	
47	104081	Cup (small) 104081 or LM-67010	
48	5552	Lug Nut	

### Repair Parts List for 6 Ton Running Gear (same as 8 Ton except)

#	Part #	Description	
14L	TRE-78L-O	Tie Rod End, Left (automotive) old style (for pipe tie rod) TRW#269-2240L	
14R	TRE-78R-O	Tie Rod End, Right (automotive) old style (for pipe tie rod) TRW#269-2241R	
14	RS-7-O	Rubber Shield for old style Tie Rod End	
14	CL-7-O	Clamp for old style Tie Rod (for pipe tie rod)	
16	TR-2114-O	Tie Rod, old style, Hvy Duty Pipe	
17L	SA-6L	Bent Spindle, 1 3/4" Dia. w/bent steering arm, Left (new style)	
17R	SA-6R	Bent Spindle, 1 3/4" Dia. w/bent steering arm, Right (new style)	
17L	SA-6L-O	Bent Spindle, 1 3/4" Dia. w/bent steering arm, Left (old style)	
17R	SA-6R-O	Bent Spindle, 1 3/4" Dia. w/bent steering arm, Right (old style)	
22	RA-6	Running Gear, Back only, less Wheels, Standards	

#	Part #	Description	
22	FA-6C	Running Gear, Front only, less Tongue, Wheels, Standards, Pole	
23	RS-67	1 3/4" Spindles, Strt 105708-K	
24	MB-58334	5/8" x 3 3/4" HHMB	
25	LN-58	5/8" Lock Nut	
27	CP-238	Coupling Pole, 2" Pipe (2 3/8"OD) x 84"	
27	CP-238L	Coupling Pole, 2" Pipe (2 3/8"OD) x 108"	
32	104682	Hub, w/Bolts & Cups (for #104683) 5 Bolt	
32	104682-SSA	Hub & Straight Spindle Assy. Complete	
32	104682-RSA	Hub & Bent Spindle Assembly Complete, Right	
32	104682-LSA	Hub & Bent Spindle Assembly Complete, Left	
40	WR-156-5	Wheel Rim, 5 hole, 15" x 6"	
40	WR-146-5	Wheel Rim, 5 hole, 14" x 6"	

### Repair Parts List for 7 Ton Running Gear (same as 8 Ton except)

#	Part #	Description	
14L	TRE-78L	Tie Rod End, Left (clevis type) new style fits 7/8" round	
14L	TRE-78L-O	Tie Rod End, Left (automotive) old style (for pipe tie rod) TRW#269-2240L	
14R	TRE-78R	Tie Rod End, Right (clevis type) new style fits 7/8" round	
14R	TRE-78R-O	Tie Rod End, Right (automotive) old style (for pipe tie rod) TRW#269-2241R	
14	RS-7-O	Rubber Shield for old style Tie Rod End	
14	CL-7-O	Clamp for old style Tie Rod (for pipe tie rod)	
16	TR-2114	Tie Rod, new style, 7/8" x 21 1/4"	
16	TR-2114-O	Tie Rod, old style, Heavy Duty Pipe	
17L	SA-78L	Bent Spindle, 1 3/4" Dia. with Bent Steering Arm, Left (new style)	
17L	SA-78L-O	Bent Spindle, 1 3/4" Dia. with Straight Steering Arm, Left (old style)	
17R	SA-78R	Bent Spindle, 1 3/4" Dia. with Bent Steering Arm, Right (new style)	
17R	SA-78R-O	Bent Spindle, 1 3/4" Dia. with Straight Steering Arm, Right (old style)	
21	FA-67	Running Gear, Front only, less Hitch, Tongue, Tie Rods, Hubs & Spindles (A-Frame)	
21	FA-7C	Running Gear, Front only, less Wheels, Standards, Tongue, Pole	

#	Part #	Description	
22	RA-7	Running Gear, Back only, less Wheels, Standards	
24	MB-58334	5/8" x 3 3/4" Machine Bolt	
25	LN-58	5/8" Lock Nut	
27	CP-238	Coupling Pole, 2" Pipe (2 3/8"OD) x 84"	
27	CP-238L	Coupling Pole, 2" Pipe (2 3/8"OD) x 108"	
33	205435	Grease Seal (#0205435) for EW-Q-709 Hub	
33	103953	Grease Seal #0205435 (NAPA 1744)	
42	613945	Wheel Bolt (#0613945) for EW-Q-709 Hub	
43	1633	Grease Fitting	
	78712	7/8" Rd CR x 7 1/2" Heat Treated Pin for Telescoping Tongue (used 1969-1979)	
	1312	1" Rd CR x 3 1/2" Pin for Telescoping Tongue (used 1969-1979)	
	112D412	1 1/2" Double Extra Strong Pipe Bushing x 4 1/2"	

# Repair Parts List for 10 Ton (Model 1074) Running Gear

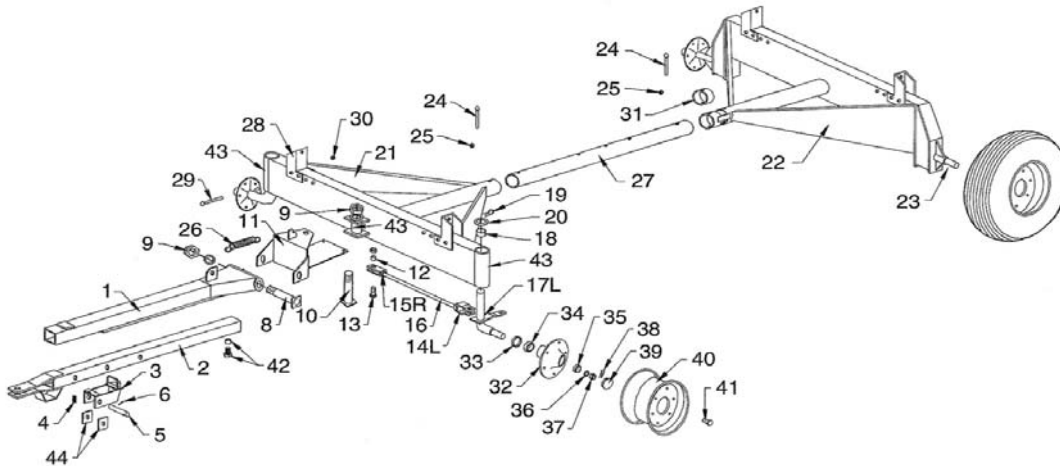

#	Part #	Description
1	OT-610NS	Adj. Tongue Outer Weldment (started in 1995) square latch (Replaces outer tongue weldment prior to 1995 with round latch)
2	IT-610NS	Adj. Tongue Inner Weldment (started in 1995)
3	TL-610NS	Tongue Latch Weldment (started in 1995) square hole (Replaces tongue latch weldment prior to 1995 with round hole)
4	SS-615	Small Latch Spring (1979 to 1994)
4	SS-615NS	Small Latch Spring (started in 1995)
5	LS-610	Latch Pivot Shaft, 1" Dia. x 5 3/4"
6	CP-112	Cotter Pin
7	ST-610	Standard Tongue
7	TT-610	Telescoping Tongue with Spring
8	TB-610	Tongue Bolt, 1 1/4" Rd x 11 3/4"
9	HN-114	1 1/4" Hex Nut
10	KP-610	King Pin Vertical Hitch Bolt, 1 1/4" x 7 3/4"
11	HW-10	Hitch Weldment Complete
12	BB-58	5/8" ID Bronze Bushing for Step Bolt
13	SB-58	Special Step Bolt for Tie Rod Ends
14L	TRE-78L	Tie Rod End, Left (clevis type)
14R	TRE-78R	Tie Rod End, Right (clevis type)
15L	HN-78L	7/8"-14 N/F Nuts L/H for Tie Rods
15R	HN-78R	7/8"-14 N/F Nuts R/H for Tie Rods
16	TR-22316	Tie Rod (7/8" Round x 22 3/16"L)
17L	SA-10L	Bent Spindle, 2" Dia. w/Arm, Left
17R	SA-10R	Bent Spindle, 2" Dia. w/Arm, Right
18	EB-2	End Spindle Bushing (2"ID x 2 3/8"OD)
19	CP-212	Cotter Pin 3/16" x 2 1/2"
20	MB-2	Mach. Bushing (top of spindle) 2"ID
21	FA-10	Running Gear, Front only, less hitch, tongue, tie rods, hubs and spindles (A-Frame)
21	FA-10C	Running Gear, Front only, less wheels, standards, tongue and pole
22	RA-10	Running Gear, Back only, less wheels and standards
23	RS-10	Straight Spindle, 2" Dia. x 14 1/4"
24	MB-345	3/4" x 5" Hex Head Machine Bolt

#	Part #	Description
25	LN-34	3/4" Lock Nut
26	TS-615	Large Tongue Spring
27	CP-312	Coupling Pole, 3 1/2"OD x 72"L
27	CP-312L	Coupling Pole, 3 1/2"OD x 113"L
28	ST-10	Standard
29	MB-38412	3/8" x 4 1/2" Bolt for Standard
30	HN-38	3/8" Hex Nut
31	CL-4	3 1/2" Collar to Coupling Pole
32	106164	Hub, w/cups & bolts, 6 bolt hub (F&H 106164)
32	106164-SSA	Hub & Straight Spindle Assembly Complete
32	106164-RSA	Hub & Bent Spindle Assembly Complete, Right
32	106164-LSA	Hub & Bent Spindle Assembly Complete, Left
33	106166	Grease Seal (#106166) for (F&H 106164)(20044)(AF2936F)
34	105771	Cone, Large 105771 or LM501349
35	104082	Cone, Small 104082 or LM67048
36	104581	Spindle Washer #103289
37	103289	Slotted Spindle Nut #103289
38	CP-316	Cotter Pin
39	103969	Dust Cap
40	WR-158	Wheel Rim, 6 hole, 15" x 8"
40	WR-168	Wheel Rim, 6 hole, 16" x 8"
40	WR-1510	Wheel Rim, 6 hole, 15" x 10"
41	105144	Wheel Bolt (#105144) for (F&H 106164) (9/16"-18)
42	78214-BS	7/8" x 2 1/4" Bolt with spacer
43	1633	Grease Fitting
	78712	7/8" Dia. x 7 1/2" Pin For Telescoping Tongue (used 1969 thru 1979)
	1312	1" Dia. x 3 1/2" Pin for Telescoping Tongue (used 1969 thru 1979)
	3DBL-BB	3" Double Extra Strong Pipe Bushing with Bronze Bushing
44	SB-212	Spacer Blocks
45	TSB-2	Tongue Spring Brackets (2 pcs)
46	105770	Cup, Large (105770) or (LM501310) (not shown)
47	104081	Cup, Small (104081) or (LM67010) (not shown)



### Repair Parts List for 12 Ton Running Gear (Same as 13 Ton Running Gear Except)

#	Part #	Description
17L	SA-12L	L/H Spindle & "U" Assembly, Low Clearance, 2 1/4" Dia.
17L	SA-12L-S	L/H Spindle & "U" Assembly, Standard Clearance, 2 1/4" Dia.
17R	SA-12R	R/H Spindle & "U" Assembly, Low Clearance, 2 1/4" Dia.
17R	SA-12R-S	R/H Spindle & "U" Assembly, Standard Clearance, 2 1/4" Dia.
22	RA-12	Rear Axle Assembly, less rims & standards
23	RS-12	Rear Spindle, 2 1/4" x 16 11/16" (straight)
23	FS-12	Front Spindle, 2 1/4" x 13 1/8" (straight)
32	H-811	Hub, including wheel bolts, cups
32	H-811-B	Hub, w/studs, nuts & cups (faced for brakes)

#	Part #	Description
32	H-811-LSAS	Hub, Spindle & "U" Assembly Complete L/H Standard Clearance
32	H-811-RSAS	Hub, Spindle & "U" Assembly Complete R/H Standard Clearance
32	H-811-LSAL	Hub, Spindle & "U" Assembly Complete L/H Low Clearance
32	H-811-RSAL	Hub, Spindle & "U" Assembly Complete R/H Low Clearance
33	SE-16	Grease Seal
34	25590	Cone, Large Inner
35	25877	Cone, Small Outer
35	25520	Cup, Large Inner
35	25821	Cup, Small Outer
36	SW-12	Spindle Washer (1"ID for CTD Hub H-811) (P-301805)
37	SN-1-1	Slotted Spindle Nut (1" Nut for CTD Hub H-811) (106248)
41	105144	Wheel Bolt

### Repair Parts List for 13 and 14 Ton (Models 1384L, 1384S and 1484) Running Gears

(For Hydraulic Disc or Drum Brake Components, see pages 21 - 23)

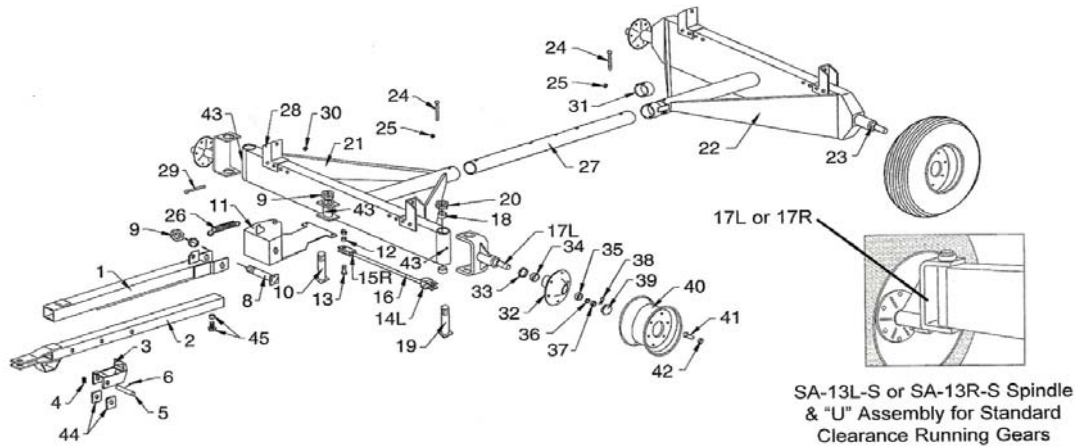

#	Part #	Description
1	OT-1215NS	Adj. Tongue Outer Weldment, square latch (replaces outer tongue prior to 1995 w/round latch)
2	IT-1215NS	Adj. Tongue Inner Weldment
3	TL-1215NS	Tongue Latch Weldment, square hole (replaces tongue latch prior to 1995 w/round hole)
4	SS-615	Small Latch Spring (prior to 1995)
4	SS-615NS	Small Latch Spring (since 1995)
5	LS-1215	Latch Pivot Shaft, 1" Dia. x 7 3/4"
5	LS-1215B	Latch Pivot Shaft, 1" x 8 3/4" (brakes)
6	CP-112	Cotter Pin
7	TT-13	Complete Tongue Assy (telescoping)
8	TB-1215	Tongue Bolt 1 1/4" x 10 1/4"L
9	HN-114	1 1/4" Hex Nut
10	KP-1215	King Pin Bolt 1 1/4" x 9 1/2"
11	HW-1215	Hitch Weldment
12	BB-34	3/4"ID Bronze Bushing for step bolt
13	SB-34	Special Step Bolt for Tie Rod End
14L	TRE-1L	Tie Rod End (clevis type) L/H
14R	TRE-1R	Tie Rod End (clevis type) R/H
15L	HN-1L	1"-14 N/F Hex Nut L/H for Tie Rod
15R	HN-1R	1"-14 N/F Hex Nut R/H for Tie Rod
16	TR-20	Tie Rod, 1" Rod x 19" Long

#	Part #	Description
17L	SA-13L	L/H Spindle & "U" Assy. Low Clearance, 2 1/2" Dia.
17L	SA-13L-S	L/H Spindle & "U" Assy. Standard Clearance, 2 1/2" Dia.
17L	SA-14L	L/H Spindle & "U" Assy. Low Clearance, 2 3/4" Dia.
17R	SA-13R	R/H Spindle & "U" Assy. Low Clearance, 2 1/2" Dia.
17R	SA-13R-S	R/H Spindle & "U" Assy. Standard Clearance, 2 1/2" Dia.
17R	SA-14R	R/H Spindle & "U" Assy. Low Clearance, 2 3/4" Dia.
18	EB-134	End Spindle Bushing, 1 3/4"ID x 2"OD
19	SPB-134	1 3/4"RD CR x 13 1/2" Bolt
20	HN-134	1 3/4" Hex Nut
21	FA-1215	Running Gear, Front only (A-Frame)
21	FA-13C	Running Gear, Front only, less rims, standards, tongue and pole (13T)
21	FA-14C	Running Gear, front only, less rims, standards, tongue and pole (14T)
22	RA-13	Running Gear, Back only, less rims, standards and brakes (13T)
22	RA-14LB	Running Gear, Back only, less rims, standards and brakes (14T)

# **Repair Parts List for 13 and 14 Ton (Models 1384L, 1384S and 1484) Running Gears (continued)**

#	Part #	Description
22	RA-14DC	Running Gear Back only with DISC brakes, less rims and standards (14T) (RA-14)
22	RA-14DR	Running Gear, back only with DRUM brakes, less rims and standards (14T)
23	RS-13	Spindle, Straight 2 1/2" x 17" (rear)
23	FS-13	Spindle, Straight 2 1/2" x 11 1/2" (front)
23	RS-14	Spindle, Straight 2 3/4" x 17" (rear)
23	FS-14	Spindle, Straight 2 3/4" x 11 1/2" (front)
24	MB-346	3/4" x 6" Hex Head Machine Bolt
25	LN-34	3/4" Lock Nut
26	TS-615H	Large Tongue Spring
27	CP-4	Coupling Pole, 4"OD x 74"L
27	CP-4L	Coupling Pole, 4"OD x 112"L
28	ST-1215	Standard
29	MB-126	1/2" x 5 1/2" HHMB for standards
30	HN-12	1/2" Lock Nut
31	CL-412	4 1/2"OD Collar to Coupling Pole
32	H-812-1	Hub w/studs & nuts (or W821 or ARW-8C02)
32	H-812-1B	Hub w/studs & nuts (faced for brakes) H-813 or W819
32	H-812-1SSA	Hub & Straight Spindle Assembly Complete (rear) (13T)
32	H-812-1SSA-14	Hub & Straight Spindle Assembly Complete (rear) (14T)
32	H-812-1LSAL	Hub, Spindle & "U" Assy Complete, L/H Low Clearance, 13 Ton
32	H-812-1LSAL-14	Hub, Spindle & "U" Assy Complete, L/H Low Clearance, 14 Ton
32	H-812-1LSAS	Hub, Spindle & "U" Assy Complete, L/H Std. Clearance, 13 Ton
32	H-812-1RSAL	Hub, Spindle & "U" Assy Complete, R/H Low Clearance, 13 Ton

#	Part #	Description
32	H-812-1RSAL-14	Hub, Spindle & "U" Assy Complete, R/H Low Clearance, 14 Ton
32	H-812-1RSAS	Hub, Spindle & "U" Assy Complete, R/H Std. Clearance, 13 Ton
33	SE-17-25091	Grease Seal (for Wilton Hub W821 or Armstrong Hub 8C02) (CR-25091)
33	SE-17-25100	Grease Seal (for CTD Hub H-812) or (CR-25100)
34	3780	Inner Bearing (large)
35	2790	Outer Bearing (small)
36	SW-1314-78	Spindle Washer (7/8"ID for Hub W821 or ARW 8C02)(P-301804)
36	SW-1314-1	Spindle Washer (1"ID for CTD Hub H-812-1)(P-301805)
37	SN-1-78	Slotted Spindle Nut (7/8" Nut for Hub W821 or ARW 8C02)(P-251705)
37	SN-1-1	Slotted Spindle Nut (1" Nut for CTD Hub H-812-1)(106248)
38	CP-316	Cotter Pin
39	DC-17	Dust Cap
40	WR-16111	Wheel Rim, 8 hole, 16.1" x 11"
40	WR-1610	Wheel Rim, 8 hole, 16" x 10"
40	WR-22.5-8.25	Wheel Rim, 8 hole, 22.5" x 8.25" (.205 Rim)
40	WR-16114	Wheel Rim, 8 hole, 16.1" x 14"
41	WB-41	Wheel Stud (Lug)(P151402) (9/16"-18)
41	WB-41L	Wheel Stud (Lug) (long knurl) for disc brakes
42	WB-40	Wheel Nut (P-201604)
43	1633	Grease Fitting
44	SB-212	Spacer Blocks
45	78214-BS	7/8" x 2 1/4" Bolt w/spacer
46	3720	Inner Cup, (large)
47	2720	Outer Cup, (small)

## Repair Parts List for Hydraulic DISC Brakes for 13 and 14 Ton Running Gears

For Old Style Disc Brake Systems with the corresponding serial numbers...

NOTE: Calipers are mounted to the backside of the rear axle from 1978 to 1995.

Calipers are mounted to the frontside of the rear axle from 1996 to present.

**Model 1384L**  
00831 to 13226

**Model 1384S**  
00831 to 01665

**Model 1484**  
00831 to 02255

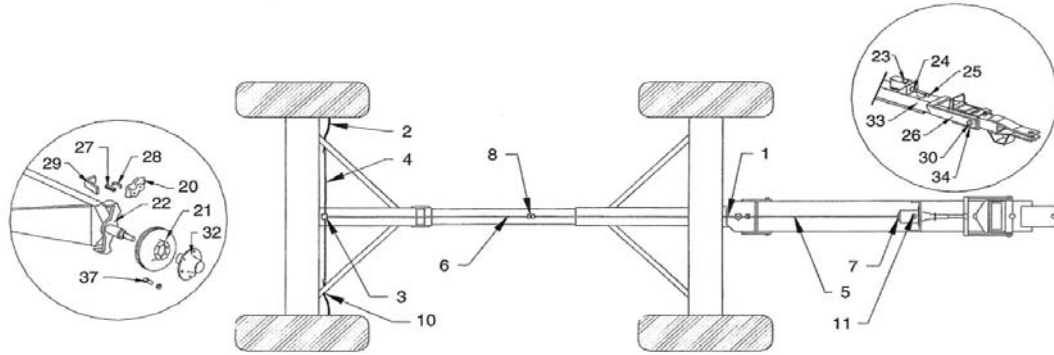

#	Part #	Description
1	RH-2312	Rubber Hose x 23 1/2"
2	RH-13	Rubber Hose x 13"
2	RH-1512	Rubber Hose x 15 1/2" (used 1978 - 1995)
3	AT-1415	Adapter Tee (3 male ends)
4	ST-175	Steel Tubing x 17 1/2"
5	ST-34	Steel Tubing x 34"
6	ST-60	Steel Tubing x 60"
7	6400-4-5	Large Fitting with Copper O-Ring
8	4MJ-2403-4	Nipple (connect 60" brake line to 60" brake line in center of Running Gear) 4MJ-2403-4 Adapter
9	BS-24	Bleeder Stem (attached to brake unit) (1996 - present)
9	BS-1415	Bleeder Stem (attached to brake unit) (1978 - 1995)
10	GR-1415	Grommet
11	RCMC-1415	Replacement Cap for M/Cylinder
12	SKMC-1415	Seal Kit for Master Cylinder
13	WS-24	Wire Spring (anti-rattle) (1996-present)
13	WS-1415	Wire Spring (anti-rattle) (used 1978 to 1995)
14	DOT5-BF	Container DOT 5 Brake Fluid
15	BP-1424	Brake Pad (used 1996 - present)
15	BP-1415L	Brake Pad, Left (1978 - 1995)
15	BP-1415R	Brake Pad, Right (1978 - 1995)
16	SCA-1415	Seal for Caliper Assembly
17	BCA-1415	Boot for Caliper Assembly
18	CCA-1415N	Cup (Piston) for Caliper Assembly (1996-present)
18	CCA-1415	Cup (Piston) for Caliper Assembly (1978 - 1995)
19	BT-1415	Tongue for Disc Brakes (less master cylinder, latch, plunger rod)

#	Part #	Description
20	CA-1424	Caliper Assembly, Left or Right (1996-present)
20	CA-1415L	Caliper Assy, Left (1978 - 1995)
20	CA-1415R	Caliper Assy, Right (1978 - 1995)
21	BD-1314	Brake Disc (1996-present)
21	BD-1415	Brake Disc (1978 - 1995)
21	BC-14	Brake Casting (used 1978-1995)
22	SP-1424L	Support, Left (1996-present)
22	SP-1424R	Support, Right (1996-present)
22	SP-1415L	Support, Left (1978 - 1995)
22	SP-1415R	Support, Right (1978 - 1995)
23	MC-1415	Master Cylinder
24	RB-1415	Rubber Boot on Master Cylinder
25	PR-1415	Plunger Rod for M/Cylinder, 2 pcs
26	BL-1415NS	Latch for Brakes (1996-present)
26	BL-1415	Latch for Brakes (1978 - 1995)
27	RT-1415	Retainer, with Bolt
28	TS-1415	Tension Spring
29	BG-1	Brake Guard
30	LS-1215B	Latch Pivot Shaft, 1" Dia., for tongue flapper and brake latch
31	WB-41L	Wheel Stud (long knurl)
32	H-812-1B	Hub, faced for brakes, with cups, studs and nuts
33	OT-1215BNS	Adjustable Tongue Outer Weldment, new style, square latch
34	SB-214	Spacer Blocks (for brakes)
37	12114-G5	1/2" x 1 1/4" Bolt with Lock Washer Grade 5
38	3MB-4MJ	Small Fitting w/O-Ring (connects 15" rubber hose to Brake Unit) Scott 990 (6400-4-3) Adapter (used 1978 to 1995)

## Repair Parts List for New Style Hydraulic DISC Brakes for 13 and 14 Ton Running Gears

For Running Gears 2004 and newer with New Style DISC Brake Systems corresponding with the beginning Serial Numbers...

NOTE: Calipers are mounted to the frontside of the rear axle.

### Tongue Assembly

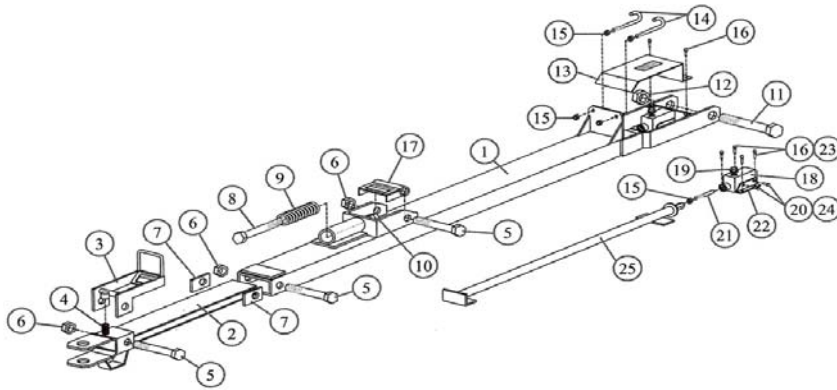

Model	Serial #
1384L	13227
1384S	01666
1484	02256

### Disc Brake Assembly

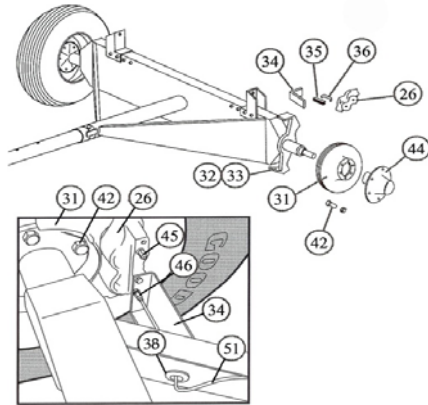

### Brake Line Assembly

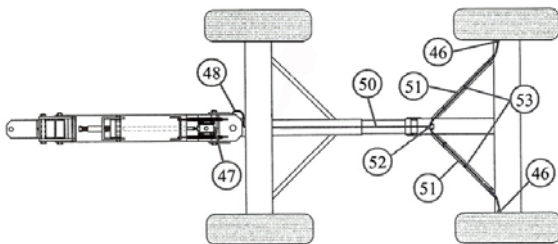

#	Part #	Description
1	OTW-1324	Outer Tongue Weldment (95")
2	ITW-1324	Inner Tongue Weldment
3	TL-1324	Tongue Latch
4	SS-615NS	Small Spring In Latch
5	17G2B	1" x 7" Bolt (Grade 2)
6	1LN	1" Lock Nut
7	BL-58	Brake Limiter
8	19G8B	1" x 9" Bolt (Grade 8)
9	CS-178714	Compression Spring
10	1RN	1" Regular Nut
11	TB-1315	Tongue Bolt
12	HN-114	1 1/4" Hex Nut
13	SMC-1	Shield for Master Cylinder
14	124-JB	1/2" x 4" J-Bolt

#	Part #	Description
15	12-N	1/2" Regular Nut
16	381-FB	3/8" x 1" Flange Bolt
17	BL0L-1	Brake Lock Out Latch
18	MCA-DC1	Master Cylinder Assembly
19	RCMC-1324	Replacement Cap for M/Cyl.
20	383G8B	3/8" x 3" Bolt (Grade 8)
21	PRE-1	Plunger Rod End
22	MBMC-DC2	Mounting Bracket (2 pcs) for M/C
23	38-FN	3/8" Flange Nut
24	38-LN	3/8" Lock Nut
25	PP-1D	Plunger Pole (52 1/2")
26	CA-1424	Brake Caliper Assembly
27	BP-1424	Brake Pad
28	SCA-1415	Seal for Caliper Assembly
29	BCA-1415	Boot for Caliper Assembly
30	CCA-1415N	Cup for Caliper Assembly
31	BD-1314	Brake Disc
32	SP-1324L	Brake Support Arm (L) (SP-1424L)
33	SP-1324R	Brake Support Arm (R) (SP-1424R)
34	BG-1	Brake Guard
35	RT-1415	Retainer with Bolt
36	TS-1415	Tension Spring
37	RB-1415	Rubber Boot on Master Cylinder
38	GR-1415	Rubber Grommet
39	SKMC-1324	Seal Kit for Mstr Cyl. (SKMC-1415)
40	WS-24	Wire Spring (anti-rattle)
41	DOT5-BF	Container DOT 5 Brake Fluid
42	12114-G5	1/2" x 1 1/4" Bolt w/Lock Washer
43	WB-41L	Wheel Stud (Long Knurl) (Disc)
44	H-812-1B	Hub, Faced for Brakes
45	BS-24	Bleeder Stem
46	CF-1324	Fitting for Caliper
47	FMC-125	Fitting for Master Cylinder
48	HH-1425	1/4" x 25" Hydraulic Hose
50	ST-96	3/16" Brake Line x 96" (ST-31696)
51	ST-53	3/16" Brake Line x 53" (ST-31653)
52	10606	Tee
53	SC-1324	Spring Clips

## Repair Parts List for Hydraulic DRUM Brakes for 13 and 14 Ton Running Gears

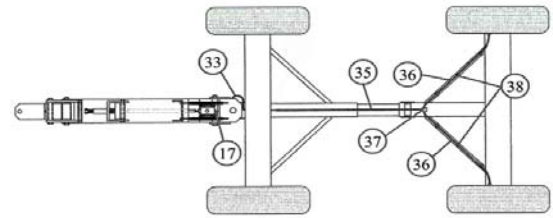
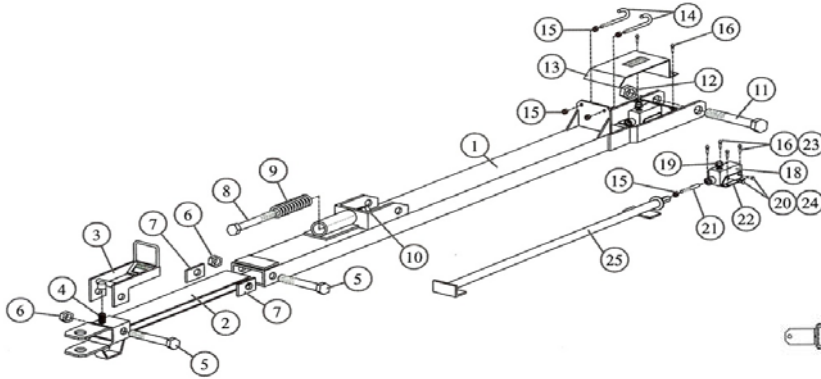

#	Part #	Description
1	OTW-1324	Outer Tongue Weldment (95")
1	OTW-1324-O	Outer Tongue Weldment (79")
2	ITW-1324	Inner Tongue Weldment
3	TL-1324	Tongue Latch
4	SS-615NS	Small Spring In Latch
5	17G2B	1" x 7" Bolt (Grade 2)
6	1LN	1" Lock Nut
7	BL-58	Brake Limiter
8	19G8B	1" x 9" Bolt (Grade 8)
9	CS-178714	Compression Spring
10	1RN	1" Regular Nut
11	TB-1315	Tongue Bolt
12	HN-114	1 1/4" Hex Nut
13	SMC-1	Shield for Master Cylinder
14	124-JB	1/2" x 4" J-Bolt
15	12-N	1/2" Regular Nut
16	381-FB	3/8" x 1" Flange Bolt
17	FMC-015	Fitting for Master Cylinder
17	FMC-015L	Fitting for M/Cyl (old style)(large)
18	MCA-DR1	Master Cylinder Assembly
19	RCMC-1324	Replacement Cap for M/Cyl.

#	Part #	Description
20	383G8B	3/8" x 3" Bolt (Grade 8)
21	PRE-1	Plunger Rod End
22	MBMC-DR2	Mounting Bracket (2 pcs) for M/C
23	38-FN	3/8" Flange Nut
24	38-LN	3/8" Lock Nut
25	PP-1D	Plunger Pole (52 1/2")
25	PP-1	Plunger Pole (36 1/2")
26	RB-1415	Rubber Boot on Master Cylinder
27	GR-1415	Rubber Grommet
28	SKMC-1324	Seal Kit for Mstr Cyl. (SKMC-1415)
29	DOT5-BF	Container DOT 5 Brake Fluid
30	----	-----
31	H-812-1B	Hub, Faced for Brakes
32	BS-24	Bleeder Stem
33	HH-1425	1/4" x 25" Hydraulic Hose
35	ST-96	3/16" Brake Line x 96" (ST-31696)
36	ST-53	3/16" Brake Line x 53" (ST-31653)
37	10606	Tee
38	SC-1324	Spring Clip

#	Part #	Description
1	24737	Back Plate Assembly
2	9739	Front Brake Shoe Assembly
3	9745	Front Shoe Lever
4	9775	Rear Shoe Lever
5	9776	Wheel Cylinder Assembly - Right
6	9777	Wheel Cylinder Assembly - Left
7	23457	Screw & Lockwasher
8	23324	Adjusting Screw
9	23324PN	Pivot Nut
10	9782	Socket - Adjusting Screw
11	9783	Push Rod - Wheel Cylinder
12	9784	Spring Adjusting Screw (Yellow)
13	9785	Spring - Front Lever (Red)
14	9786	Spring - Rear Shoe (Orange)
15	9788	Pin - Shoe Hold Down
16	9789	Cup - Shoe Hold Down
17	9790	Spring - Front Hold Down (Yellow)
18	9791	Spring - Rear Hold Down (Black)
19	9254	Cover Plate - Adjusting Hole
20	7778	Retaining Ring
21	17406	Hex - Locknut 5/16" NC
28	9743	Travel Link
29	7949	Travel Link Bolt - Hex Cap Screw 5/16" NC x 5/8"
30	12560	Pin-Front Shoe - w/o Park Linkage
31	6814	Spring - Front Shoe
32	9797	Plug - Plastic
33	7972	Hex Nut 1/2" NF

### Drum Brake Assembly

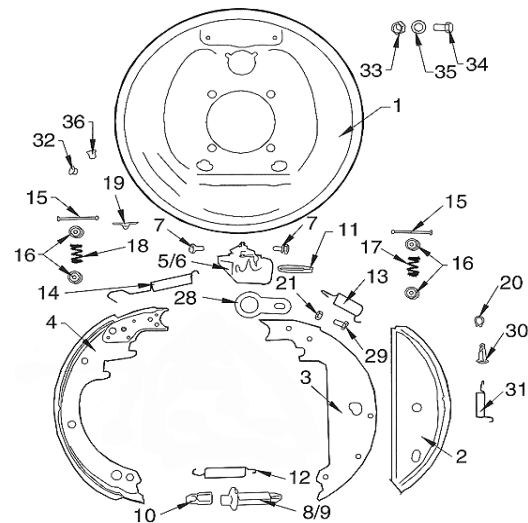

#	Part #	Description
34	7955	Cap Screw 1/2" NF x 1"
35	7937	Lockwasher 1/2"
36	9404	Plug - Plastic
39	15845	Wheel Cyl. Repair Kit - 1 1/8"
40	DRBA-L	Drum Brake Cluster Assy (left)
40	DRBA-R	Drum Brake Cluster Assy (right)
41	1314BD	13" Brake Drum (5 3/4" pilot)



## Repair Parts List for 15 Ton (Model 1592) Running Gear

(For Hydraulic Disc or Drum Brake Components, see pages 25 - 27)

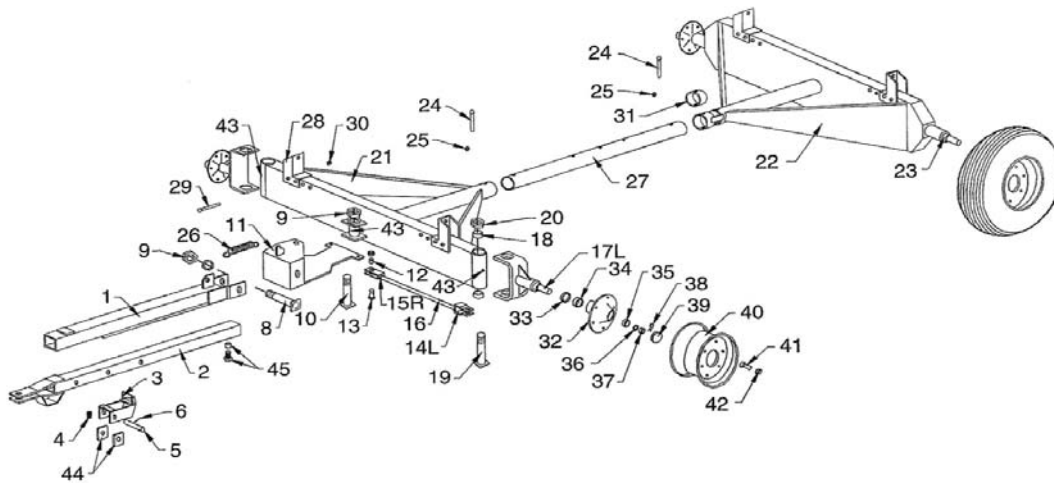

#	Part #	Description
1	OT-1215NS	Adj. Tongue Outer Weldment, square latch (replaces outer tongue prior to 1995 w/round latch)
2	IT-1215NS	Adj. Tongue Inner Weldment
3	TL-1215NS	Tongue Latch Weldment, square hole (replaces tongue latch prior to 1995 w/round hole)
4	SS-615	Small Spring in Latch (prior to 1995)
4	SS-615NS	Small Spring in Latch (since 1995)
5	LS-1215	Latch Pivot Shaft, 1" Dia. x 7 3/4"
6	CP-112	Cotter Pin
7	TT-13	Complete Tongue Assy (telescoping)
8	TB-1215	Tongue Bolt 1 1/4" x 10 1/4"
9	HN-114	1 1/4" Hex Nut
10	KP-1215	King Pin Vertical Hitch Bolt 1 1/4" x 9 1/2"
11	HW-1215	Hitch Weldment Complete (2005 and older) (single spring)
11	HW-1315	Hitch Weldment Complete (2005 and newer) (double spring)
12	BB-34	3/4"ID Bronze Bushing for step bolt
13	SB-34	Special Step Bolt for Tie Rod End
14L	TRE-1L	Tie Rod End, L/H Thread (clevis)
14R	TRE-1R	Tie Rod End, R/H Thread (clevis)
15L	HN-1L	1"-14 N/F Hex Nut L/H for Tie Rod
15R	HN-1R	1"-14 N/F Hex Nut R/H for Tie Rod
16	TR-20	Tie Rod, 1" Rod x 19" Long
17L	SA-15L	L/H Spindle & "U" Assy (3" Dia.)
17R	SA-15R	R/H Spindle & "U" Assy (3" Dia.)
18	EB-134	End Spindle Bushing 1 3/4"ID x 2"OD
19	SPB-134	1 3/4"RD CR x 13 1/2" Bolt
20	HN-134	1 3/4" Hex Nut
21	FA-1215	Running Gear, Front Only (A-Frame)

#	Part #	Description
22	RA-15	Rear Axle Assy. (incl. Brakes) less Rims, Standards, Hoses & Piping
23	RS-15	Rear Spindle 3" Dia. X 20 1/2" Strt.
24	MB-346	3/4" x 6" Hex Head Machine Bolt
25	LN-34	3/4" Lock Nut
26	TS-615H	Large Tongue Spring
27	CP-4	Coupling Pole, 3 1/2" x 74" (4"OD)
27	CP-4L	Coupling Pole, 3 1/2" x 112" (4"OD)
28	ST-1215	Standards
29	MB-126	1/2" x 5 1/2" HHMB for standards
30	HN-12	1/2" Lock Nut
31	CL-412	4 1/2"OD Collar to coupling pole
32	107751	Hub, including Lug Bolts, Cups
32	107751-B	Hub (faced for brakes) incl. Lug Bolts, Cups
32	107751-RSA	Hub, Spindle & "U" Assy. R/H, Complete
32	107751-LSA	Hub, Spindle & "U" Assy. L/H, Complete
33	29968	Grease Seal
34	387-AS	Inner Cone, (large)
35	105771	Outer Cone, (small)
36	106247	Spindle Washer
37	106248	Slotted Spindle Nut
38	CP-316	Cotter Pin
39	103213	Dust Cap
40	WR-22.5-13.5	Wheel Rim, 8 hole, 22.5x13.5
40	WR-16116	Wheel Rim, 8 hole, 16.1x16
41	WB-15	Wheel Stud
42	WN-15F	Wheel Nut (flat)
42	WN-15	Wheel Nut (tapered)
43	1633	Grease Fitting
44	SB-212	Spacer Blocks
45	78214-BS	7/8" x 2 1/4" Bolt with spacer
46	382A	Inner Cup, (large) (not shown)
47	105770	Outer Cup, (small) (LM501310) (not shown)

## Repair Parts List for Hydraulic DISC Brakes for 15 Ton Running Gears

For Old Style Disc Brake Systems with serial numbers 00831 through 03668

NOTE: Calipers are mounted to the backside of the rear axle from 1978 to 1995.

Calipers are mounted to the frontside of the rear axle from 1996 to present.

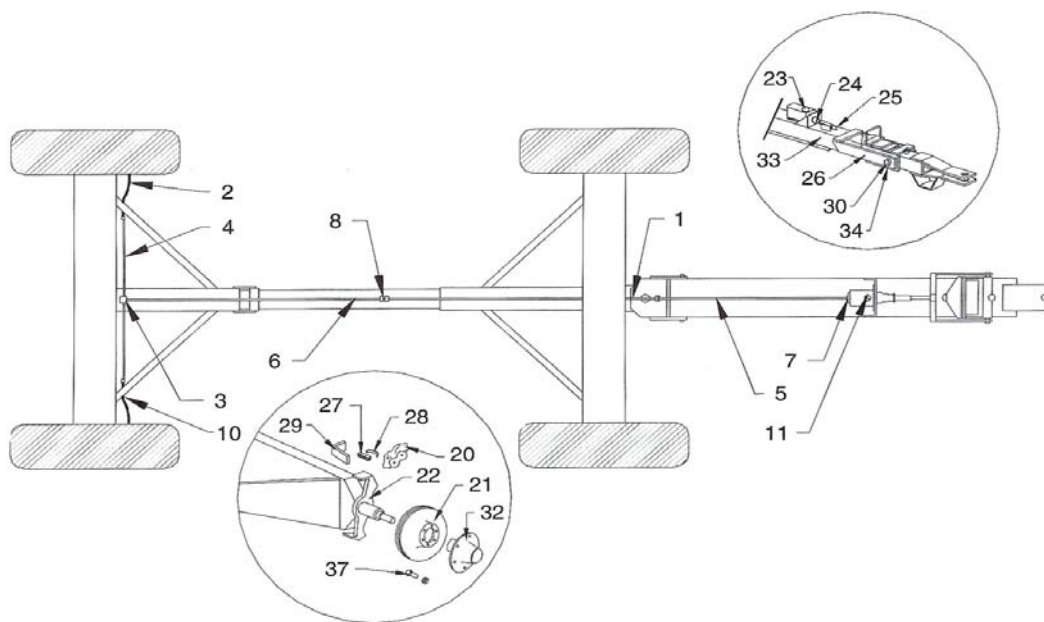

#	Part #	Description
1	RH-2312	Rubber Hose x 23 1/2"
2	RH-13	Rubber Hose x 13"
2	RH-1512	Rubber Hose x 15 1/2" (1978-1995)
3	AT-1415	Adapter Tee (3 male ends)
4	ST-205	Steel Tubing x 20 1/2"
5	ST-34	Steel Tubing x 34"
6	ST-60	Steel Tubing x 60"
7	6400-4-5	Large Fitting with Copper O-Ring
8	4MJ-2403-4	Nipple (connect 60" brake line to 60" brake line in center of Running Gear) 4MJ-2403-4 Adapter
9	BS-24	Bleeder Stem (attached to brake unit) (1996 - present)
9	BS-1415	Bleeder Stem (attached to brake unit) (1978 - 1995)
10	GR-1415	Grommet
11	RCMC-1415	Replacement Cap for M/Cylinder
12	SKMC-1415	Seal Kit for Master Cylinder
13	WS-24	Wire Spring (anti-rattle) (1996-present)
13	WS-1415	Wire Spring (anti-rattle) (1978 to 1995)
14	DOT5-BF	Container DOT 5 Brake Fluid
15	BP-1424	Brake Pad (used 1996 - present)
15	BP-1415L	Brake Pad, Left (1978 - 1995)
15	BP-1415R	Brake Pad, Right (1978 - 1995)
16	SCA-1415	Seal for Caliper Assembly
17	BCA-1415	Boot for Caliper Assembly
18	CCA-1415N	Cup (Piston) for Caliper Assembly (1996-present)
18	CCA-1415	Cup (Piston) for Caliper Assembly (1978 - 1995)
19	BT-1415	Tongue for Disc Brakes (less master cylinder, latch, plunger rod)

#	Part #	Description
20	CA-1424	Caliper Assembly, Left or Right (1996-present)
20	CA-1415L	Caliper Assembly, Left (1978 - 1995)
20	CA-1415R	Caliper Assembly, Right (1978 - 1995)
21	BD-15	Brake Disc (1996-present)
21	BD-1415	Brake Disc (1978 - 1995)
21	BC-15	Brake Casting (used 1978-1995)
22	SP-1424L	Support, Left (1996-present)
22	SP-1424R	Support, Right (1996-present)
22	SP-1415L	Support, Left (1978 - 1995)
22	SP-1415R	Support, Right (1978 - 1995)
23	MC-1415	Master Cylinder
24	RB-1415	Rubber Boot on Master Cylinder
25	PR-1415	Plunger Rod for M/Cylinder (2 pcs.)
26	BL-1415NS	Latch for Brakes (1996-present)
26	BL-1415	Latch for Brakes (1978 - 1995)
27	RT-1415	Retainer, with Bolt
28	TS-1415	Tension Spring
29	BG-1	Brake Guard
30	LS-1215B	Latch Pivot Shaft, 1" Dia., for tongue flapper and brake latch
32	107751-B	Hub, faced for brakes, with cups, studs and nuts
33	OT-1215BNS	Adjustable Tongue Outer Weldment, new style, square latch
34	SB-214	Spacer Blocks (for brakes)
37	12114-G5	1/2" x 1 1/4" Bolt with Lock Washer Grade 5
38	3MB-4MJ	Small Fitting w/O-Ring (connects 15" rubber hose to Brake Unit) Scott 990 (6400-4-3) Adapter (Used 1978 to

## Repair Parts List for New Style Hydraulic DISC Brakes for 15 Ton Running Gear

For Running Gears 2004 and newer with New Style DISC Brake Systems beginning with Serial Number 03669

NOTE: Calipers are mounted to the frontside of the rear axle.

### Tongue Assembly

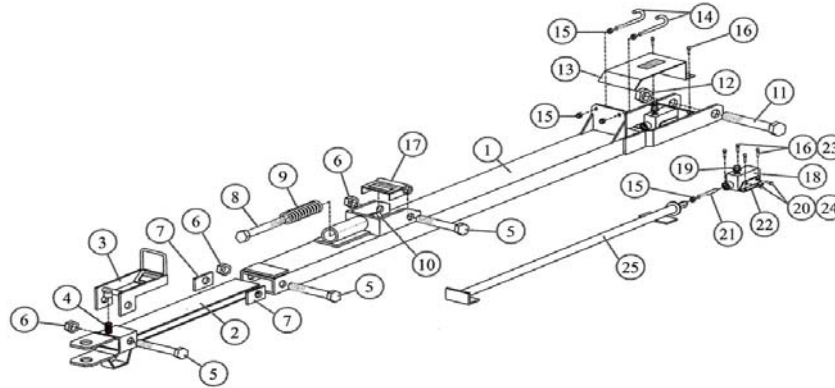

### Disc Brake Assembly

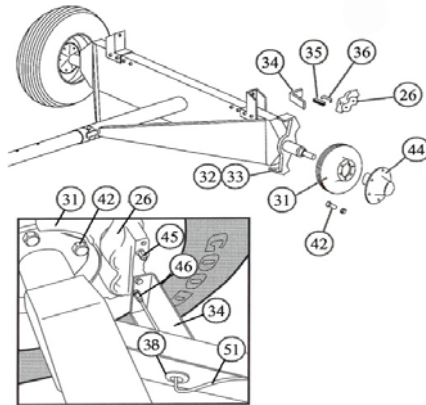

### Brake Line Assembly

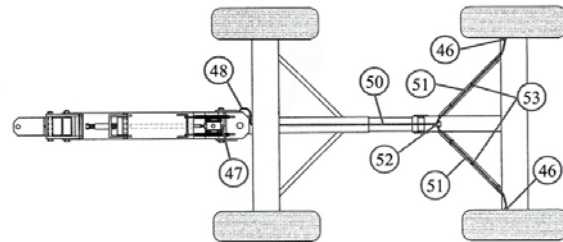

#	Part #	Description
1	OTW-1324	Outer Tongue Weldment (95")
2	ITW-1324	Inner Tongue Weldment
3	TL-1324	Tongue Latch
4	SS-615NS	Small Spring In Latch
5	17G2B	1" x 7" Bolt (Grade 2)
6	1LN	1" Lock Nut
7	BL-58	Brake Limiter
8	19G8B	1" x 9" Bolt (Grade 8)
9	CS-178714	Compression Spring
10	1RN	1" Regular Nut
11	TB-1315	Tongue Bolt
12	HN-114	1 1/4" Hex Nut
13	SMC-1	Shield for Master Cylinder
14	124-JB	1/2" x 4" J-Bolt
15	12-N	1/2" Regular Nut
16	381-FB	3/8" x 1" Flange Bolt
17	BLOL-1	Brake Lock Out Latch
18	MCA-DC1	Master Cylinder Assembly
19	RCMC-1324	Replacement Cap for M/Cyl.
20	383G8B	3/8" x 3" Bolt (Grade 8)
21	PRE-1	Plunger Rod End
22	MBMC-DC2	Mounting Bracket (2 pcs) for M/C
23	38-FN	3/8" Flange Nut
24	38-LN	3/8" Lock Nut
25	PP-1D	Plunger Pole (52 1/2")
26	CA-1424	Brake Caliper Assembly

#	Part #	Description
27	BP-1424	Brake Pad
28	SCA-1415	Seal for Caliper Assembly
29	BCA-1415	Boot for Caliper Assembly
30	CCA-1415N	Cup for Caliper Assembly
31	BD-15	Brake Disc
32	SP-1324L	Brake Support Arm (L) (SP-1424L)
33	SP-1324R	Brake Support Arm (R) (SP-1424R)
34	BG-1	Brake Guard
35	RT-1415	Retainer with Bolt
36	TS-1415	Tension Spring
37	RB-1415	Rubber Boot on Master Cylinder
38	GR-1415	Rubber Grommet
39	SKMC-1324	Seal Kit for Mstr Cyl. (SKMC-1415)
40	WS-24	Wire Spring (anti-rattle)
41	DOT5-BF	Container DOT 5 Brake Fluid
42	12114-G5	1/2" x 1 1/4" Bolt w/Lock Washer
44	107751-B	Hub, Faced for Brakes
45	BS-24	Bleeder Stem
46	CF-1324	Fitting for Caliper
47	FMC-125	Fitting for Master Cylinder
48	HH-1425	1/4" x 25" Hydraulic Hose
50	ST-96	3/16" Brake Line x 96" (ST-31696)
51	ST-53	3/16" Brake Line x 53" (ST-31653)
52	10606	Tee
53	SC-1324	Spring Clips

## Repair Parts List for Hydraulic DRUM Brakes for 15 Ton Running Gears

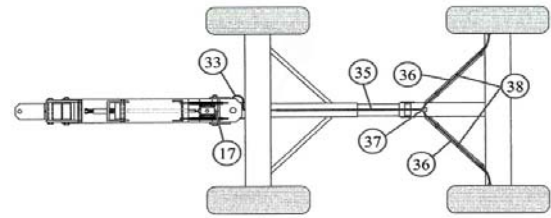
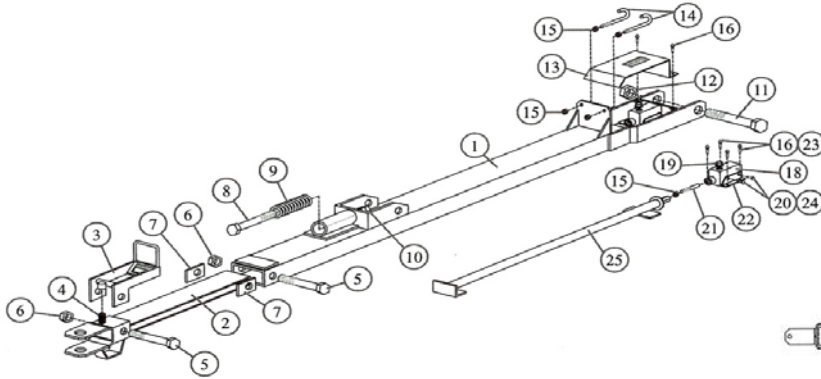

#	Part #	Description
1	OTW-1324	Outer Tongue Weldment (95")
1	OTW-1324-O	Outer Tongue Weldment (79")
2	ITW-1324	Inner Tongue Weldment
3	TL-1324	Tongue Latch
4	SS-615NS	Small Spring In Latch
5	17G2B	1" x 7" Bolt (Grade 2)
6	1LN	1" Lock Nut
7	BL-58	Brake Limiter
8	19G8B	1" x 9" Bolt (Grade 8)
9	CS-178714	Compression Spring
10	1RN	1" Regular Nut
11	TB-1315	Tongue Bolt
12	HN-114	1 1/4" Hex Nut
13	SMC-1	Shield for Master Cylinder
14	124-JB	1/2" x 4" J-Bolt
15	12-N	1/2" Regular Nut
16	381-FB	3/8" x 1" Flange Bolt
17	FMC-015	Fitting for Master Cylinder
17	FMC-015L	Fitting for M/Cyl (old style)(large)
18	MCA-DR1	Master Cylinder Assembly
19	RCMC-1324	Replacement Cap for M/Cyl.

#	Part #	Description
20	383G8B	3/8" x 3" Bolt (Grade 8)
21	PRE-1	Plunger Rod End
22	MBMC-DR2	Mounting Bracket (2 pcs) for M/C
23	38-FN	3/8" Flange Nut
24	38-LN	3/8" Lock Nut
25	PP-1D	Plunger Pole (52 1/2")
25	PP-1	Plunger Pole (36 1/2")
26	RB-1415	Rubber Boot on Master Cylinder
27	GR-1415	Rubber Grommet
28	SKMC-1324	Seal Kit for Mstr Cyl. (SKMC-1415)
29	DOT5-BF	Container DOT 5 Brake Fluid
31	107751-B	Hub, Faced for Brakes
32	BS-24	Bleeder Stem
33	HH-1425	1/4" x 25" Hydraulic Hose
35	ST-96	3/16" Brake Line x 96" (ST-31696)
36	ST-53	3/16" Brake Line x 53" (ST-31653)
37	10606	Tee
38	SC-1324	Spring Clip

#	Part #	Description
1	24737	Back Plate Assembly
2	9739	Front Brake Shoe Assembly
3	9745	Front Shoe Lever
4	9775	Rear Shoe Lever
5	9776	Wheel Cylinder Assembly - Right
6	9777	Wheel Cylinder Assembly - Left
7	23457	Screw & Lockwasher
8	23324	Adjusting Screw
9	23324PN	Pivot Nut
10	9782	Socket - Adjusting Screw
11	9783	Push Rod - Wheel Cylinder
12	9784	Spring Adjusting Screw (Yellow)
13	9785	Spring - Front Lever (Red)
14	9786	Spring - Rear Shoe (Orange)
15	9788	Pin - Shoe Hold Down
16	9789	Cup - Shoe Hold Down
17	9790	Spring - Front Hold Down (Yellow)
18	9791	Spring - Rear Hold Down (Black)
19	9254	Cover Plate - Adjusting Hole
20	7778	Retaining Ring
21	17406	Hex - Locknut 5/16" NC
28	9743	Travel Link
29	7949	Travel Link Bolt - Hex Cap Screw 5/16" NC x 5/8"
30	12560	Pin-Front Shoe - w/o Park Linkage
31	6814	Spring - Front Shoe
32	9797	Plug - Plastic
33	7972	Hex Nut 1/2" NF

### Drum Brake Assembly

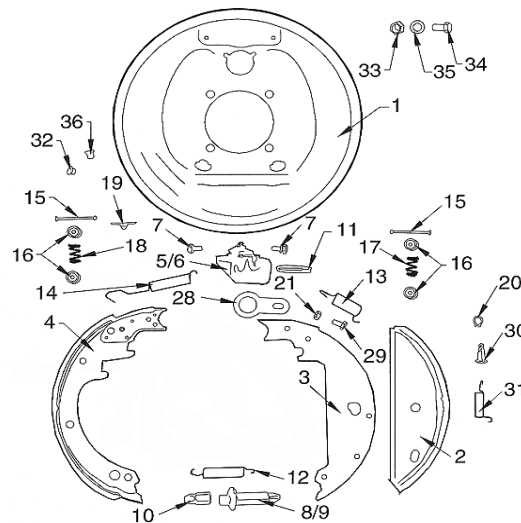

#	Part #	Description
34	7955	Cap Screw 1/2" NF x 1"
35	7937	Lockwasher 1/2"
36	9404	Plug - Plastic
39	15845	Wheel Cyl. Repair Kit - 1 1/8"
40	DRBA-L	Drum Brake Cluster Assy (left)
40	DRBA-R	Drum Brake Cluster Assy (right)
41	15BD	13" Brake Drum (4 1/2" pilot)

## Repair Parts List for Model 1688 (16 Ton) Running Gears

(For Hydraulic Drum Brake Components, see page 29)

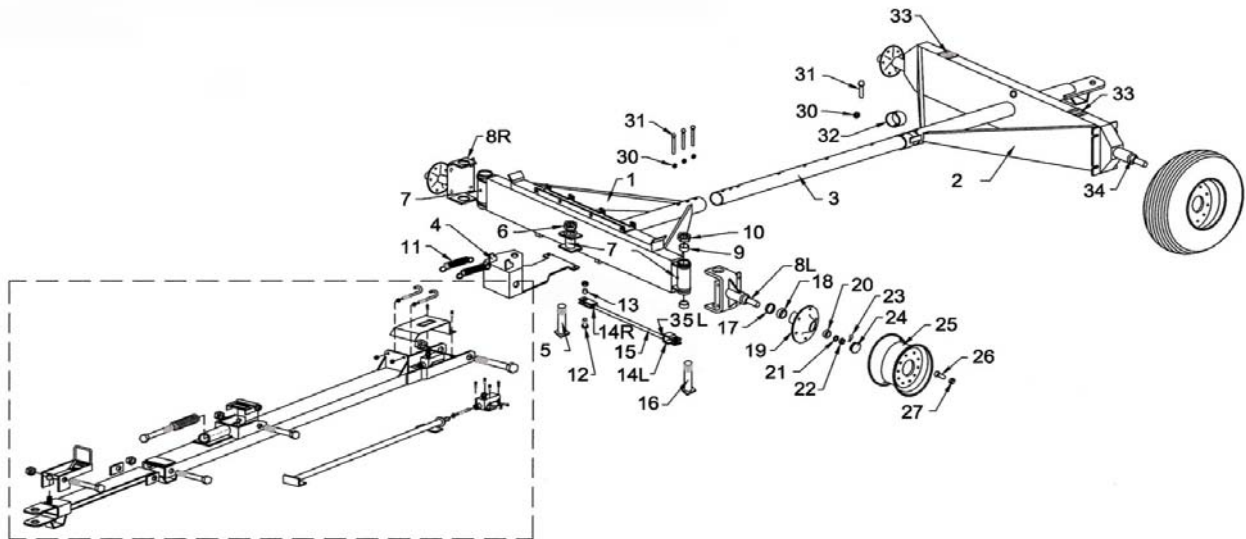

#	Part #	Description
1	FA-16	Front Axle Weldment (A-Frame Only) Less Wheels and Tongue
2	RA-16	Rear Axle Weldment (A-Frame Only) Less Wheels and Brakes
3	CP-16	Couple Pole with Rear Hitch
4	HW-16	Hitch Weldment (for two spring connections)
5	KP-1215	King Pin
6	HN-114	1 1/4" Hex Nut
7	1633	Grease Fitting
8L	SA-16L	Spindle and "U" Assembly (left)
8R	SA-16R	Spindle and "U" Assembly (right)
9	EB-134	1 3/4" Bronze Bushing
10	HN-134	1 3/4" Hex Nut
11	TS-615	Tongue Spring
12	SB-34	3/4" Step Bolt
13	BB-34	3/4" Bronze Bushing
14L	TRE-1L	Tie Rod End (L/H)
14R	TRE-1R	Tie Rod End (R/H)
15	TR-20	Tie Rod, 1" diameter
16	SPB-134	Spindle Bolt, 1 3/4" x 13 1/2"
17	29968	Grease Seal
18	387-AS	Inner Bearing (large)

#	Part #	Description
19	107751	Hub, Including Lug Bolts, Nuts and Races (for Non-Brake Wheel)
19	107751-B	Hub, Faced for Brakes, Including Nuts and Races (Brakes)
20	105771	Outer Bearing (small)
21	106247	Spindle Washer
22	106248	Slotted Spindle Nut
23	CP-316	Cotter Pin
24	103213	Dust Cap
25	WR-22.5-13.5	Wheel Rim, 8 hole, 22.5x13.5
26	WB-15	Wheel Stud
27	WN-15F	Wheel Nut
28	382A	Inner Cup (large)
29	105770	Outer Cup (small)
30	1LN	1" Lock Nut
31	1634G5B	1" x 6 3/4" Grade 5 Bolt
32	CL-412	Collar to Coupling Pole
33	212314-RP	2 1/2" x 3 1/4" Rubber Plate
34	RS-16	3" Rear Spindle, Straight
35L	HN-1L	1"-14 N/F Hex Nut L/H for Tie Rod
35R	HN-1R	1"-14 N/F Hex Nut R/H for Tie Rod



## Repair Parts List for Hydraulic DRUM Brakes for 16 Ton Running Gears

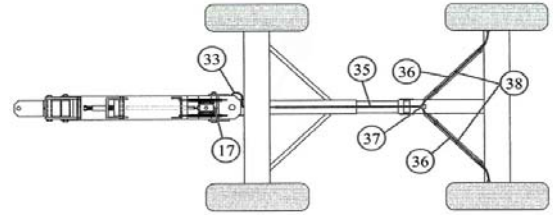
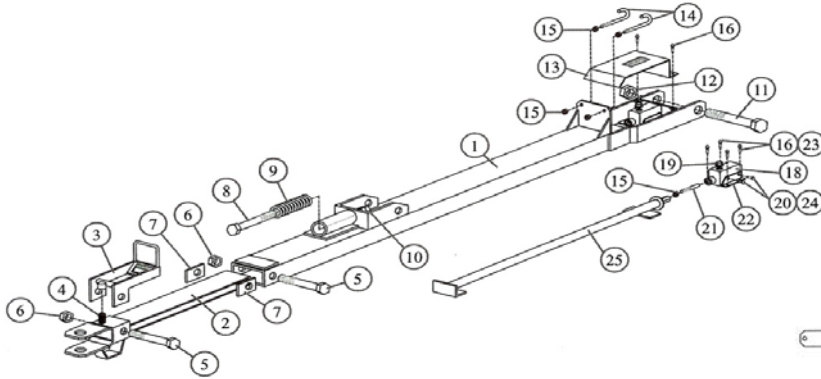

#	Part #	Description
1	OTW-1324	Outer Tongue Weldment (95")
2	ITW-1324	Inner Tongue Weldment
3	TL-1324	Tongue Latch
4	SS-615NS	Small Spring In Latch
5	17G2B	1" x 7" Bolt (Grade 2)
6	1LN	1" Lock Nut
7	BL-58	Brake Limiter
8	19G8B	1" x 9" Bolt (Grade 8)
9	CS-178714	Compression Spring
10	1RN	1" Regular Nut
11	TB-1315	Tongue Bolt
12	HN-114	1 1/4" Hex Nut
13	SMC-1	Shield for Master Cylinder
14	124-JB	1/2" x 4" J-Bolt
15	12-N	1/2" Regular Nut
16	381-FB	3/8" x 1" Flange Bolt
17	FMC-015	Fitting for Master Cylinder
18	MCA-DR1	Master Cylinder Assembly
19	RCMC-1324	Replacement Cap for M/Cyl.

#	Part #	Description
20	383G8B	3/8" x 3" Bolt (Grade 8)
21	PRE-1	Plunger Rod End
22	MBMC-DR2	Mounting Bracket (2 pcs) for M/C
23	38-FN	3/8" Flange Nut
24	38-LN	3/8" Lock Nut
25	PP-1D	Plunger Pole (52 1/2")
26	RB-1415	Rubber Boot on Master Cylinder
27	GR-1415	Rubber Grommet
28	SKMC-1324	Seal Kit for Mstr Cyl. (SKMC-1415)
29	DOT5-BF	Container DOT 5 Brake Fluid
31	107751-B	Hub, Faced for Brakes
32	BS-24	Bleeder Stem
33	HH-1425	1/4" x 25" Hydraulic Hose
35	ST-96	3/16" Brake Line x 96" (ST-31696)
36	ST-53	3/16" Brake Line x 53" (ST-31653)
37	10606	Tee
38	SC-1324	Spring Clip

#	Part #	Description
1	24737	Back Plate Assembly
2	9739	Front Brake Shoe Assembly
3	9745	Front Shoe Lever
4	9775	Rear Shoe Lever
5	9776	Wheel Cylinder Assembly - Right
6	9777	Wheel Cylinder Assembly - Left
7	23457	Screw & Lockwasher
8	23324	Adjusting Screw
9	23324PN	Pivot Nut
10	9782	Socket - Adjusting Screw
11	9783	Push Rod - Wheel Cylinder
12	9784	Spring Adjusting Screw (Yellow)
13	9785	Spring - Front Lever (Red)
14	9786	Spring - Rear Shoe (Orange)
15	9788	Pin - Shoe Hold Down
16	9789	Cup - Shoe Hold Down
17	9790	Spring - Front Hold Down (Yellow)
18	9791	Spring - Rear Hold Down (Black)
19	9254	Cover Plate - Adjusting Hole
20	7778	Retaining Ring
21	17406	Hex - Locknut 5/16" NC
28	9743	Travel Link
29	7949	Travel Link Bolt - Hex Cap Screw 5/16" NC x 5/8"
30	12560	Pin-Front Shoe - w/o Park Linkage
31	6814	Spring - Front Shoe
32	9797	Plug - Plastic
33	7972	Hex Nut 1/2" NF

### Drum Brake Assembly

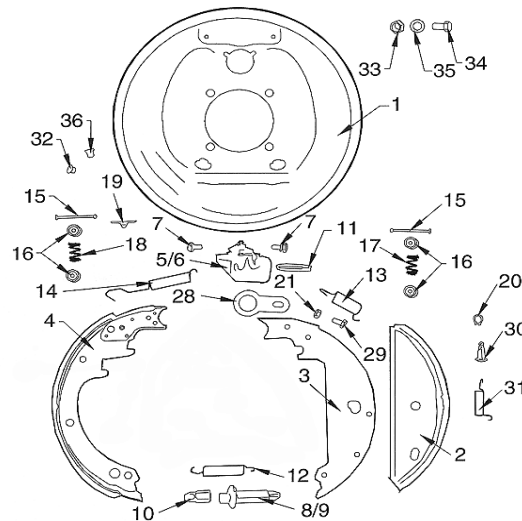

#	Part #	Description
34	7955	Cap Screw 1/2" NF x 1"
35	7937	Lockwasher 1/2"
36	9404	Plug - Plastic
39	15845	Wheel Cyl. Repair Kit - 1 1/8"
40	DRBA-L	Drum Brake Cluster Assy (left)
40	DRBA-R	Drum Brake Cluster Assy (right)
41	15BD	13" Brake Drum (4 1/2" pilot)



# Repair Parts List for 24 Ton (Model 2494) Running Gear (used on Models 650SD and 750SD Wagons)

(For Hydraulic Disc Brake Components, see pages 31 - 32)

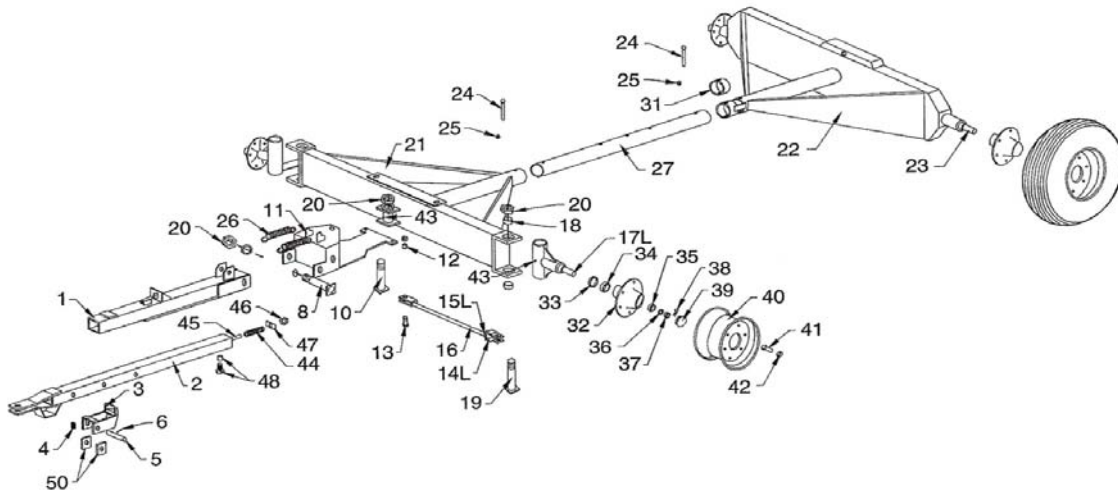

#	Part #	Description
1	OT-24	Adj. Tongue Outer Weldment
2	IT-24	Adj. Tongue Inner Weldment
3	TL-24	Tongue Latch Weldment
4	SS-615	Small Spring in Latch (1993-1995)
4	SS-615NS	Small Spring in Latch (1996-Pres.)
5	LS-24	Latch Pivot Shaft 1 1/4" Dia. x 9 1/2"
6	14134EX	1/4" x 1 3/4" Ex Pan Pin
7	TC-24	Tongue for Hyd. Brakes (less M. Cyl, Latch, Rod, Comm. Spring)
8	TB-24	Tongue Bolt 1 3/4" x 10 1/2"
10	HB-24	King Pin Vertical Hitch Bolt 1 3/4" x 10 1/2"
11	HW-24	Hitch Weldment Complete
12	BB-34	3/4"ID Bronze Bushing for step bolt (1993-1994)
12	BB-78	7/8"ID Bronze Bushing for step bolt (1995-pres.)
13	SB-34	3/4" Special Step Bolt for Tie Rod Ends (1993-1994)
13	SB-78	7/8" Special Step Bolt for Tie Rod Ends (1995-pres.)
14L	TRE-1L	1" Tie Rod End, Left (clevis type) (1993-1994)
14R	TRE-1R	1" Tie Rod End, Right (clevis type) (1993-1994)
14L	TRE-114L	1 1/4" Tie Rod End, Left (clevis type) (1995-pres.)
14R	TRE-114R	1 1/4" Tie Rod End, Right (clevis type) (1995-pres.)
15L	HN-1L	1"-14 N/F Hex Nut for Tie Rod L/H
15R	HN-1R	1"-14 N/F Hex Nut for Tie Rod R/H
15L	HN-114L	1 1/4" Hex Nut, L/H
15R	HN-114R	1 1/4" Hex Nut, R/H
16	TR-24	Tie Rod, 1" x 24" Long (1993-1994)
16	TR-24A	Tie Rod, 1 1/4" x 24" L (1995-pres.)
17L	SA-24L	L/H Spindle & Spool Assy. 3 3/8"
17R	SA-24R	R/H Spindle & Spool Assy. 3 3/8"
18	EB-134	End Spindle Bushing, 1 3/4"ID

#	Part #	Description
19	SPB-134	1 3/4" Rd CR x 13 1/2" Bolt to front spindle
20	HN-134	1 3/4" Hex Nut
21	FA-24	Running Gear, Front only (A-Frame)
21	FA-24C	Running Gear, Front only (less brakes) less Rims, Tongue, Hose,
22	RA-24	Running Gear, Rear only (incl. Disc brakes) less Rims, Hose, Rocking Bolster
23	SS-33816	Spindle, Straight 3 3/8" x 16"
24	MB-78634	7/8" x 6 3/4" HHMB
25	LN-78	7/8" Lock Nut
26	TS-615H	Large Tongue Spring
27	CP-4H	Coupling Pole, 3 1/2" x 126" 4"OD
31	HCL-412	4 1/2"OD Collar to Coupling Pole
32	W-871B	873 Hub (faced) w/studs & nuts (11.25 bolt circle, 8.785 pilot)
33	CR-33772	Seal (4 5/8"OD)(946275)
34	4T-33275	Large Bearing (910398) (33275)
35	4T-460	Small Bearing (910334) (BK460)
36	913632	Spindle Washer
37	912969	Slotted Spindle Nut
38	905944	Cotter Pin
39	909983	Dust Cap
40	WR-22.5-13	Wheel Rim, 10 hole, 22.5x13
41	913564	Wheel Studs, 3/4"-16
42	913571	Wheel Nuts, 3/4"-16
43	1633	Grease Fitting
44	CS-24	Brake Tongue Compress. Spring
45	MB-10	1" x 10" HHMB
46	HLN-1	1" Hex Lock Nut
47	SB-78-1	7/8" x 2 5/8" x 4 5/8" Spring Block
48	782BN	7/8" x 2" Bolt with Nut
49	58134-G5	5/8" x 1 3/4" Bolt w/Lock Nuts Gr 5
50	SB-312	3 1/2" Spacer Block
51	910397	Inner Cup, (large) (not shown)
52	910332	Outer Cup, (small) (not shown)

## Repair Parts List for Old Style Hydraulic DISC Brakes for 24 Ton (Model 2494) Running Gear

For 24 Ton Running Gears with Serial Number 01001 through 01649

NOTE: Calipers are mounted to the backside of the rear axle from 1993 to 1995.

Calipers are mounted to the frontside of the rear axle from 1996 to present.

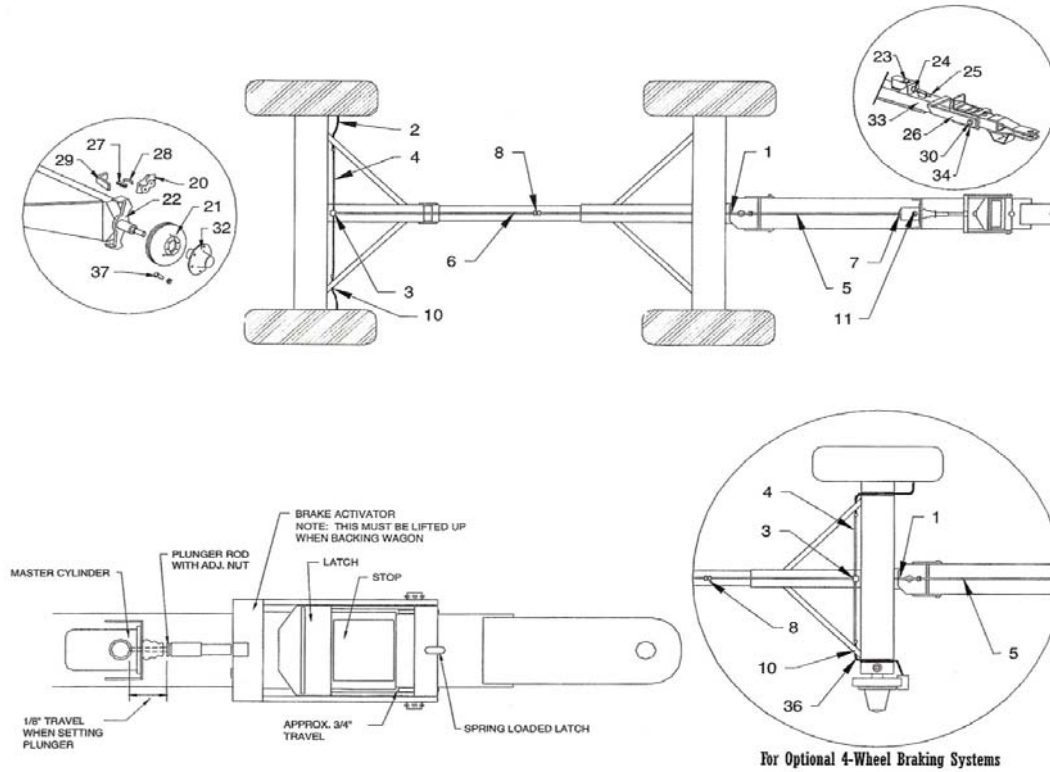

For Optional 4-Wheel Braking Systems

#	Part #	Description
1	RH-2312	Rubber Hose x 23 1/2"
1	RH-2312S	Rubber Hose x 23 1/2" (4-whl disc)
2	RH-13	Rubber Hose x 13"
2	RH-1512	Rubber Hose x 15 1/2" (1993-1995)
3	AT-1415	Adapter Tee (3 male ends)
4	ST-25	Steel Tubing x 25"
5	ST-34	Steel Tubing x 34"
6	ST-63	Steel Tubing x 63" (for 24T w/ 650SD)
6	ST-73	Steel Tubing x 73" (for 24T w/ 750SD)
7	6400-4-5	Large Fitting with Copper O-Ring
8	4MJ-2403-4	Nipple (connects brake lines in center of Running Gear) 4MJ-2403-4 Adapter
9	BS-24	Bleeder Stem (attached to brake unit) (1996 - present)
9	BS-1415	Bleeder Stem (attached to brake unit) (1993 - 1995)
10	GR-1415	Grommet
11	RCMC-1415	Replacement Cap for M/Cylinder
12	SKMC-1415	Seal Kit for Master Cylinder
13	WS-24	Wire Spring (anti-rattle) (1996-present)
13	WS-1415	Wire Spring (anti-rattle) (1993 to 1995)
14	DOT5-BF	Container DOT 5 Brake Fluid
15	BP-24	Brake Pad (used 1996 - present)
15	BP-1415L	Brake Pad, Left (1993 - 1995)
15	BP-1415R	Brake Pad, Right (1993 - 1995)
16	SCA-1415	Seal for Caliper Assembly
17	BCA-1415	Boot for Caliper Assembly
18	CCA-1415N	Cup (Piston) for Caliper Assembly (1996-present)

#	Part #	Description
18	CCA-1415	Cup (Piston) for Caliper Assembly (1993 - 1995)
19	TC-24	Tongue for Disc Brakes (less master cylinder, latch, plunger rod)
20	CA-1424	Caliper Assembly, Left or Right (1996-present)
20	CA-1415L	Caliper Assy, Left (1993 - 1995)
20	CA-1415R	Caliper Assy, Right (1993 - 1995)
21	BD-24	Brake Disc (1996-present)
21	BD-1415	Brake Disc (1993 - 1995)
22	SP-24L	Support, Left (1996-present)
22	SP-24R	Support, Right (1996-present)
22	SP-1415L	Support, Left (1993 - 1995)
22	SP-1415R	Support, Right (1993 - 1995)
23	MC-1415	Master Cylinder
24	RB-1415	Rubber Boot on Master Cylinder
25	PR-24	Plunger Rod for M/Cylinder 2 pcs
26	BL-24	Latch for Brakes (1996-present)
26	BL-24	Latch for Brakes (1993 - 1995)
27	RT-1415	Retainer, with Bolt
28	TS-1415	Tension Spring
29	G-24	Brake Guard
30	LS-24	Latch Pivot Shaft, 1 1/4" Dia. x 9 1/2", for tongue flapper and brake latch
32	W-871B	Hub, faced for brakes, with cups, studs and nuts
33	OT-24	Adjustable Tongue Outer Weldment, new style, square latch
34	SB-3	Spacer Blocks (for brakes)
35	AT-24	Adapter Tee (2 male, 1 female) 4-Wheel
36	RH-20	Rubber Hose x 20" (4-Wheel Brakes)
37	12114-G5	1/2" x 1 1/4" Bolt with Lock Washer Gr 5

## Repair Parts List for New Style Hydraulic DISC Brakes for 24 Ton (Model 2494) Running Gear

For Running Gears 2004 and newer with New Style DISC Brake Systems beginning with Serial Number 1650

NOTE: Calipers are mounted to the frontside of the rear axle.

### Tongue Assembly

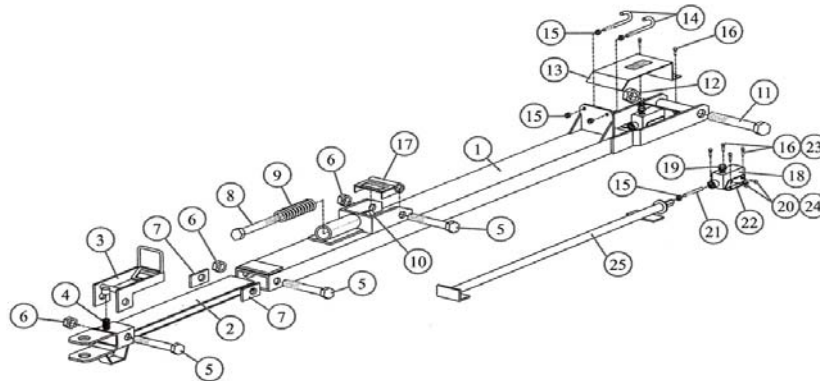

### Disc Brake Assembly

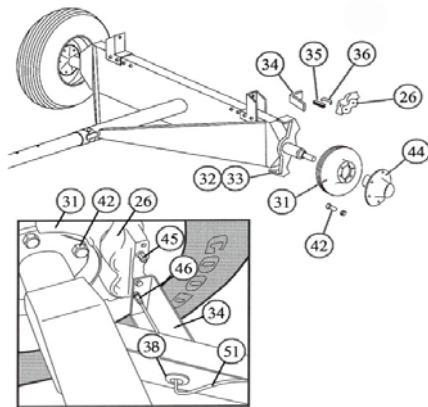

### Brake Line Assembly

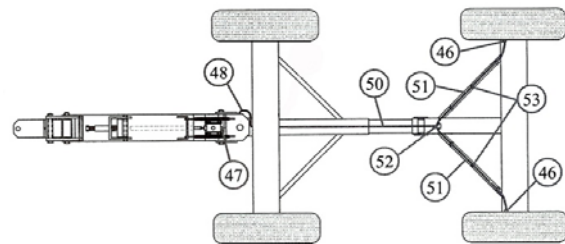

#	Part #	Description
1	OTW-24	Outer Tongue Weldment (94 1/2")
2	ITW-1324	Inner Tongue Weldment
3	TL-1324	Tongue Latch
4	SS-615NS	Small Spring In Latch
5	17G2B	1" x 7" Bolt (Grade 2)
6	1LN	1" Lock Nut
7	BL-58	Brake Limiter
8	19G8B	1" x 9" Bolt (Grade 8)
9	CS-178714	Compression Spring
10	1RN	1" Regular Nut
11	TB-24	1 3/4" Tongue Bolt
12	HN-134	1 3/4" Hex Nut
13	SMC-1	Shield for Master Cylinder
14	124-JB	1/2" x 4" J-Bolt
15	12-N	1/2" Regular Nut
16	381-FB	3/8" x 1" Flange Bolt
17	BLOL-1	Brake Lock Out Latch
18	MCA-DC1	Master Cylinder Assembly
19	RCMC-1324	Replacement Cap for M/Cyl.
20	383G8B	3/8" x 3" Bolt (Grade 8)
21	PRE-1	Plunger Rod End
22	MBMC-DC2	Mounting Bracket (2 pcs) for M/C
23	38-FN	3/8" Flange Nut
24	38-LN	3/8" Lock Nut
25	PP-1D	Plunger Pole (52 1/2")
26	CA-1424	Brake Caliper Assembly

#	Part #	Description
27	BP-1424	Brake Pad
28	SCA-1415	Seal for Caliper Assembly
29	BCA-1415	Boot for Caliper Assembly
30	CCA-1415N	Cup for Caliper Assembly
31	BD-24	Brake Disc
32	SP-1324L	Brake Support Arm (L) (SP-1424L)
33	SP-1324R	Brake Support Arm (R) (SP-1424R)
34	BG-1	Brake Guard
35	RT-1415	Retainer with Bolt
36	TS-1415	Tension Spring
37	RB-1415	Rubber Boot on Master Cylinder
38	GR-1415	Rubber Grommet
39	SKMC-1324	Seal Kit for Mstr Cyl. (SKMC-1415)
40	WS-24	Wire Spring (anti-rattle)
41	DOT5-BF	Container DOT 5 Brake Fluid
42	12114-G5	1/2" x 1 1/4" Bolt w/Lock Washer
44	W-871B	Hub, Faced for Brakes
45	BS-24	Bleeder Stem
46	CF-1324	Fitting for Caliper
47	FMC-125	Fitting for Master Cylinder
48	HH-1425	1/4" x 25" Hydraulic Hose
50	ST-96	3/16" Brake Line x 96" (680SD)
50	ST-120	3/16" Brake Line x 120"
51	ST-53	3/16" Brake Line x 53" (ST-31653)
52	10606	Tee
53	SC-1324	Spring Clips

# Repair Parts List for 24 Ton **Short Turn (Model 2494ST) Running Gear** (used on Models 680SD/760SD Wagons)

(For Hydraulic Disc or Drum Brake Components, see pages 34 - 36)

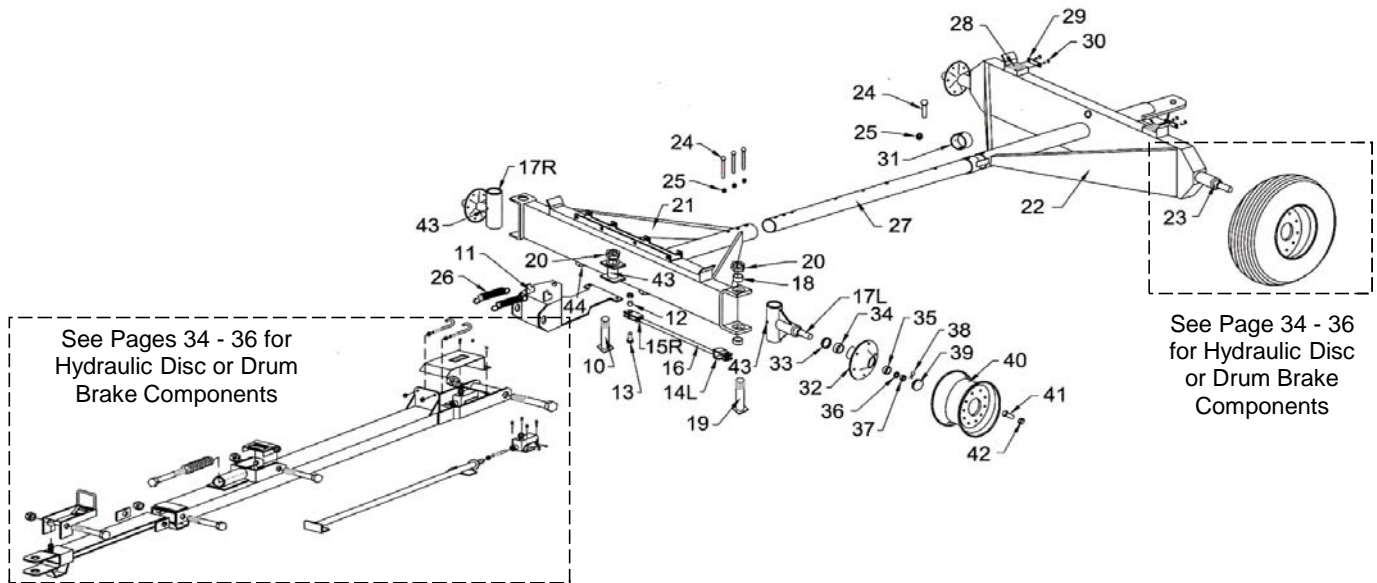

#	Part #	Description
10	HB-24	King Pin Hitch Bolt; 1 3/4" x 10 1/2"
11	HW-24	Hitch Weldment
12	BB-78	7/8" ID Bronze Bushing
13	SB-78	7/8" Step Bolt w/Nut
14L	TRE-114L	Tie Rod End, Left
14R	TRE-114R	Tie Rod End, Right
15L	HN-114L	1 1/4" Hex Nut, Left
15R	HN-114R	1 1/4" Hex Nut, Right
16	TR-24A	Tie Rod, 1 1/4" x 24" Long
17L	SA-24L	Spindle & Spool Assy, 3 3/8" Left
17R	SA-24R	Spindle & Spool Assy, 3 3/8" Right
18	EB-134	End Spindle Bushing, 1 3/4" ID
19	SPB-134	1 3/4" Rd CR x 13 1/2" Bolt
20	HN-134	1 3/4" Hex Nut
21	FA-24	Front Axle Weldment (A-Frame only)
21	FA-24C	Running Gear, Front Only (less brakes) Less Rims, Tongue, Hose, Piping, Pole
21	FA-24CDR	Running Gear, Front Only WITH DRUM BRAKES, Less Rims, Tongue, Hose, Piping, Pole
22	RA-24	Running Gear, Rear Only WITH DISC BRAKES, Less Rims, Hose, Rocking Bolster
22	RA-24DR	Running Gear, Rear Only WITH DRUM BRAKES, Less Rims, Hose, Rocking Bolster

#	Part #	Description
23	SS-33816	Spindle, Straight 3 3/8" x 16"
24	1634G5B	1" x 6 3/4" Bolt
25	1LN	1" Lock Nut
26	TS-615H	Large Tongue Spring
27	CP-24ST	Coupling Pole with Rear Hitch
28	212314-RP	2 1/2" x 3 1/4" Rubber Plate
29	14114312-P	1/4" x 1 1/4" x 3 1/2" Plate
30	381-FB	3/8" x 1" Flange Bolt
31	HCL-412	4 1/2" OD Collar
32	W-871B	873 Hub (faced) w/stud & nuts
33	CR-33772	Seal (4 5/8" OD)
34	4T-33275	Large Bearing
35	4T-460	Small Bearing
36	913632	Spindle Washer
37	912969	Slotted Spindle Nut
38	905944	Cotter Pin
39	909983	Dust Cap
40	WR-22.5-13	Wheel, 22.5 x 13, 10 Bolt
41	913564	Wheel Studs, 3/4"-16
42	913571	Wheel Nuts, 3/4"-16
43	1633	Grease Fitting
44	583G8B	5/8" x 3" Grade 8 Bolt
45	58-RN	5/8" Regular Nut (not shown)
51	910397	Inner Cup (large) (not shown)
52	910332	Outer Cup (small) (not shown)

**Repair Parts List for New Style Hydraulic DISC Brakes for 24 Ton Short Turn (Model 2494ST) Running Gear**  
For Running Gears 2006 and newer with New Style DISC Brake Systems beginning with Serial Number 01800

**Tongue Assembly**

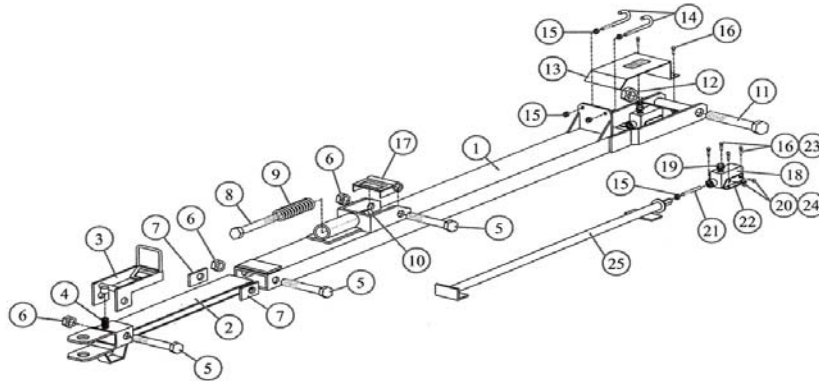

**Disc Brake Assembly**

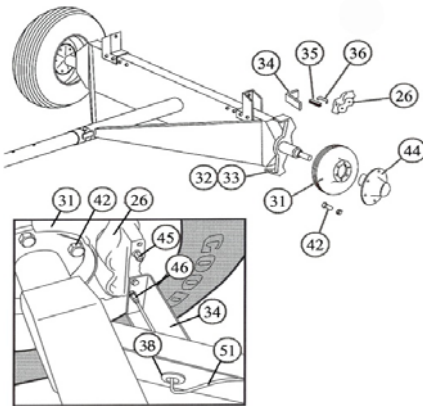

**Brake Line Assembly**

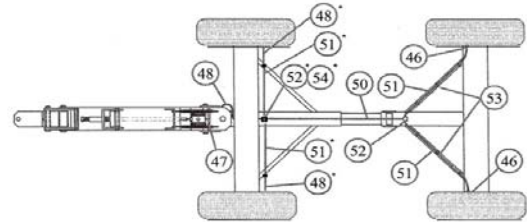
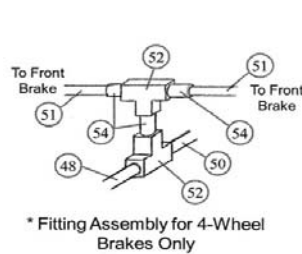

#	Part #	Description
1	OTW-24ST	Outer Tongue Weldment
2	ITW-24	Inner Tongue Weldment
3	TL-1324	Tongue Latch
4	SS-615NS	Small Spring In Latch
5	17G2B	1" x 7" Bolt (Grade 2)
6	1LN	1" Lock Nut
7	BL-58	Brake Limiter
8	19G8B	1" x 9" Bolt (Grade 8)
9	CS-178714	Compression Spring
10	1RN	1" Regular Nut
11	TB-24	1 3/4" Tongue Bolt
12	HN-134	1 3/4" Hex Nut
13	SMC-1	Shield for Master Cylinder
14	124-JB	1/2" x 4" J-Bolt
15	12-N	1/2" Regular Nut
16	381-FB	3/8" x 1" Flange Bolt
17	BLOL-1	Brake Lock Out Latch
18	MCA-DC1	Master Cylinder Assembly
19	RCMC-1324	Replacement Cap for M/Cyl.
20	383G8B	3/8" x 3" Bolt (Grade 8)
21	PRE-1	Plunger Rod End
22	MBMC-DC2	Mounting Bracket (2 pcs) for M/Cyl
23	38-FN	3/8" Flange Nut
24	38-LN	3/8" Lock Nut
25	PP-1DST	Plunger Pole
26	CA-1424	Brake Caliper Assembly
27	BP-1424	Brake Pad

#	Part #	Description
28	SCA-1415	Seal for Caliper Assembly
29	BCA-1415	Boot for Caliper Assembly
30	CCA-1415N	Cup for Caliper Assembly
31	BD-24	Brake Disc (24 Ton)
32	SP-1324L	Brake Support Arm (Left)
33	SP-1324R	Brake Support Arm (Right)
34	G-24	Brake Guard (24 Ton)
35	RT-1415	Retainer with Bolt
36	TS-1415	Tension Spring
37	RB-1415	Rubber Boot on Master Cylinder
38	GR-1415	Rubber Grommet
39	SKMC-1324	Seal Kit for Master Cylinder
40	WS-24	Wire Spring (anti-rattle)
41	DOT5-BF	Container DOT 5 Brake Fluid
42	12114-G5	1/2" x 1 1/4" Bolt w/Lock Wash.
44	W-871B	Hub, Faced for Brakes (24T)
45	BS-24	Bleeder Stem
46	CF-1324	Fitting for Caliper
47	FMC-1324	Fitting for Master Cylinder
48	HH-1424	1/4" x 24" Hydraulic Hose
49	58134-G5	5/8" x 1 3/4" Bolt with Lock Nuts (Grade 5)
50	ST-120	3/16" Brake Line x 120" (24T)
51	ST-30	3/16" Brake Line x 30"
52	10606	Tee
53	SC-1324	Spring Clips
54	10606-X	Tee Extension



**Repair Parts List for Hydraulic DRUM Brakes for 24 Ton Short Turn (Model 2494ST) Running Gear  
Tongue Assembly**

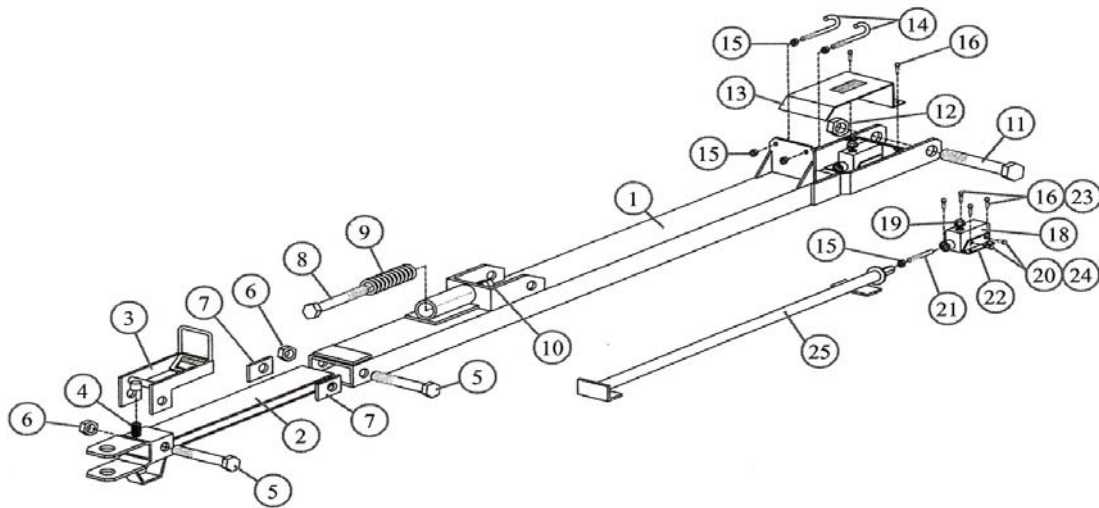

**Brake Line Assembly**

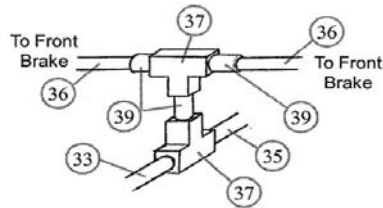

Front Brake Line Assembly

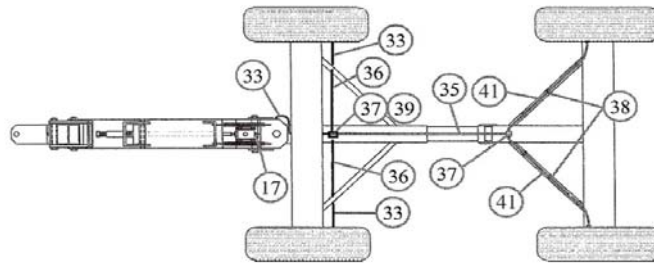

#	Part #	Description
1	OTW-24ST	Outer Tongue Weldment
2	ITW-1324	Inner Tongue Weldment
3	TL-1324	Tongue Latch
4	SS-615NS	Small Spring In Latch
5	17G2B	1" x 7" Bolt (Grade 2)
6	1LN	1" Lock Nut
7	BL-58	Brake Limiter
8	19G8B	1" x 9" Bolt (Grade 8)
9	CS-178714	Compression Spring
10	1RN	1" Regular Nut
11	TB-24	1 3/4" Tongue Bolt
12	HN-134	1 3/4" Hex Nut
13	SMC-1	Shield for Master Cylinder
14	124-JB	1/2" x 4" J-Bolt
15	12-N	1/2" Regular Nut
16	381-FB	3/8" x 1" Flange Bolt
17	FMC-1324	Fitting for Master Cylinder
18	MCA-DR1	Master Cylinder Assembly
19	RCMC-1324	Replacement Cap for M/Cyl.

#	Part #	Description
20	383G8B	3/8" x 3" Bolt (Grade 8)
21	PRE-1	Plunger Rod End
22	MBMC-DR2	Mounting Bracket (2 pcs) for M/Cyl
23	38-FN	3/8" Flange Nut
24	38-LN	3/8" Lock Nut
25	PP-1DST	Plunger Pole
26	RB-1415	Rubber Boot on Master Cylinder
27	GR-1415	Rubber Grommet
28	SKMC-1324	Seal Kit for Master Cylinder
29	DOT5-BF	Container DOT 5 Brake Fluid
31	W-871B	Hub, Faced for Brakes (24T)
32	BS-24	Bleeder Stem
33	HH-1424	1/4" x 24" Hydraulic Hose
35	ST-120	3/16" Brake Line x 120" (24T)
36	ST-30	3/16" Brake Line x 30"
37	10606	Tee
38	CT-1	Cable Tie
39	10606-X	Tee Extension
41	ST-53	3/16" Brake Line x 53"



## Repair Parts List for Hydraulic DRUM Brakes for 24 Ton Short Turn (Model 2494ST) Running Gear

#	Part #	Description
1	24737	Back Plate Assembly
2	9739	Front Brake Shoe Assembly
3	9745	Front Shoe Lever
4	9775	Rear Shoe Lever
5	9776	Wheel Cylinder Assembly - Right
6	9777	Wheel Cylinder Assembly - Left
7	23457	Screw & Lockwasher
8	23324	Adjusting Screw
9	23324PN	Pivot Nut
10	9782	Socket - Adjusting Screw
11	9783	Push Rod - Wheel Cylinder
12	9784	Spring Adjusting Screw (Yellow)
13	9785	Spring - Front Lever (Red)
14	9786	Spring - Rear Shoe (Orange)
15	9788	Pin - Shoe Hold Down
16	9789	Cup - Shoe Hold Down
17	9790	Spring - Front Hold Down (Yellow)
18	9791	Spring - Rear Hold Down (Black)
19	9254	Cover Plate - Adjusting Hole
20	7778	Retaining Ring
21	17406	Hex - Locknut 5/16" NC
28	9743	Travel Link
29	7949	Travel Link Bolt - Hex Cap Screw 5/16" NC x 5/8"
30	12560	Pin-Front Shoe - w/o Park Linkage
31	6814	Spring - Front Shoe
32	9797	Plug - Plastic
33	7972	Hex Nut 1/2" NF

**Drum Brake Assembly**

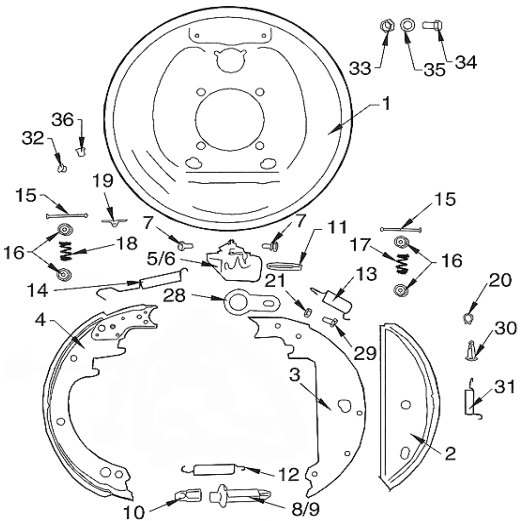

#	Part #	Description
34	7955	Cap Screw 1/2" NF x 1"
35	7937	Lockwasher 1/2"
36	9404	Plug - Plastic
39	15845	Wheel Cyl. Repair Kit - 1 1/8"
40	DRBA-L	Drum Brake Cluster Assy (left)
40	DRBA-R	Drum Brake Cluster Assy (right)
41	24BD	13" Brake Drum (6" pilot)

## Repair Parts List for Fender Kit for Models 1688 and 2494ST Short Turn Running Gears

The hardware installation shown is typical for each fender

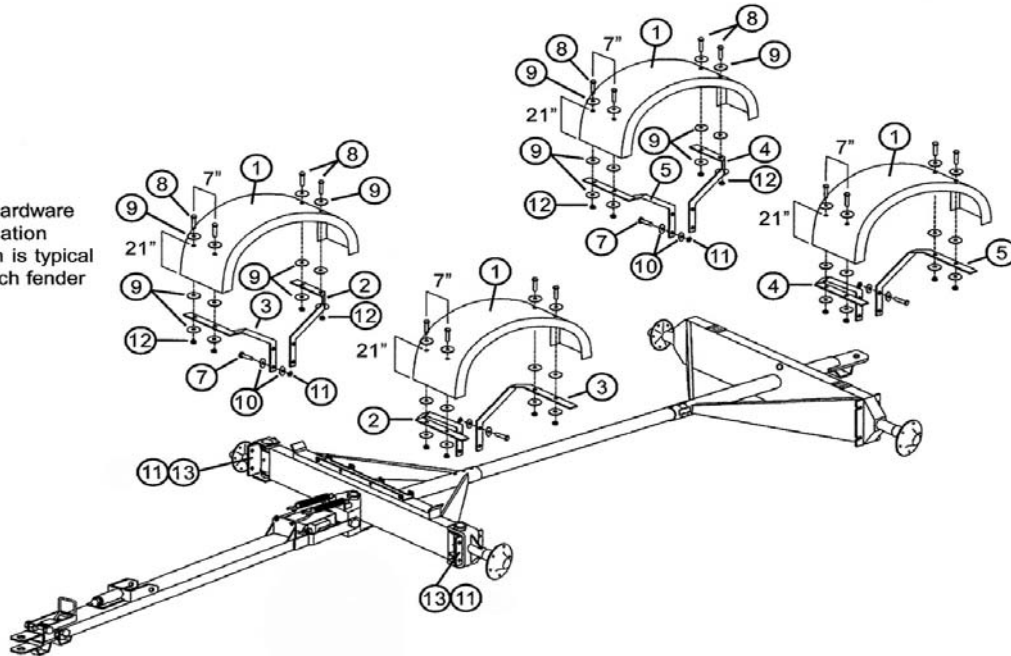

#	Part #	Description
1	PF-4	Plastic Fender
2	FMB-16A	Fender Mounting Bracket (16T)
2	FMB-24A	Fender Mounting Bracket (24T)
3	FMB-16B	Fender Mounting Bracket (16T)
3	FMB-24B	Fender Mounting Bracket (24T)
4	FMB-16C	Fender Mounting Bracket (16T)
4	FMB-24C	Fender Mounting Bracket (24T)
5	FMB-16D	Fender Mounting Bracket (16T)
5	FMB-24D	Fender Mounting Bracket (24T)

#	Part #	Description
6	FBP-2	Bracket Plate (16T) (not shown)
7	12212G5B	1/2" x 2 1/2" Grade 5 Bolt
8	12112G5B	1/2" x 1 1/2" Grade 5 Bolt
9	12OSW	1/2" Oversized Washer
10	12-WR	1/2" Regular Washer
11	12FN	1/2" Flange Nut
12	12RN	1/2" Regular Nut
13	122G5B	1/2" x 2" Grade 5 Bolt

## Repair Parts for Model 6HA 6" Hydraulic Auger

(Hydraulic Motor Mounted at Top of Auger)

#	Part #	Description	
1	EP-6-O	Cast Iron End Plate at Top of Auger (Old Style-Char-Lynn Motor)	
1	EP-6	Cast Iron End Plate at Top of Auger (New Style - Ross Motor)	
2	RS-AA-O	White Motor (1984-pres.) RS-AA-O Roller Stator	
3	RS-AA-OK	White Motor w/Conversion Kit to change auger from old style to new style	
4	HV-1	Hand Valve	
5	VH-1	Valve Handle	
6	RV-4	Rope for Valve	
7	VF-1	Fitting to Valve	
8	MF-1	Fitting to Motor (Used 1977 to 1984 with Ross Motor)	
9	SK-1	Seal Kit #1 for Valve Used 1965-1976	
9	SK-2	Seal Kit #2 for Valve Used 1977-pres.	
10	SK-005	Seal Kit for Char-Lynn Motor #60036, last 3 digits on Boss of Motor are 005 (used prior to 1974)	
10	SK-007	Seal Kit for Char-Lynn Motor #60036, last 3 digits on Boss of Motor are 007 (1975-1976)	
10	SK-HG50005	Seal Kit for Ross Motor HG50005 (1974-1984)	
10	SK-RS-AA-O	Seal Kit for White Motor RS-AA-O or RS-AC-O, 1984-1988	
10	SK-RS-AA-ON	Seal Kit for White Motor RS-AA-O or RS-AC-O, 1989-pres.(HS-0405S)	
11	FT-48	Formed Tubing from Valve to Motor, Approx. 48" long, (1977-pres.)	
12	HH-3	1/2" Hydraulic Hose w/Fitting, 3' Long (1965-1976)	
13	HH-7	1/2" Hydraulic Hose w/Fitting, 7' L	
13	HH-812	1/2" Hyd. Hose w/Fitting, 8' 6" Long (required when mounting on 12' box)	
13	HH-912	1/2" Hyd. Hose w/Fitting, 9' 6" Long (required for 500 bu. box)	
14	5RS-3	5" Dia. Rubber Spout x 3' Long	
14	5RS-4	5" Dia. Rubber Spout x 4' Long	
14	5RS-6	5" Dia. Rubber Spout x 6' Long	
14	5RS-12	5" Dia. Rubber Spout x 12' Long	
15	HC-5	5" Clamp for Rubber Spout	

#	Part #	Description	
16	6T-10	6" Dia. Tube x 10' Long w/Spout welded	
16	6T-12	6" Dia. Tube x 12' Long w/Spout welded	
16	6T-14	6" Dia. Tube x 14' Long w/Spout welded	
17	SS-5	Steel Spout (welded to 6" Tube)	
18	6AF-10	10' Length of Auger Flighting Welded to 1" Pipe (for 6" Auger)	
18	6AF-12	12' Length of Auger Flighting Welded to 1" Pipe (for 6" Auger)	
18	6AF-14	14' Length of Auger Flighting Welded to 1" Pipe (for 6" Auger)	
19	TB-1	Transport Bracket	
20	WB-2	Bracket to Hold Winch	
21	CC-80	Complete Chain Assembly for 10' Approx. 80"L (includes "S" hook)	
21	CC-102	Complete Chain Assembly for 12' Approx. 102"L (includes "S" hook)	
21	CC-124	Complete Chain Assembly for 14' Approx. 124"L (includes "S" hook)	
22	CSH-36	Chain with "S" Hook, 36" L	
23	SH-38	S Hook Only	
24	RW-1-1	Rubber Washer in Hopper Assy.	
25	HPC-316	Hair Pin Cotter	
26	TF-10	Tarp Fastener, 10"	
27	CA-12	Coupler Assy. to Box for 1/2" Hydraulic Hoses	
28	WA-1	Winch Only	
29	WC-316	Winch Cable, 3/16" x 10' with cable clamp	
30	WP-1	Pulley for Winch Assembly	
31	SP-14	1/4" Steel Plug for Auger Valve	
32	TF-6	Tarp Fastener, 6" (for 250-7S)	
33	SS-6	Safety Shield with Band	
34	AH-626	Auger Hopper only for 6' Wide Box, 26 3/4"	
35	AH-726	Auger Hopper only for 7' Wide Box, 26 3/4"	
36	AH-732	Auger Hopper for 7' Wide Box, 32 3/4" (250-7S)	
37	AH-7538	Auger Hopper for 7' 6" Wide Box, 38 3/4" (385SD & 500SD)	
38	AH-28	Auger Hopper (Special) 28 3/4"	
39	CWA-6	Cable Winch Assembly Complete	

**Repair Parts List for Models USA-13S, USA-13B, USA-13P,  
USA-15S, USA-15B and USA-15P Uni-Swivel Hydraulic Augers**

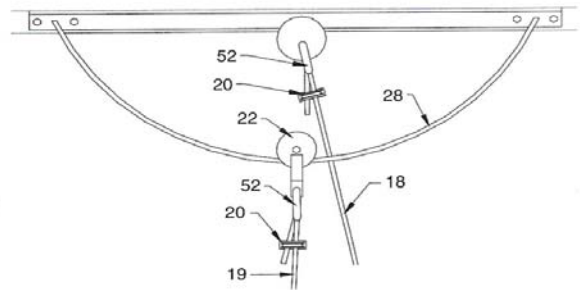
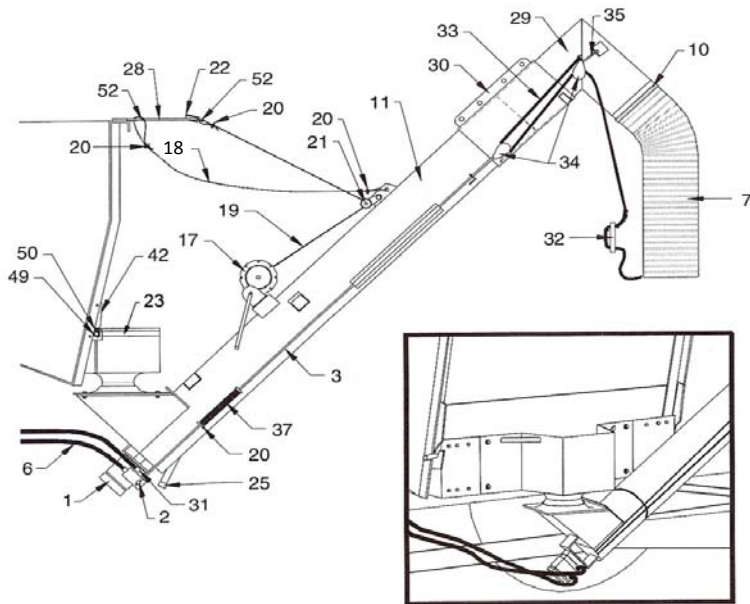

**Curved Rod Weldment (view from top of box)**

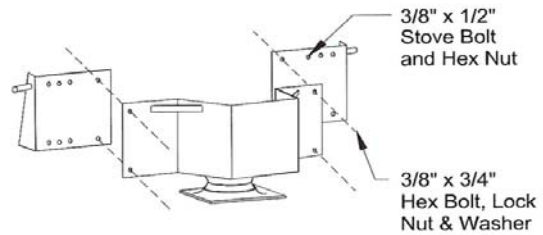

**3-Piece Adjustable Hopper**

#	Part #	Description
1	HS-0405N	Hydraulic Motor (2008)
2	DL-86	Valve with Handle
3	14-CR	Control Rod
4	HS-0405S	Seal Kit for Motor (SK-RS-AA-ON) (4 Bolt Square Base (Roller Stator)
4	255222	Seal Kit for Motor (25522201) 2008 (7 Bolt Round Base)
5	DL86-V	Seal Kit for Valve
6	HH-7	1/2" Hydraulic Hose x 84"
7	6RS-4	6" Dia. Rubber Spout x 4'
8	6RS-6	6" Dia. Rubber Spout x 6'
9	6RS-12	6" Dia. Rubber Spout x 12'
10	HC-6	6" Clamp
11	6ST-12	6" Steel Tube with Flange
12	SF-13	Steel Flighting for 13'
12	SF-15	Steel Flighting for 15'
14	PF-13	13' Plastic Flighting Complete
14	PF-15	15' Plastic Flighting Complete
14	APF-1	Hex/Round Adapter to Flighting
15	RS-6	6" Rubber Strap
16	RS-9	9" Rubber Strap
17	WA-1	Winch Assembly
18	316C-7	3/16" Cable x 7' (Safety)
19	316C-10	3/16" Cable x 11' (Winch)
20	316CC	3/16" Cable Clamp
21	316-P	3/16" Pulley (zinc)
22	12-P	1/2" Pulley (black)
23	3AH	3 Piece Adjustable Hopper
24	CA-12	Coupler Bracket
25	2C-1	2" Cap for Clean-out Pipe
26	DP-1	Complete Decal Package
27	TB-2	Transport Bracket (less ratchet)
28	12-RW	1/2" Curved Rod Weldment (for tapered sided gravity box)
28	12-RWSS	1/2" Curved Rod Weldment (for straight sided gravity box)
29	6TS-18	6" Top Spout for 13' Auger
29	6TS-42	6" Top Spout for 15' Auger

#	Part #	Description
30	SS-12	6" Sleeve x 12"
31	38M-12F	Street Elbow
32	1PRH	Plastic Rope Handle
33	516R15	5/16" Rope x 15'
34	516-P	5/16" Pulley (small) (teardrop)
35	384JB	3/8" x 4" J-Bolt
36	HHB-1	Hose Holder Bracket
37	51617	Compression Spring
38	HW-SR	Hopper Wing, Short, for tapered box with door 36" wide and under (Right)
38	HW-SL	Hopper Wing, Short, for tapered box with door 36" wide and under (Left)
39	HW-LR	Hopper Wing, Long, for tapered box with door over 36" wide (Right)
39	HW-LR540	Hopper Wing, Right, for 540SD
39	HW-LL540	Hopper Wing, Left, for 540SD
39	HW-LL	Hopper Wing, Long, for tapered box with door over 36" wide (Left)
40	HW-SSR	Hopper Wing, Short, for straight box with door 36" wide and under (right)
40	HW-SSL	Hopper Wing, Short, for straight box with door 36" wide and under (left)
41	HW-LSR	Hopper Wing, Long, for straight sided box with door over 36" wide (right)
41	HW-LSL	Hopper Wing, long, for straight sided box with door over 36" wide (Left)
42	FAB-1	Flat Attaching Bracket
43	38112HB	3/8" x 1 1/2" Hex Bolt Grade 2
44	3812SB	3/8" x 1/2" Stove Bolt
45	381-HB	3/8" x 1" Hex Bolt
46	38LN	3/8" Lock Nut
47	38WN	3/8" Wing Nut

**Repair Parts List for Models USA-13S, USA-13B, USA-13P,  
USA-15S, USA-15B and USA-15P Uni-Swivel Hydraulic Augers (Continued)**

#	Part #	Description
48	38LW	3/8" Lock Washer
49	34FW	3/4" Flat Washer
50	316HP	3/16" Large Hair Pin Clip
51	381TB	3/8" x 1" Tab Bolt
52	516-S	5/16" Shackle
53	38HN	3/8" Hex Nut
54	3834HB	3/8" x 3/4" Hex Bolt
55	38-FW	3/8" Flat Washer
56	4SPF-5	4" Section of Plastic Flighting x 5" Diameter

#	Part #	Description
56	4SPF-5TB	4" Top or Bottom Section of Plastic Flighting x 5" Diameter
57	3STR-1	Replacement Flex Spout with Rivets (for 3-Stage Telescoping Spout)
58	RA-1	Ratchet
59	TDS-1A	Tie Down Strap and Hook Assy
60	APF-1	Hexagonal Adapter for Plastic Flighting Shaft (not shown)
61	15HS	Hexagonal Shaft Only

**Repair Parts List for Electric Solenoid Switch Kits**

#	Part #	Description
1	ES-1	Solenoid with Fittings
2	ECHS-1	Cable with Hand Switch
3	BB-2	Battery Box with Strap
4	20PT	Large Plastic Tie - 20"
5	4PT	Small Plastic Tie - 4"
6	HS-1	Hanger Strap
7	38EB	Eyebolt
8	38LN	3/8" Lock Nut
9	142HB	1/4" x 2" HHMB
10	14HN	1/4" Hex Nut
11	SV-10	Replacement Cartridge (SV10-21-O-N-00)
12	SL-1	Replacement Sleeve (6352012) to cartridge

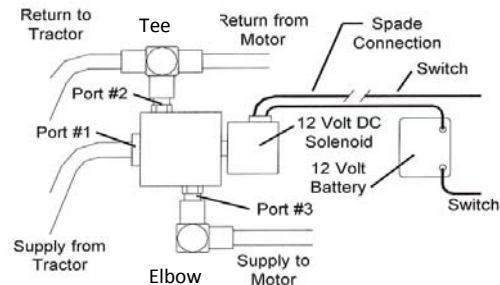

**Repair Parts List for Portable Hydraulic Auger-Mates**

#	Part #	Description
1	AMF-1	Mounting Frame
2	AFRP-1	Reinforcing Plate
3	12EL	1/2" Elbow
4	HH-34	Hyd. Hose with swivel 1/2" x 34"
5	12112HB	1/2" x 1 1/2" Bolt - Grade 5
6	12LN	1/2" Lock Nut
7	FW-12	1/2" Flat Washer
8	BB-2	Battery Box w/strap (electric start)
9	123HB	1/2" x 3" Bolt (for 250-7S only)
10	PS-1	Pipe Spacer (for 250-7S only)
11	1552HF	Hydraulic Filter (NAPA 1552)
12	1078	Filler, Breather & Strainer Assy.
13	P10A14	Hydraulic Pump

