

OPERATOR'S MANUAL

and Set-Up Instructions for

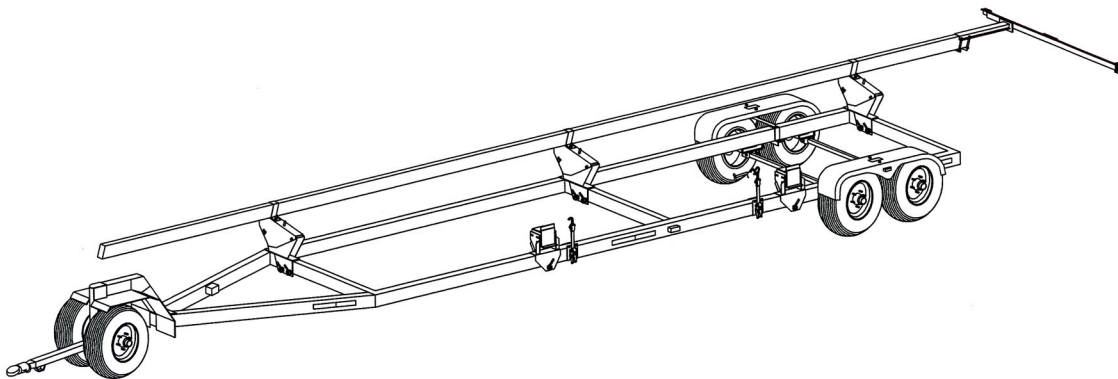

HEADER TRANSPORTS



HS-30B

HS-36B



J. & M. Mfg. Co., Inc.

P.O. Box 547 Ft. Recovery, OH 45846

Ph: (419) 375-2376 Fax: (419) 375-2708

www.jm-inc.com

JMMAN0101 (Rev. 08/01/05)

TO THE DEALER:

Read manual instructions and safety rules. Make sure all items on the Dealer's Pre-Delivery and Delivery Check Lists in the Operator's Manual are completed before releasing equipment to the owner.

The dealer must complete the Warranty Registration Card attached to the front inside cover of this manual and return to J. & M. Mfg. Co., Inc. at the address indicated on the card. **Warranty claims will be denied if the Warranty Registration Card has not been completed and returned. THE DEALER MUST ALSO COMPLETE AND RETURN THE TIRE REGISTRATION FORM ATTACHED TO THE INSIDE COVER OF THIS MANUAL. In case of a recall, we can reach you only if the card is complete and returned to the address printed on the form. The Dealer MUST return this card to be on our recall list.**

EXPRESS WARRANTY:

J. & M. Mfg. Co. Inc. warrants against defects in construction or materials for a period of ONE year. We reserve the right to inspect and decide whether material or construction was faulty or whether abuse or accident voids our guarantee.

Warranty service must be performed by a dealer or service center authorized by J. & M. Mfg. Co. Inc. to sell and/or service the type of product involved, which will use only new or remanufactured parts or components furnished by J. & M. Mfg. Co. Inc. Warranty service will be performed without charge to the purchaser for parts or labor based on the Warranty Labor Times schedule. Under no circumstance will allowable labor times extend beyond the maximum hours indicated in the Warranty Labor Times schedule for each warranty procedure. The purchaser will be responsible, however, for any service call and/or transportation of the product to and from the dealer or service center's place of business, for any premium charged for overtime labor requested by the purchaser, and for any service and/or maintenance not directly related to any defect covered under the warranty. Costs associated with equipment rental, product down time, or product disposal are not warrantable and will not be accepted under any circumstance.

Each warranty term begins on the date of product delivery to the purchaser. Under no circumstance will warranty be approved unless (i) the product warranty registration card (attached to the inside of the Operator's Manual) has been properly completed and submitted to the equipment manufacturer, and (ii) a warranty authorization number has been issued by the equipment manufacturer. This Warranty is effective only if the warranty registration card is returned within 30 days of purchase.

This warranty does not cover a component which fails, malfunctions or is damaged as a result of (i) improper modification or repair, (ii) accident, abuse or improper use, (iii) improper or insufficient maintenance, or (iv) normal wear or tear. This warranty does not cover products that are previously owned and extends solely to the original purchaser of the product. Should the original purchaser sell or otherwise transfer this product to a third party, this Warranty does not transfer to the third party purchaser in any way. J. & M. Mfg. Co. Inc. makes no warranty, express or implied, with respect to tires or other parts or accessories not manufactured by J. & M. Mfg. Co. Inc. Warranties for these items, if any, are provided separately by their respective manufacturers.

THIS WARRANTY IS EXPRESSLY IN LIEU OF ALL OTHER WARRANTIES OR CONDITIONS, EXPRESS, IMPLIED OR STATUTORY, INCLUDING ANY IMPLIED WARRANTY OF MERCHANTABILITY OR FITNESS FOR PARTICULAR PURPOSE.

In no event shall J. & M. Mfg. Co. Inc. be liable for special, direct, incidental or consequential damages of any kind. The exclusive remedy under this Warranty shall be repair or replacement of the defective component at J. & M. Mfg. Co. Inc.'s option. This is the entire agreement between J. & M. Mfg. Co. Inc. and the Owner about warranty and no J. & M. Mfg. Co. Inc. employee or dealer is authorized to make any additional warranty on behalf of J. & M. Mfg. Co. Inc.

The manufacturer reserves the right to make product design and material changes at any time without notice. They shall not incur any obligation or liability to incorporate such changes and improvements in products previously sold to any customer, nor shall they be obligated or liable for the replacement of previously sold products with products or parts incorporating such changes.

SERVICE:

The equipment you have purchased has been carefully manufactured to provide dependable and satisfactory use. Like all mechanical products, it will require cleaning and upkeep. Lubricate the unit as specified. Observe all safety information in this manual and safety signs on the equipment.

For service, your authorized J. & M. dealer has trained mechanics, genuine J. & M. service parts, and the necessary tools and equipment to handle all your needs.

Use only genuine J. & M. service parts. Substitute parts may void the warranty and may not meet standards required for safe and satisfactory operation. Record the model number and serial number of your equipment in the spaces provided:

Serial No.: _____ Date of Purchase: _____
Purchased From: _____

Provide this information to your dealer to obtain correct repair parts.

HS-30B and HS-36B HEADER TRANSPORTS

SPECIFICATIONS

	DIMENSIONS	
	HS-30B	HS-36B
A	41'-0"	47'-0"
B	6'-0"	6'-0"
C	26'-0"	26'-0"
D	2'-10 1/2"	2'-10 1/2"
E	6'-0"	6'-0"

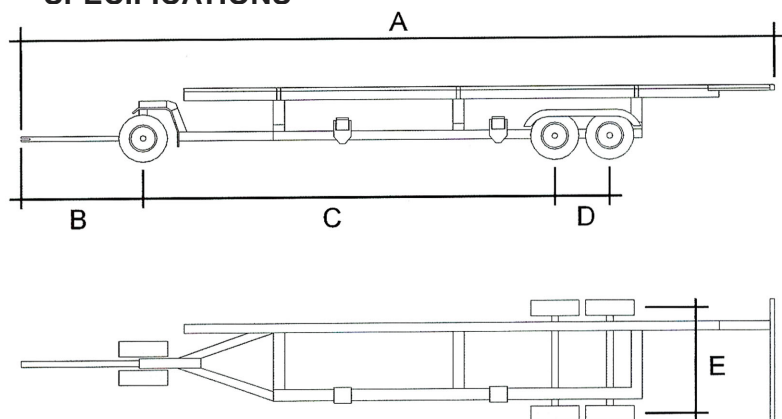

SPECIFICATIONS

Weight	3,050 lbs (HS-30B) 3,190 lbs (HS-36B)
Wheels	15 x 6
Hub	6 bolt
Spindles	2-1/4" dia. (front) and 2-1/2" dia. (rear)
Front Construction	4" x 6" x 3/8" steel tubing
Steel Upper Bar	4" x 6" x 3/16" steel tubing
Rear Electric Brakes	Standard on both rear axles
Adjustable Header Mounts	Standard
Tie Down Straps	Standard

GENERAL INFORMATION

TO THE OWNER:

The purpose of this manual is to assist you in operating and maintaining your header transport in a safe manner. Read it carefully. It furnishes information and instructions that will help you achieve years of dependable performance and help maintain safe operating conditions. If this machine is used by an employee or is loaned or rented, make certain that the operator(s), prior to operating:

1. Is instructed in safe and proper use.
2. Reviews and understands the manual(s) pertaining to this machine.

Throughout this manual, the term **IMPORTANT** is used to indicate that failure to observe can cause damage to equipment. The terms **CAUTION**, **WARNING** and **ANGER** are used in conjunction with the Safety-Alert Symbol, (a triangle with an exclamation mark), to indicate the degree of hazard for items of personal safety. When you see this symbol, carefully read the message that follows and be alert to the possibility of personal injury or death.



This Safety-Alert symbol indicates a hazard and means **ATTENTION! BECOME ALERT! YOUR SAFETY IS INVOLVED!**



DANGER

Indicates an imminently hazardous situation that, if not avoided, will result in death or serious injury.



WARNING

Indicates a potentially hazardous situation that, if not avoided, could result in death or serious injury, and includes hazards that are exposed when guards are removed.



CAUTION

Indicates a potentially hazardous situation that, if not avoided, may result in minor or moderate injury.

IMPORTANT

Indicates that failure to observe can cause damage to equipment.

NOTE

Indicates helpful information.

GENERAL INFORMATION

BOLT TORQUE CHART

Always tighten hardware to these values unless a different torque or tightening procedure is listed for a specific application.

Fasteners must always be replaced with the same grade as specified in the manual parts list.

Always use the proper tool for tightening hardware: SAE for SAE hardware and Metric for metric hardware.

Make sure fastener threads are clean and you start thread engagement properly.

All torque values are given to specifications used on hardware defined by SAE J1701 & J1701M JUL 96.

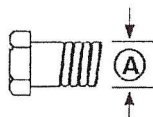

**SAE SERIES
TORQUE
CHART**

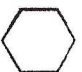

SAE Bolt Head
Identification



SAE Grade 5
(3 Radial Dashes)

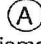

SAE Grade 8
(6 Radial Dashes)

 Diameter (Inches)	Wrench Size	MARKING ON HEAD					
		SAE 2		SAE 5		SAE 8	
		Lbs.-Ft.	N-m	Lbs.-Ft.	N-m	Lbs.-Ft.	N-m
1/4	7/16"	6	8	10	13	14	18
5/16	1/2"	12	17	19	26	27	37
3/8	9/16"	23	31	35	47	49	67
7/16	5/8"	36	48	55	75	78	106
1/2	3/4"	55	75	85	115	120	163
9/16	13/16"	78	106	121	164	171	232
5/8	15/16"	110	149	170	230	240	325
3/4	1-1/8"	192	261	297	403	420	569
7/8	1-5/16"	306	416	474	642	669	907
1	1-1/2"	467	634	722	979	1020	1383

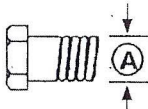

METRIC SERIES
TORQUE
CHART

8.8

Metric Bolt Head
Identification

10.9

Metric
Grade 10.9

Diameter & Thread Pitch (Millimeters)	Wrench Size	COARSE THREAD				FINE THREAD				Diameter & Thread Pitch (Millimeters)
		MARKING ON HEAD				MARKING ON HEAD				
		Metric 8.8		Metric 10.9		Metric 8.8		Metric 10.9		
		N-m	Lbs.-Ft.	N-m	Lbs.-Ft.	N-m	Lbs.-Ft.	N-m	Lbs.-Ft.	
6 x 1.0	10 mm	8	6	11	8	8	6	11	8	6 x 1.0
8 x 1.25	13 mm	20	15	27	20	21	16	29	22	8 x 1.0
10 x 1.5	16 mm	39	29	54	40	41	30	57	42	10 x 1.25
12 x 1.75	18 mm	68	50	94	70	75	55	103	76	12 x 1.25
14 x 2.0	21 mm	109	80	151	111	118	87	163	120	14 x 1.5
16 x 2.0	24 mm	169	125	234	173	181	133	250	184	16 x 1.5
18 x 2.5	27 mm	234	172	323	239	263	194	363	268	18 x 1.5
20 x 2.5	30 mm	330	244	457	337	367	270	507	374	20 x 1.5
22 x 2.5	34 mm	451	332	623	460	495	365	684	505	22 x 1.5
24 x 3.0	36 mm	571	421	790	583	623	459	861	635	24 x 2.0
30 x 3.0	46 mm	1175	867	1626	1199	1258	928	1740	1283	30 x 2.0

TABLE OF CONTENTS

INTRODUCTION	2
EXPRESS WARRANTY	2
SPECIFICATIONS	3
GENERAL INFORMATION	3
BOLT TORQUE CHART	4
SAFETY RULES	6
SAFETY SIGNS	7
SET-UP INSTRUCTIONS	7-10
PARTS DIAGRAMS	11
PARTS LIST	12
ADJ. BRACKETS, TIE-DOWN BRACKETS, HEADER MOUNTS	13
INITIAL OPERATION, OPERATING INSTRUCTIONS/MAINTENANCE	14
REPORTING SAFETY DEFECTS	15
SERVICE RECORDS	16

SAFETY RULES



ATTENTION! BECOME ALERT! YOUR SAFETY IS INVOLVED!



Safety is a primary concern in the design and manufacture of our products. Unfortunately, our efforts to provide safe equipment can be erased by an operator's single careless act. In addition, hazard control and accident prevention are dependent upon the awareness, concern, judgement, and proper training of personnel involved in the operation, transport, maintenance and storage of equipment.

Make certain that the operator(s), prior to operating is instructed in safe and proper use and reviews and understands the manual(s) pertaining to this machine.

Read this manual before you operate this machine. If you do not understand any part of this manual, or need more information, contact the manufacturer or your authorized dealer.

SAFETY

Understand that your safety and the safety of other persons is measured by how you service, and operate this machine. Know the positions and functions of all controls before you try to operate them. Make sure to check all controls in a safe area before starting you work.

The safety information given in this manual does not replace safety codes, federal, state or local laws. Make certain your machine has the proper equipment as designated by local laws and regulations.

A frequent cause of personal injury or death is from persons falling off equipment and being run over. Do not permit persons to ride on this machine.

Travel speeds should be such that complete control and machine stability is maintained at all times. Where possible, avoid operating near ditches, embankments and holes. Reduce speed when turning, crossing slopes and rough, slick or muddy surfaces.

Make sure that the header is fastened securely to the transport before moving.

Make sure that everyone is clear of equipment before moving the machine. NEVER position yourself under or near header when mounting on header transport.

Never adjust, service, clean, or lubricate the header transport until all power is shut off.

Make sure that the header transport is fastened securely to the tractor by using a high strength hitch pin, clip and safety chains.

Before unhooking the header transport from the towing unit, be sure to properly block the wheels to prevent the transport from moving.

IMPORTANT: Use caution when transporting. Be alert of the transport unit's overall width when approaching obstacles, such as post signs and poles, along the road. Check the transport width of the unit to ensure clearance before entering bridges.

COMPLY WITH ALL SAFETY WARNINGS AND CAUTIONS IN THIS MANUAL AND IN THE COMBINE OPERATOR'S MANUAL.



WARNING

Be certain all lights are working properly BEFORE highway travel.

Use only 2-5/16" Ball Hitch to transport unit.

SAFETY SIGNS

ATTENTION! BECOME ALERT! YOUR SAFETY IS INVOLVED!

Replace Immediately If Damaged or Missing!

IMPORTANT: Install new safety signs if the old signs are destroyed, lost, painted over or cannot be read. When parts are replaced that have safety signs, make sure you install a new sign with each new part. New signs are available from the manufacturer or your authorized dealer.

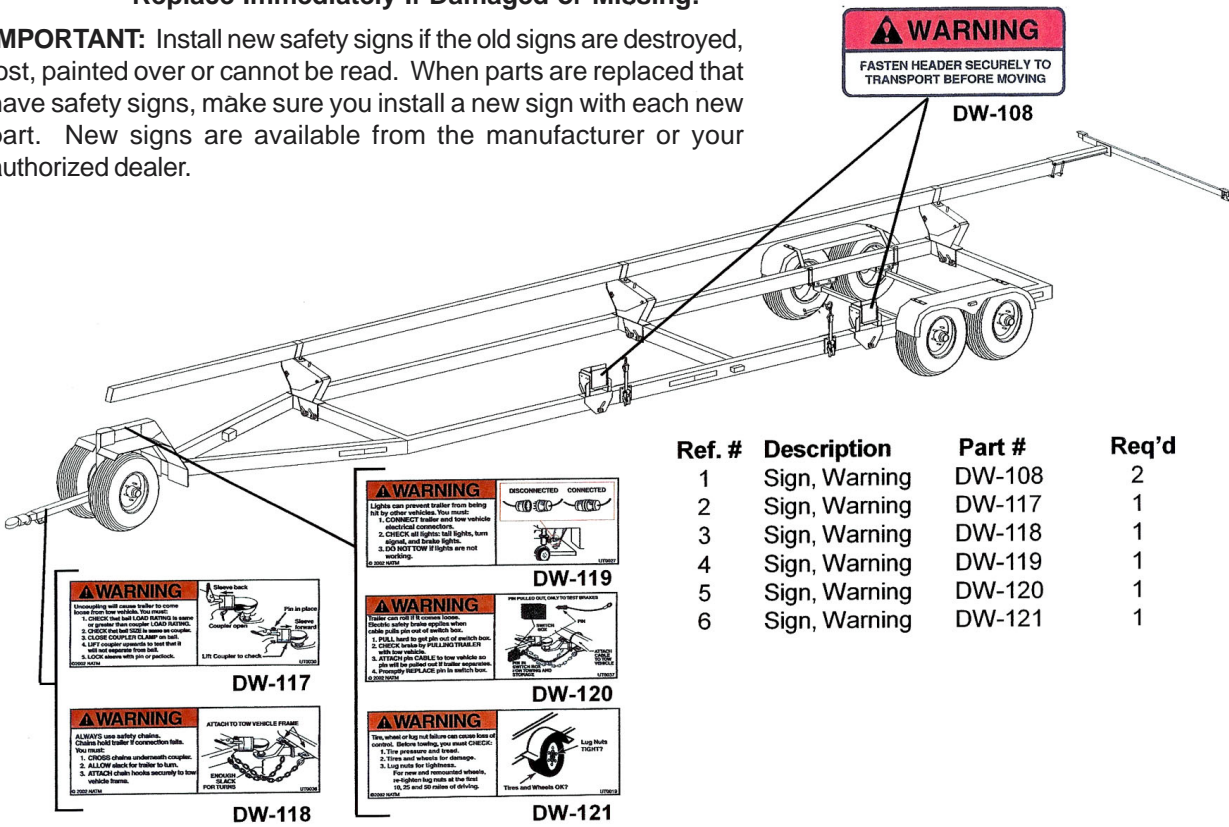

SET-UP INSTRUCTIONS

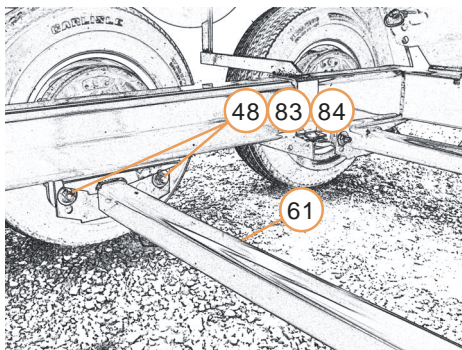

1. Mounting the Rear Axles

Secure the Dura-Flex Rear Axles (61) to the axle mounts located on the underside of the Header Transport Main Frame (1) using four 5/8" x 1-3/4" Grade 5 bolts (48) with eight 5/8" flat washers (83) and four 5/8" locknuts (84). **NOTE:** The axle should be positioned so the spindle is located toward the rear of the axle centerline.

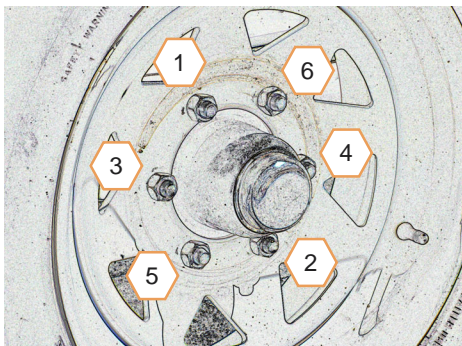
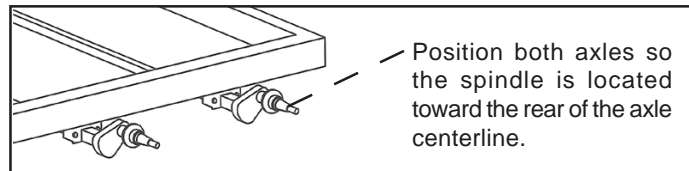

2. Mounting the Rear Tires

Secure one tire and wheel assembly (18)(16) to each of the rear hub assemblies using the wheel nuts (17) provided. Use a star pattern to tighten the spindle nuts according to SAE standards.

SET-UP INSTRUCTIONS (Continued)

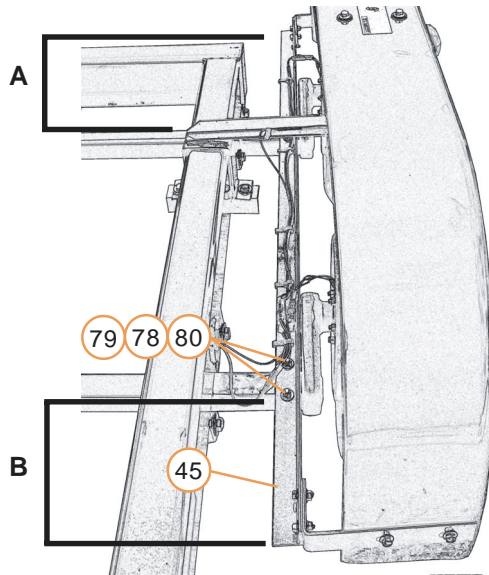

3. Mounting the Rear Fenders

Place one of the Base Fender Support Rail (Left or Right) (45L and 45R) on top of the two rear axles between the main frame and spindle as shown. Align the holes in the support rail with the rear axles and loosely secure to each axle using one 3/8" x 3 1/2" x 3 1/2" U-Bolt (80), two 3/8" flat washers (78) and two 3/8" lock nuts (79). **IMPORTANT:** Be sure the vertical face of the support rail faces the outside of the transport (toward the tires) and the support rail extends farther behind the second rear axle (A) than it does the first rear axle (B). If the support rail does not project farther behind the second rear axle, the rail is located on the wrong side of the transport and the other rail should be used.

Repeat on opposite side of transport.

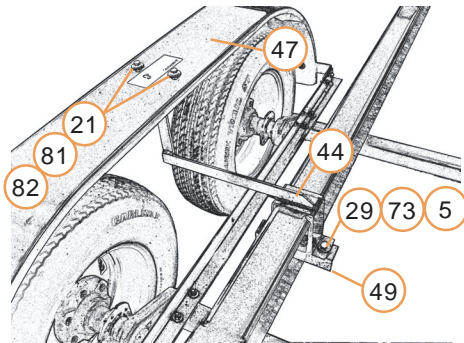

Slide the Fender Support Arm (44) across the header transport main frame and loosely secure to the Angle Iron Support (49) using two 1/2" x 1 1/2" Grade 5 bolts (29), two 1/2" washers (73) and two 1/2" lock nuts (5). Mount the Fender to the top of the Fender Support Arm using two 3/8" x 1" flange bolts (21), two 3/8" rubber/metal washers (81) and two 3/8" whiz nuts (82). Be sure the side tear drop of the fender is located toward the outside of the transport. Slide the Fender Support Arm along the main frame until the Fender is centered above the tires to ensure proper clearance.

Repeat on opposite side of transport.

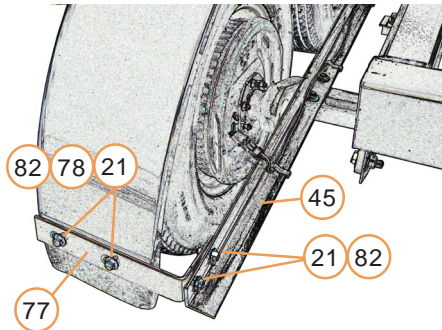

Mount one Fender L-Brackets (77) to each inside end of the fender using two 3/8" x 1" flange bolt (21), two 3/8" washers (81) and two 3/8" whiz nuts (82) as shown. Secure the other side of the L-Bracket to the Base Fender Support Rail using two 3/8" x 1" flange bolts (21) and two 3/8" whiz nuts (82). Repeat on opposite end of fender.

Repeat on opposite side of transport.

SET-UP INSTRUCTIONS (Continued)

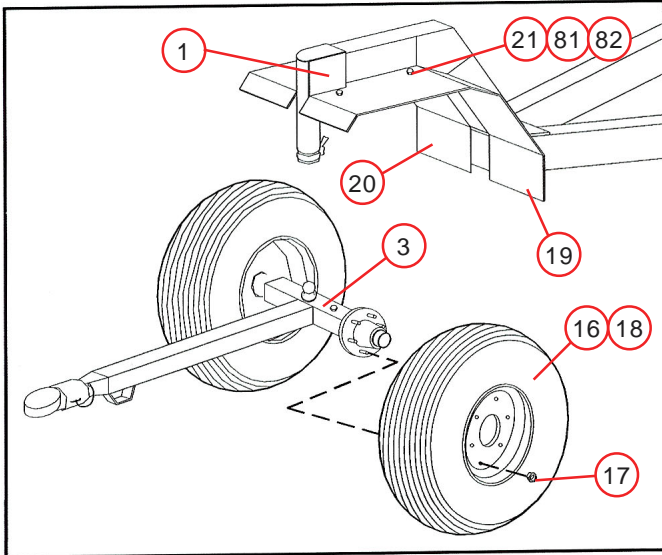

4. Mounting the Front Axle Assembly

Mount two wheel and tires (16)(18) to the hubs on the Ball Hitch Tongue and Axle Assembly (3). Use a star pattern to secure the wheel rim to the hub and tighten to SAE specifications. Once both wheels are secured to the front axle, raise the spring loaded pin on the Header Transport Main Frame (1) and engage the ball hitch on the Front Axle Assembly. Once the ball hitch has engaged the locking tube, lower the spring loaded pin into the hole located on the Front Axle Assembly to ensure the assembly from unlatching during transport.

Secure the Front Fenders (19)(20) using four 3/8" x 1" Flange Bolts (21), four 3/8" rubber/metal washers (81) and four 3/8" Flange Nuts (82).

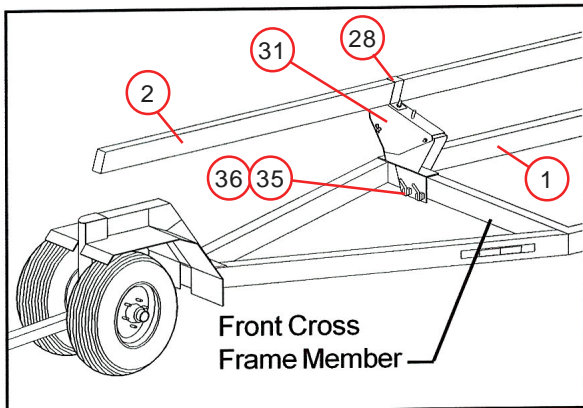

5. Attaching the Adjustable Brackets and Upper Bar, Tie-Down Brackets and Adjustable Header Mounts

Straddle each cross frame member of the Header Transport Main Frame (1) with one Upper Bar Adjustable Bracket (31) as shown. Be sure to position and align all Adjustable Brackets at the far right end of the cross frame as necessary.

Secure each Upper Bar Adjustable Bracket (31) to the cross frame member using the 7/8" x 5-1/2" grade 5 bolts (36) and 7/8" Handle Nuts (35) provided. **IMPORTANT:** Before operating the transport, be sure the clamping handle is extended upward for maximum ground clearance during transport.

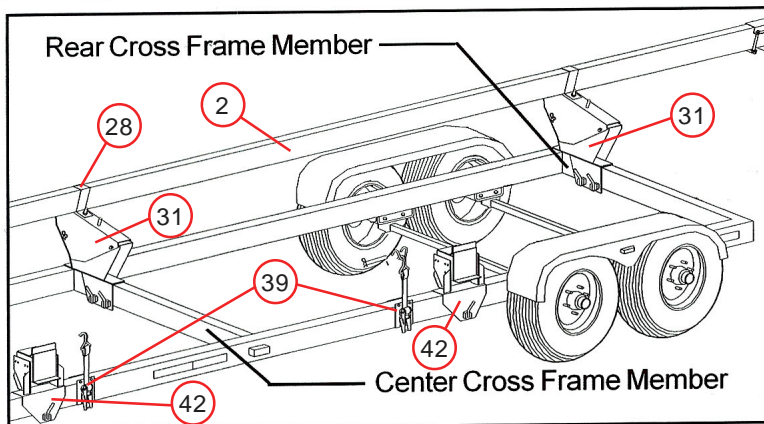

Place the Adjustable Header Mounts (42) and Tie-Down Bracket Assemblies (39) on the outside left tube of the Header Transport Main Frame as shown. Position one Adjustable Header Mount (42) and Tie-Down Bracket Assembly (39) on each side of the center cross member. Secure the Adjustable Header Mount to the outside tube using one 7/8" x 5-1/2" Grade 5 Bolt (36) and 7/8" Handle Nut (35). **IMPORTANT:** Before operating the transport, be sure the clamping handle is extended upward for maximum ground clearance during transport.

Secure the Tie-Down Bracket Complete (39) to the outside tube using two 1/2" x 5" Bolts (50) and two 1/2" Lock Nuts (5). **DO NOT OVER TIGHTEN THE 1/2" BOLTS ON THE TOP OF THE ASSEMBLY, BUT ALLOW THE TIE-DOWN BRACKETS TO MOVE FREELY ALONG THE OUTER TUBE.**

Position the Upper Bar (2) on the three Upper Bar Adjustable Brackets (31) so the front end of the bar is located adjacent to the front axle as necessary. Secure the Upper Bar at each Upper Bar Mount using the Upper Bar Clamp (28), two 1/2" Washers (73) and two 1/2" Lock Nuts (5). The angle of the Upper Bar can be adjusted by removing and repositioning the 5/8" x 6" Hitch Pins (32) in the Upper Bar Adjustable Brackets.

SET-UP INSTRUCTIONS (Continued)

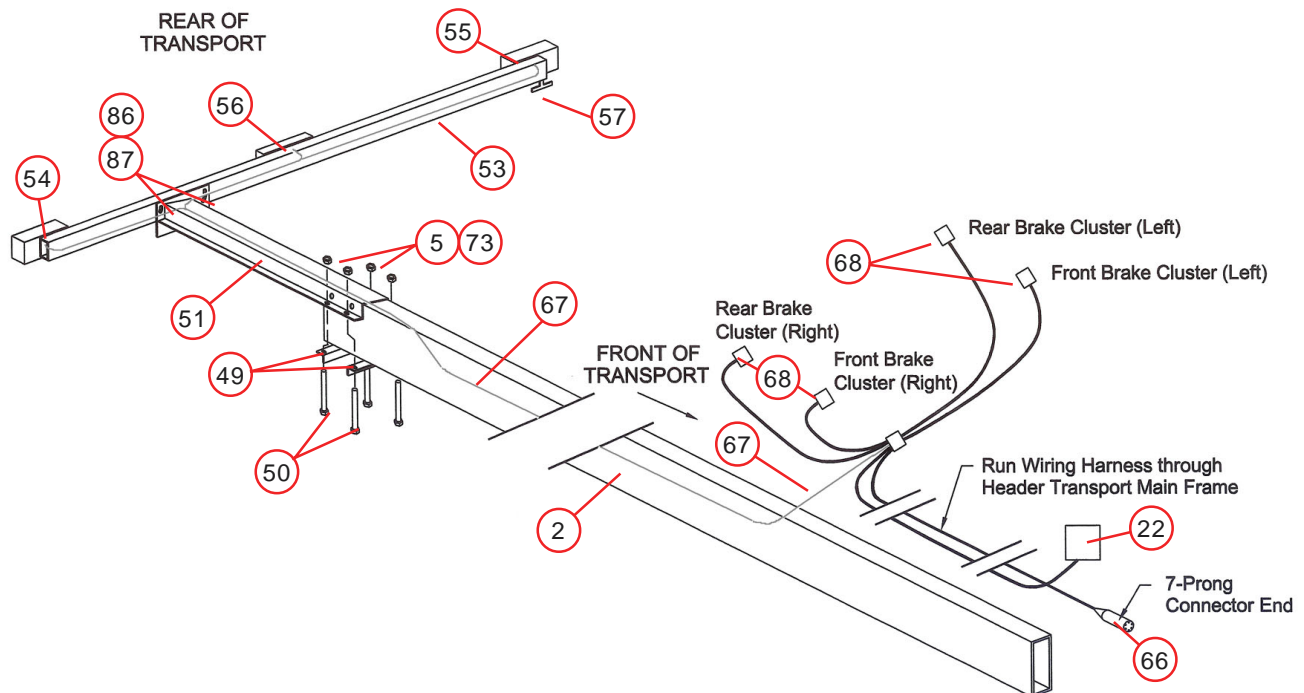

6. Header Transport Light Kit

Place Extension Bracket Arm (51) at rear end of Upper Bar (2). Attach using the two Angle Iron Supports (49) and secure with four 1/2" x 5" bolts (50), four 1/2" washers (73) and four 1/2" lock nuts (5).

Place Light Mounting Bar (53) at the end of the Extension Bracket Arm (51) so the Light Mounting Bar is level or horizontal and extends towards the center of the header transport. Secure using two 1/2 x 1 1/4" Grade 5 Flange Bolts (86) and two 1/2" Whiz Nuts (87).

Mount each Rear Light Assembly (54)(55) at the end of the Light Mounting Bar (53) so the reflective side lense is positioned toward the outside of the transport. Secure each light assembly using four small Self-tapping Screws (27). Secure the Rear Light Panel (56) to the center of the Light Mounting Bar (53) using four 1/4" x 1" Bolts (58) and four 1/4" Lock Nuts (85).

7. Installing the Light and Electric Brake Wiring Harnesses

A) Insert the Main Wiring Harness, end opposite the 7-Prong Connector End, through the grommet located at the front of the gooseneck of the Header Transport Main Frame and exit the A-Frame behind the gooseneck.

B) Extend the Main Wiring Harness along the inside right side of the Header Transport Main Frame. Reinsert the Main Wiring Harness through the opening located along the front of the A-Frame and extend the harness through the main frame tubing toward the rear of the transport.

C) Exit the Main Wiring Harness at the opening located adjacent to the two rear axles. Extend the Main Wiring Harness along the top of the front Dura-Flex Rear Axle.

D) Connect the wire to each of the side marker lights located on the outside of the rear fenders and the center of the Header Transport Main Frame. Extend the wires along the top of the Header Transport Main Frame to the end of the Main Wiring Harness.

E) Connect the brake wires to each of the brake clusters located on the rear axles and extend the wires along the top of the Header Transport Main Frame to the end of the Main Wiring Harness.

F) Extend the Light Wiring Harness through the Light Mounting Bar and connect to both the Rear Red Lights and Light Mounting Bar. Insert the Light Wiring Harness through the Upper Bar and exit at the opening near the Dura-Flex Rear Axles. Proceed the wire harness along the top of the Header Transport Main Frame to the Main Wiring Harness.

SET-UP INSTRUCTIONS (Continued)

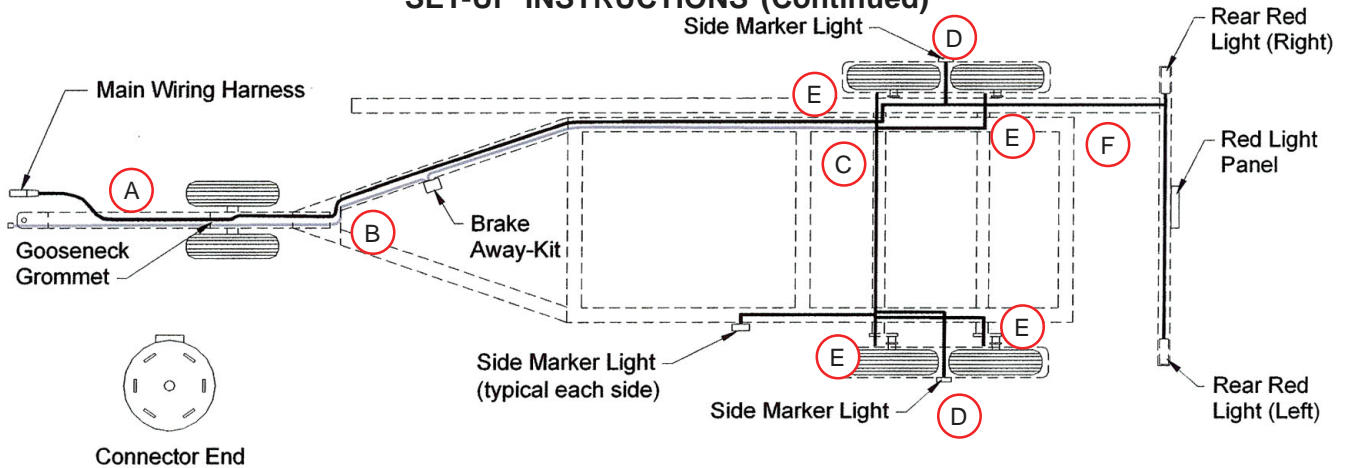

7. Installing the Light and Electric Brake Wiring Harnesses (continued)

G) Connect the Rear Brake-Away Kit Wire to the end of the Main Wiring Harness located at the top of the front Dura-Flex Rear Axle. Extend the harness through the Header Transport Main Frame and Connect to the Brake Away Kit mounted on the inside, right side of the A-Frame. Connect the Brake-Away Cable to the Break-Away Switch mounted on the top of the gooseneck and attach to the rear of the towing vehicle.

H) Secure all wires to the outside of the transport to the Header Transport Main Frame using the small wire clips and self tapping screws, and plastic bands provided.

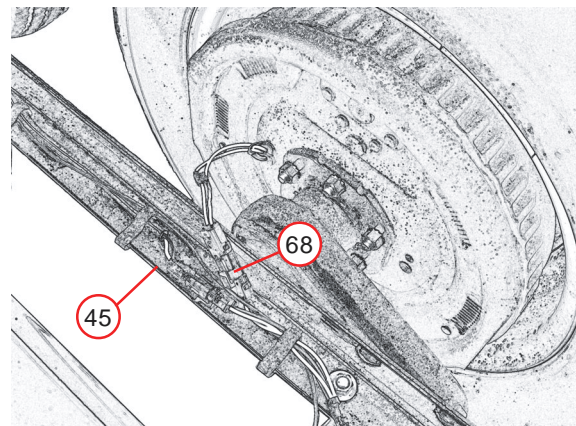
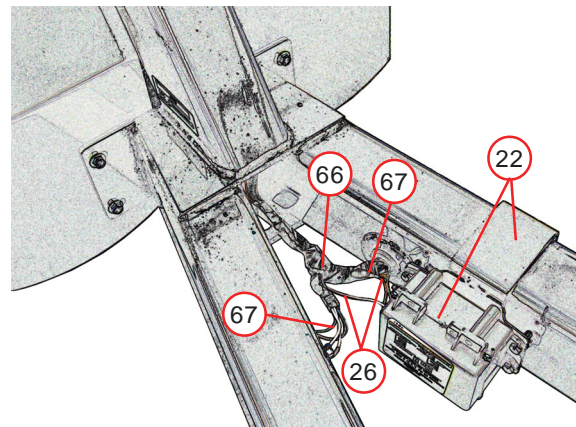
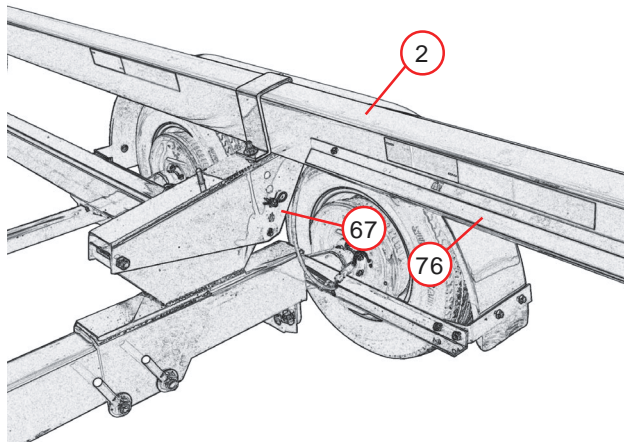
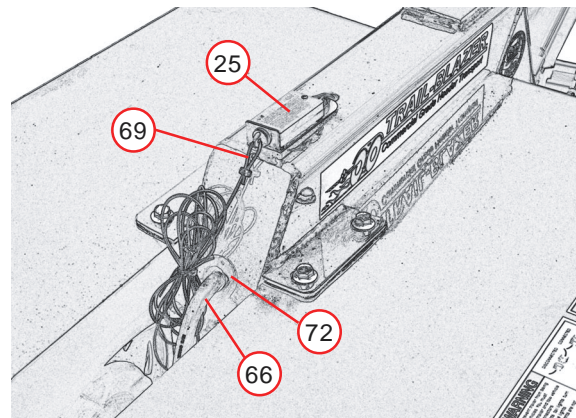

⚠ WARNING

* Be certain all lights and brakes are working properly BEFORE highway travel.

* Use only a 2-5/16" Ball Hitch to transport unit.

REPAIR PARTS DIAGRAMS

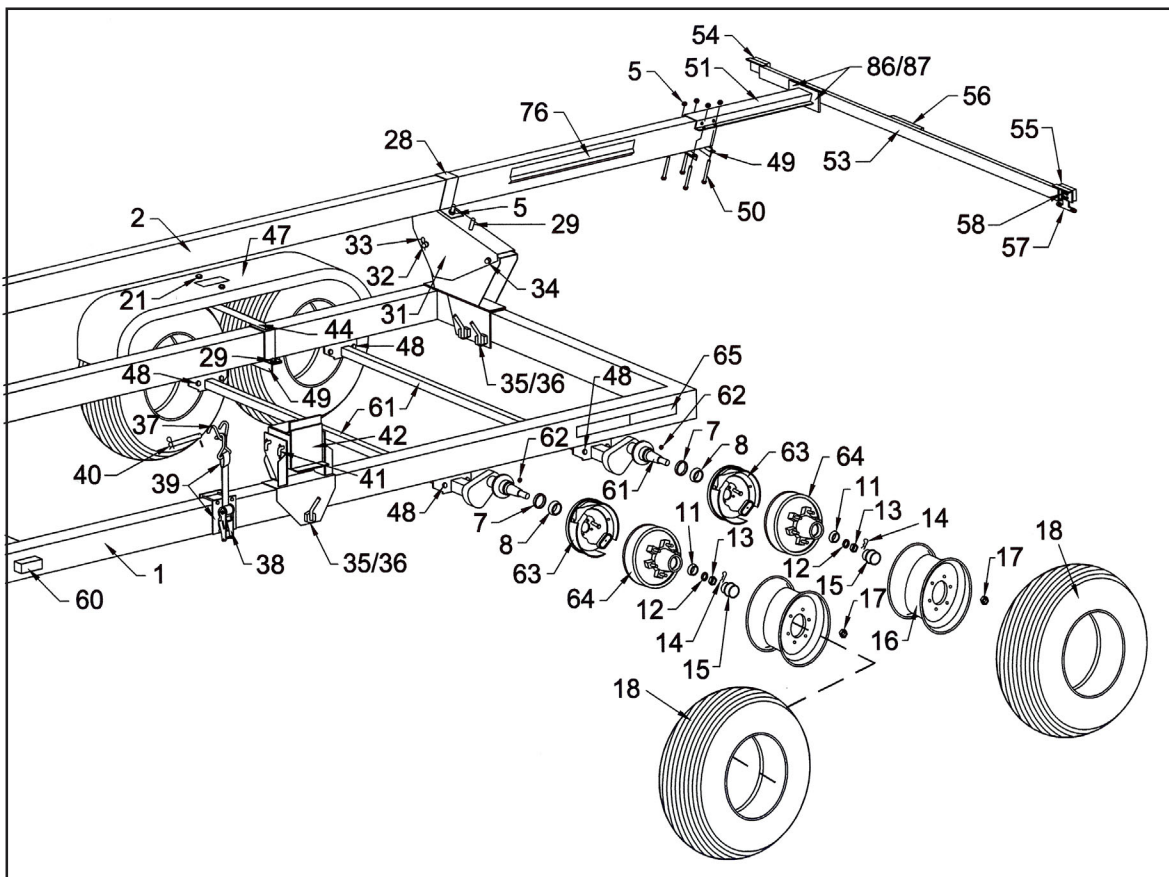
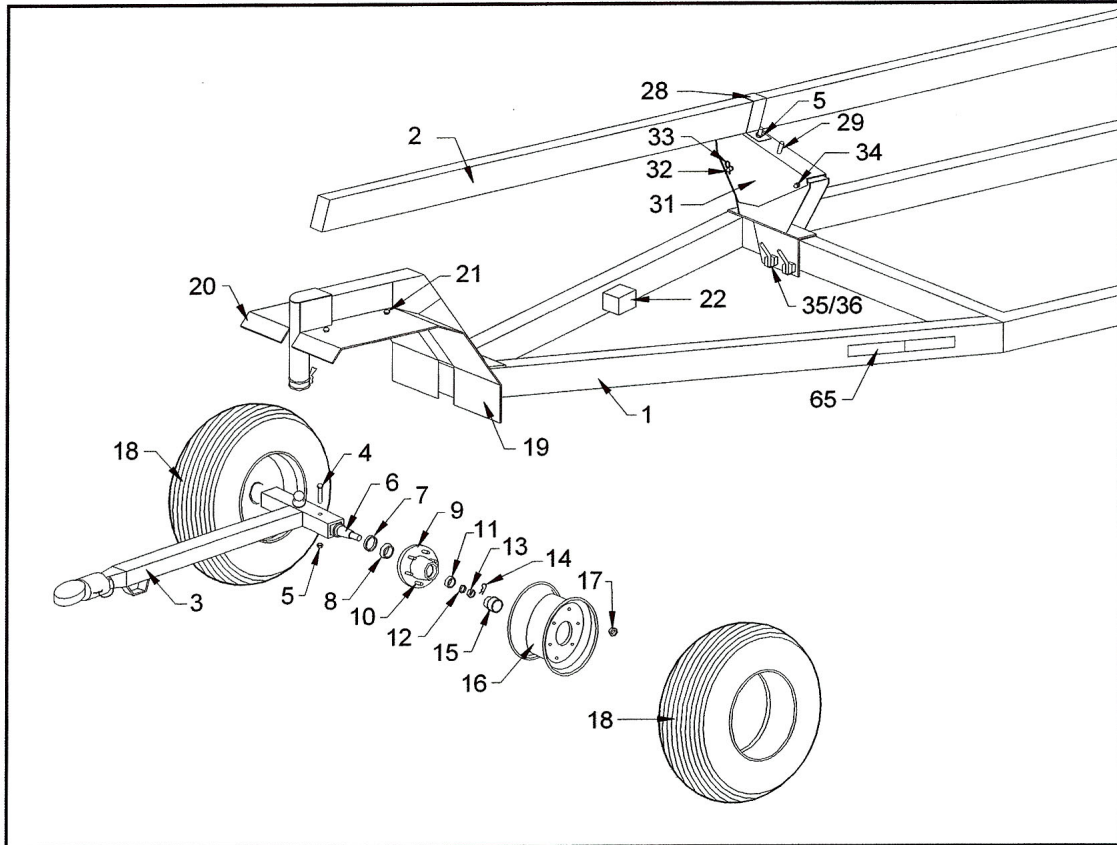

REPAIR PARTS LIST

#	Part #	Description	Qty	#	Part #	Description	Qty
1	HCMF1	Header Transport Main Frame (HS-30B or HS-36B)	1	44	FSA-2	Fender Support Arm	2
2	UB-36	Upper Bar (4" x 6" x 36'-0") (HS-36B)	1	45L	BFSR-L	Base Fender Support Rail (L)	1
	UB-874XL	Upper Bar (4" x 6" x 30'-0") (HS-30B)	1	45R	BFSR-R	Base Fender Support Rail ®	1
3	BHT-1	Ball Hitch Tongue Complete	1	46	381BG5	3/8" x 1" Bolt (Grade 5)	8
4	124BG5	1/2" x 4" Bolt (Grade 5)	1	47	WF-1	Wheel Fender	2
5	12LN	1/2" Lock Nut	1	48	58134B	5/8" x 1-3/4" Bolt	8
6	FS-HC1	Front Spindle	1	49	AIS-2	Angle Iron Support	2
7	027001500	Grease Seal	6	50	125HBN	1/2" x 5" Bolt	4
8	25580	Large Bearing (0170012C)	6	51	EB-1	Extension Bracket	1
9	3160333	Hub, 6 Bolt, with cups and studs	2	52	381HBNF	3/8" x 1" Flange Bolt	2
10	HCWS-1	Wheel Stud	36	53	LMB-2	Light Mounting Bar	1
11	104082	Small Bearing	6	54	RLA-1R	Rear Light Assembly (Right)	1
12	HC-SW	Spindle Washer	6	55	RLA-1L	Rear Light Assembly (Left)	1
13	SN-HC1	Slotted Spindle Nut	6	56	RLP-1	Rear Light Panel	1
14	HC-CP	Cotter Pin	6	57	LPMB-1	License Plate Mounting Bracket	1
15	502019	Dust Cap	6	58	141-BLN	1/4" x 1" Bolt	8
16	WR-156-6HC	Wheel Rim, 15x6 6 hole, HC	6	59	SML-1	Side Marker Light (Fender)	2
17	WN-HC1	Wheel Nut	36	60	SML-2	Side Marker Light (Main Frame)	2
18	15NT	15" New Tire	6	61	7350881	Dura-Flex Axle Weldment Complete with Brakes	2
19	FFL-1	Front Fender (Left)	1	62	38-N	3/8" Regular Nut	16
20	FFR-1	Front Fender (Right)	1	63	3160629G	12" Electric Brake (L/H)	2
21	381FB	3/8" x 1" Flange Bolt	8		3160630G	12" Electric Brake (R/H)	
22	BAK-1C	Break Away Kit Complete	1	64	3160121G	Hub with Brake Drum with Cups and Studs	2
23	HS-B1	Battery for Break Away Kit	1	65	RD-SR1	Silver/Red Reflective Decal	12
24	HS-BB1	Battery Box	1	66	MWH-HS	Main Wiring Harness	1
25	HS-BAS-1	Break Away Switch	1	67	LWH-HS	Light Wiring Harness	1
26	BAW-CW1	Break Away Kit Connecting Wires	2	68	BWH-HS	Brake Wiring Harness	4
27	STS-1	Self Tapping Screws	4	69	CBAK-1	Cable for Break Away Kit	1
28	UBC-2	Upper Bar Clamp	3	70	SML-W1	Side Marker Light Wire (Fender)	2
29	12112BG5	1/2" x 1-1/2" Bolt (Grade 5)	9	71	SML-W2	Side Marker Light Wire (Main Frame)	2
30	WFLSA-1	Fender Lower Support Assy.	2	72	GR-134	Grommet	1
31	AB-HC1	Adjustable Brackets for Upper Bar (2 pcs)	3	73	W-12	Regular Washer	4
32	HP-586	5/8" x 6" Hitch Pin	6	74	EBSLK-1	Electric Brake Shoe and Lining Kit (repair)	4
33	316HP	3/16" Hair Pin	3	75	SC-HS-1	Safety Chain (each)	2
34	MB585	5/8" x 5" Bolt	3	76	UBHC-1	Upper Bar Harness Cover	1
35	78HDN	7/8" Handle Nut	8	77	FLB-4	Fender L-Bracket	4
36	78512BG5	7/8" x 5-1/2" Bolt (Grade 5)	8	78	38-FW	3/8" Flat Washer	8
37	TDS-1	Tie Down Strap and Hook Assembly	2	79	38-LN	3/8" Lock Nut	8
38	RA-1	Ratchet Assembly	2	80	38312312UB	3/8" x 3 1/2" x 3 1/2" U-Bolt	4
39	TDB-2	Tie Down Bracket Complete	2	81	38-RMW	3/8" Rubber/Metal Washer	12
40	CHP-1	Claw Hook & Pin Assembly	2	82	38-WN	3/8" Whiz Nut	28
41	3412P	3/4" x 12" Pin	4	83	58-FW	5/8" Flat Washer	8
42	HM874NS	Adjustable Header Mount with Decals	2	84	58-LN	5/8" Lock Nut	8
43	126BLN	1/2" x 6" Bolt (Grade 5)	8	85	14-LN	1/4" Lock Nut	8
				86	12114FBG5	1/2" x 1 1/4" Gr 5 Flange Bolt	2
				87	12-WN	1/2" Whiz Nut	2

ADJUSTABLE TIE-DOWN BRACKET, HOOK & STRAP ASSEMBLY (TDB-2)

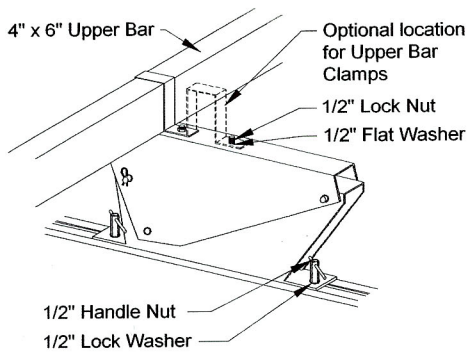

**Some John Deere models
use this system**

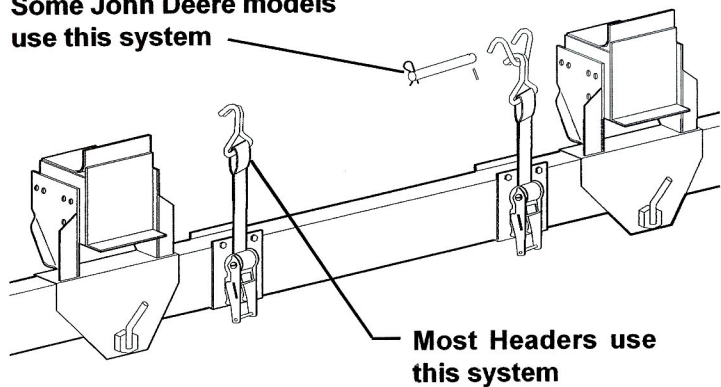

POSSIBLE HEADER MOUNT POSITIONS FOR RECTANGULAR, ROUND AND STAND LEG FRAME HEADERS

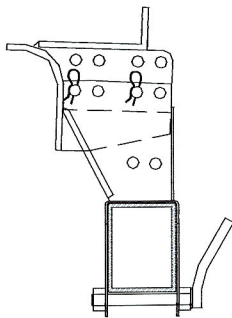

Possible Header Mount positions for Rectangular Frame Headers. The Header Mount can be adjusted up, down, forward or backwards, depending upon the type of header being transported.

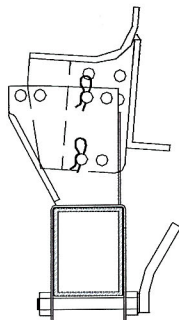

Possible Header Mount positions for Round Frame Headers. The Header Mount can be adjusted up, down, forward or backwards, depending upon the type of header being transported.

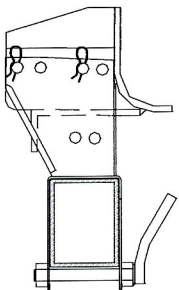

Possible Header Mount positions for Stand Leg Headers. The Header Mount can be adjusted up, down, forward or backwards, depending upon the type of header being transported.

WARNING

INITIAL OPERATION/MAINTENANCE

BE CERTAIN THAT ALL POWER IS SHUT OFF BEFORE SERVICING THE HEADER TRANSPORT

Before the header transport is put into service:

Have all danger, warning, caution and important signs on the equipment been read and understood? If employees or others use or are near this equipment, make sure that they also have read and understood all danger, warning, caution and important signs on the equipment and have also read the operator's manual.

Are all braces, bolts, nuts, lug bolts and lug nuts properly fastened?

Has the header transport been properly fastened to the towing unit? Use a good quality hitch pin with clip and safety chains.



SAFETY CHAIN USER INSTRUCTIONS

- a) Secure the safety chain by looping it around the tongue support located on the underside of the Ball Hitch Tongue and connect to the towing machine's attaching bar.
- b) Do Not allow more slack than necessary for articulation.
- c) Do Not use any intermediate support as the attaching point.
- d) Store the safety chain by securing it around the tongue.
- e) Replace the safety chain if one or more links or end fittings are broken, stretched or otherwise damaged or deformed.

OPERATING INSTRUCTIONS/MAINTENANCE

Adjust the brackets on the header transport to best fit your make and model header. When mounting the header, NEVER position yourself under or near the header. Securely fasten the header to the header transport.

Do not exceed the load and size limits of the unit.

Keep the tires properly inflated. Both under inflation and over inflation can greatly reduce tire life.

Inspect bracing and welds periodically and repair immediately if needed. Failure to repair could cause extensive damage and greatly reduce the life of the unit.

Repack the bearings in the hub assembly once a year or as needed. Use a good quality bearing lubricant such as Bearing Gard MK1 or equivalent.

Be sure to check the hub nuts often and keep them properly tightened.

BRAKING SYSTEM REQUIREMENTS:

WARNING

Tow Loads Safely

Stopping distance increases with speed and weight of towed loads, and on slopes. Towed loads with or without brakes that are too heavy for the tractor or are towed too fast can cause loss of control. Consider the total weight of the equipment and its load.

Observe these recommended maximum road speeds, or local speed limits which may be lower:

If towed equipment does not have brakes, do not travel more than 32 km/h (20 mph) and do not tow loads more than 1.5 times the tractor weight.

If towed equipment does have brakes, do not travel more than 40 km/h (25 mph) and do not tow loads more than 4.5 times the tractor weight.

Ensure the load does not exceed the recommended weight ratio. Use additional caution when towing loads under adverse surface conditions, when turning, and on inclines.

REPORTING SAFETY DEFECTS

J. & M. Manufacturing Co., Inc.
P.O. Box 547
Fort Recovery, OH 45846

Reporting Safety Defects

If you believe that your vehicle has a defect which could cause a crash or could cause injury or death, you should immediately inform the National Highway Traffic Safety Administration (NHTSA) in addition to notifying J. & M. Manufacturing Co., Inc.

If NHTSA receives similar complaints, it may open an investigation, and if it finds that a safety defect exists in a group of vehicles, it may order a recall and remedy campaign. However, NHTSA cannot become involved in any individual problems between you, your dealer, or J. & M. Manufacturing Co., Inc.

To contact NHTSA you may either call the Auto Safety Hotline toll-free at 1-800-424-9393 (366-0123 in Washington, DC area) or write to:

NHTSA
U.S. Department of Transportation
400 7th Street SW, (NSA-11)
Washington, DC 20590

You can also obtain information about motor vehicle safety from the Hotline.

SERVICE / MAINTENANCE RECORD

DATE	DESCRIPTION	NOTES