



Manual

HEADER TRANSPORT OPERATOR'S MANUAL

MODEL

- HT-974
- HT-974L-30
- HT-974L-30X
- HT-974XL-36
- HT-974-16
- HT-974-20

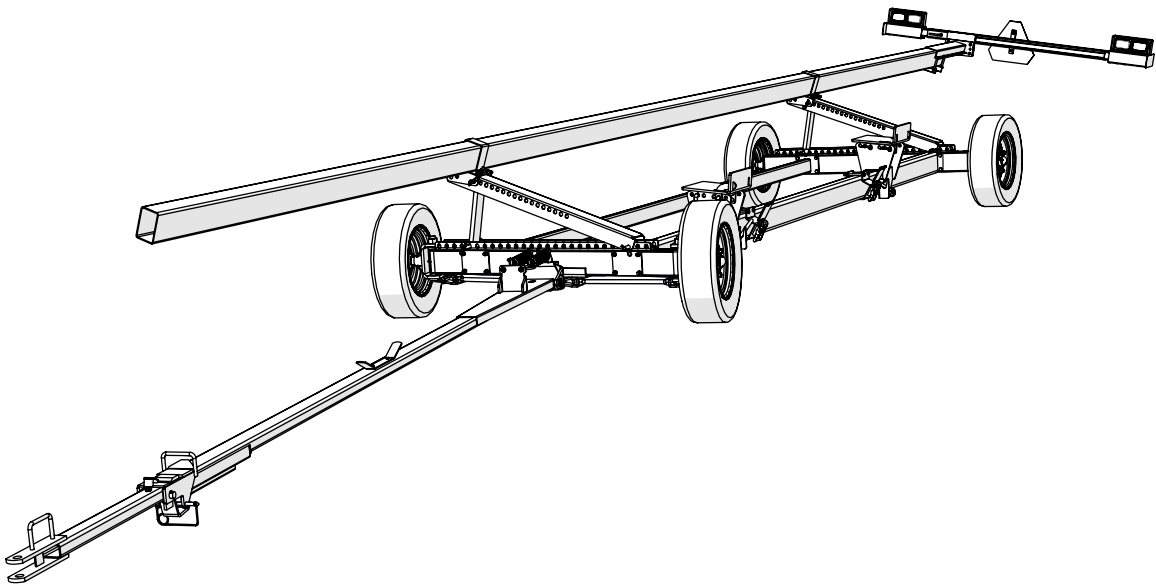

Rev. 7.1.2021

J&M Manufacturing Co, Inc

284 Railroad Street - P.O. Box 547 | Fort Recovery, OH 45846 | Ph: (419) 375-2376 | Fax: (419) 375-2708

www.jm-inc.com

To the Dealer

Read manual instructions and safety rules. Make sure all items on the Dealer's Pre-Delivery and Delivery Check Lists are completed before releasing equipment to the owner.

The dealer must complete the Warranty Registration found on the Dealer Portal website located at dealer.jm-inc.com and return it to J&M Mfg. Co., Inc. at the address indicated on the form. Warranty claims will be denied if the Warranty Registration has not been submitted.

EXPRESS WARRANTY:

J&M Mfg. Co., Inc. warrants against defects in construction or materials for a period of ONE year. We reserve the right to inspect and decide whether material or construction was faulty or whether abuse or accident voids our guarantee.

Warranty service must be performed by a dealer or service center authorized by J&M Mfg. Co., Inc. to sell and/or service the type of product involved, which will use only new or remanufactured parts or components furnished by J&M Mfg. Co., Inc. Warranty service will be performed without charge to the purchaser for parts or labor based on the Warranty Labor Times schedule. Under no circumstance will allowable labor times extend beyond the maximum hours indicated in the Warranty Labor Times schedule for each warranty procedure. The purchaser will be responsible, however, for any service call and/or transportation of the product to and from the dealer or service center's place of business, for any premium charged for overtime labor requested by the purchaser, and for any service and/or maintenance not directly related to any defect covered under the warranty. Costs associated with equipment rental, product down time, or product disposal are not warrantable and will not be accepted under any circumstance.

Each Warranty term begins on the date of product delivery to the purchaser. Under no circumstance will warranty be approved unless (i) the product warranty registration card has been properly completed and submitted to the equipment manufacturer, and (ii) a warranty authorization number has been issued by the equipment manufacturer. This Warranty is effective only if the warranty registration card is returned within 30 days of purchase.

This Warranty does not cover a component which fails, malfunctions or is damaged as a result of (i) improper modification or repair, (ii) accident, abuse or improper use, (iii) improper or insufficient maintenance, or (iv) normal wear or tear. This Warranty does not cover products that are previously owned and extends solely to the original purchaser of the product. Should the original purchaser sell or otherwise transfer this product to a third party, this Warranty does not transfer to the third party purchaser in any way. J&M Mfg. Co., Inc. makes no Warranty, express or implied, with respect to tires or other parts or accessories not manufactured by J&M Mfg. Co., Inc. Warranties for these items, if any, are provided separately by their respective manufacturers.

THIS WARRANTY IS EXPRESSLY IN LIEU OF ALL OTHER WARRANTIES OR CONDITIONS, EXPRESS, IMPLIED OR STATUTORY, INCLUDING ANY IMPLIED WARRANTY OF MERCHANTABILITY OR FITNESS FOR PARTICULAR PURPOSE.

In no event shall J&M Mfg. Co., Inc. be liable for special, direct, incidental or consequential damages of any kind. The exclusive remedy under this Warranty shall be repair or replacement of the defective component at J&M Mfg. Co., Inc.'s option. This is the entire agreement between J&M Mfg. Co., Inc. and the Owner about warranty and no J&M Mfg. Co., Inc. employee or dealer is authorized to make any additional warranty on behalf of J&M Mfg. Co., Inc.

The manufacturer reserves the right to make product design and material changes at any time without notice. They shall not incur any obligation or liability to incorporate such changes and improvements in products previously sold to any customer, nor shall they be obligated or liable for the replacement of previously sold products with products or parts incorporating such changes.

SERVICE:

The equipment you have purchased has been carefully manufactured to provide dependable and satisfactory use. Like all mechanical products, it will require cleaning and maintenance. Lubricate the unit as specified. Observe all safety information in this manual and safety signs on the equipment.

For service, your authorized J&M dealer has trained mechanics, genuine J&M service parts, and the necessary tools and equipment to handle all your needs.

Use only genuine J&M service parts. Substitute parts may void warranty and may not meet standards required for safety and satisfactory operation. Record the model number and serial number of your equipment in the spaces provided:

Model No: HT-974 Header Wagon **Serial No:** _____ **Date of Purchase:** _____

Purchased From: _____

Provide this information to your dealer to obtain correct repair parts.



Table of Contents

General Information	4
Safety Rules.....	4
Bolt Torque Chart	5
Stud and Wheel Nut Torque Specifications	5
Specs and Dimensions	6
Initial Operation/Maintenance.....	7
Service	8
Repair Parts List and Diagrams	
Decals	9
Main Frame & Bars	10
Tongue Assembly	12
Upper Bar Mounts	14
Header Mounts and Straps	15
Axle Weldments	16
Spindle & Tire Assemblies	17
Light Kit	19
Set Up Instructions.....	20
Set Up Assembly	21



General Information

TO THE OWNER:

The purpose of this manual is to assist you in operating and maintaining your header transport in a safe manner. Read it carefully. It furnishes information and instructions that will help you achieve years of dependable performance and help maintain safe operating conditions. If this machine is used by an employee or is loaned or rented, make certain that the operator(s), prior to operating:

1. Is instructed in safe and proper use.
2. Reviews and understands the manual(s) pertaining to this machine.

Throughout this manual, the term **IMPORTANT** is used to indicate that failure to observe can cause damage to equipment. The terms **CAUTION**, **WARNING** and **DANGER** are used in conjunction with the Safety-Alert Symbol (a triangle with an exclamation mark) to indicate the degree of hazard for items of personal safety. When you see this symbol, carefully read the message that follows and be alert to the possibility of personal injury or death.



This Safety-Alert symbol indicates a hazard and means **ATTENTION! BECOME ALERT! YOUR SAFETY IS INVOLVED!**



DANGER

Indicates an imminently hazardous situation that, if not avoided, will result in death or serious injury.



WARNING

Indicates a potentially hazardous situation that, if not avoided, could result in death or serious injury, and includes hazards that are exposed when guards are removed.



CAUTION

Indicates a potentially hazardous situation that, if not avoided, may result in minor or moderate injury.

IMPORTANT

Indicates that failure to observe can cause damage to equipment.

NOTE

Indicates helpful information.

Safety Rules

ATTENTION! BECOME ALERT! YOUR SAFETY IS INVOLVED!

Safety is a primary concern in the design and manufacture of our products. Unfortunately, our efforts to provide safe equipment can be erased by an operator's single careless act. In addition, hazard control and accident prevention are dependent upon the awareness, concern, judgment, and proper training of personnel involved in the operation, transport, maintenance and storage of equipment.

Make certain that the operator(s), prior to operating is instructed in safe and proper use and reviews and understands the manual(s) pertaining to this machine.

Read this manual before you operate this machine. If you do not understand any part of this manual, or need more information, contact the manufacturer or your authorized dealer.

SAFETY

Understand that your safety and the safety of other persons is measured by how you service and operate this machine. Know the positions and functions of all controls before you try to operate them. Make sure to check all controls in a safe area before starting your work.

The safety information given in this manual does not replace safety codes, federal, state or local laws. Make certain your machine has the proper equipment as designated by local laws and regulations.

A frequent cause of personal injury or death is from persons falling off equipment and being run over. Do not permit persons to ride on this machine.

Travel speeds should be such that complete control and machine stability is maintained at all times. Where possible, avoid operating near ditches, embankments and holes. Reduce speed when turning, crossing slopes and rough, slick or muddy surfaces.

Collision of high speed road traffic and slow moving machines can cause personal injury or death. On roads, use flasher lights according to local laws. Keep slow-moving-vehicle emblem visible. Pull over to let faster traffic pass.

Make sure that the header is fastened securely to the transport before moving.

Make sure that everyone is clear of equipment before applying power or moving the machine. **NEVER** position yourself under or near header when mounting on the header transport.

Safety Rules

Make sure that the implement is fastened securely to the tractor by using the proper hitch pin, clip and safety chains.

Before unhooking the implement from the towing unit, be sure to properly block the wheels to prevent the implement from moving.

Never overload the header transport. Overloading the header transport is dangerous and can cause extensive damage.

Do NOT exceed speeds in excess of 25 MPH. The header transport is designed for heavy loads at slow speeds. Also be sure slow moving vehicle emblem is attached to rear of wagon.

IMPORTANT: Use caution when transporting. Be alert of the transport unit's overall width when approaching obstacles, such as post signs and poles, along the road. Check the transport width of the unit to ensure clearance before entering bridges.

COMPLY WITH ALL SAFETY WARNINGS AND CAUTIONS IN THIS MANUAL AND IN THE COMBINE OPERATOR'S MANUAL.

WARNING: BE SURE ALL LIGHTS ARE WORKING PROPERLY BEFORE HIGHWAY TRAVEL.

Bolt Torque Chart

Always tighten hardware to these values unless a different torque or tightening procedure is listed for specific application. Fasteners must always be replaced with the same grade as specified in the manual parts list. Always use the proper tool for tightening hardware. Make sure fastener threads are clean and you start thread engagement properly. **Use these values when tightening all bolts and nuts with the exception of wheel nuts.**

SAE Fasteners

Coarse Thread Series				
Diameter and Pitch (Inches)	Grade 5		Grade 8	
	Dry	Oiled	Dry	Oiled
1/4"-20	8 ft-lbs	6 ft-lbs	12 ft-lbs	9 ft-lbs
5/16"-18	17	13	25	18
3/8"-16	31	23	44	33
7/16"-14	49	37	70	52
1/2"-13	75	57	106	80
9/16"-12	109	82	154	115
5/8"-11	150	113	212	159
3/4"-10	267	200	376	282
7/8"-9	429	322	606	455
1"-8	644	483	909	681
Fine Thread Series				
Diameter and Pitch (Inches)	Grade 5		Grade 8	
	Dry	Oiled	Dry	Oiled
1/4"-28	10 ft-lbs	7 ft-lbs	14 ft-lbs	10 ft-lbs
5/16"-24	19	15	27	20
3/8"-24	35	26	49	37
7/16"-20	55	41	78	58
1/2"-20	85	64	120	90
9/16"-18	121	91	171	128
5/8"-18	170	127	240	180
3/4"-16	297	223	420	315
7/8"-14	474	355	669	502

Stud and Wheel Nut Torque Specifications

Always tighten hardware to these values unless a different torque or tightening procedure is listed for specific application. Fasteners must always be replaced with the same grade as specified in the manual parts list. Always use the proper tool for tightening hardware. Make sure fastener threads are clean and you start thread engagement properly. **Use these values when tightening all studs and wheel nuts.**

Stud	Tightening Torque
1/2"-20	120 ft-lbs
9/16"-18	170 ft-lbs
5/8"-18	300 ft-lbs
3/4"-16	400 ft-lbs
20mm	475 ft-lbs
22mm	640 ft-lbs

TIGHTENING WHEEL NUTS: Standard **1/2" wheel studs and nuts should be tightened to torque 120 ft-lbs.** During initial operation of the header transport and then checked for proper torque after every 10 hours of use. Failure to do so may damage wheel nut seats. Once seats are damaged, it will become impossible to keep nuts tight.



Specs and Dimensions

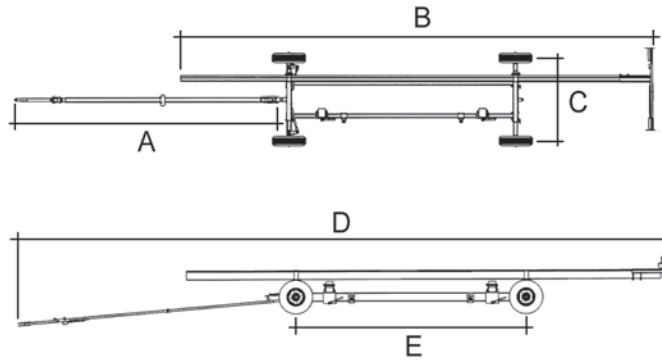

Dimensions						
	HT-974	HT-974L-30	HT-974L-30X	HT-974XL-36	HT-974-16	HT-974-20
A	12'-0"	15'-0"	15'-0"	17'-0"	6'-2"	6'-2"
B	27'-0"	32'-0"	32'-0"	38'-0"	16'-10"	20'-5"
C	6'-2"	6'-2"	6'-2"	6'-2"	6'-2"	6'-2"
D	33'-6"	39'-9"	36'-9"	44'-9"	23'-5"	27'-1"
E	13'-10"	16'-6"	24'-4"	16'-6"	14'-4"	18'-4"

Specifications						
	HT-974	HT-974L-30	HT-974L-30X	HT-974XL-36	HT-974-16	HT-974-20
Weight	1,540 lbs	1,755 lbs	1,870 lbs	1,830 lbs	1,580 lbs	1,725 lbs
Capacity (Net)	7,500 lbs	10,700 lbs	10,500 lbs	10,620 lbs	10,800 lbs	11,000 lbs
Spindle Size	1-3/4" Diameter	1-3/4" Diameter	1-3/4" Diameter	1-3/4" Diameter	1-3/4" Diameter	1-3/4" Diameter
Wheel Size	14"x6"-6 Bolt	15"x6"-6 Bolt	15"x6"-6 Bolt	15"x6"-6 Bolt	15"x6"-6 Bolt	15"x6"-6 Bolt
Tire Size	215/75R14-D	225/75R15-E	225/75R15-E	225/75R15-E	225/75R15-E	225/75R15-E
Steel Upper Bar	4"x6"	4"x6"	4"x6"	4"x6"	4"x6"	4"x6"
Upper Bar Length	25'	30'	30'	36'	20'	20'
Box Channel Axle Frame	6"	6"	6"	6"	6"	6"

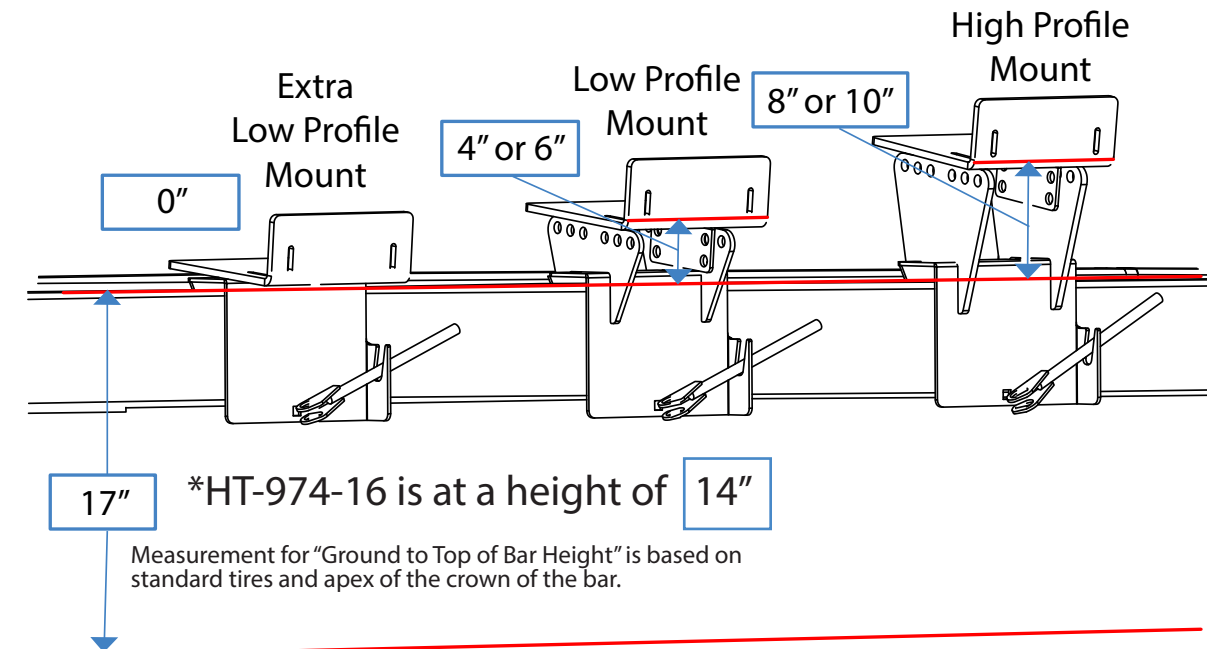

Initial Operation/Maintenance

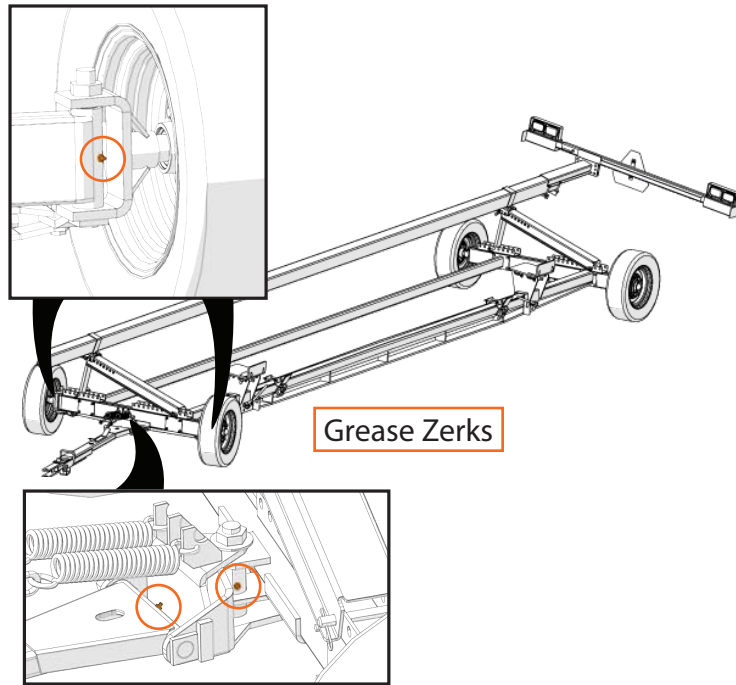

INITIAL OPERATION / MAINTENANCE

BE CERTAIN THAT ALL POWER IS SHUT OFF BEFORE SERVICING THE HEADER TRANSPORT

Before the header transport is put into service:

- Has the Slow-Moving Vehicle Emblem been properly positioned at the rear of the header transport?
- Have all danger, warning, caution and important signs on the equipment been read and understood? If employees or others use or are near this equipment, make sure that they also have read and understood all danger, warning, caution, and important signs on the equipment and have also read the operators manual.
- Are all braces, bolts, nuts, lug bolts and lug nuts properly fastened?
- Has the header transport been properly fastened to the towing unit? Use a good quality hitch pin with clip and safety chains.
- Are the rear amber extremity lights properly positioned? Extend lights within 16" of the left and right extremities of the header.

OPERATING INSTRUCTIONS/ MAINTENANCE

- Adjust the brackets on the header transport to best fit your make and model header. When mounting the header, NEVER position yourself under or near the header.
- Do not exceed the load and size limits of the unit.
- Keep the tires properly inflated. Both under inflation and over inflation can greatly reduce tire life.
- Inspect bracing and welds periodically and repair immediately if needed. Failure to repair could cause extensive damage and greatly reduce the life of the unit.
- Repack the bearings in the hub assembly once a year or as needed. Use a good quality bearing lubricant such as Bearing Guard MK1 or equivalent.
- Insert the amount of grease needed into all of the grease zerks shown in the image above.
- Be sure to check the hub nuts often and keep them properly tightened.
- Check alignment of tires yearly. Adjust the push pull bar to realign the tires if needed.



Service

Adjusting the Wheel Toe-In

1. Locate the tongue in the straight and horizontal position. Check this by measuring reference lines "A" and "B". These measurements are the same when the tongue is straight forward.
2. To adjust the toe-in of the tire on the front axle, measure the distance between the wheels at the centerline of the tires. Dimension "C" should be $1/8"$ to $1/4"$ shorter than dimension "D". If not, loosen the locknuts on both ends of both front tie rods. Adjust both front tie rods evenly as needed. Re-tighten the locknuts and recheck the dimensions.

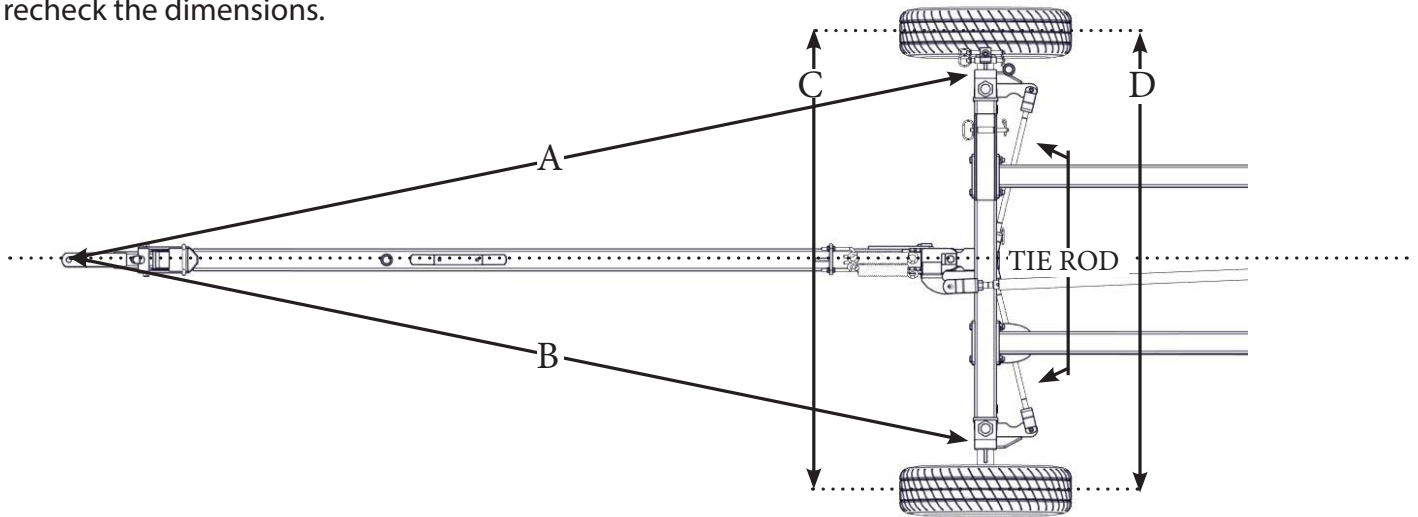

Repair Parts List and Diagrams

When performing maintenance work, wear sturdy, rough-soled work shoes and protective equipment for eyes, hair, hands, hearing and head. Follow the Operator's Manual instructions to ensure safe and proper maintenance and repair.

Your local, authorized dealer can supply genuine replacement parts. Substitute parts may not meet original equipment specifications and may be dangerous.

⚠ WARNING MAKE SURE ALL POWER IS SHUT OFF BEFORE PERFORMING ANY MAINTENANCE OR REPAIR WORK.

Decals

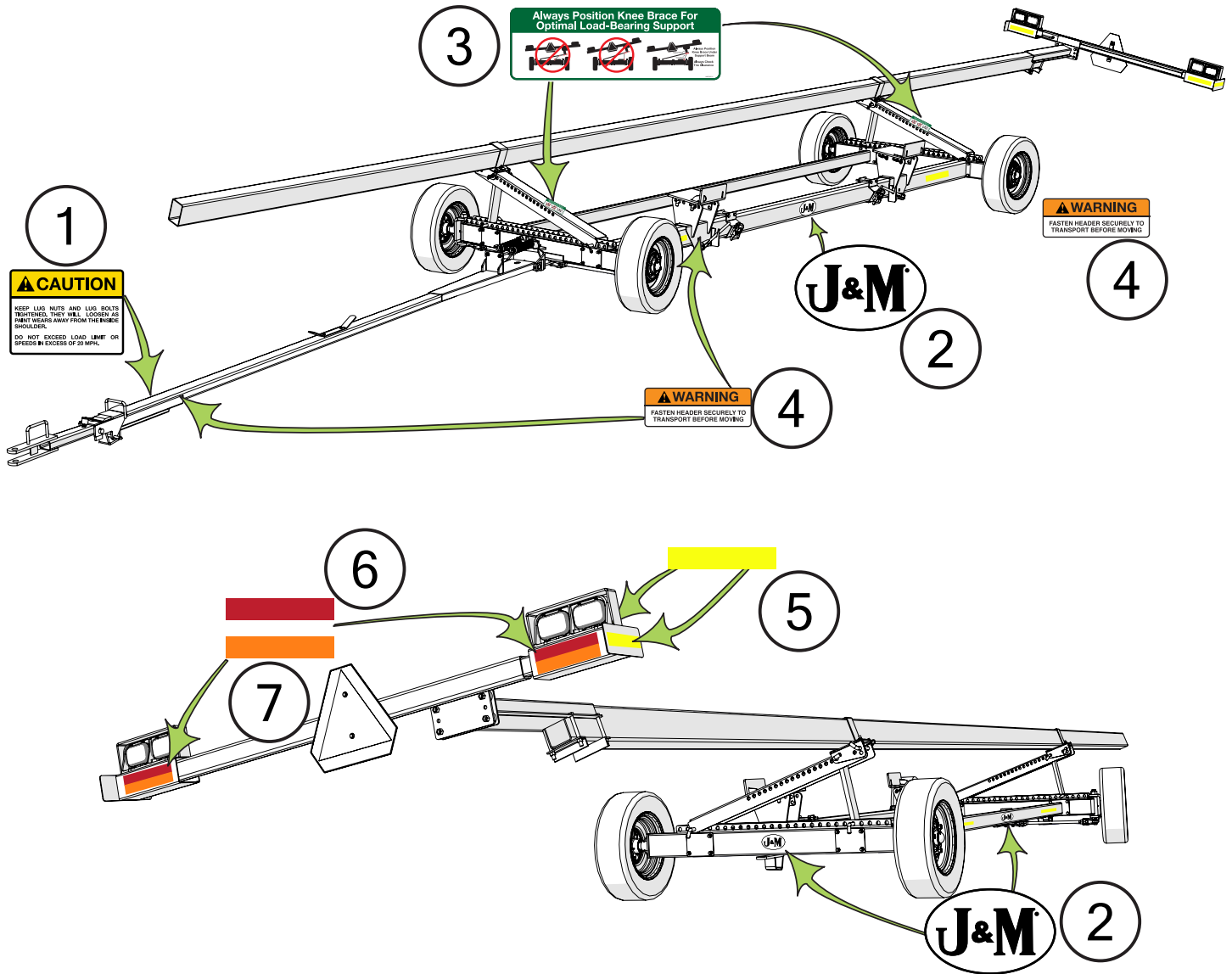

Description	Part No.
1 Caution - Keep Lug Nut Tight / Do Not Exceed Load Limit - Decal	JM0019220
2 J&M Oval Decal (Small) 3-5/8" x 5-1/4"	JM0015150
3 HT - Knee Brace Set Up Decal	JM0026114
4 Warning - Fasten Header Securely To Transport Before Moving Decal	JM0039381
5 Amber Reflective Decal 2" x 9"	JM0009946
6 Red Reflective Decal 2" x 9"	JM0009945
7 Orange Reflective Decal 2" x 9"	JM0009944

Main Frame & Bars

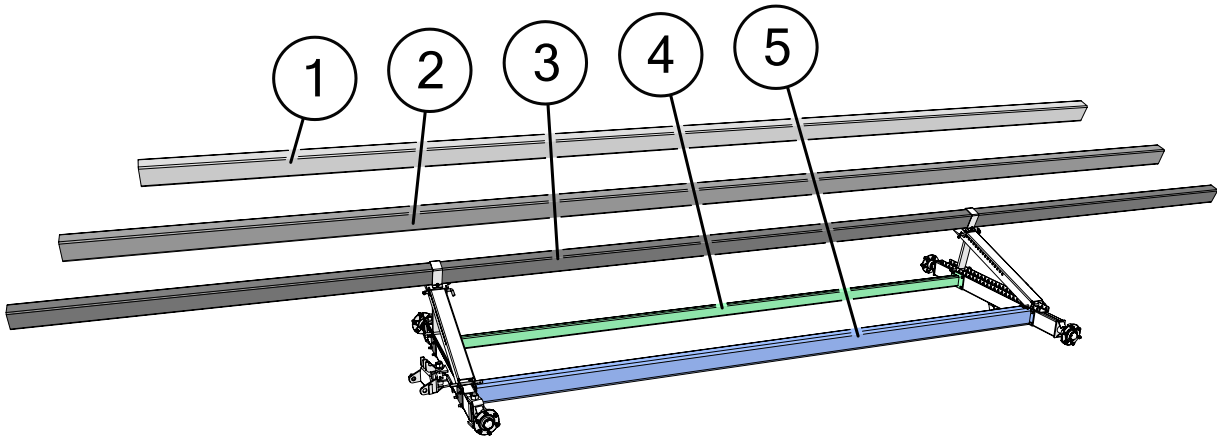

HT-974
HT-974L-30
HT-974XL-36

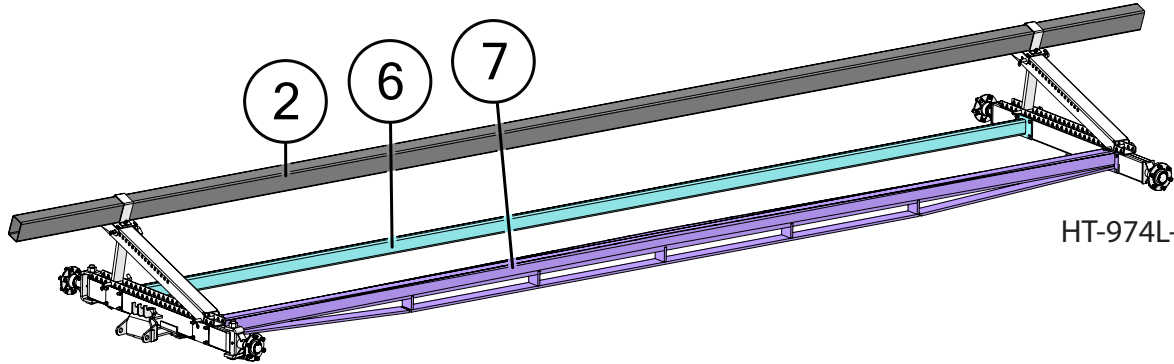

HT-974L-30X

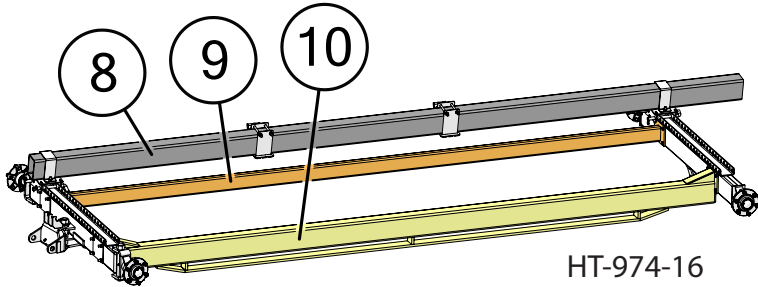

HT-974-16

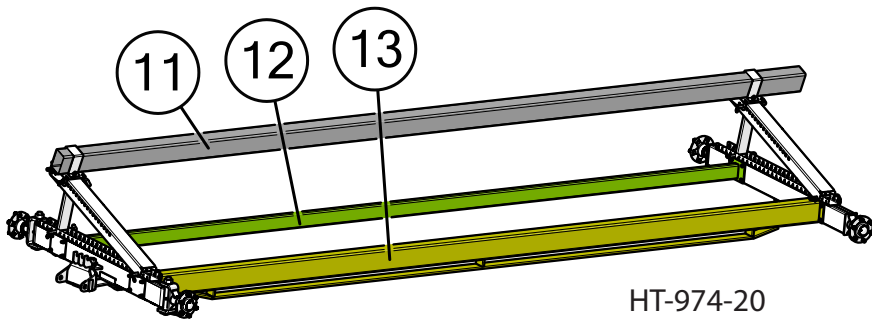

HT-974-20

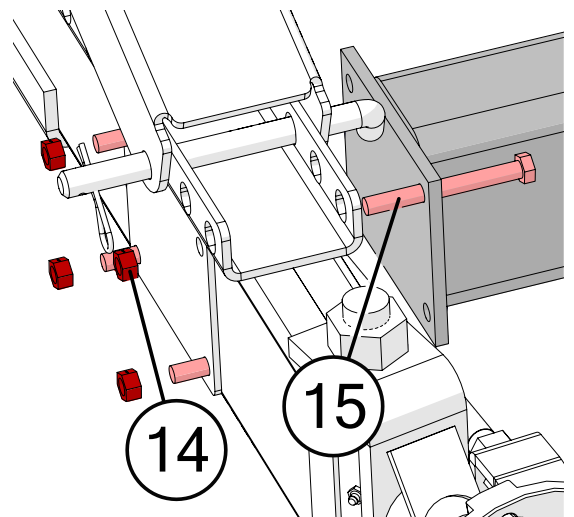

Main Frame & Bars

	Description	Part No.
1	4" x 6" x 25' Upper Bar (UB-874S)	JM0030203
2	4" x 6" x 30' Upper Bar (UB-874SXL)	JM0030201
3	4" x 6" x 36' Upper Bar (UB-874SXL-36)	JM0030205
4	2" x 4" x 152" Small Lower Bar (SLB-874)	JM0030175
4	2" x 4" x 194" Small Lower Bar (HT-874XL)	JM0030197
5	4" x 6" x 152" Large Lower Bar Weldment (LLB-874)	JM0030179
5	4" x 6" x 194" Large Lower Bar Weldment (LLB-874XL)	JM0030188
6	2" x 4" x 288" Small Lower Bar Weldment (HT-974)	JM0059379
7	4" x 6" x 288" Large Lower Bar Weldment Trussed (HT-974)	JM0061371
8	4" x 6" x 16' Upper Bar (HT-974)	JM0046202
9	2" x 4" x 168" Small Lower Bar Weldment (HT-974)	JM0046203
10	4" x 6" x 168" Large Lower Bar Weldment Trussed (HT-974)	JM0046206
11	4" x 6" x 20' Upper Bar (HT-974)	JM0045427
12	2" x 4" x 216" Small Lower Bar Weldment (HT-974)	JM0045430
13	4" x 6" x 216" Large Lower Bar Weldment Trussed (HT-974)	JM0044987
14	1/2"-13 Gr2 Z Centerlock Hex Nut	JM0001511
15	1/2"-13 x 4-1/2" Gr5 Z Hex Bolt	JM0008548

Tongue Assembly

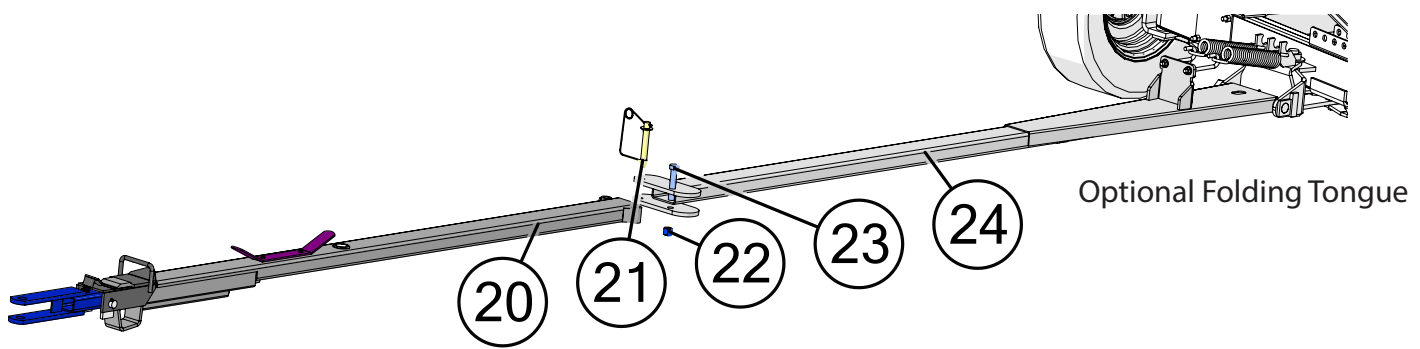
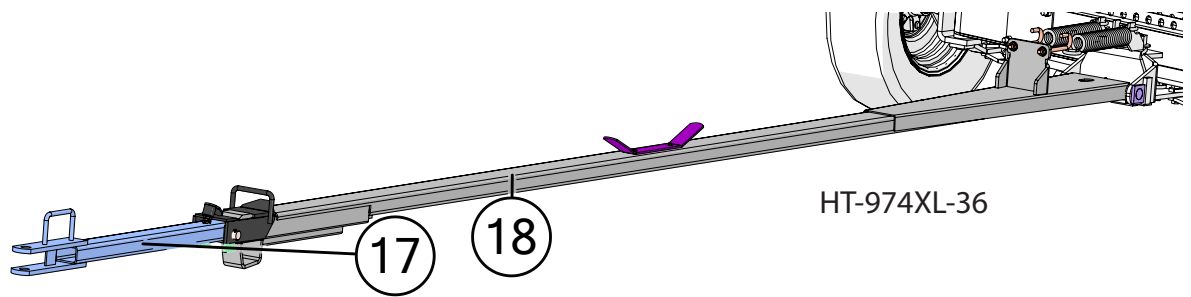
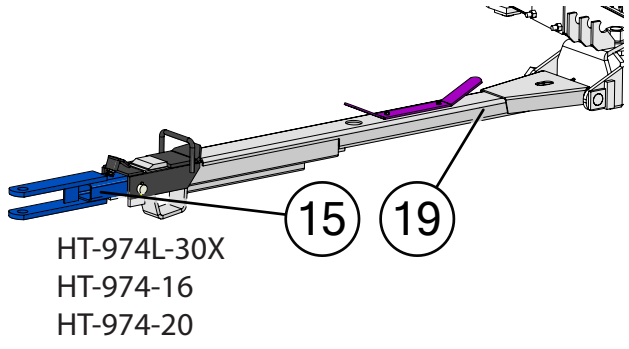
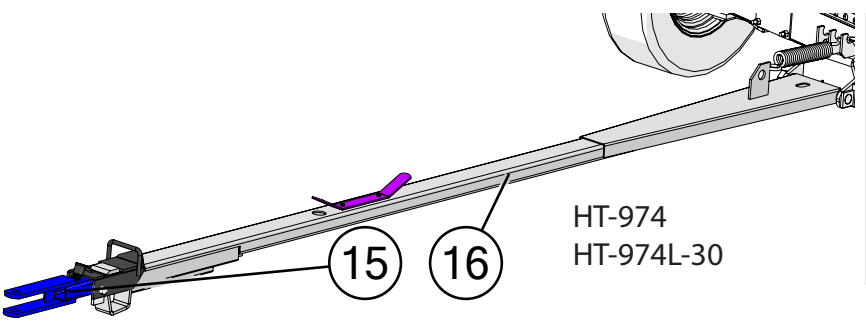
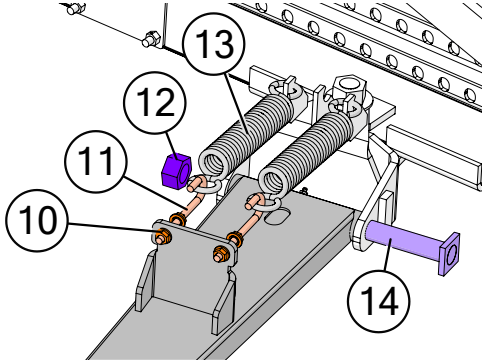
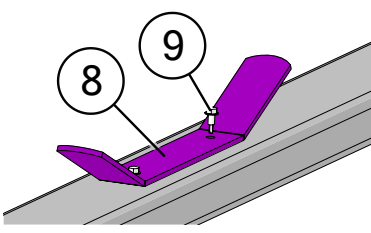
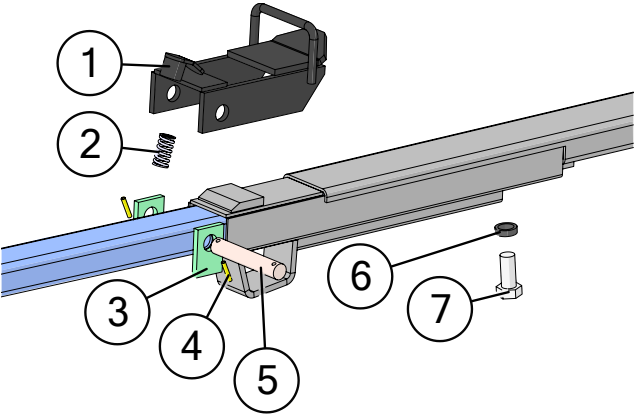

Tongue Assembly

	Description	Part No.
1	Tongue Latch (Flapper Weldment) 10 Ton	JM0003033
2	Compression Spring (1" x 1-3/4") for Door Assembly & Tongue Latch	JM0001688
3	Spacer Blocks, 2-1/2", 6-15 Ton (SB-212)	JM0003032
4	1/4" x 1-3/8" Roll Pin	JM0009896
5	1" x 5-3/4" Flapper Pivot Shaft (LS-610)	JM0027732
6	Tongue Stop Bolt Ring	JM0001649
7	7/8"-9 x 2" Gr5 Z Hex Bolt	JM0002108
8	Wire Harness Storage Bracket (WHB-1)	JM0001438
9	1/4" x 3/4" Self Tapping Screw	JM0001570
10	1/2"-13 Gr5 Z SF Hex Nut	JM0002153
11	1/2"-13 x 6" Gr5 Z J-Bolt	JM0002168
12	1-1/4"-7 Gr2 Z Hex Nut	JM0001700
13	Large Tongue Spring 3/8" x 2" x 12-1/2" (GDP) TS-615H	JM0014200
14	1-1/4" x 11-3/4" Tongue Bolt (6-10 Ton Horizontal)	JM0027667
15	Short Inner Tongue (40") (Header Transport)	JM0001683
16	12' Outer Tongue Weldment (OT-HT974)	JM0030108
16	14'7" Outer Tongue Weldment 1 Spring (OT-HT974L)	JM0030106
17	Long Inner Tongue 65" (Header Transport)	JM0030165
18	14'7" Outer Tongue Weldment 2 Springs (OT-HT974XL)	JM0030160
19	59" Outer Tongue Weldment (974-16, 974-20, 4WS-HD)	JM0046959
20	HT-974 Folding Tongue Front Half	JM0075914
21	3/4" x 4" Lynch Pin	JM0075930
22	3/4"-10 Gr2 Z Nylon Locking Hex Nut	JM0026756
23	3/4"-10 x 4" Gr5 Z Hex Bolt	JM0009863
24	HT-974 Folding Tongue Back Half	JM0075909

Upper Bar Mounts

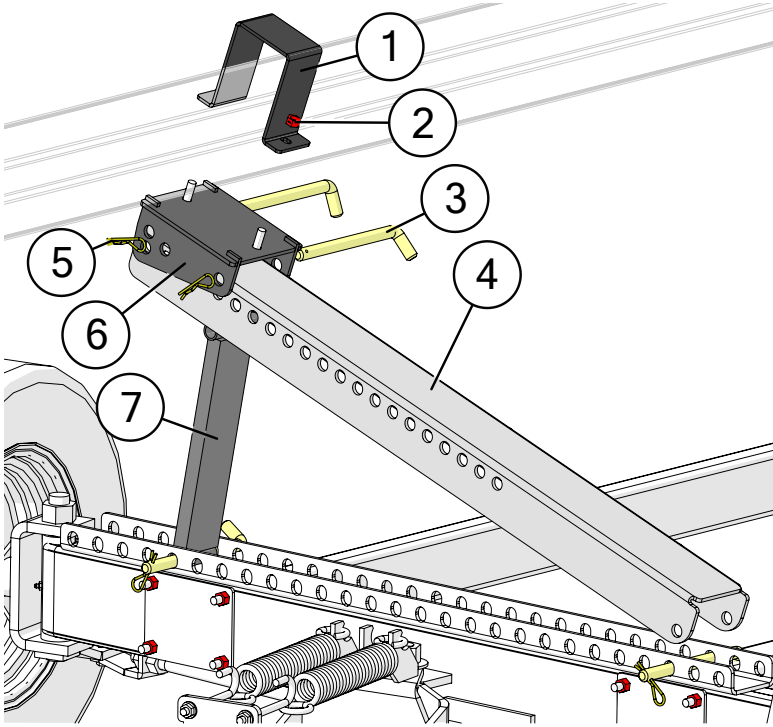

Stalk Roller Scissor Arm and Upper Bar Mount

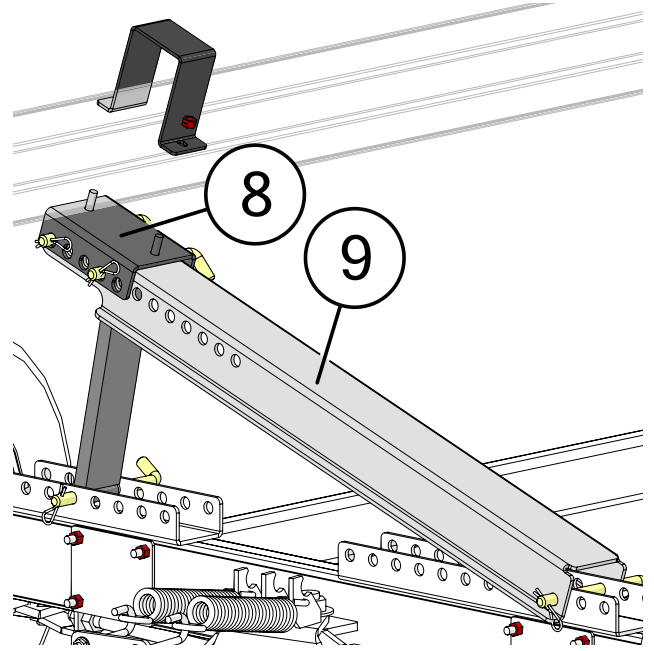

Standard Scissor Arm and Upper Bar Mount

Description	Part No.
1 Upper Bar Clamp (4x6) (UBC-2)	JM0028447
2 1/2"-13 Gr2 Z Centerlock Hex Nut	JM0001511
3 3/4" x 8" Z L Pin (Header Wagon, c450)	JM0029738
4 HT974 Scissor Arm (Stalk Roller Option)	JM0054841
5 3/16" x 2-1/2" Hair Clip Pin (316HP)	JM0001657
6 HT974 Upper Bar Mount/Slide Mount with Tilt	JM0062925
7 Upper Bar Support Arm (UBSA-3)	JM0003077
8 Upper Bar Slide Mount (UBSM-3)	JM0015133
9 Upper Bar Channel Mount 3/4" (UBCM-3)	JM0029588

Header Mounts and Straps

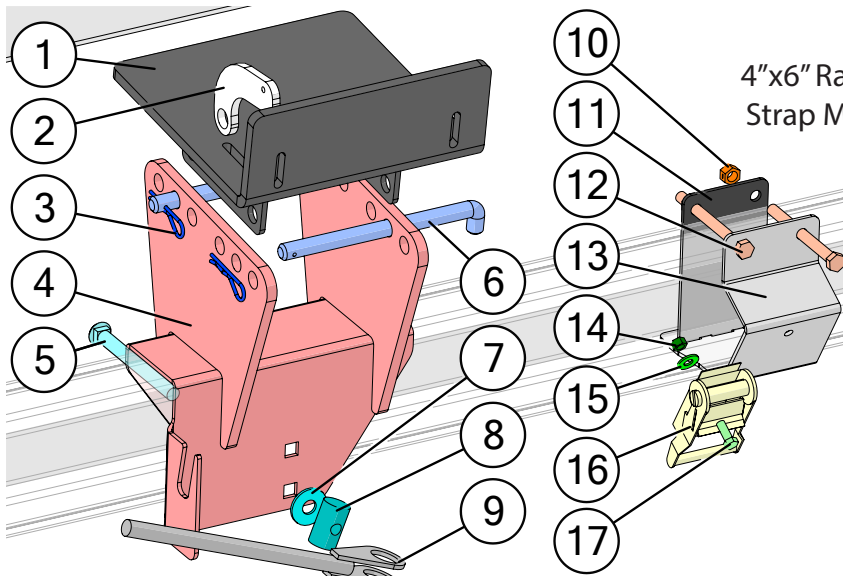

4"x6" Ratchet Strap Mount

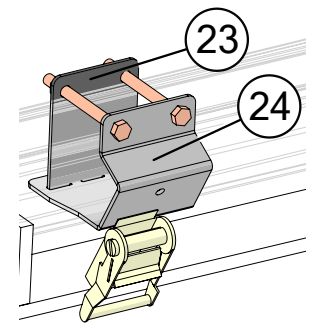

4"x4" Ratchet Strap Mount for HT-974L-30X

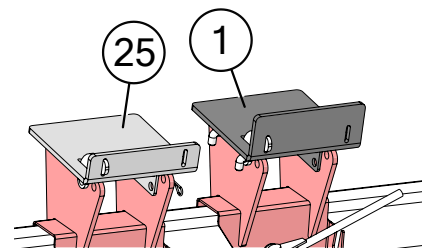
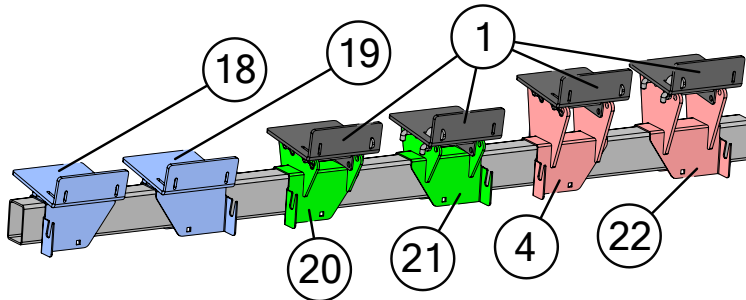

Stalk Roller Upper Header Mount on left.
Standard Upper Header Mount on right

Description	Part No.
1 Upper Header Wagon Mount	JM0014351
2 Removable Header Stop Gusset	JM0003075
3 3/16" x 2-1/2" Hair Clip Pin (316HP)	JM0001657
4 High Profile Bottom Mount Weldment 4" x 6" (Front)	JM0032573
5 5/8"-11 x 6-1/2" Gr5 Z Carriage Bolt	JM0001651
6 3/4" L Pin (10-9/32" Length)	JM0003076
7 5/8" USS Flat Washer	JM0003073
8 Header Saddle Mount Bolt (Coupler)	JM0001653
9 Clamp Handle Weldment (CHA2)	JM0001656
10 1/2"-13 Gr2 Z Centerlock Hex Nut	JM0001511
11 60 Degree Ratchet Strap Bracket Back Plate for 4" x 6" Tube	JM0044977
12 1/2"-13 x 5" Gr5 Z Hex Bolt	JM0001594
13 60 Degree Ratchet Strap Bracket Front Plate for 4" x 6" Tube	JM0044978
14 3/8"-16 Gr2 Z Centerlock Hex Nut	JM0001512
15 3/8" ID, 1" OD Z Flat Washer	JM0003061
16 2" Tie-Down Ratchet (10,000 lb) (RA-1)	JM0003084
17 3/8"-16 x 1" Gr8 YZ Hex Bolt	JM0001485
18 Extra Low Profile Mount 4" x 6" Saddle (Front)	JM0046210
19 Extra Low Profile Mount 4" x 6" Saddle (Back)	JM0028948
20 Low Profile Bottom Mount Weldment 4" x 6" (Front)	JM0037718
21 Low Profile Bottom Mount Weldment 4" x 6" (Back)	JM0003072
22 High Profile Bottom Mount Weldment 4" x 6" (Back)	JM0007140
23 60 Degree Ratchet Strap Bracket Back Plate for 4" x 4" Tube	JM0061529
24 60 Degree Ratchet Strap Bracket Front Plate for 4" x 4" Tube	JM0061530
25 Upper Header Wagon Mount with Short Lip	JM0054856

Axle Weldments

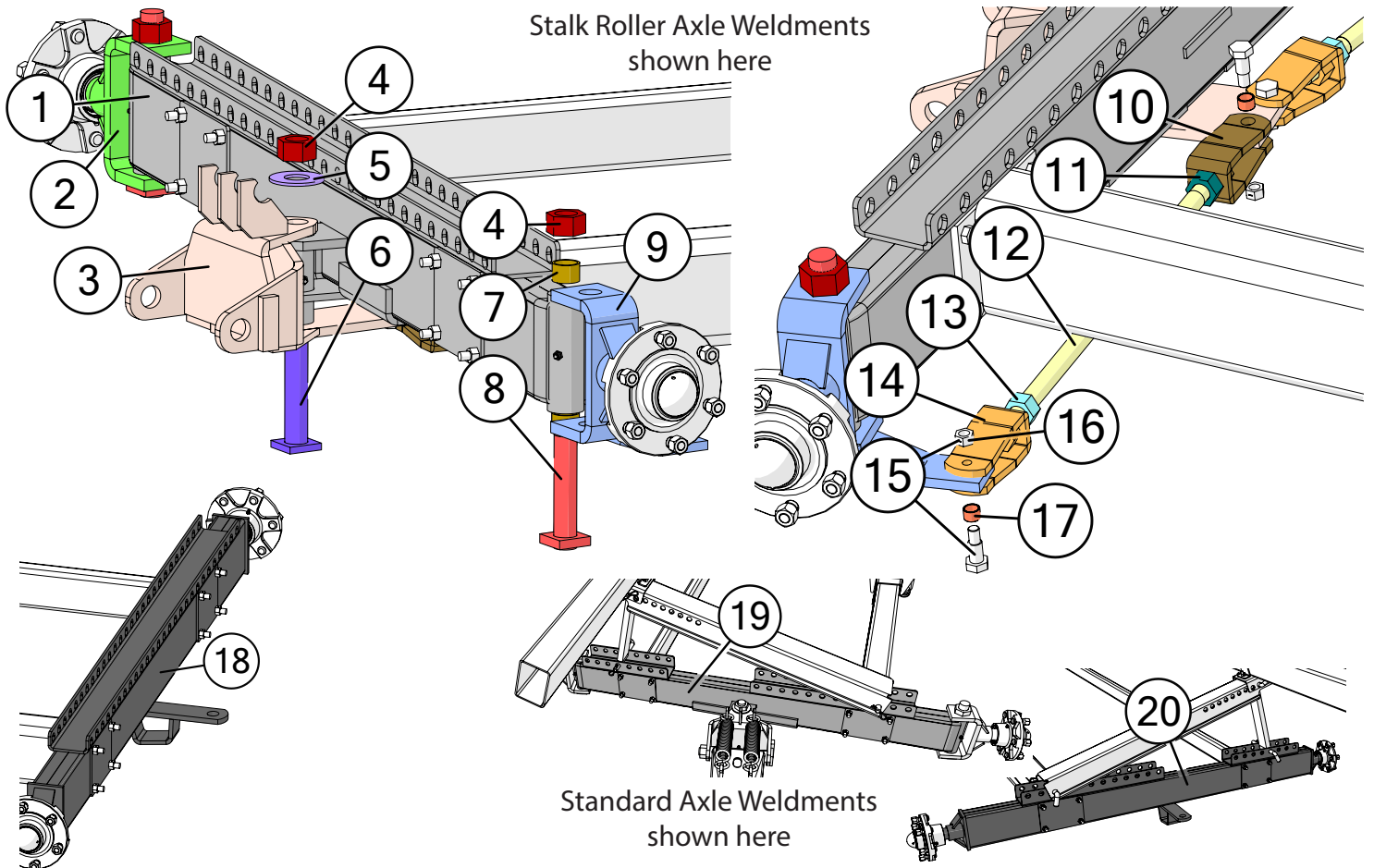

Description	Part No.
1 Front Axle, Less Hub, Spindle Assembly and Hitch For Stalk Rollers (HT)	JM0076273
2 1-3/4" Spindle & "U" Assembly, Right (SA-874R)	JM0030141
3 Hitch Swivel Weldment 6-8 Ton (HT-974) (HW-68)	JM0030131
4 1-1/4"-12 Gr5 Z Hex Nut	JM0002158
5 1-1/4" USS Flat Washer	JM0010112
6 King Pin Vertical Hitch Bolt (1-1/4" x 7-3/4") 6-10 Ton (KP-610)	JM0027665
7 1-1/4" ID x 1-1/2" OD Bronze Bushing (1" Depth)	JM0002248
8 Spindle Bolt 1-1/4" x 10-1/4" (HT974) (SB-114)	JM0019324
9 1-3/4" Spindle & "U" Assembly, Left (SA-874L)	JM0030136
10 6-10 Ton Clevis Weldment (Left) (TRE-78L)	JM0003168
11 7/8"-14 Gr5 Z LH Hex Nut	JM0027686
12 Tie Rod (7/8" x 24-1/2") (TR-78)	JM0030104
13 7/8"-14 Gr5 Z Hex Nut	JM0025714
14 6-10 Ton Clevis Weldment (Right) (TRE-78R)	JM0030149
15 5/8" Shoulder Dia x 1" Shoulder Length x 1/2"-13 Shoulder Bolt & Nut (SB-58)	JM0002408
16 1/2"-13 Gr5 Z Centerlock Hex Nut	JM0001511
17 5/8" ID x 3/4" OD x 1/2" Bronze Bushing (BB-58)	JM0003189
18 Rear Axle, Less Hub Assemblies for Stalk Roller (HT)	JM0076274
19 Front Axle, Less Hub, Spindle Assembly and Hitch (HT) (FA-974)	JM0030103
20 Rear Axle, Less Hub Assemblies (HT) (RA-974)	JM0030097

Spindle & Tire Assemblies

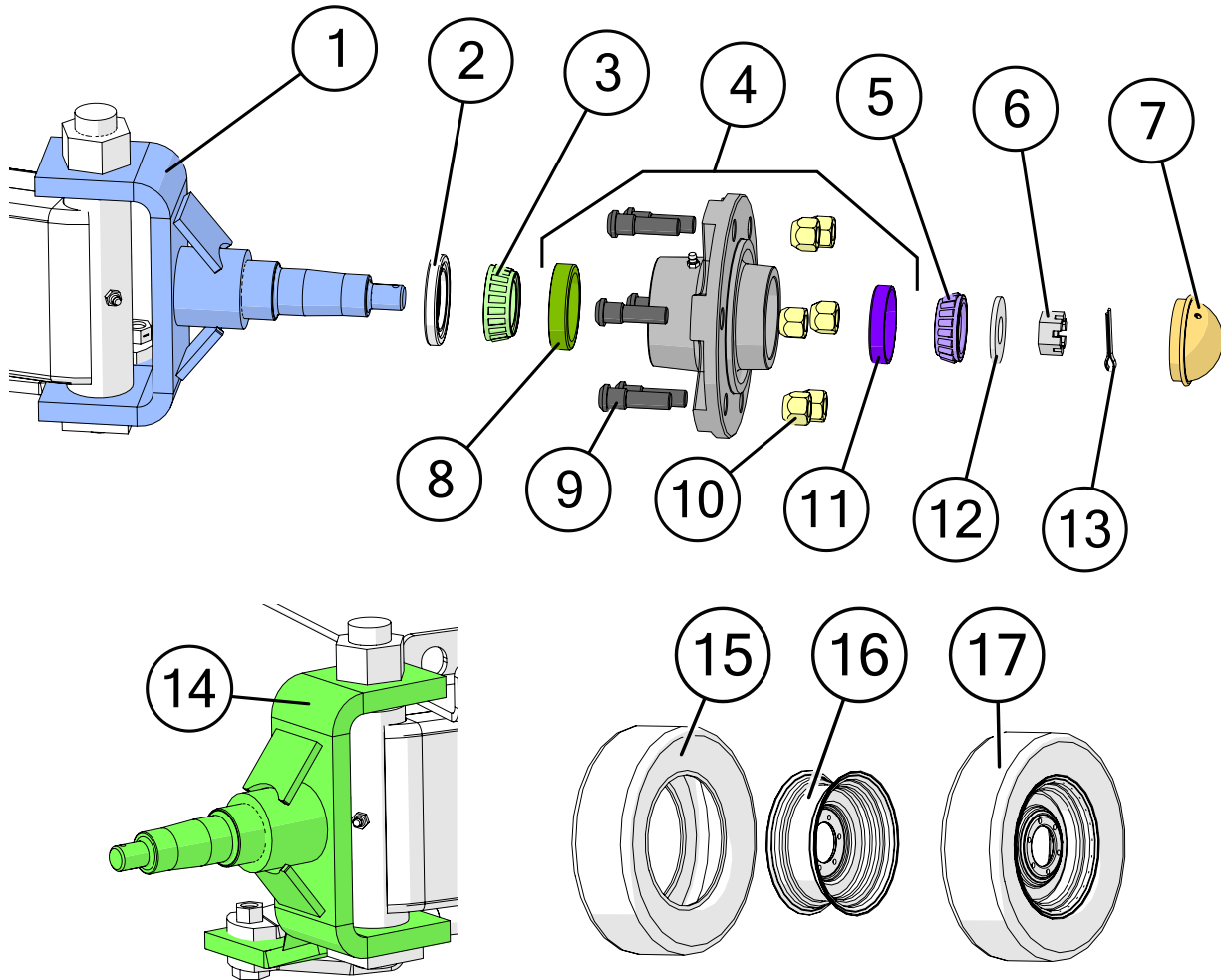

	Description	Part No.
1	1-3/4" Spindle & "U" Assembly, Left (SA-874L)	JM0030136
2	Grease Seal, 6-8 Ton (103953)	JM0026572
3	Large Inner Bearing for 6-8 Ton (LM48548) (104579)	JM0019563
4	G25 Hub with Races, Studs and Nuts, 7-8 Ton (105218)	JM0026566
5	Small Outer Cone for 6-10 Ton (LM67048)	JM0019564
6	3/4"-10 Gr5 Z Castle Hex Nut	JM0002130
7	Dust Cap, 6-10 Ton (103969)	JM0026567
8	Large Cup for 6-8 Ton (LM48510) (104580)	JM0026565
9	Wheel Stud for Hub, 6-8 Ton (1/2"-20 x 1-7/8") (4187)	JM0019559
10	1/2"-20 Lug Nut, 6-8 Ton (5552)	JM0003062
11	Small Cup for 6-10 Ton (LM67010) (200500)	JM0026564
12	3/4" USS Flat Washer	JM0010006
13	5/32" x 1-1/2" Cotter Pin	JM0014348
14	1-3/4" Spindle & "U" Assembly, Right (SA-874R)	JM0030141
15	14" Tire 215/75R14D (HT974)	JM0019529
15	15" Tire ST215-75E15 (Carlisle)	JM0030451
16	14" x 6" - 6 Hole Wheel Rim	JM0019535
16	15" x 6" Wheel 6 Hole	JM0030449
17	ST215-75D14 Carlisle Sport Trail Tire and 14x6 - 6 Hole Wheel Rim	JM0019536
17	15" Wheel & Tire Assembly ST215-75E15 6 Bolt (Carlisle)	JM0030452

Light Bar Assembly

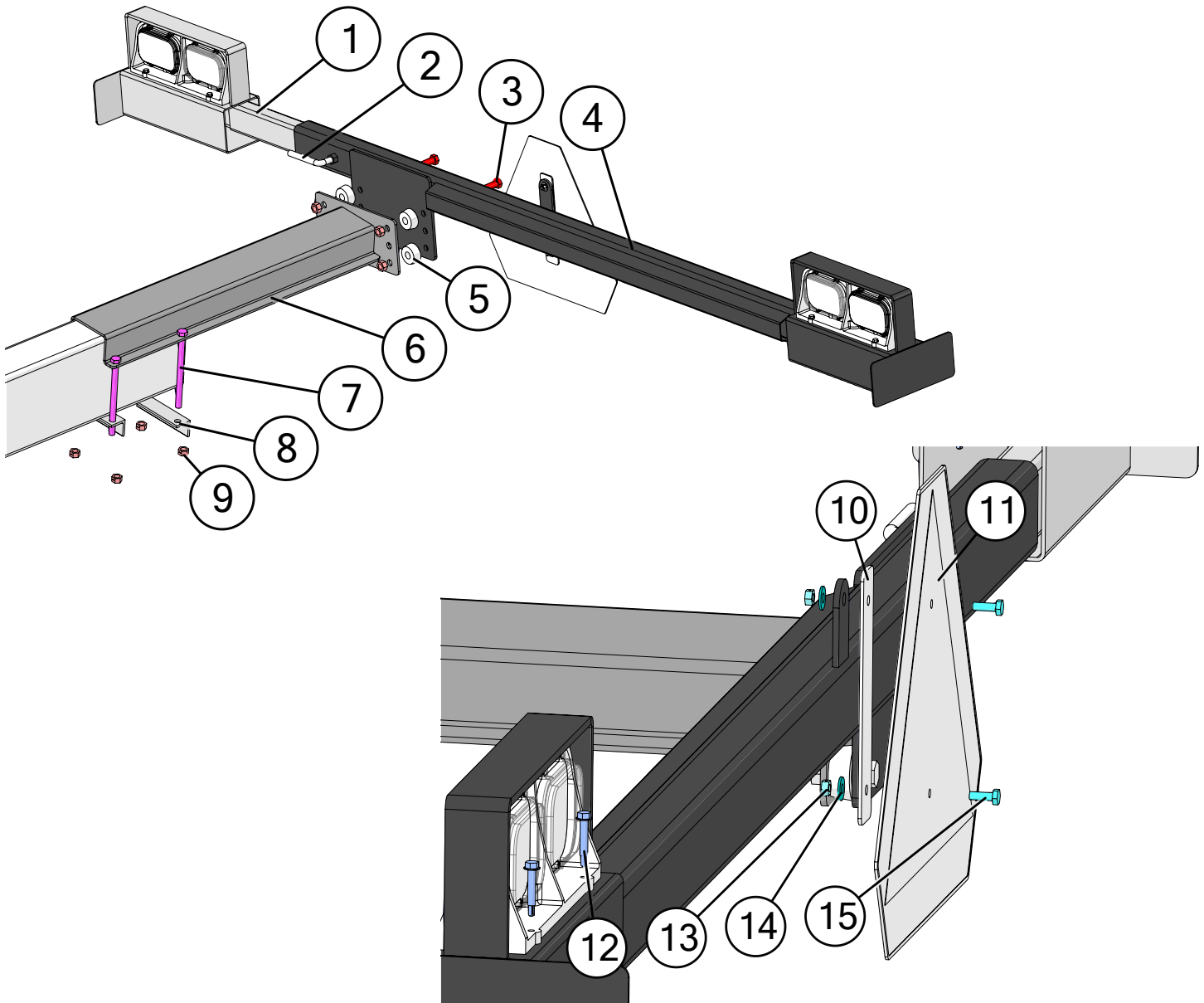

	Description	Part No.
1	Telescoping Arm for Header Transport Light Kit (TA-1)	JM0001375
2	1/2"-13 x 4" Gr5 Z Bent L Bolt	JM0021419
3	1/2"-13 x 2" Gr8 Z Hex Bolt	JM0001620
4	Header Transport Light Mounting Bracket (LMB-1)	JM0001374
5	Neoprene Vibration Damping Mount with 5/8" Diameter Hole	JM0001869
6	Header Transport Light Mount Extension Bracket (EB-1)	JM0001393
7	1/2"-13 x 7" Gr8 YZ Hex Bolt	JM0001622
8	Header Transport Light Bar Angle Iron Support (AIS-2)	JM0001440
9	1/2"-13 Gr2 Z Centerlock Hex Nut	JM0001511
10	Slow Moving Vehicle Sign Bracket	JM0001645
11	Slow Moving Vehicle Sign	JM0001616
12	1/4" x 1-1/2" Self Tapping Screw	JM0001571
13	1/4"-20 Gr2 Z Centerlock Hex Nut	JM0001505
14	1/4" ID, 3/4" OD Z Flat Washer	JM0003090
15	1/4"-20 x 3/4" Gr5 Z Hex Bolt	JM0001507

Light Kit

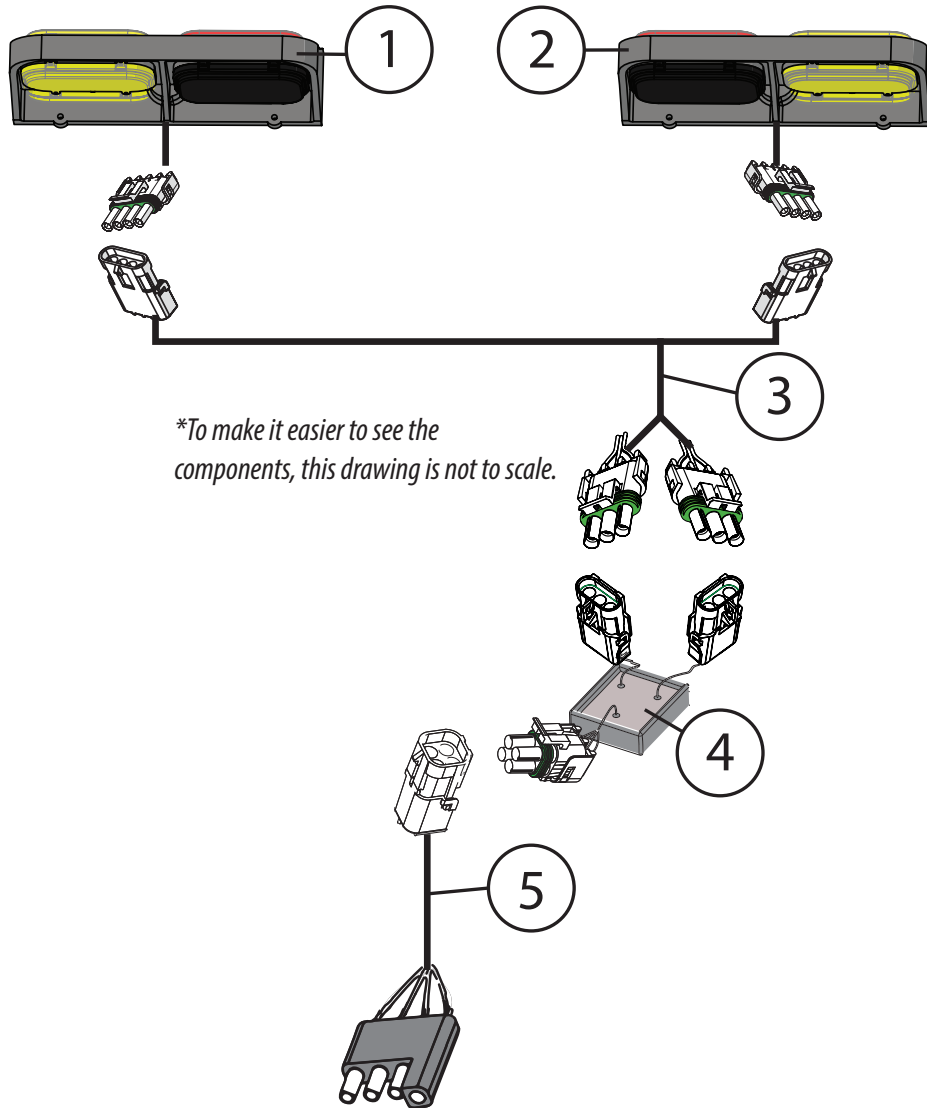

	Description	Part No.
1	Right LED Light Assembly - Header Transport	JM0001682
2	Left LED Light Assembly - Header Transport	JM0001680
3	Rear Harness (4WS)	JM0007166
4	Light Enhancer (4WS)	JM0007445
5	Main Harness (4WS, Header Transport - Ag)	JM0007436

Set Up Instructions

• **Front & Rear Axle**

Secure the front and rear axle to the frame bars. Use (8) 1/2" x 4" zinc hex bolts and (8) 1/2" centerlock hex nuts to install each axle. Tighten all of the hex nuts.

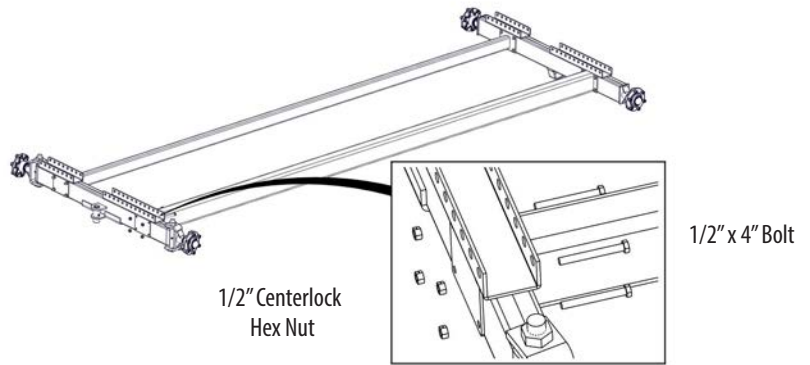

• **Wheels & Tires**

Install all four tires. Attach the tires using (6) 1/2" lugnuts. Tighten lugnuts in a star pattern to 120 ft-lbs according to the figure below.



• **Tongue Assembly**

Install the tongue assembly. Attach the tongue to the main frame using a 1-1/4" x 11-3/4" pin weldment and a 1-1/4" hex nut. Tighten hardware once installed. Install the tongue spring. Raise the adjustable portion of the tongue in the air to assist in installing the tongue spring.

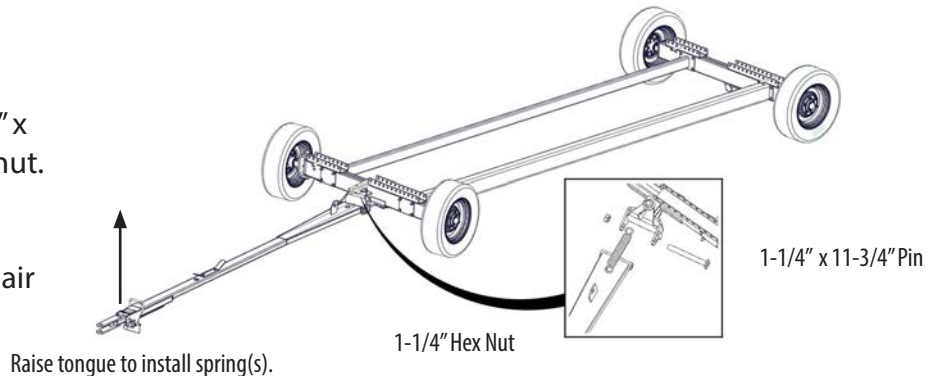

Set Up Assembly

• **Support Arms**

Install the support arm, channel mount and top tube support onto the front and rear axles. First attach the support arm onto the right side of the front axle. Use a "L" pin and a 3/16" hair pin to fasten. Next attach the channel mount on the left side of the front axle. Use a "L" pin and a 3/16" hair pin to fasten. Now fasten the top tube support to the channel mount and the support arm. Use (2) "L" pins and (2) 3/16" hair pin to fasten. Repeat with the rear axle.

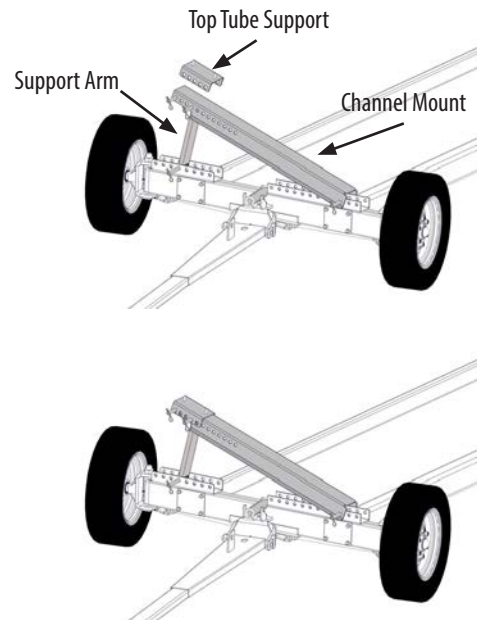

• **Upper Bar**

Install the upper bar. Secure the upper bar with 2 clamp brackets. Fasten the clamp brackets with (2) 1/2" centerlock hex nuts each. Fasten hardware once installed.

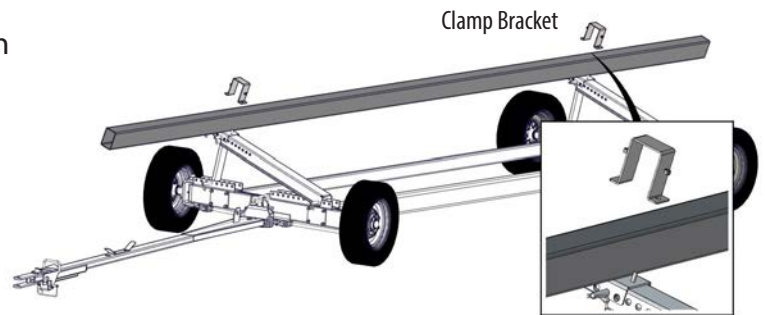

• **Header Mount & Ratchet Bracket**

Place the header mounts and ratchet brackets on the large lower bar. Secure the header mount using a 5/8" x 6-1/2" carriage bolt and the clamp handle assembly. Secure the ratchet bracket using (2) 1/2" x 5-1/2" hex bolts and (2) 1/2" centerlock hex nuts.

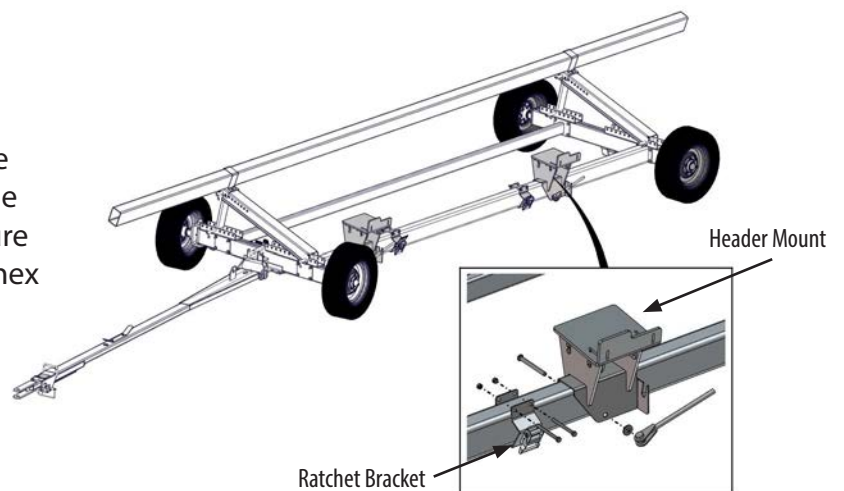

Set Up Assembly

• Light Bar

Install the light bar. Secure the light bar using (4) 1/2" x 5" hex bolts and (4) 1/2" hex nuts. Tighten hardware once installed.

Install the SMV sign. Secure using (2) 1/4" x 1" hex bolts, (2) 1/4" washers, and (2) 1/4" centerlock hex nuts.

Tighten hardware once installed.

Adjust the light bar loosening the adjustment handle and moving the right portion of the light bar. Tighten the adjustment handle once in desired position.

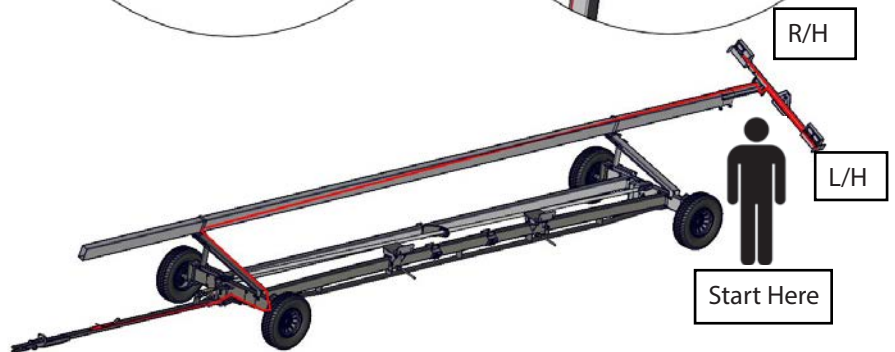
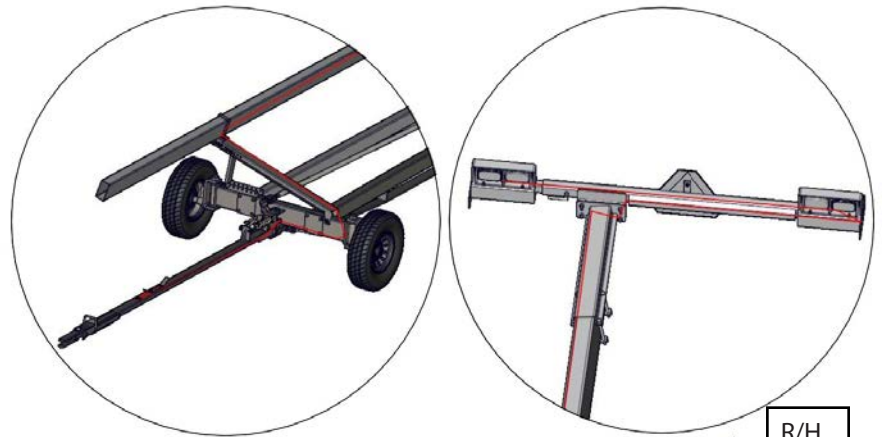
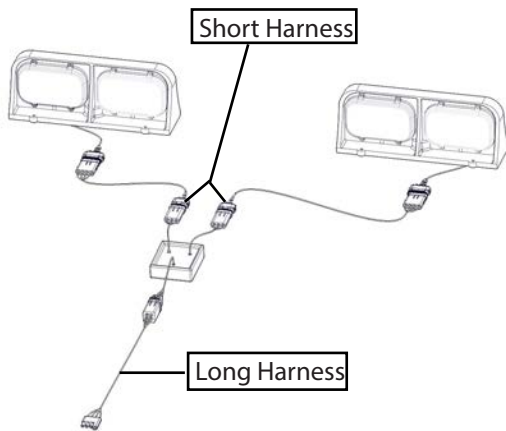
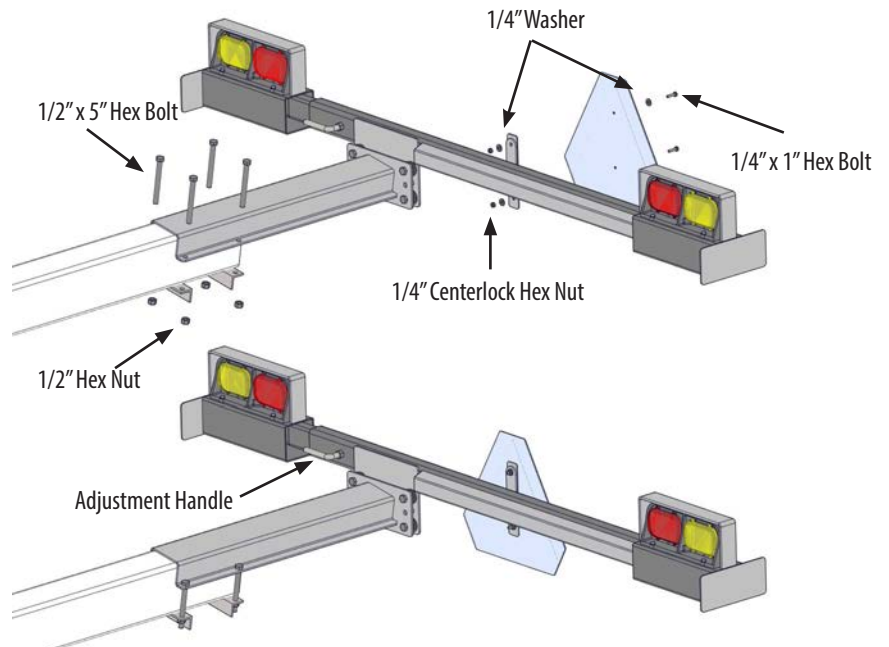

1. Run the short harness. Thread the 4 way flat connectors through the light bar starting on the side nearest to the rear axle. Facing the light bar from the front, the wire will run from left to right through the channel on the outside of the light bar. Connect the 4 way flat connector to the 4 way flat connector coming out of the left hand light. Run the rest of the short harness to the right side through the inside of the main tube on the light bar.
2. Connect the 3 way flat connector coming off the short harness to the 3 way flat connection coming out of the light enhancer.
3. Connect the light enhancer to the long harness with the two 4 way square connectors.
4. Run the 3 male 1 female flat connector to the front of the top bar. Run the end of the connector through the top bar. There is a hole for the wire to come out of the bottom of the top bar near the front of the wagon. Run it through the front axle, starting at the bottom rear left hand side to the middle front hole. Continue down the tongue, to the cord wrap. For transportation, connect the 4 way flat connector to the vehicle and wrap the remaining cord around the cord wrap.