



Manual

155 ACE PUMP WATER/FERTILIZER SEAL REPLACEMENT KIT JM0061308

ACE PUMPS PART NUMBER: RK-FMCSC-150



Rev. 2.22.2021

J&M Manufacturing Co, Inc

284 Railroad Street - P.O. Box 547 | Fort Recovery, OH 45846 | Ph: (419) 375-2376 | Fax: (419) 375-2708

www.jm-inc.com

Ace Pump Breakdown and Water Seal Replacement

J&M Part Number: JM0061308

Ace Pump Part Number: RK-FMCSC-150

DISASSEMBLY

1. Remove four 5/16" socket head cap screws from rear of motor.
2. Remove motor and seal support spacer.
3. Remove rear internal bearing snap ring.
4. Remove four 3/8" x 3/4" hex head cap screws from mounting frame.
5. Remove volute.
6. Remove 3/8" lock nut from shaft. Insert a flat file into impeller vane to hold stationary.
Caution: Excess torque may cause damage to plastic impellers.
7. Press shaft out of impeller using one 5/16" socket head cap screw from step #1.
8. Remove impeller, key, and rotating seal member.
9. Press shaft/bearing assembly out of frame.
10. Remove stationary seal member by prying out with a screwdriver or pressing out from motor end of pump housing.
11. Remove O-ring from shaft groove.
Note: If you are only replacing the pump seal:
12. Press the shaft/bearing assembly into the frame.
13. Reinstall the rear internal bearing snap ring.

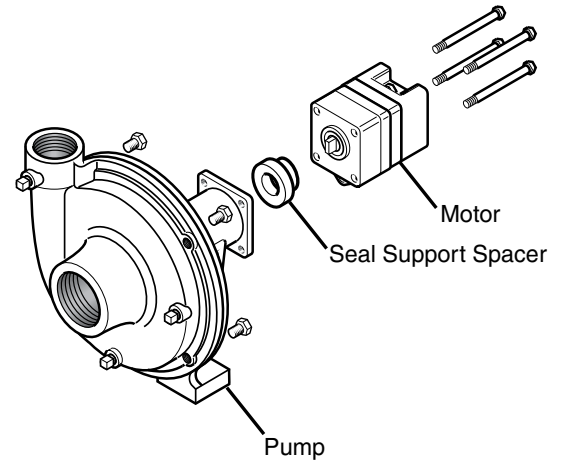

Disassembly Steps 1-5

ASSEMBLY

1. Press the shaft/bearing assembly into the frame.
2. Reinstall the rear internal bearing snap ring.
3. Clean old sealant from mounting frame seal bore.
4. Install O-ring in shaft groove.
5. Apply non-hardening type 2 Permatex or similar under stationary seal flange.
6. Place Stationary portion of seal over shaft and press into seal bore cavity. Use a 1-3/8" ID pipe or PTO adapter to press seal flange evenly on all sides.
7. Install rotating portion of seal over shaft and O-ring by hand. The two polished seal faces should face each other. Avoid contacting the polished seal faces.
8. Apply anti seize compound to impeller seat area on the shaft and key.
9. Insert key in keyway and install impeller on shaft.
10. place lock washer and 3/8" lock nut on shaft and tighten nut.
11. Replace volute O-ring, volute, and four 3/8" x 3/4" cap screws.
12. Position seal support spacer in the cavity behind the pump bearing and snap ring. The smaller diameter of the 200 series spacer faces the motor. Fill the spacer hole halfway with coupling grease.
13. Install motor by aligning motor tang and coupler slot. Rotate motor to proper orientation.
14. Install four 5/16" socket head cap screws and tighten to 15 ft. lb. torque.

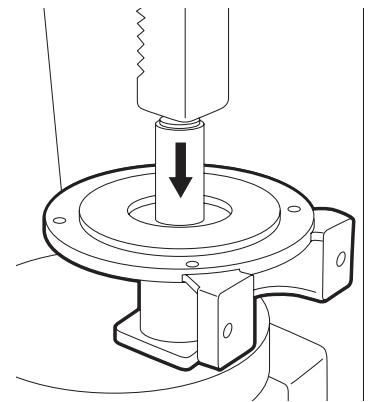

Assembly Step 6

