

OPERATORS MANUAL

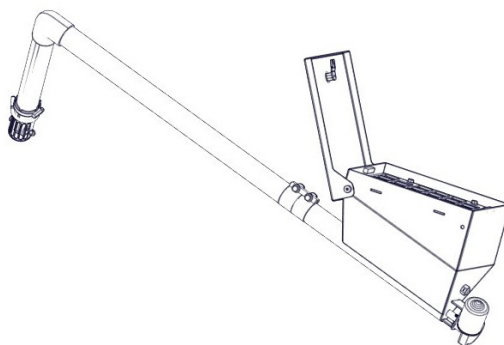

J. & M. Mfg. Co., Inc.
284 Railroad Street - P.O. Box 547
Fort Recovery, OH 45846
Ph: (419) 375-2376 Fax: (419) 375-2708
www.jm-inc.com

Table Of Contents

4	To The Dealer
5-6.....	General Information
7	Safety Rulese
8-9.....	Kit List
10-15.....	Assembly
16-17.....	Repair Parts

To The Dealer

Read manual instructions and safety rules. Make sure all items on the Dealer's Pre-Delivery and Delivery Check Lists are completed before releasing equipment to the owner.

The dealer must complete the Warranty Registration found on the Dealer Portal website located at dealer.jm-inc.com and return it to J. & M. Mfg. Co., Inc. at the address indicated on the form. Warranty claims will be denied if the Warranty Registration has not been submitted.

EXPRESS WARRANTY:

J. & M. Mfg. Co. Inc. warrants against defects in construction or materials for a period of ONE year. We reserve the right to inspect and decide whether material or construction was faulty or whether abuse or accident voids our guarantee.

Warranty service must be performed by a dealer or service center authorized by J. & M. Mfg. Co., Inc. to sell and/or service the type of product involved, which will use only new or re-manufactured parts or components furnished by J. & M. Mfg. Co., Inc. Warranty service will be performed without charge to the purchaser for parts or labor based on the Warranty Labor Times schedule. Under no circumstance will allowable labor times extend beyond the maximum hours indicated in the Warranty Labor Times schedule for each warranty procedure. The purchaser will be responsible, however, for any service call and/or transportation of the product to and from the dealer or service center's place of business, for any premium charged for overtime labor requested by the purchaser, and for any service and/or maintenance not directly related to any defect covered under the warranty. Costs associated with equipment rental, product down time, or product disposal are not warrantable and will not be accepted under any circumstance.

Each warranty term begins on the date of product delivery to the purchaser. Under no circumstance will warranty be approved unless (i) the product warranty registration card has been properly completed and submitted to the equipment manufacturer, and (ii) a warranty authorization number has been issued by the equipment manufacturer. This Warranty is effective only if the warranty registration card is returned within 30 days of purchase.

This warranty does not cover a component which fails, malfunctions, or is damaged as a result of (i) improper modification or repair, (ii) accident, abuse or improper use, (iii) improper or insufficient maintenance, or (iv) normal wear or tear. This warranty does not cover products that are previously owned and extends solely to the original purchaser of the product. Should the original purchaser sell or otherwise transfer this product to a third party, this implied, with respect to tires or other parts or accessories not manufactured by J. & M. Mfg. Co., Inc. Warranties for these items, if any, are provided separately by their respective manufacturers.

THIS WARRANTY IS EXPRESSLY IN LIEU OF ALL OTHER WARRANTIES OR CONDITIONS, EXPRESS, IMPLIED OR STATUTORY, INCLUDING ANY IMPLIED WARRANTY OF MERCHANTABILITY OR FITNESS FOR PARTICULAR PURPOSE.

In no event shall J. & M. Mfg. Co., Inc. be liable for special, direct, incidental or consequential damages of any kind. The exclusive remedy under this Warranty shall be repair or replacement of the defective component at J. & M. Mfg. Co., Inc.'s option. This is the entire agreement between J. & M. Mfg. Co., Inc. and the Owner about warranty and no J. & M. Mfg. Co., Inc. employee or dealer is authorized to make any additional warranty on behalf of J. & M. Mfg. Co., Inc.

The manufacturer reserves the right to make product design and material changes at any time without notice. They shall not incur any obligation or liability to incorporate such changes and improvements in products previously sold to any customer, nor shall they be obligated or liable for the replacement of previously sold products with products or parts incorporating such changes.

SERVICE:

The equipment you have purchased has been carefully manufactured to provide dependable and satisfactory use. Like all mechanical products, it will require cleaning and maintenance. Lubricate the unit as specified. Observe all safety information in this manual and safety signs on the equipment.

For service, your authorized J. & M. dealer has trained mechanics, genuine J. & M. service parts, and the necessary tools and equipment to handle all your needs.

Use only genuine J. & M. service parts. Substitute parts may void warranty and may not meet standards required for a safe and satisfactory operation. Record the model number and serial number of your equipment in the spaces provided:

Model No: _____ **Serial No:** _____ **Date of Purchase:** _____

Purchased From: _____

Provide this information to your dealer to obtain correct repair parts.

TO THE OWNER:

The purpose of this manual is to assist you in operating and maintaining your Talc Applicator in a safe manner. Read it carefully. It furnishes information and instructions that will help you achieve years of dependable performance and help maintain safe operating conditions. If this machine is used by an employee or is loaned or rented, make certain that the operator(s), prior to operating:

1. Is instructed in safe and proper use.
2. Reviews and understands the manual(s) pertaining to this machine.

Throughout this manual, the term **IMPORTANT** is used to indicate that failure to observe can cause damage to equipment. The terms **CAUTION**, **WARNING** and **DANGER** are used in conjunction with the Safety-Alert Symbol (a triangle with an exclamation mark) to indicate the degree of hazard for items of personal safety. When you see this symbol, carefully read the message that follows and be alert to the possibility of personal injury or death.

 This Safety-Alert symbol indicates a hazard and means
ATTENTION! BECOME ALERT! YOUR SAFETY IS INVOLVED!

 **DANGER** Indicates an imminently hazardous situation that, if not avoided, will result in death or serious injury.

 **WARNING** Indicates a potentially hazardous situation that, if not avoided, will result in death or serious injury, and includes hazards that are exposed when guards are removed.

 **CAUTION** Indicates a potentially hazardous situation that, if not avoided, may result in minor or moderate injury.

IMPORTANT Indicates that failure to observe can cause damage to equipment.

NOTE Indicates helpful information.

General Information

BOLT TORQUE CHART

Always tighten hardware to these values unless a different torque or tightening procedure is listed for specific application.

Fasteners must always be replaced with the same grade as specified in the manual parts list.

Always use the proper tool for tightening hardware: SAE for SAE hardware and Metric for Metric hardware.

Make sure fastener threads are clean and you start thread engagement properly.

All torque values are given to specifications used on hardware defined by SAE J1701 & J1701M (JUL 96)

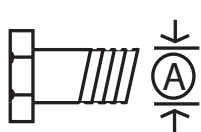

SAE SERIES TORQUE CHART



SAE Grade 2
(No Dashes)

SAE Bolt Head
Identification



SAE Grade 5
3 Radial Dashes



SAE Grade 8
6 Radial Dashes

 Diameter (Inches)	Wrench Size	MARKING ON HEAD					
		SAE 2		SAE 5		SAE 8	
		LBS.-FT.	N-m	LBS.-FT.	N-m	LBS.-FT.	N-m
1/4	7/16"	6	8	10	13	14	18
5/16	1/2"	12	17	19	26	27	37
3/8	9/16"	23	31	35	47	49	67
7/16	5/8"	36	48	55	75	78	106
1/2	3/4"	55	75	85	115	120	163
9/16	13/16"	78	106	121	164	171	232
5/8	15/16"	110	149	170	230	240	325
3/4	1-1/8"	192	261	297	403	420	569
7/8	1-5/16"	306	416	474	642	669	907
1	1-1/2"	467	634	722	979	1020	1383



METRIC SERIES TORQUE CHART



Metric
Grade 8.8

Metric Bolt Head
Identification

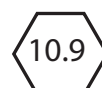

Metric
Grade 10.9

Diameter & (Millimeters) Thread Pitch	Wrench Size	Grade 8.8				Grade 10.9				Diameter & (Millimeters) Thread Pitch
		COARSE THREAD				FINE THREAD				
		MARKING ON THREAD				MARKING ON THREAD				
		Metric 8.8		Metric 10.9		Metric 8.8		Metric 10.9		
6 x 1.0	10 mm	8	6	11	8	8	6	11	8	6 x 1.0
8 x 1.25	13 mm	20	15	27	20	21	16	29	22	8 x 1.0
10 x 1.5	16 mm	39	29	54	40	41	30	57	42	10 x 1.25
12.1.75	18 mm	68	50	94	70	75	55	103	76	12.1.25
14 x 2.0	21 mm	109	80	151	111	118	87	163	120	14 x 1.5
16 x 2.0	24 mm	169	125	234	173	181	133	250	184	16 x 1.5
18 x 2.5	27 mm	234	172	323	239	263	194	363	268	18 x 1.5
20 x 2.5	30 mm	330	244	457	337	367	270	507	374	20 x 1.5
22 x 2.5	34 mm	451	332	623	460	495	365	684	505	22 x 1.5
24 x 3.0	36 mm	571	421	790	583	623	459	861	635	24 x 2.0
30 x 3.0	46 mm	1175	867	1626	1199	1258	928	1740	1283	30 x 2.0



ATTENTION! BECOME ALERT! YOUR SAFETY IS INVOLVED!



Safety is a primary concern in the design and manufacture of our products. Unfortunately, our efforts to provide safe equipment can be erased by an operator's single careless act. In addition, hazard control and accident prevention are dependent upon the awareness, concern, judgment, and proper training of personnel involved in the operation, transport, maintenance and storage of equipment.

Make certain that the operator(s), prior to operating is instructed in safe and proper use and reviews and understands the manual(s) pertaining to this machine. Also make certain that the operator(s) reviews and understands the operator's manual of the tractor prior to hooking up or operating the grain cart.

Read this manual before you operate this machine. If you do not understand any part of this manual, or need more information, contact the manufacturer or your authorized dealer.

SAFETY

Understand that your safety and the safety of other persons is measured by how you service and operate this machine. Know the positions and functions of all controls before you try to operate them. Make sure to check all controls in a safe area before starting your work.

The safety information given in this manual does not replace safety codes, federal, state or local laws. Make certain your machine has the proper equipment as designated by local laws and regulations.

A frequent cause of personal injury or death is from persons falling off equipment and being run over. Do not permit persons to ride on this machine.

Travel speeds should be such that complete control and machine stability is maintained at all times. Where possible, avoid operating near ditches, embankments and holes. Reduce speed when turning, crossing slopes and rough, slick or muddy surfaces.

Collision of high speed road traffic and slow moving machines can cause personal injury or death. On roads, use flasher lights according to local laws. Keep slow-moving-vehicle emblem visible. Pull over to let faster traffic pass.

Hydraulic oil leaking under pressure can penetrate skin and cause infection or other injury. To prevent personal injury,

- Relieve all pressure, before disconnecting fluid lines,
- Before applying pressure, make sure all connections are tight and components are in good condition,
- Never use your hand to check for suspected leaks under pressure. Use a piece of cardboard or wood for this purpose.
- If injured by leaking fluid, see your doctor immediately.

When transporting the Seed Tender, always keep the auger in the stow position.

Use care when moving or operating the Seed Tender near electric lines, as serious injury or death can result from contact.

Never adjust, service, clean, or lubricate the Seed Tender until all power is shut off. Keep all safety shields in place. Keep hands, feet, hair and clothing away from moving parts while the grain cart is in operation.

The service ladder is for service work only. If you must climb into the grain tank, be certain that all power is shut off and then use extreme caution when climbing into the Seed Tender.

Make sure that everyone is clear of equipment before applying power or moving the machine.

Before filling the Seed Tender, make certain that no one is inside the grain tank. Never allow children or anyone in, near, or on the Seed Tender during transport or during loading and unloading of grain. Be aware that moving grain is dangerous and can cause entrapment, resulting in severe injury or death by suffocation.

Never operate the auger system with anyone inside the grain tank.

Before unhooking the Seed Tender from the transport unit, be sure the jack stand is properly mounted and in place and the wheels are properly blocked to prevent the Seed Tender from moving.

Kit List

Description (375)		
	375ST Talc Appl ASM	
15	2" PVC for 375 ST Talc - 41-3/8" Long	1
4	375ST Talc fighting asm - 62-7/8" Long	1
20	275/375 Mounting Bracket Weldment	1
21	Talc Tube U-Bolt Brace	1

Description (275)		
	275 Seed Tender Talc Kit	
15	2" PVC for 275 ST Talc - 33-3/8" Long	1
4	275ST Talc fighting asm - 54-7/8" Long	1
20	275/375 Mounting Bracket Weldment	1
21	Talc Tube U-Bolt Brace	1

Description (C4-50)		
	C4-50 Talc Kit	
15	2" PVC for C4-50 & 510 Talc - 58-3/8" Long	1
4	C4-50 & 510ST Talc fighting asm - 79-7/8" Long	1
19	Talc Tube U-Bolt Brace	1
18	C4-50 Mounting Bracket Weldment	1

Description (510)		
	510 Talc Appl ASM	
15	2" PVC for C4-50 & 510 Talc - 58-3/8" Long	1
4	C4-50 & 510ST Talc fighting asm - 79-7/8" Long	1
16	510 Talc Mounting Bracket Weldment	1
17	510 Talc Spout Mounting Bracket	1

Description		
1	17 Deg. Talc Box Assembly	1
2	5/16-18 X .3125L Knurl Grip Cup Set Screw	2
3	3/4 Flatwasher Nylon_1.057 OD_.125 Washer	1
4	Talc Fighting	1
5	2in Clamp	1
6	2" Black Pipe, Sharp 90 Deg Elow	1
7	#35 Chain - 44.625 Long	1
8	2in PVC Downspout	1
9	Screw Clamp	1
10	3/8" Round U-Bolt 2" Pipe	1
11	3/8"-16 Gr5 Z Centerlock Hex Nut	1
12	3/8"-16 x 1" Gr5 Z SF Hex Bolt	6
13	Talc Chain Drag Poly Idler	1
14	Talc Applicator - Idler Sprocket Housing Weldment	1
15	2in PVC	1
22	3/8 - 16 Gr5 Z SF Hex Nut	8

Kit List

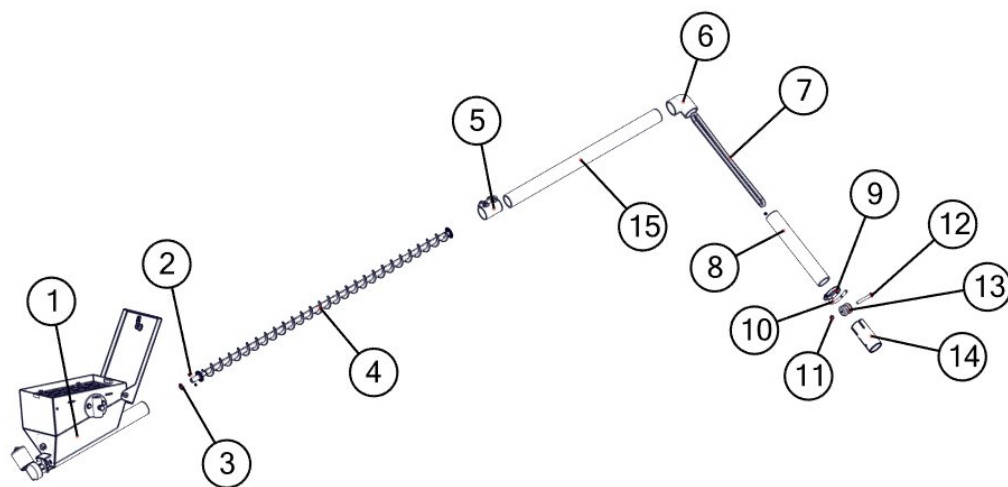

510ST

C4-50



16

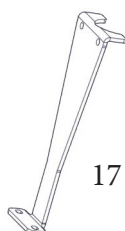

17

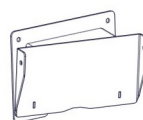

18



19

375/275ST

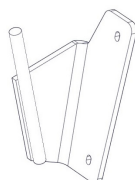

20

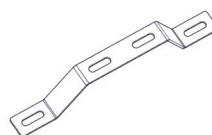

21

Assemble the talc box

- Place the nylon washer on the end of the Coupler. Insert the auger with the motor coupler down and the chain sprocket up into the trough of the Talc Box. (Figure 1)

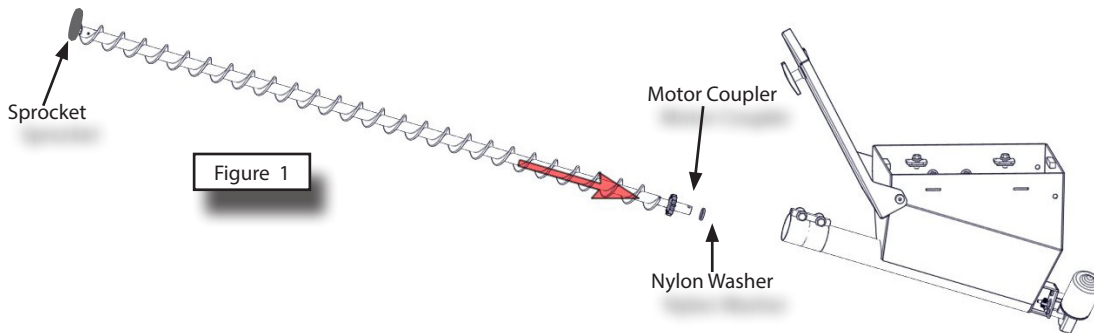

- Line up the flats on the motor shaft with the set screw holes on the coupler and fasten the Auger Motor Coupler to the shaft using the 5/16" set screws provided. (Figure 2)

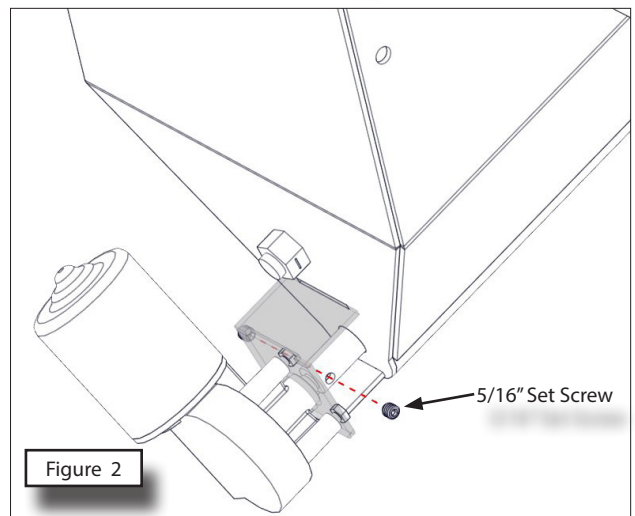

- Slide the longer black PVC pipe over the auger along with the pipe clamp. (Figure 3)
Note: DO NOT tighten the clamp.

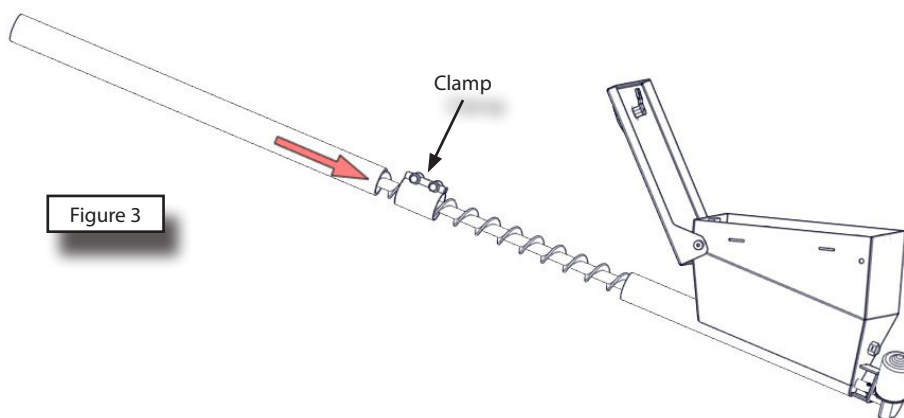

Assembly

- Loop the roller chain over the sprocket on the end of the auger. (Figure 4)
- Slide the chain through the PVC elbow and attach the elbow to the end of the pipe. (Figures 4 & 5)

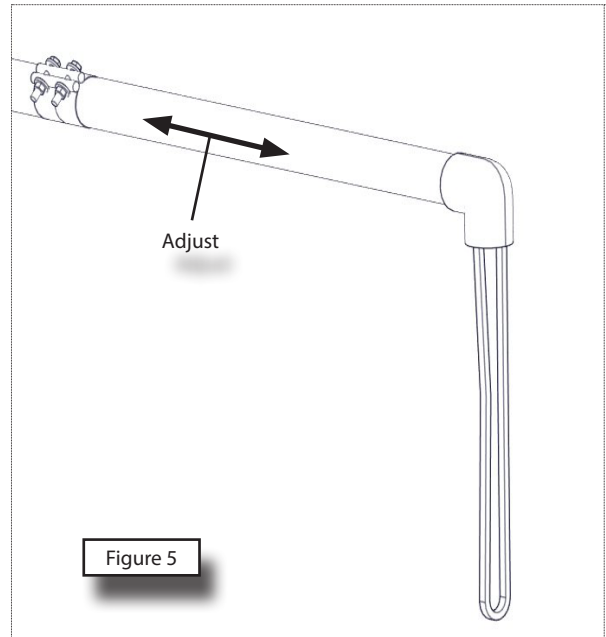
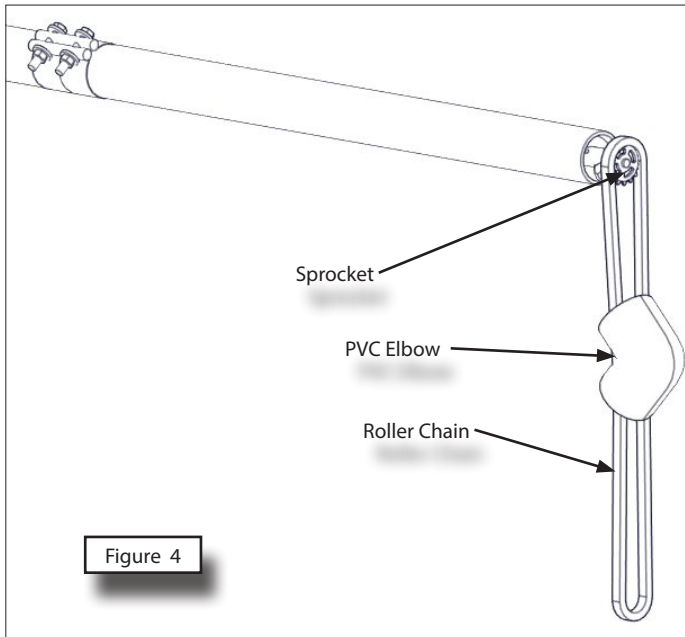

- Adjust the black PVC pipe so that the sprocket and chain are centered in the PVC elbow. (Figures 5 & 6)
- Once the sprocket and chain are centered in the PVC elbow, tighten the pipe clamp securely on both ends. (Figures 6 & 7)

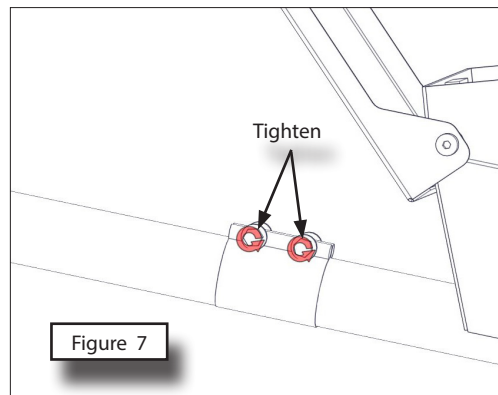
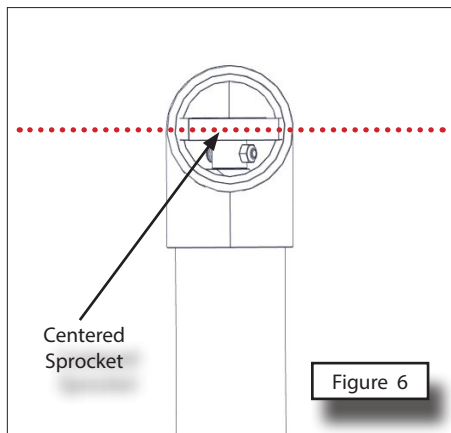

Assembly

- Slide the PVC Down Spout over the Roller Chain and insert into the PVC Elbow.
- Place the Chain Idler in the end of the Chain. (Figure 8)
- Loosely place the Hose Clamp over the Idler Housing.
- Place the Idler Housing over the Chain Idler and fit it to the PVC Down Spout. (Figure 9)
- Insert a 3/8" x 3" bolt through the Idler Housing and Chain Idler and tighten the 3/8" lock nut.

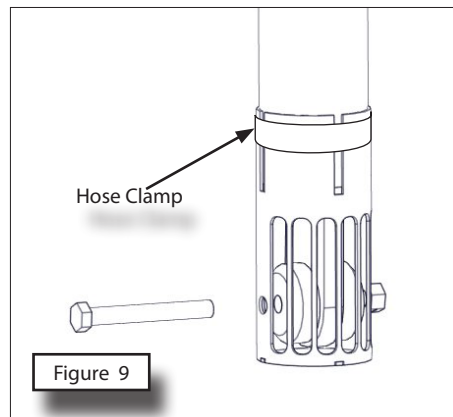
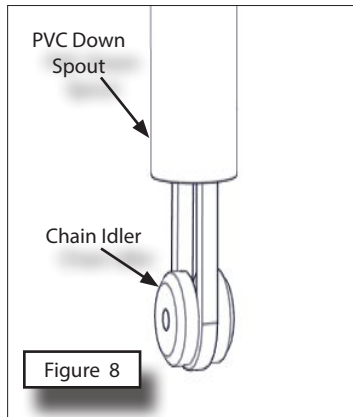

Align and tension the chain

- Align the chain by twisting the idler housing until the sprocket and chain idler are aligned. (Figure 10)
NOTE: Failure to align the Chain Idler properly may cause the Talc Applicator to fail.
- Tension the chain by pulling on the Idler housing.
- **NOTE: DO NOT over tighten the chain. The top row of the chain should sag slightly but not touch the bottom row of chain. (Figure 11)**
- Tighten the Hose Clamp on the Idler Housing to lock it in place. (Figure 11)

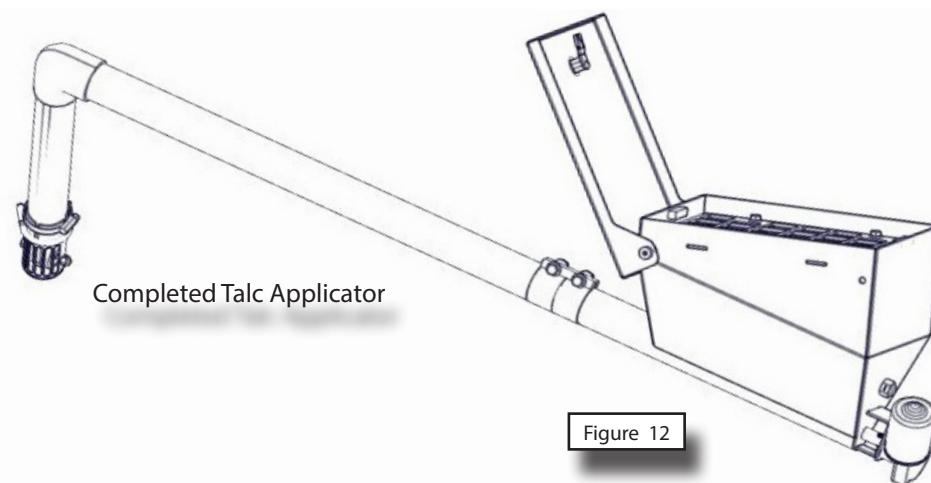
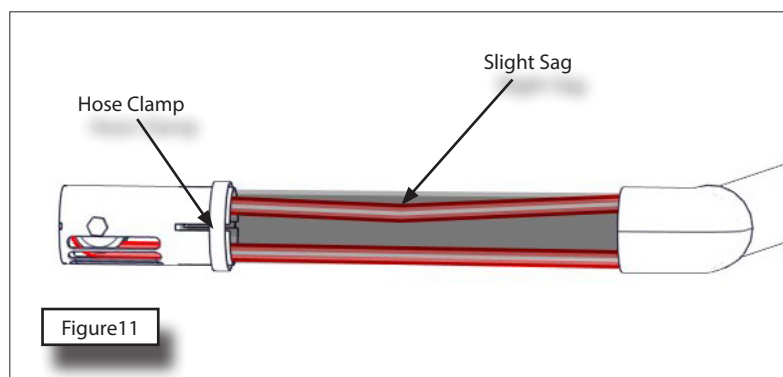
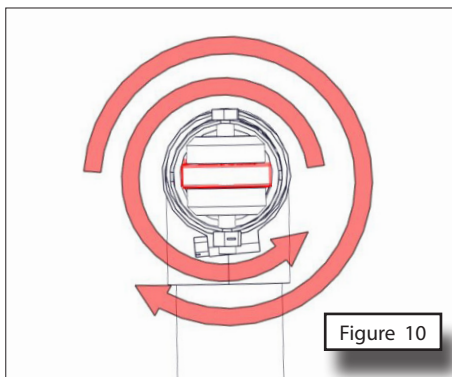

Installing the Mounting Bracket

For Model 275

- Measure 20-1/4" up the leg brace from the tube and align the bottom of the talc mounting bracket with that mark.
- Drill (2) 13/32" holes and attach the Mounting bracket using (2) 3/8" x 3/4" SF hex bolts. (Figure 13)

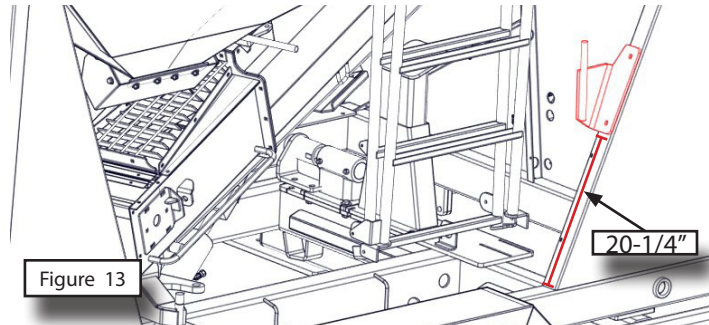

For Model 375

- Measure 15" up the leg brace from the tube and align the bottom of the talc mounting bracket with that mark.
- Drill (2) 13/32" holes and attach the Mounting bracket using (2) 3/8" x 3/4" SF hex bolts. (Figure 14)

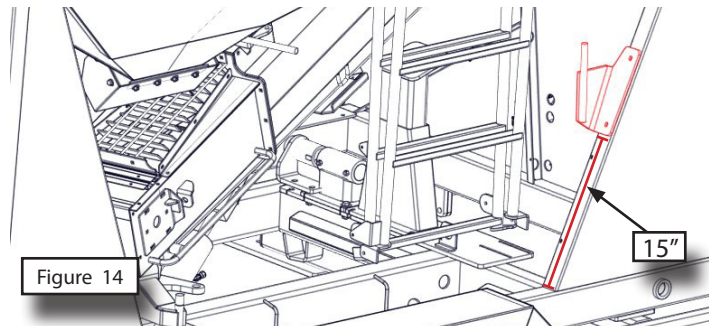

For Model 510

- Measure 4 - 3/4" up the leg brace from the tube and align the bottom of the talc mounting bracket with that mark.
- Drill (6) 13/32" holes and attach the Mounting bracket using (6) 3/8" x 3/4" SF hex bolts. (Figure 15)

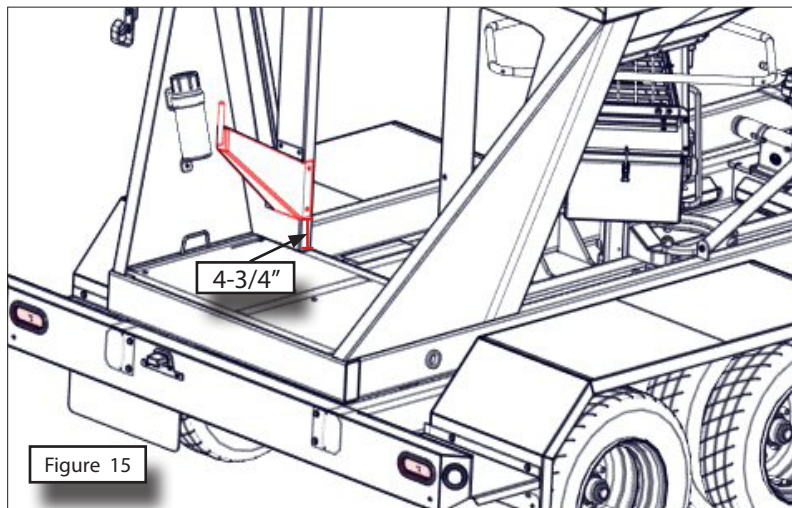

Installing the Mounting Bracket Continued

For Model C450

- Install the Talc Mounting bracket to the front leg using (4) 3/8" x 3/4" SF hex bolts and (4) 3/8" SF hex nuts. (Figure 16)

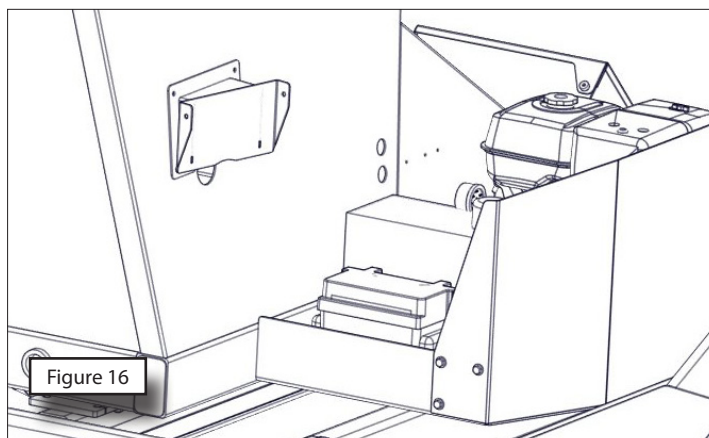

Installing the Talc Box

- Fasten Talc Box to mounting bracket Using (4) 3/8" x 3/4" SF hex bolt and 3/8" SF hex nuts.
- Fasten the down spout to the chute using the supplied u bolt and hardware.

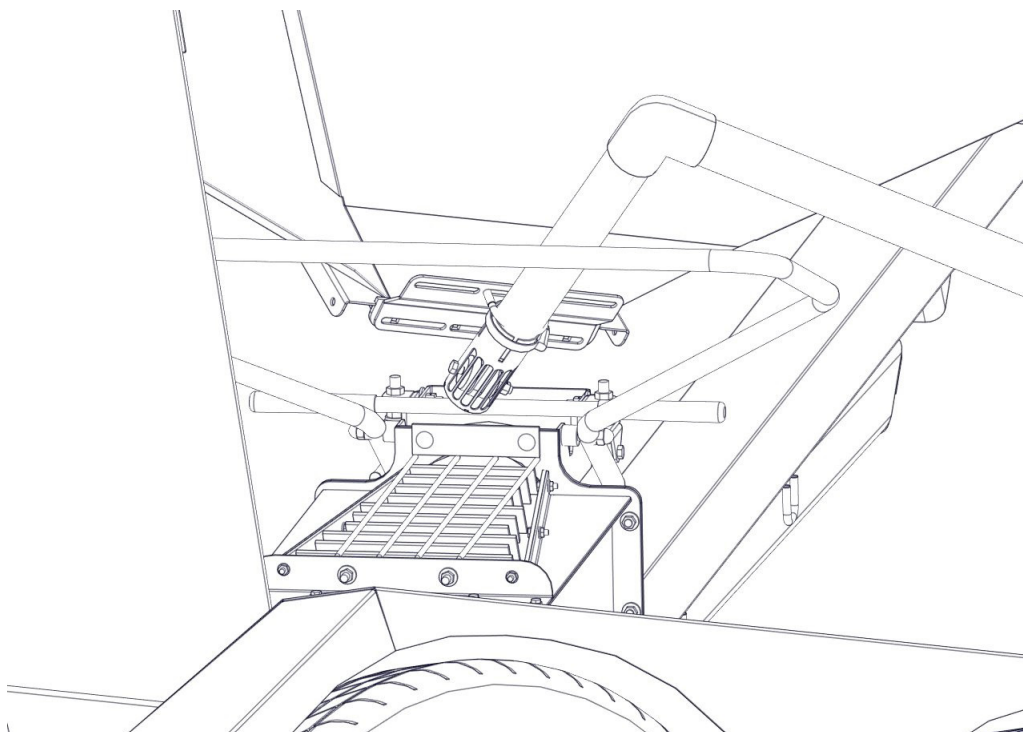

For Models 275,375 and 510

- Slide the Talc Box Spool over the mounting bracket rod. (Figure 17)
- Tighten the 1/2" x 1" spool bolt and 1/2" lock nut. (Figure 17)
- Fasten the down spout to the chute using the supplied u bolt and hardware. (Figure 18)

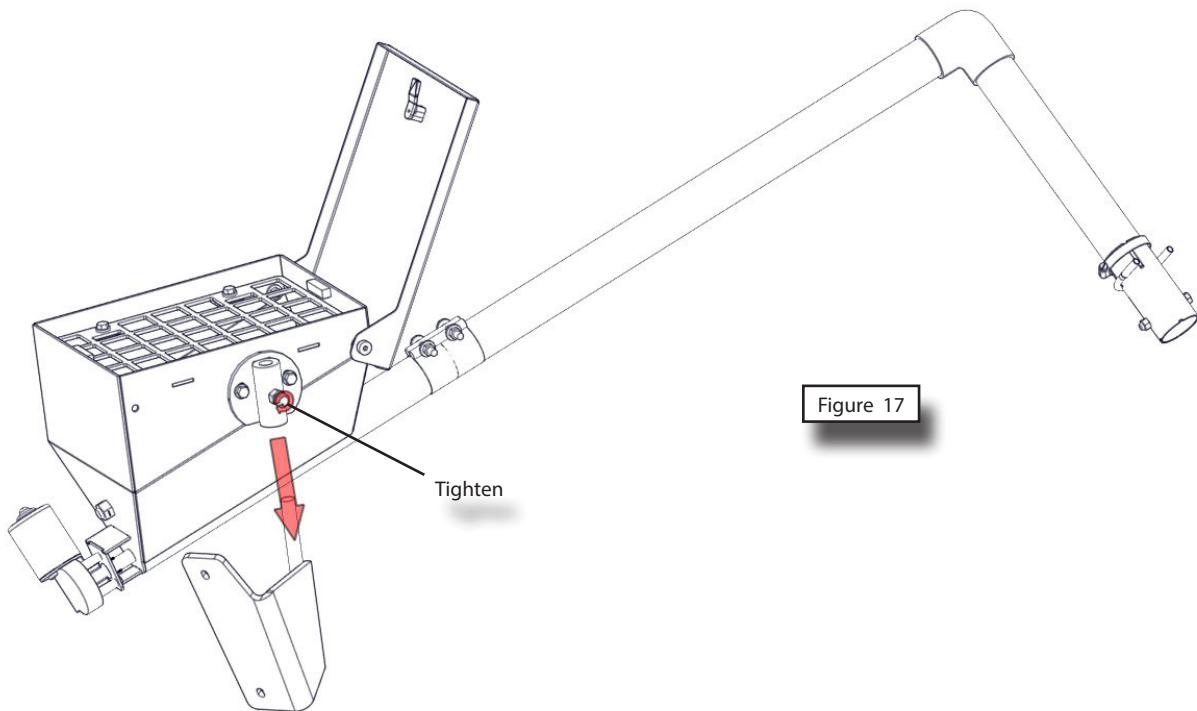

Figure 17

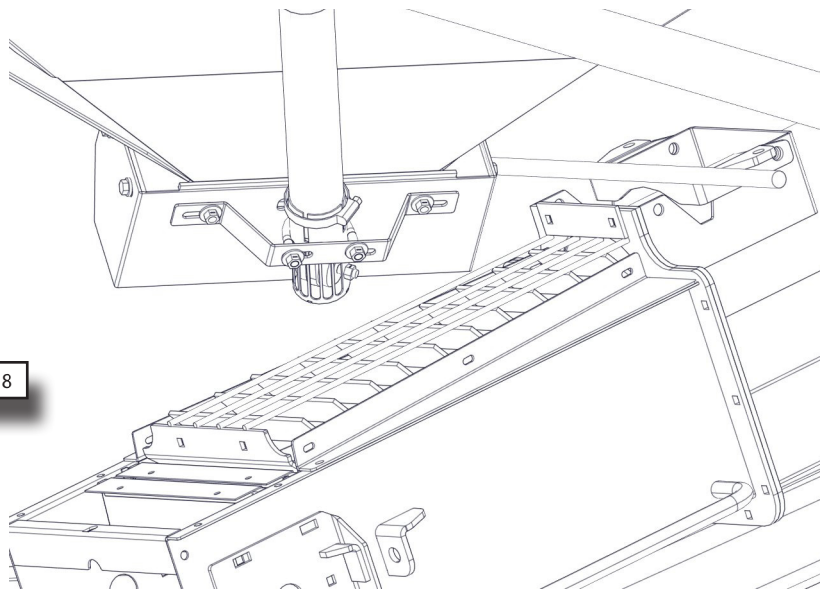

Figure 18

Repair Parts

375ST Talc Kit		JM#
1	2" PVC for 375 ST Talc - 41-3/8" Long	JM0037555
2	375ST Talc flighting asm - 62-7/8" Long	JM0037559
3	275/375 Mounting Bracket Weldment	JM0037272
4	Talc Tube U-Bolt Brace	JM0026471

275ST Talc Kit		JM#
1	2" PVC for 275 ST Talc - 33-3/8" Long	JM0037603
2	275ST Talc flighting asm - 54-7/8" Long	JM0037605
3	275/375 Mounting Bracket Weldment	JM0037272
4	Talc Tube U-Bolt Brace	JM0026471

C4-50 Talc Kit		JM#
1	2" PVC for C4-50 & 510 Talc - 58-3/8" Long	JM0037616
2	C4-50 & 510ST Talc flighting asm - 79-7/8" Long	JM0037619
5	C4-50 Mounting Bracket Weldment	JM0037645
6	C4-50 Talc Spout Mounting Bracket	JM0037675

510ST Talc Kit		JM#
1	2" PVC for C4-50 & 510 Talc - 58-3/8" Long	JM0037616
2	C4-50 & 510ST Talc flighting asm - 79-7/8" Long	JM0037619
7	510 Talc Mounting Bracket Weldment	JM0037641
8	510 Talc Spout Mounting Bracket	JM0037470

	Description	JM#
9	17 Deg. Talc Box Weldment	JM0037538
10	Large Agitator 17 DEG	JM0037241
11	Drive Adapter	JM0035081
12	3/4" Flat washer	JM0035079
13	12V Electric Gear Motor	JM0035522
14	Large Talc box screen	JM0037456
15	17 Deg. Talc Box Door	JM0037237
16	T-Handle Non Locking Chrome	JM0001911
17	1/2" Dia. x 3/8" LG 3/8"-16th Shoulder Bolt	JM0009998
18	3/8" USS Flat Washer	JM0003061
19	3/8"-16 Gr5 Z SF Hex Nut	JM0002152
20	5/8"-11 Gr5 Z Center-lock Hex Nut	JM0002146
21	3/4" Dia x 1/2" LG, 5/8-11, Shoulder Bolt	JM0034989
22	3/8"-16 x 3/4" Gr5 Z SF Hex Bolt	JM0001750
23	M6-1 x 14 Gr8.8 YZ Hex Bolt	JM0031837
24	Weed Whip Cord 18"	JM0038500
25	5/16"-18 x 3/16" Knurl Grip Cup Set Screw	JM0038513
26	2" PVC Downspout	JM0037544
27	Screw Clamp	JM0030547
28	3/8"-16 Gr5 Z Center-lock Hex Nut	JM0001512
29	Talc Chain Drag Poly Idler	JM0037547
30	#35 Chain - 44-5/8" Long	JM0037553
31	Chain Sprocket Weldment	JM0037565
32	Idler Sprocket Housing Weldment	JM0037838
33	#10-24 X 1.0 Z Round Head Phillips Screw	JM0037646
34	#10-24 Z Nylon Locking Hex Nut	JM0016030
35	2" Black Pipe, Sharp 90 Deg Elbow	JM0038564
36	3/8" Round U-Bolt 2" Pipe Size	JM0000351
37	Talc Rotation Bracket Weldment	JM0038395
38	1/2"-13 x 1" Gr5 Z Hex Bolt	JM0010225
39	1/2"-13 Gr5 Z Hex Nut	JM0002124
40	Clamp	JM0037668
41	3/8"-16 x 3" Gr5 Z Hex Bolt	JM0001666

Repair Parts

