



# Manual

## SPEED TENDER OPERATOR'S MANUAL

## 51 SERIES PRO BOX SCALE INSTALL

51-4-STWS

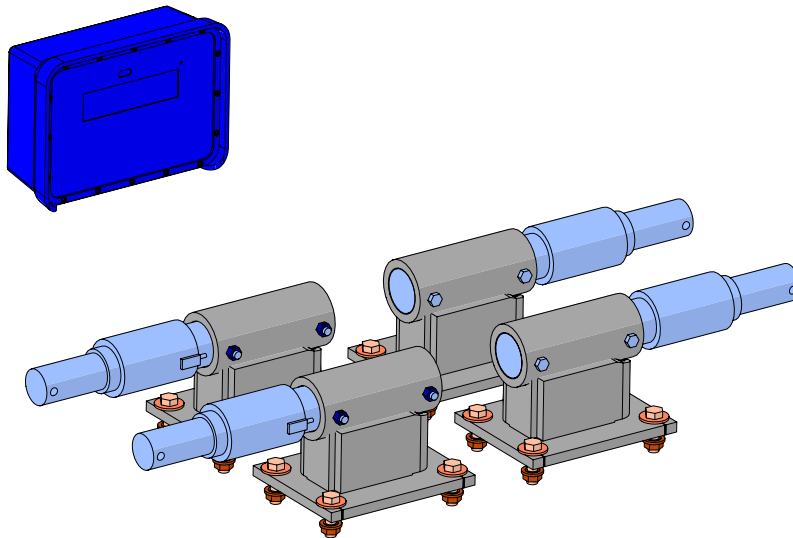

Rev. 4.4.2023

J&M Manufacturing Co, Inc

284 Railroad Street - P.O. Box 547 | Fort Recovery, OH 45846 | Ph: (419) 375-2376 | Fax: (419) 375-2708

[www.jm-inc.com](http://www.jm-inc.com)

# Scale Assembly

## **STEP ONE - 251 and 451**

- Bolt the scale monitor to the lower auger brace as it is pictured below with the hardware provided with the scale monitor.

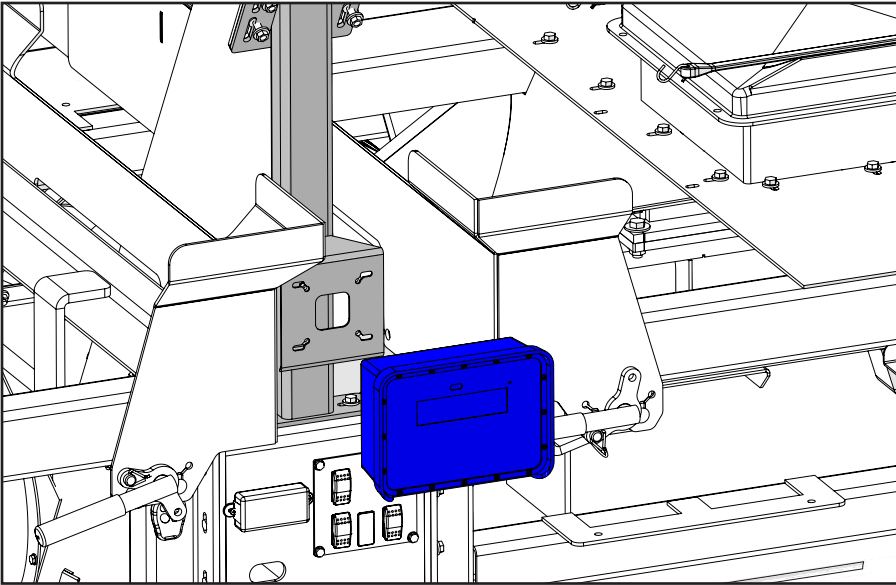

## **STEP TWO - 251 and 451**

- Unbolt the seed box frame from the trailer.

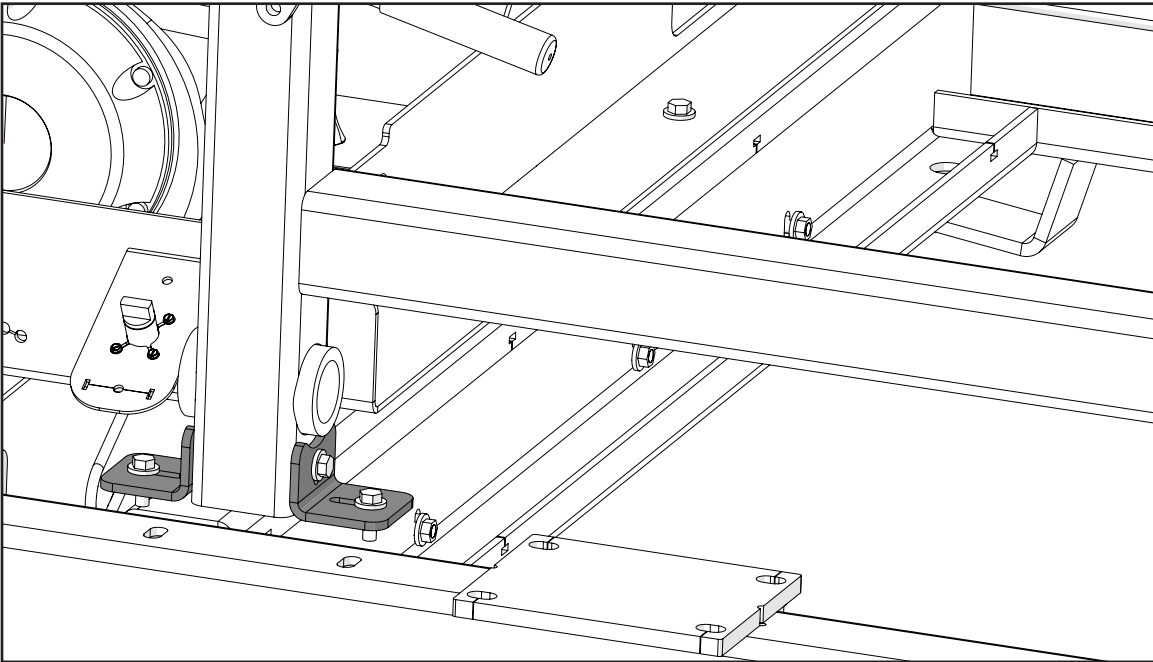

# Scale Assembly

## STEP THREE - 251 and 451

- Use an overhead hoist to lift the seed box frame slightly.
- Assemble a scale bar and scale bar mount as shown below, making sure the labels on the scale bar is facing up.
- Slide scale bar into the pipe in the seed box frame and line up the holes for the scale bar mount to the trailer frame.
- Do this to all four corners of the unit.

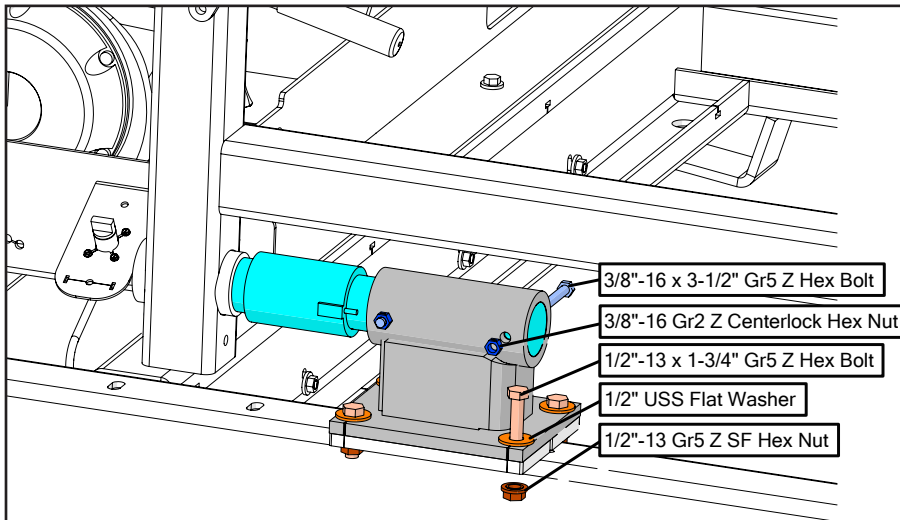

## STEP FOUR - 251 and 451

- Route all of the wires from the scale bars to the scale monitor and plug them in.
- Plug in the monitor to the diode board, making sure the green wire connect to each other. The system is now ready to use.

