



Manual

Talc Applicator

Installation Kit

Hydraulic Talc

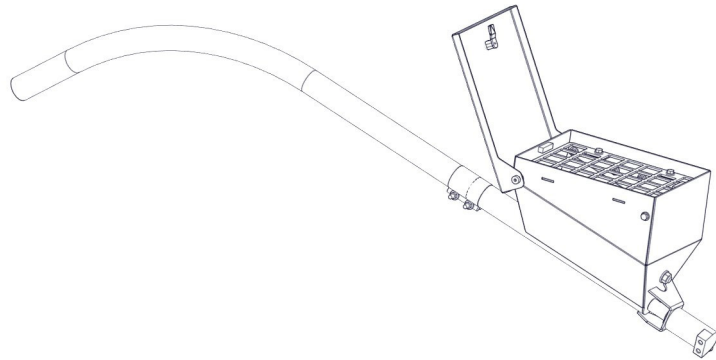

Rev. 8.12.2019

J&M Manufacturing Co, Inc

284 Railroad Street - P.O. Box 547 | Fort Recovery, OH 45846 | Ph: (419) 375-2376 | Fax: (419) 375-2708

www.jm-inc.com



Table of Contents

| | |
|----|--|
| 4 |To the Dealer |
| 5 |General Information |
| 6 | Bolt Torque Chart |
| 7 |Safety Rules |
| 8 | Talc Box Mount Assembly |
| 9 | Flex Flighting Assembly |
| 10 | Attaching Motor and Door Skirt |
| 11 | Talc PVC Tube Assembly |
| 12 | Assembly for Aluminum Valve |
| 13 | Assembly for Aluminum Valve |
| 14 | Assembly For Black Intercomp Valve |
| 15 | Hydraulic Schematic and Repair Parts for Black Intercomp Valve with Talc |
| 16 | Hydraulic Schematic and Repair Parts for Aluminum Valve Bank with Talc |
| 17 | Talc Parts for LC290, LC390 SpeedTenders |
| 18 | Talc Parts for SpeedTender Pro c450 |
| 19 | Talc Parts for LC535 SpeedTender |

To the Dealer

Read manual instructions and safety rules. Make sure all items on the Dealer's Pre-Delivery and Delivery Check Lists are completed before releasing equipment to the owner.

The dealer must complete the Warranty Registration found on the Dealer Portal website located at dealer.jm-inc.com and return it to J&M Mfg. Co., Inc. at the address indicated on the form. Warranty claims will be denied if the Warranty Registration has not been submitted.

EXPRESS WARRANTY:

J&M Mfg. Co., Inc. warrants against defects in construction or materials for a period of ONE year. We reserve the right to inspect and decide whether material or construction was faulty or whether abuse or accident voids our guarantee.

Warranty service must be performed by a dealer or service center authorized by J&M Mfg. Co., Inc. to sell and/or service the type of product involved, which will use only new or remanufactured parts or components furnished by J&M Mfg. Co., Inc. Warranty service will be performed without charge to the purchaser for parts or labor based on the Warranty Labor Times schedule. Under no circumstance will allowable labor times extend beyond the maximum hours indicated in the Warranty Labor Times schedule for each warranty procedure. The purchaser will be responsible, however, for any service call and/or transportation of the product to and from the dealer or service center's place of business, for any premium charged for overtime labor requested by the purchaser, and for any service and/or maintenance not directly related to any defect covered under the warranty. Costs associated with equipment rental, product down time, or product disposal are not warrantable and will not be accepted under any circumstance.

Each Warranty term begins on the date of product delivery to the purchaser. Under no circumstance will warranty be approved unless (i) the product warranty registration card has been properly completed and submitted to the equipment manufacturer, and (ii) a warranty authorization number has been issued by the equipment manufacturer. This Warranty is effective only if the warranty registration card is returned within 30 days of purchase.

This Warranty does not cover a component which fails, malfunctions or is damaged as a result of (i) improper modification or repair, (ii) accident, abuse or improper use, (iii) improper or insufficient maintenance, or (iv) normal wear or tear. This Warranty does not cover products that are previously owned and extends solely to the original purchaser of the product. Should the original purchaser sell or otherwise transfer this product to a third party, this Warranty does not transfer to the third party purchaser in any way. J&M Mfg. Co., Inc. makes no Warranty, express or implied, with respect to tires or other parts or accessories not manufactured by J&M Mfg. Co., Inc. Warranties for these items, if any, are provided separately by their respective manufacturers.

THIS WARRANTY IS EXPRESSLY IN LIEU OF ALL OTHER WARRANTIES OR CONDITIONS, EXPRESS, IMPLIED OR STATUTORY, INCLUDING ANY IMPLIED WARRANTY OF MERCHANTABILITY OR FITNESS FOR PARTICULAR PURPOSE.

In no event shall J&M Mfg. Co., Inc. be liable for special, direct, incidental or consequential damages of any kind. The exclusive remedy under this Warranty shall be repair or replacement of the defective component at J&M Mfg. Co., Inc.'s option. This is the entire agreement between J&M Mfg. Co., Inc. and the Owner about warranty and no J&M Mfg. Co., Inc. employee or dealer is authorized to make any additional warranty on behalf of J&M Mfg. Co., Inc.

The manufacturer reserves the right to make product design and material changes at any time without notice. They shall not incur any obligation or liability to incorporate such changes and improvements in products previously sold to any customer, nor shall they be obligated or liable for the replacement of previously sold products with products or parts incorporating such changes.

SERVICE:

The equipment you have purchased has been carefully manufactured to provide dependable and satisfactory use. Like all mechanical products, it will require cleaning and maintenance. Lubricate the unit as specified. Observe all safety information in this manual and safety signs on the equipment.

For service, your authorized J&M dealer has trained mechanics, genuine J&M service parts, and the necessary tools and equipment to handle all your needs.

Use only genuine J&M service parts. Substitute parts may void warranty and may not meet standards required for safety and satisfactory operation. Record the model number and serial number of your equipment in the spaces provided:

Model No: _____ **Serial No:** _____ **Date of Purchase:** _____

Purchased From: _____

Provide this information to your dealer to obtain correct repair parts.

General Information

TO THE OWNER:

The purpose of this manual is to assist you in operating and maintaining your Talc Applicator in a safe manner. Read it carefully. It furnishes information and instructions that will help you achieve years of dependable performance and help maintain safe operating conditions. If this machine is used by an employee or is loaned or rented, make certain that the operator(s), prior to operating:

1. Is instructed in safe and proper use.
2. Reviews and understands the manual(s) pertaining to this machine.

Throughout this manual, the term **IMPORTANT** is used to indicate that failure to observe can cause damage to equipment. The terms **CAUTION**, **WARNING** and **DANGER** are used in conjunction with the Safety-Alert Symbol (a triangle with an exclamation mark) to indicate the degree of hazard for items of personal safety. When you see this symbol, carefully read the message that follows and be alert to the possibility of personal injury or death.

 This Safety-Alert symbol indicates a hazard and means
ATTENTION! BECOME ALERT! YOUR SAFETY IS INVOLVED!

 **DANGER** Indicates an imminently hazardous situation that, if not avoided, will result in death or serious injury.

 **WARNING** Indicates a potentially hazardous situation that, if not avoided, will result in death or serious injury, and includes hazards that are exposed when guards are removed.

 **CAUTION** Indicates a potentially hazardous situation that, if not avoided, may result in minor or moderate injury.

IMPORTANT Indicates that failure to observe can cause damage to equipment.

NOTE Indicates helpful information.

Bolt Torque Chart

Always tighten hardware to these values unless a different torque or tightening procedure is listed for specific application. Fasteners must always be replaced with the same grade as specified in the manual parts list. Always use the proper tool for tightening hardware. Make sure fastener threads are clean and you start thread engagement properly. **Use these values when tightening all bolts and nuts with the exception of wheel nuts.**

SAE Fasteners

| Coarse Thread Series | | | | |
|------------------------------------|--------------------------|--------------------------|--------------------------|--------------------------|
| <i>Diameter and Pitch (Inches)</i> | Grade 5 | | Grade 8 | |
| | <i>Dry</i> | <i>Oiled</i> | <i>Dry</i> | <i>Oiled</i> |
| 1/4"-20 | 8 ft-lbs | 6 ft-lbs | 12 ft-lbs | 9 ft-lbs |
| 5/16"-18 | 17 | 13 | 25 | 18 |
| 3/8"-16 | 30 | 23 | 45 | 35 |
| 7/16"-14 | 50 | 35 | 70 | 55 |
| 1/2"-13 | 75 | 55 | 110 | 80 |
| 9/16"-12 | 110 | 80 | 150 | 110 |
| 5/8"-11 | 150 | 110 | 220 | 170 |
| 3/4"-10 | 260 | 200 | 380 | 280 |
| 7/8"-9 | 430 | 320 | 600 | 460 |
| 1"-8 | 640 | 480 | 900 | 680 |
| Fine Thread Series | | | | |
| <i>Diameter and Pitch (Inches)</i> | <i>Clamp Load (Lbs.)</i> | <i>Tightening Torque</i> | <i>Clamp Load (Lbs.)</i> | <i>Tightening Torque</i> |
| 1/4"-28 | 10 ft-lbs | 7 ft-lbs | 14 ft-lbs | 10 ft-lbs |
| 5/16"-24 | 19 | 14 | 29 | 20 |
| 3/8"-24 | 35 | 25 | 50 | 40 |
| 7/16"-20 | 55 | 40 | 80 | 60 |
| 1/2"-20 | 90 | 65 | 120 | 90 |
| 9/16"-18 | 120 | 90 | 170 | 130 |
| 5/8"-18 | 180 | 130 | 240 | 180 |
| 3/4"-16 | 300 | 220 | 420 | 320 |
| 7/8"-14 | 470 | 360 | 660 | 500 |

Safety Rules



ATTENTION! BECOME ALERT! YOUR SAFETY IS INVOLVED!



Safety is a primary concern in the design and manufacture of our products. Unfortunately, our efforts to provide safe equipment can be erased by an operator's single careless act. In addition, hazard control and accident prevention are dependent upon the awareness, concern, judgment, and proper training of personnel involved in the operation, transport, maintenance and storage of equipment.

Make certain that the operator(s), prior to operating is instructed in safe and proper use and reviews and understands the manual(s) pertaining to this machine.

Read this manual before you operate this machine. If you do not understand any part of this manual, or need more information, contact the manufacturer or your authorized dealer.

SAFETY

Understand that your safety and the safety of other persons is measured by how you service and operate this machine. Know the positions and functions of all controls before you try to operate them. Make sure to check all controls in a safe area before starting your work.

The safety information given in this manual does not replace safety codes, federal, state or local laws. Make certain your machine has the proper equipment as designated by local laws and regulations.

- Relieve all pressure, before disconnecting fluid lines,
- Before applying pressure, make sure all connections are tight and components are in good condition,
- Never use your hand to check for suspected leaks under pressure. Use a piece of cardboard or wood for this purpose.
- If injured by leaking fluid, see your doctor immediately.
- Keep clear of moving parts at all times when operating the talc unit.
- Be sure all safety shields are in place before operation.

Make sure everyone is clear of equipment before applying power or moving the machine.

DECALS

|  ADVANCED SEED DELIVERY | | | | | |
|--|----------|--|---|---|---------|
| TALC APPLICATOR FLOW CONTROL SETTINGS | | | | | |
| Flow Control Setting | Cups/min | Cups/unit @ 24.4 units/min (1 door fully open) | Cups/unit @ 30 units/min (2 doors fully open) | Cups/unit @ 45 units/min (S35 Only) (2 doors fully open) | Lbs/min |
| 1.5 | 0.0 | 0.0 | 0.0 | 0.0 | 0.0 |
| 2.0 | 0.6 | 0.0 | 0.0 | 0.0 | 0.2 |
| 2.5 | 1.3 | 0.1 | 0.0 | 0.0 | 0.4 |
| 3.0 | 3.8 | 0.2 | 0.1 | 0.1 | 1.3 |
| 3.5 | 6.3 | 0.3 | 0.2 | 0.1 | 2.1 |
| 4.0 | 6.6 | 0.3 | 0.2 | 0.1 | 2.2 |
| 4.5 | 7.0 | 0.3 | 0.2 | 0.2 | 2.3 |
| 5.0 | 9.0 | 0.4 | 0.3 | 0.2 | 3.0 |
| 5.5 | 11.0 | 0.5 | 0.4 | 0.2 | 3.7 |
| 6.0 | 14.5 | 0.6 | 0.5 | 0.3 | 4.8 |
| 6.5 | 18.0 | 0.7 | 0.6 | 0.4 | 6.0 |
| 7.0 | 21.5 | 0.9 | 0.7 | 0.5 | 7.2 |
| 7.5 | 25.0 | 1.0 | 0.8 | 0.6 | 8.4 |
| 8.0 | 27.5 | 1.1 | 0.9 | 0.6 | 9.2 |
| 8.5 | 30.0 | 1.2 | 1.0 | 0.7 | 10.0 |
| 9.0 | 35.0 | 1.4 | 1.2 | 0.8 | 11.7 |
| 10.0 | 40.0 | 1.6 | 1.3 | 0.9 | 13.4 |



Place Decal on Talc Box. Place on side most visible to the user.

Talc Box Mount Assembly

STEP ONE - LC290 & LC390

- Bolt the LC290/LC390 talc box mounting bracket (JM0037272) to the SpeedTender's front passenger side leg using two 3/8" x 1" flange screws and 3/8" flange nuts. Hand tighten fasteners.
- Fasten the talc box (JM0037538) and talc rotation bracket (JM0038395) onto the LC290/LC390 talc box mounting bracket. Hand tighten fasteners.

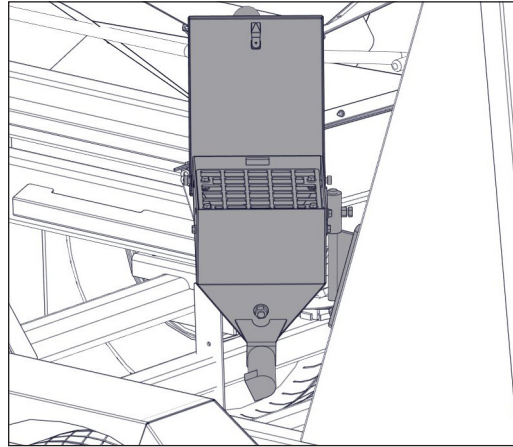
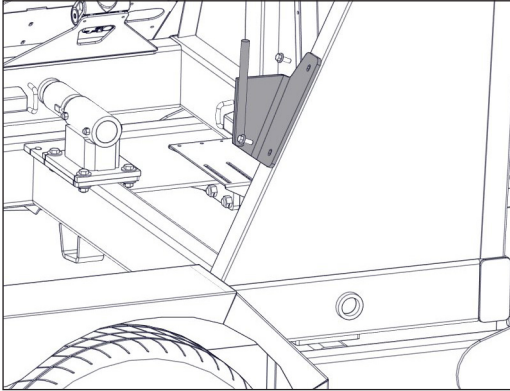

STEP ONE - LC535

- Bolt the LC535 talc box mounting bracket (JM0037641) to the SpeedTender's rear driver side leg using five 3/8" x 1" flange screws and 3/8" flange nuts. Hand tighten fasteners.
- Fasten the talc box (JM0037538) and talc rotation bracket (JM0038395) onto the LC535 talc box mounting bracket. Hand tighten fasteners.

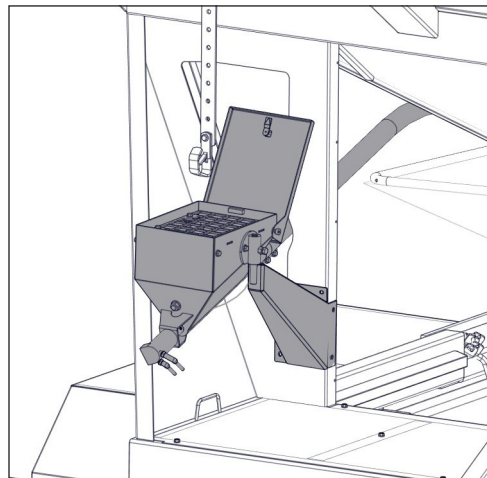
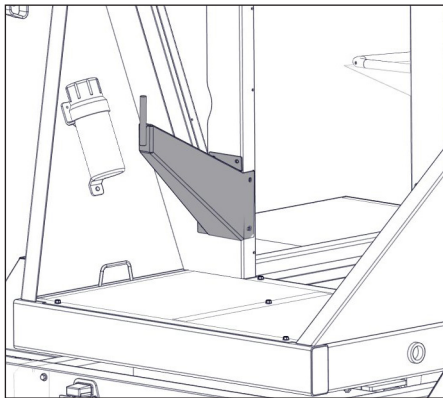

Flex Flighting Assembly

STEP ONE - SpeedTender Pro c4-50

- Bolt the SpeedTender Pro c4-50 talc box mounting bracket (JM0037645) to the SpeedTender's front passenger side leg using four 3/8" x 1" flange screws and 3/8" flange nuts. Hand tighten fasteners.
- Fasten the talc box (JM0037538) to the SpeedTender Pro c4-50 talc box mounting bracket.

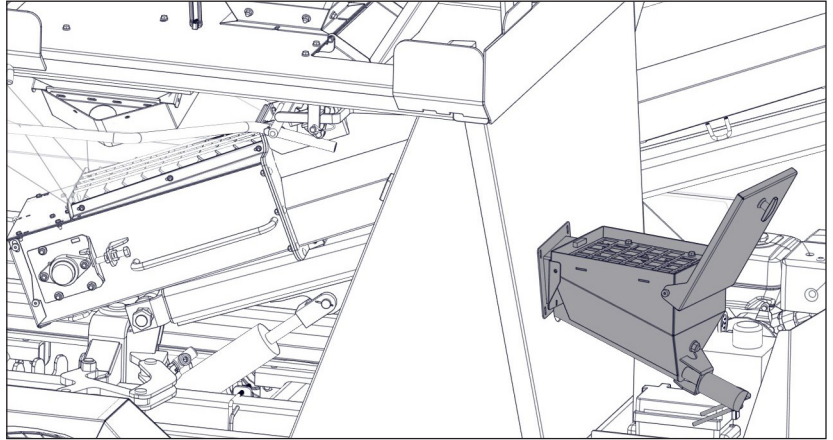
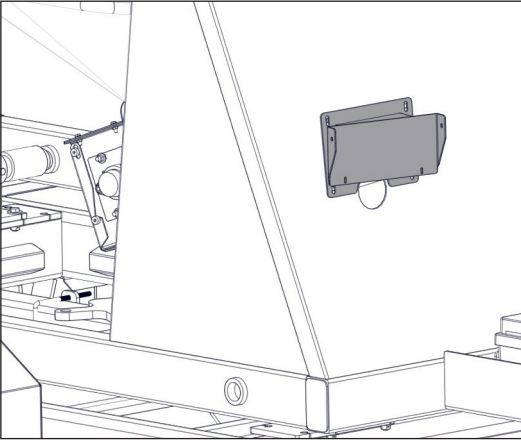

STEP TWO - All Models

- Insert the flex flighting weldment (LC390-JM0042587, LC290-JM0042838, SpeedTender Pro c4-50/LC535-JM0043060) with the nylon washer (JM0035079) into the talc box and ensure the nylon washer is seated firmly against the side of the box and the flighting weldment sprocket is meshed with the agitator sprocket.

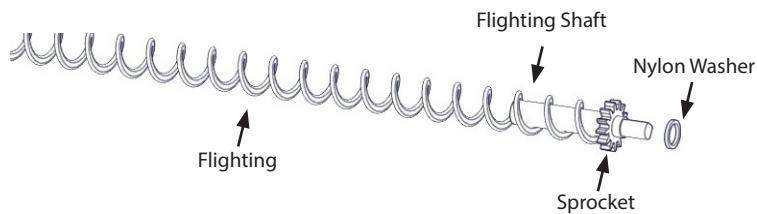

STEP THREE - All Models

- Slide the shaft coupler (JM0042842) onto the flighting weldment shaft and fasten using the set screws provided. Ensure the shaft coupler is slid as far up the flighting weldment shaft as possible.

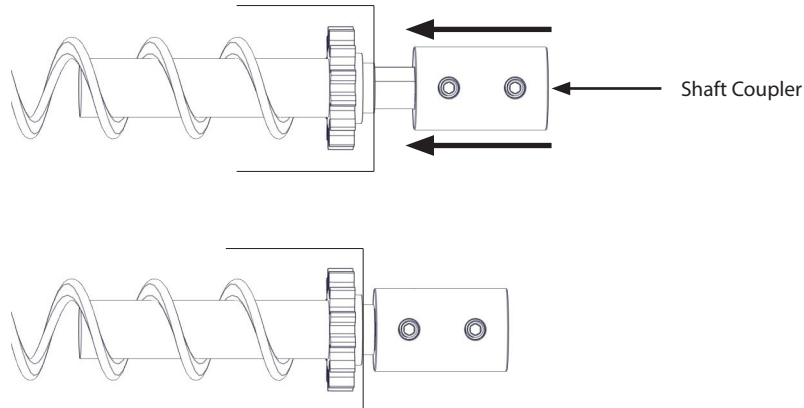

Attaching Motor and Door Skirt

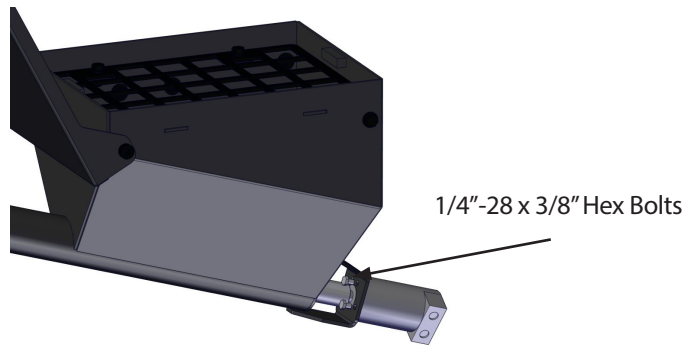

STEP FOUR - All models

- Align the motor shaft key with the keyway in the shaft coupler.
- Attach the hydraulic motor (JM0042491) to the talc box using the three 1/4"-28 x 3/8" hex bolts and tighten.

STEP FIVE - All models

- Again, be sure the nylon washer on the flighting weldment is firmly seated against the inside face of the talc box. Tap the flighting with a hammer to confirm that the flighting washer is properly seated. Tighten the set screw on the hydraulic motor shaft.

STEP SIX - (Skip this step for LC535 units)

- Remove the rubber door skirt (below doors) from the SpeedTender and fasten the talc spout bracket (JM0042542) and talc rubber door skirt (JM0042688) to the bottom of the SpeedTender door. Hand tighten fasteners.

Talc Spout Bracket

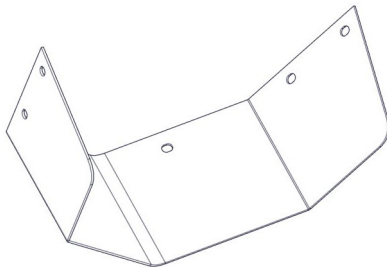
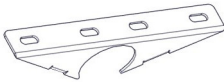

Rubber Skirt

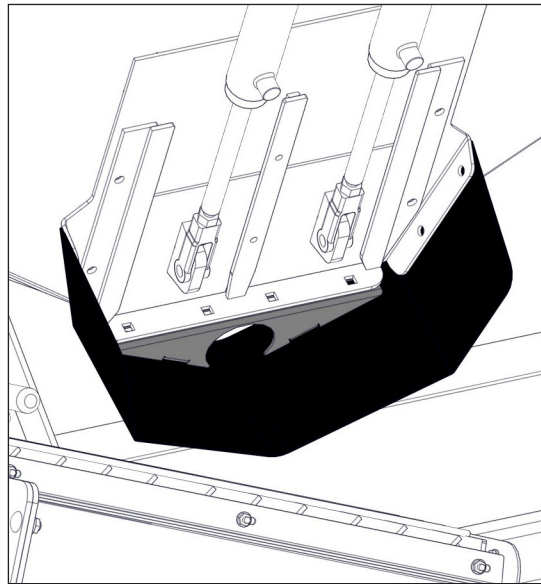

Talc PVC Tube Assembly

STEP SEVEN - LC290, LC390 & SpeedTender Pro c4-50

- Attach the talc fighting PVC tube (LC390 - JM0042810, LC290 - JM0042809, SpeedTender Pro c4-50 - JM0043049) over the fighting with the 2" exhaust clamp. (JM0037668)
- Before tightening the 2" exhaust clamp, insert the talc fighting PVC tube spout into the talc spout bracket. Ensure the talc box is oriented so the talc fighting PVC tube is in line with the talc box pipe (as shown below). Tighten the 2" exhaust clamp. Tighten all fasteners.

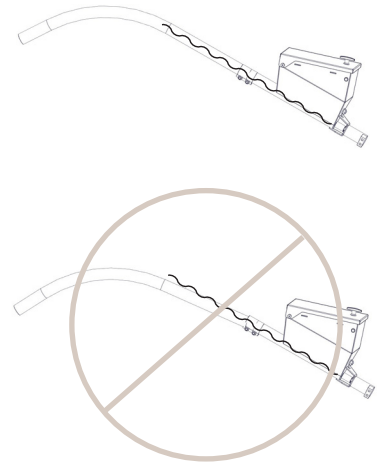
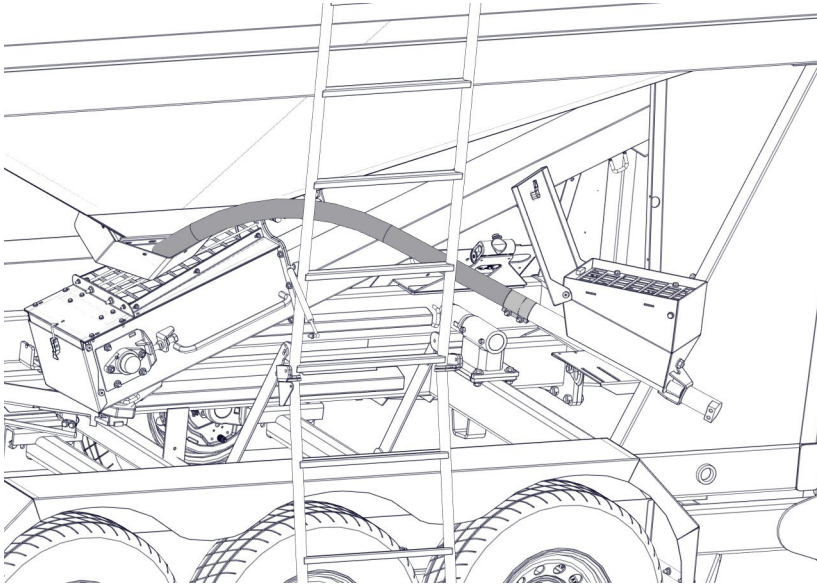

STEP SEVEN - LC535

- Attach the talc fighting PVC tube (LC535-JM0043049) over the fighting with the 2" exhaust clamp.
- Before tightening the 2" exhaust clamp ensure the talc box is oriented so the talc fighting PVC tube is in line with the talc box pipe (shown below) and the spout is hanging over the conveyor hopper inlet. Tighten the 2" exhaust clamp. Tighten all fasteners.
- Use the 2" pipe loop clamp (JM0043498), 3/8" x 1" flange bolt and 3/8" flange nut to fasten the talc fighting PVC tube to the LC535 tank.

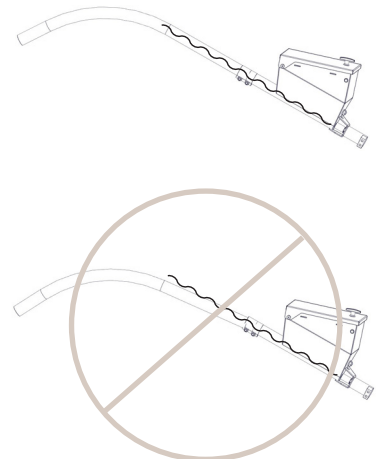
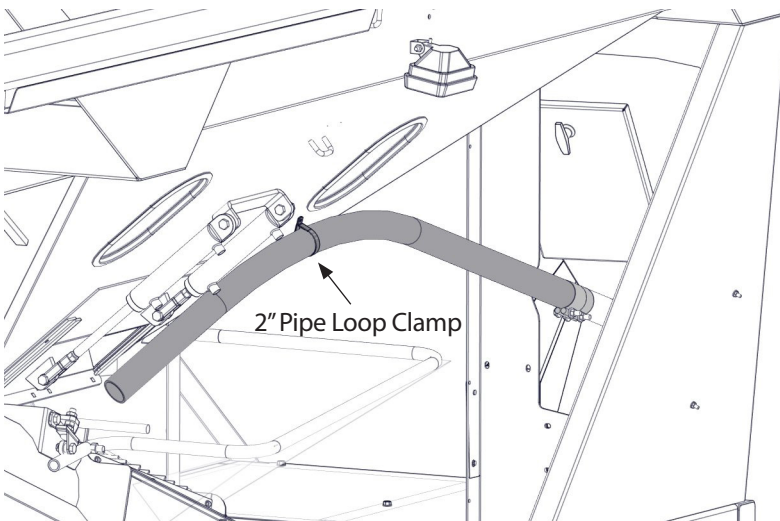

Assembly for Aluminum Valve

If you have a Black Intercomp Valve go to “Assembly For Black Intercomp Valve” on page 14.

If you have an Aluminum Valve, continue with the following instructions:

STEP EIGHT - All models

- Mount the flow control valve (JM0026104) using the flow control mounting bracket (LC290/LC390/SpeedTender Pro c4-50-JM0043097, LC535-JM0025400). Mount in the location shown below by removing the scale box bolts. Remove and attach 1 bolt at a time to keep the scale box secure.

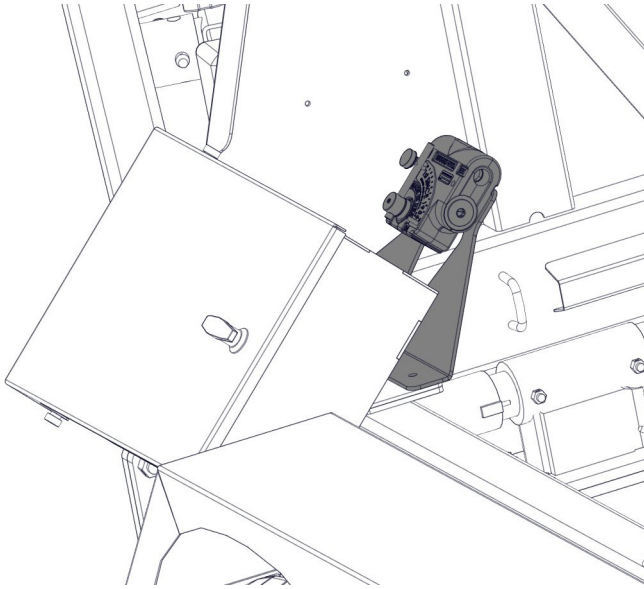

STEP NINE - All models

- Bolt the flow control valve (JM0026104) to the flow control mounting bracket using (2) 1/4" x 2" hex bolts and (2) 1/4" lock nuts.
- Assemble the fittings to the flow control valve as shown below. Apply Teflon tape to pipe thread before assembly.

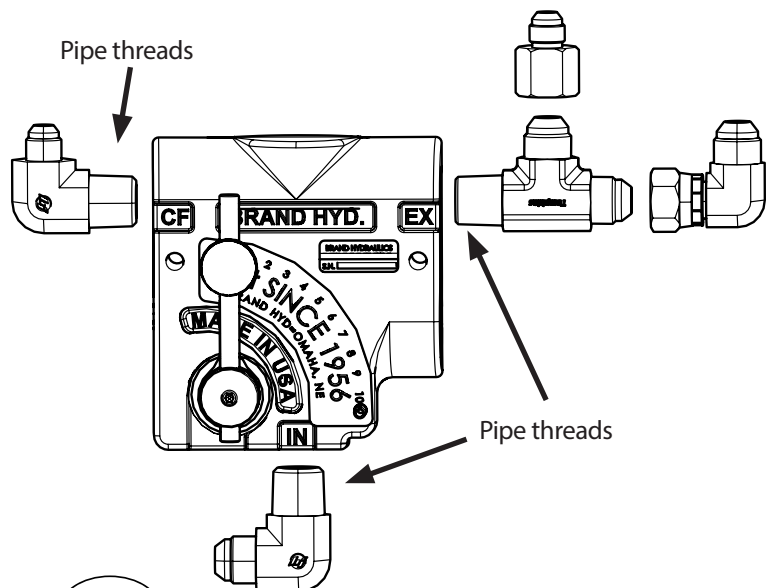
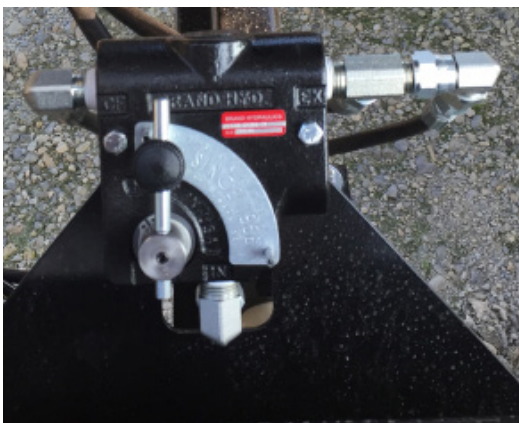

Assembly for Aluminum Valve

STEP TEN - All models

- Route the talc motor hydraulic hoses (JM0042861) through the conduits on the trailer as shown below. Tighten the hoses to the flow control valve and hydraulic talc motor.

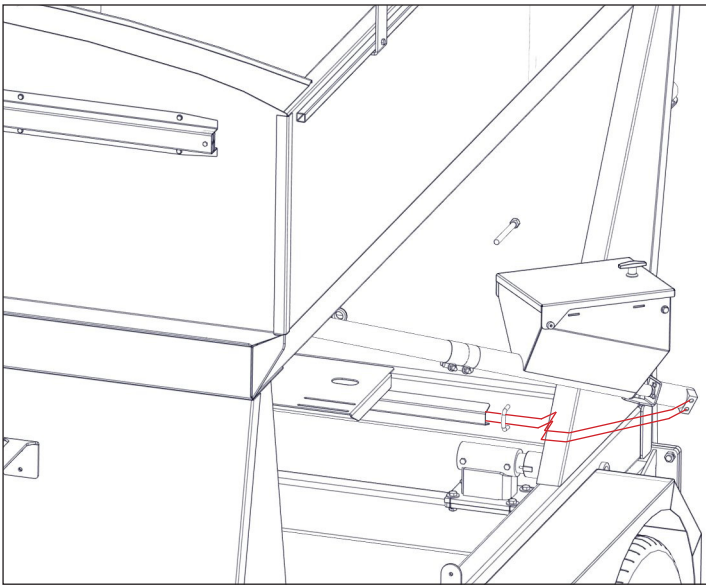

LC290/LC390

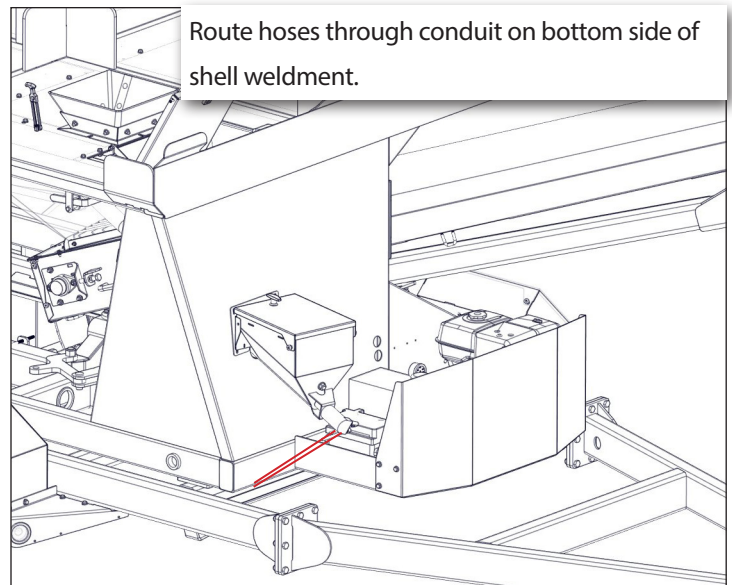

SpeedTender Pro c4-50

STEP ELEVEN - All models

- Remove the conveyor motor return hose from the conveyor return port on the seed tender valve bank and attach the 20" supply hose (JM0042862) to the conveyor motor return hose and to the "IN" port elbow on the flow control valve. See "Hydraulic Schematic and Repair Parts for Aluminum Valve Bank with Talc" on page 16.

STEP TWELVE - All models

- Attach the 30" return hose (JM0042863) to the "EX" port elbow on the flow control valve and the "Conveyor Return" port on the SpeedTender valve bank. See "Hydraulic Schematic and Repair Parts for Aluminum Valve Bank with Talc" on page 16.

Assembly For Black Intercomp Valve

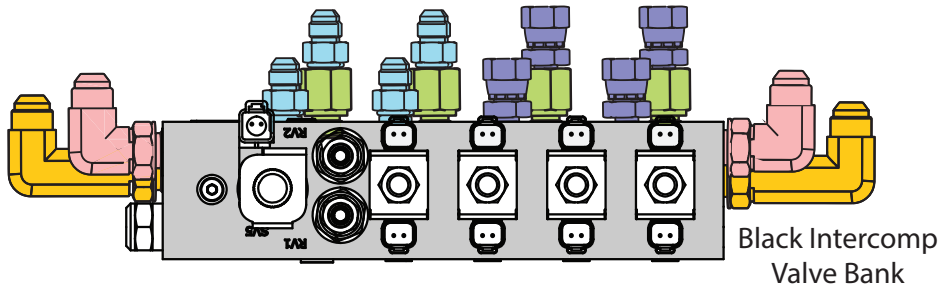

The black intercomp valve bank is shown on the left.

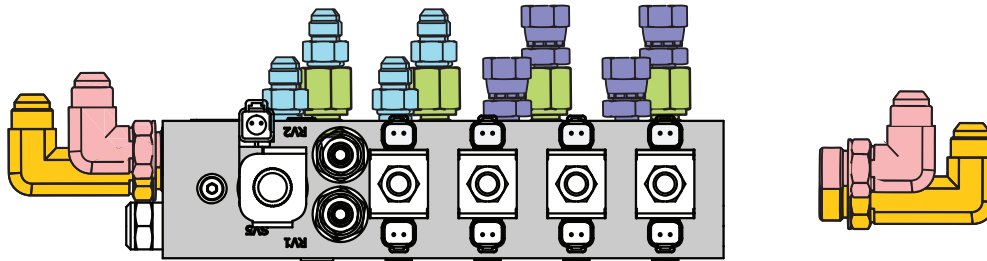

STEP NINE - All models

- Remove the two 90° hydraulic fittings on the right side shown on the left.

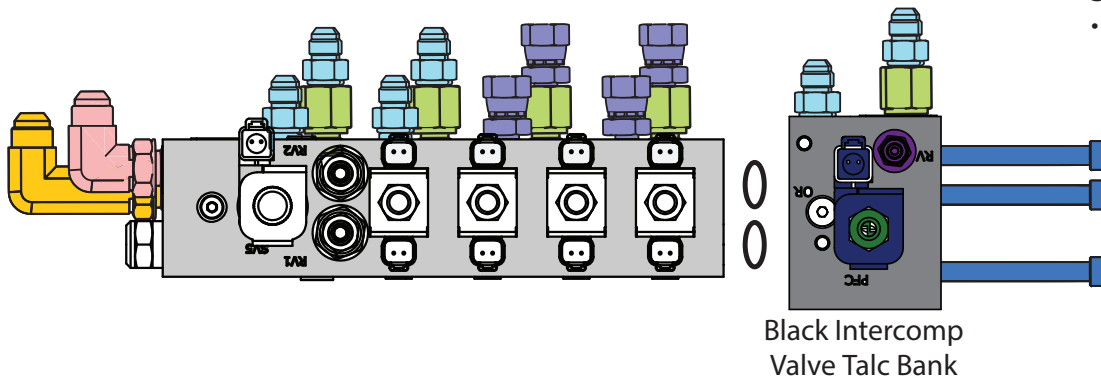

STEP TEN - All models

- Add the black intercomp valve talc bank using the two o-rings and three bolts to secure it to the main valve bank.

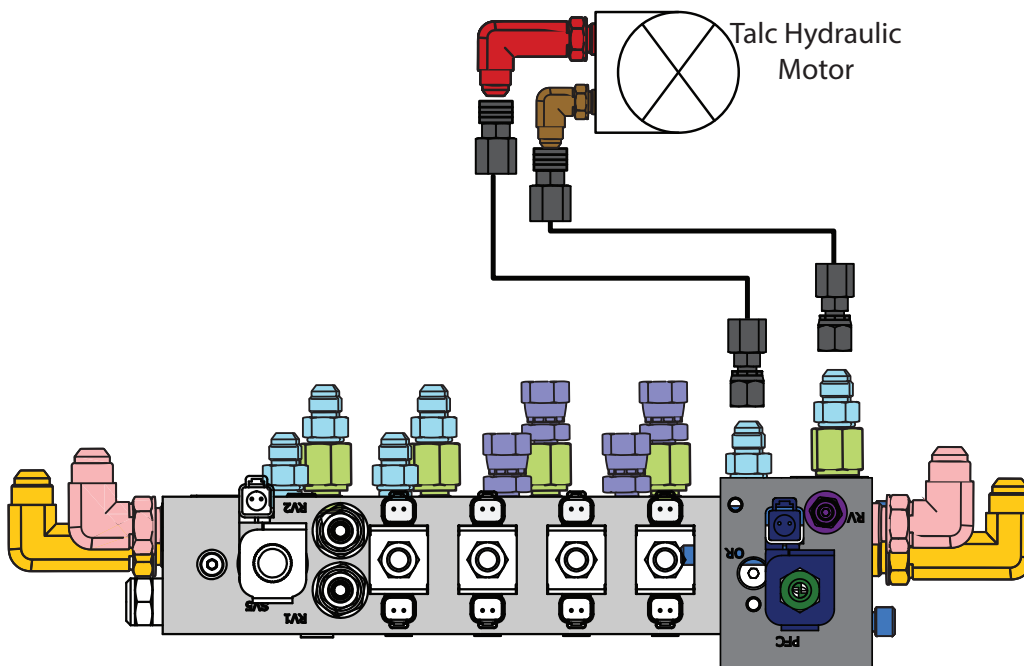

STEP ELEVEN - All models

- Add the two 90° hydraulic fittings into the side of the black intercomp valve talc bank. Insert the fittings (coming out of the front of the bank shown on the left) to the valve bank. Connect the hoses and run them to the talc hydraulic motor. Be sure to tighten all fasteners.

NOTE: Route the hoses as shown in image on page 13.

Hydraulic Schematic and Repair Parts for Black Intercomp Valve with Talc

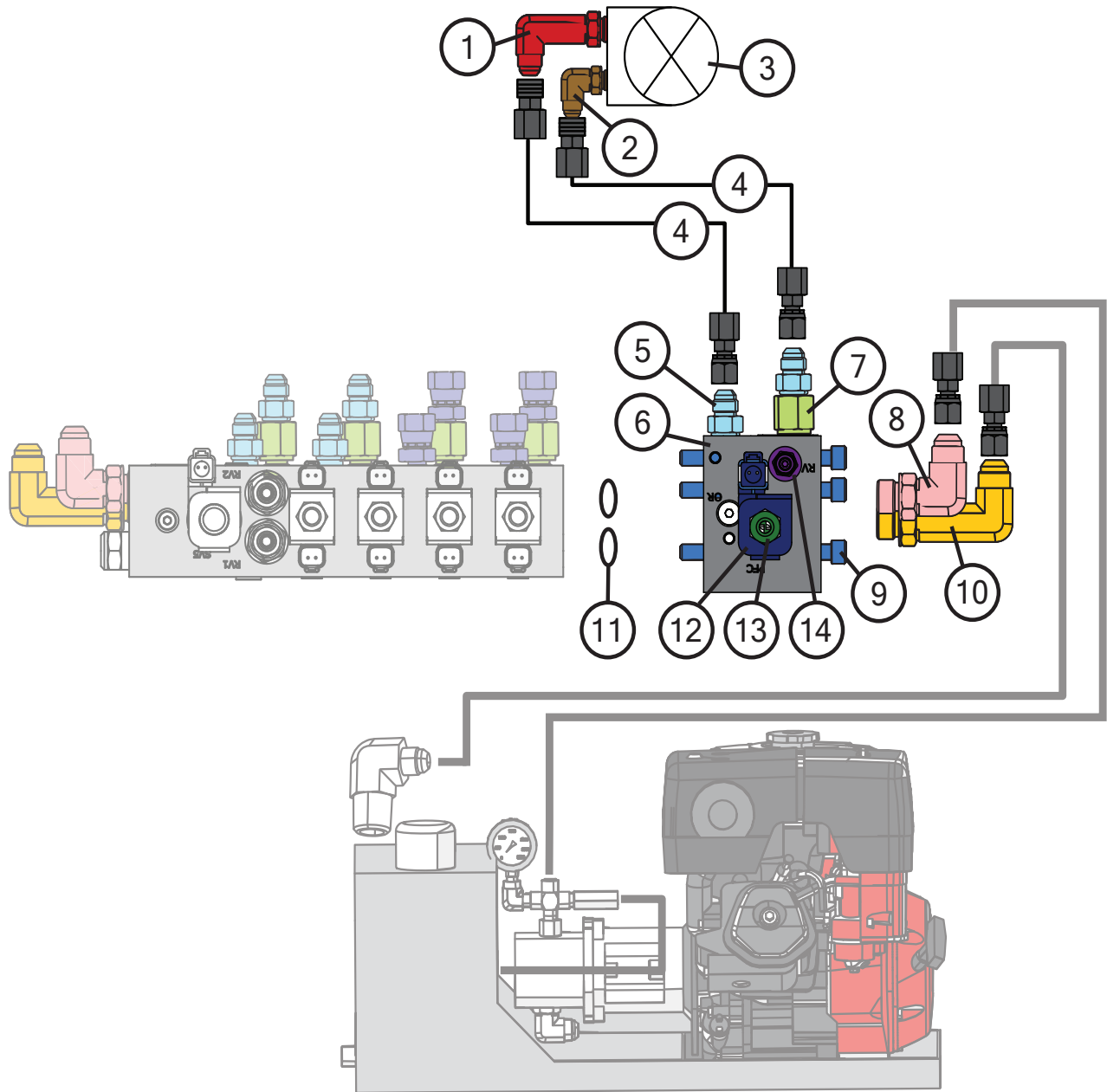

| | Description | Part No. |
|----|---|-----------|
| 1 | 3/8" Male JIC x 3/8" Male ORB; Extra Long 90 Degree Elbow (6801-LL-06-06) | JM0039050 |
| 2 | 3/8" Male JIC x 3/8" Male ORB; 90 Degree Elbow | JM0026121 |
| 3 | White Drive Hydraulic Motor - 125032JL5C3AAAAA | JM0042491 |
| 4 | 1/4" x 84" Hydraulic Hose 84inch4M3K-4G-6FJX-4G-6FJX | JM0051419 |
| 5 | 3/8" Male JIC x 3/8" Male ORB; Straight | JM0043614 |
| 6 | Intercomp Talc Block Assembly (FA/VBBA-TA) | JM0051361 |
| 7 | 3/8" Male ORB x 3/8" Female ORB; Straight Reducer | JM0039051 |
| 8 | 1/2" Male JIC x 3/4" Male NPT; 90 Degree Elbow | JM0033775 |
| 9 | 5/16"-18 x 3-1/2" Socket Head Cap Screw | JM0051418 |
| 10 | 1/2" Male JIC x 1/2" Male ORB; Extra Long 90 Degree Elbow (6801-LL-08-08) | JM0046935 |
| 11 | Talc O-Ring (FA/VBBA-TA) | JM0051416 |
| 12 | Talc Coil/Solenoid (FA/VBBA-TA) | JM0051412 |
| 13 | Talc Cartridge Proportional (FA/VBBA-TA) | JM0051413 |
| 14 | Talc Pressure Relief Valve (FA/VBBA-TA) | JM0051415 |

Hydraulic Schematic and Repair Parts for Aluminum Valve Bank with Talc

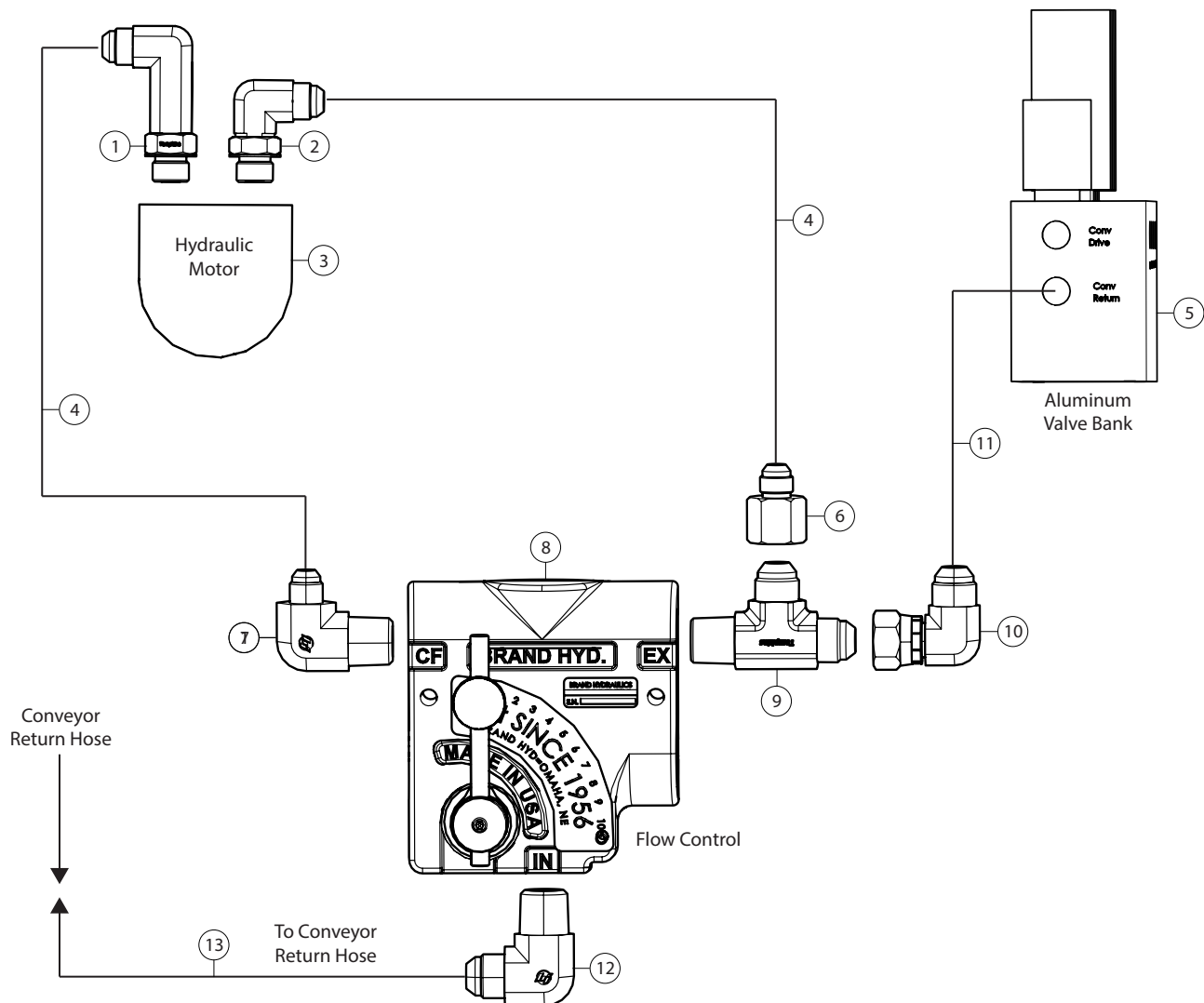

| | Description | JM# |
|----|--|-----------|
| 1 | #6 male JIC X #6 male o-ring – Extra Long 90 degree elbow | JM0039050 |
| 2 | #6 male JIC X #6 male o-ring – 90 degree elbow | JM0026121 |
| 3 | White Drive Hydraulic Motor - 125032JL5C3AAAAA or Danfoss equivalent | JM0042491 |
| 4 | 116" Long x 3/8" Hydraulic Hose (4M3K-4G-6FJX-4G-6FJX-116in) | JM0042861 |
| 5 | 5 Function Aluminum Valve Block | JM0029973 |
| 6 | #8 female JIC x #6 male JIC reducer (2406-08-06) | JM0026117 |
| 7 | #6 male JIC x 1/2" male NPT; 90 degree elbow (2501-06-08) | JM0042849 |
| 8 | Flow Control Talc Applicator FC51 -.5 (0-2 GPM) | JM0026104 |
| 9 | #8 male JIC x 1/2" male NPT x #8 male JIC tee (2605-08-08-08) | JM0026119 |
| 10 | #8 male JIC x #8 female JIC swivel; 90 degree elbow (6500-08-08) | JM0010296 |
| 11 | 30" Hydraulic Hose x 3/8" (8M3K8G8FJX8G8FJX-30) | JM0042863 |
| 12 | #8 male JIC x 1/2" male NPT; 90 degree elbow (2501-08-08) | JM0042847 |
| 13 | 20" Hydraulic Hose x 3/8" (8M3K8G8MJ8G8FJX-20) | JM0042862 |

Talc Parts for LC290, LC390 SpeedTenders

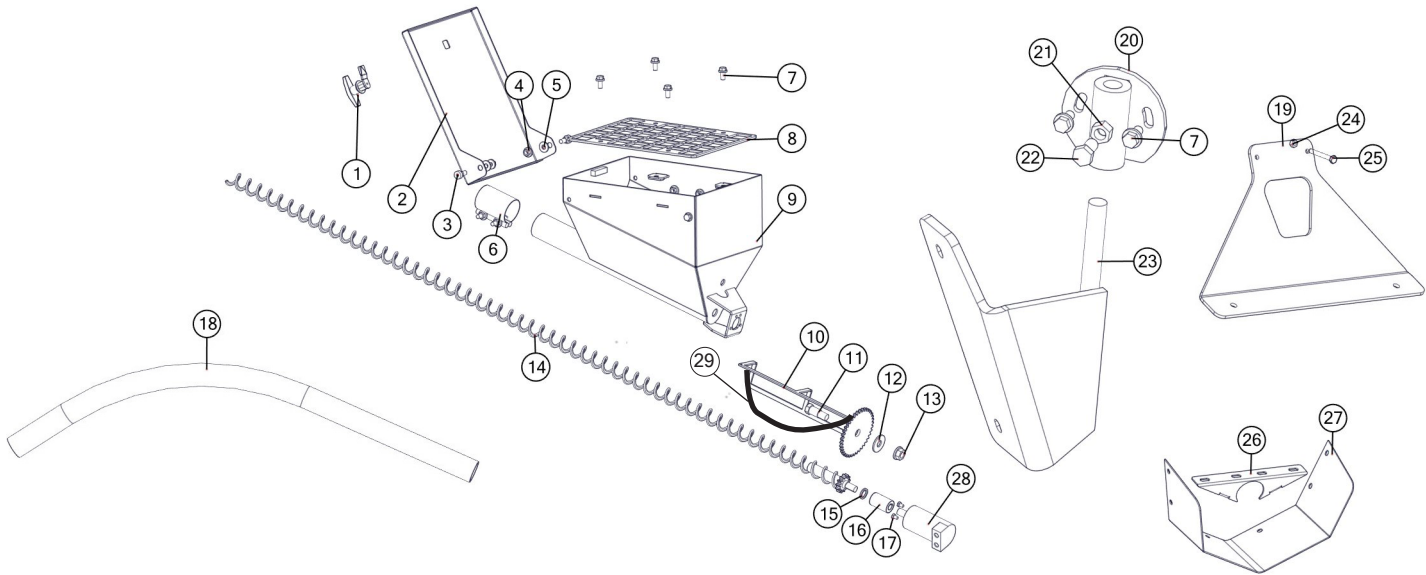

| Description | Part No. |
|--|-----------|
| 1 Chrome T-Handle Non-Locking | JM0001911 |
| 2 17 Deg. Talc Box Door (Electric & Hydraulic Motor) | JM0037237 |
| 3 1/2" Shoulder Dia x 3/8" Shoulder Length x 3/8"-16 Socket Shoulder Bolt | JM0009998 |
| 4 3/8"-16 Gr5 Z SF Hex Nut | JM0002152 |
| 5 3/8" ID, 1" OD Z Flat Washer | JM0003061 |
| 6 2" Exhaust Clamp with Fasteners (Electric & Hydraulic Motor) | JM0037668 |
| 7 3/8"-16 x 3/4" Gr5 Z SF Hex Bolt | JM0001750 |
| 8 Large Talc Box Screen (Electric & Hydraulic Motor) | JM0037456 |
| 9 17 Deg. Talc Box Weldment (Electric & Hydraulic Motor) | JM0037538 |
| 10 Large Agitator 17 Deg. (Electric & Hydraulic Motor) | JM0037241 |
| 11 3/4" Shoulder Dia x 1" Shoulder Length x 5/8"-11 Hex Head Shoulder Bolt and Nut (SB-34) | JM0003181 |
| 12 3/4" ID, 2" OD Z Flat Washer | JM0010006 |
| 13 5/8"-18 Gr5 Z SF Hex Nut | JM0043101 |
| 14 290 Flex Auger Flighting Weldment | JM0042838 |
| 14 390 Flex Auger Flighting Weldment | JM0042587 |
| 15 3/4" Nylon Flatwasher | JM0035079 |
| 16 5/8" Keyed Shaft Coupling | JM0042842 |
| 17 1/4"-28 x 3/8" Gr5 Z Hex Bolt | JM0043100 |
| 18 290 Flex Auger Heat Bent PVC Pipe (45') | JM0042809 |
| 18 390 Flex Auger Heat Bent PVC Pipe | JM0042810 |
| 19 Hydraulic Talc Flow Control Mounting Bracket | JM0043097 |
| 20 Talc Rotation Bracket Weldment (Electric & Hydraulic Motor) | JM0038395 |
| 21 1/2"-13 Gr5 Z Hex Nut | JM0002124 |
| 22 1/2"-13 x 1" Gr5 Z Hex Bolt | JM0010225 |
| 23 Talc Mounting Bracket Weldment (Electric & Hydraulic Motor) | JM0037272 |
| 24 1/4"-20 Gr2 Z Centerlock Hex Nut | JM0001505 |
| 25 1/4"-20 x 2-1/2" Gr5 Z Hex Bolt | JM0001506 |
| 26 Hydraulic Talc Spout Clamp | JM0042542 |
| 27 SpeedTender Rubber Door Skirt for Standard and Talc | JM0048679 |
| 28 White Drive Hydraulic Motor - 125032JL5C3AAAAA | JM0042491 |
| 29 Weed Whip Cord 18" - Professional Extreme - 5/32" | JM0038500 |

275 & 375 Retro Kit Additional Parts

| Description | JM# |
|-----------------------------|-----------|
| LC Series Hopper Hoop | JM0040345 |
| LC Series Hopper Tarp | JM0041069 |
| LC Series Hopper Tarp Cover | JM0041070 |

Talc Parts for SpeedTender Pro c450

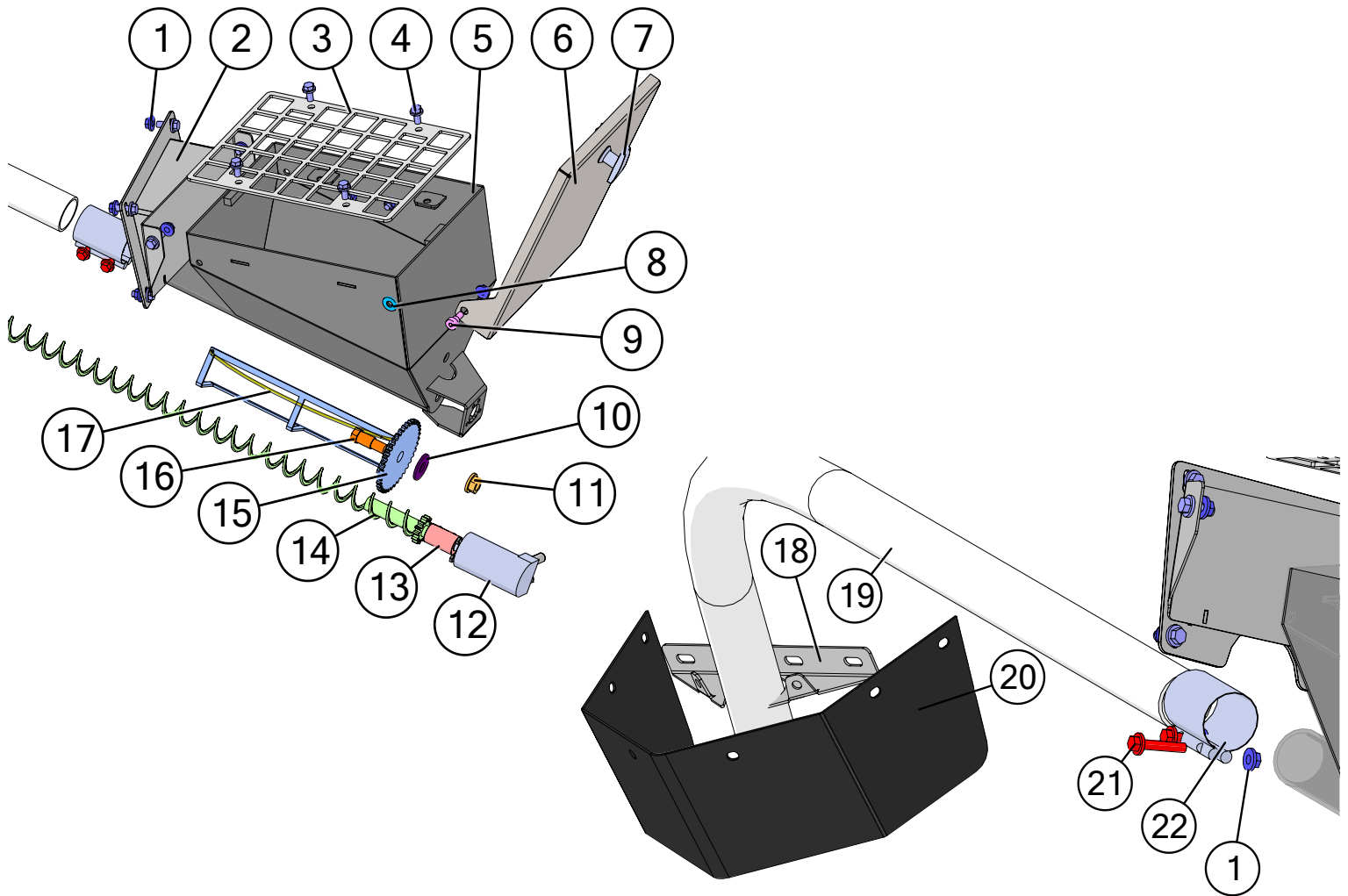

| | Description | Part No. |
|----|---|-----------|
| 1 | 3/8"-16 Gr5 Z SF Hex Nut | JM0002152 |
| 2 | c450 Talc Mounting Bracket Weldment | JM0037645 |
| 3 | Large Talc Box Screen (Electric & Hydraulic Motor) | JM0037456 |
| 4 | 3/8"-16 x 3/4" Gr5 Z SF Hex Bolt | JM0001750 |
| 5 | 17 Deg. Talc Box Weldment (Electric & Hydraulic Motor) | JM0037538 |
| 6 | 17 Deg. Talc Box Door (Electric & Hydraulic Motor) | JM0037237 |
| 7 | Chrome T-Handle Non-Locking | JM0001911 |
| 8 | 3/8 USS Flat Washer | JM0003061 |
| 9 | 1/2" Shoulder Dia x 3/8" Shoulder Length x 3/8"-16 Socket Shoulder Bolt | JM0009998 |
| 10 | 5/8" USS Flat Washer | JM0003073 |
| 11 | 0.625-18 Gr5 Z SF Hex Nut | JM0043101 |
| 12 | White Drive Hydraulic Motor - 125032JL5C3AAAAA | JM0042491 |
| 13 | 5/8" Keyed Shaft Coupling | JM0042842 |
| 14 | C4-50/535 Flex Auger Flighting Weldment | JM0043060 |
| 15 | Large Agitator 17 Deg. (Electric & Hydraulic Motor) | JM0037241 |
| 16 | 3/4" Shoulder Dia x 1" Shoulder Length x 5/8"-11 Hex Head Shoulder Bolt and Nut (SB-34) | JM0003181 |
| 17 | Weed Whip Cord 18" - Professional Extreme - 5/32" | JM0038500 |
| 18 | Hydraulic Talc Spout Door Bracket | JM0042542 |
| 19 | 535/c450 Flex Auger Heat Bent PVC Pipe | JM0043049 |
| 20 | SpeedTender Rubber Door Skirt for Standard and Talc | JM0048679 |
| 21 | 3/8"-16 x 2" Gr5 Z SF Hex Bolt | JM0016070 |
| 22 | 2" Exhaust Clamp with Fasteners (Electric & Hydraulic Motor) | JM0037668 |

Talc Parts for LC535 SpeedTender

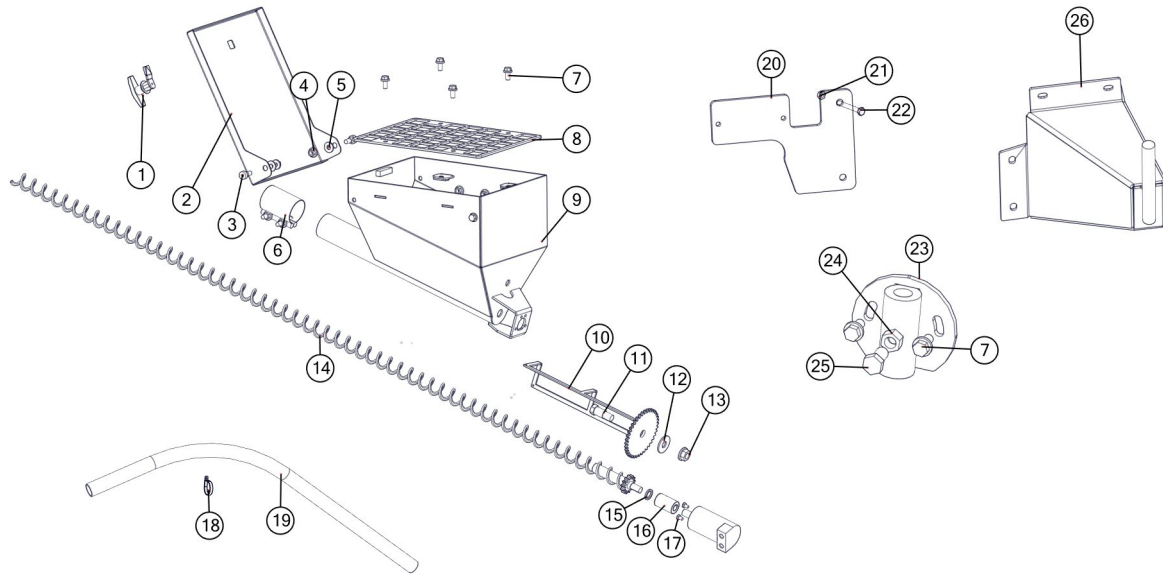

| | Description | JM# |
|----|---|-----------|
| 1 | T-Handle Non-Locking Chrome | JM0001911 |
| 2 | 17 Deg. Talc Box Door | JM0037237 |
| 3 | 1/2" x 3/8" LG Shoulder Bolt | JM0009998 |
| 4 | 3/8"-16 Gr5 Z SF Hex Nut | JM0002152 |
| 5 | 3/8 USS Flat Washer | JM0003061 |
| 6 | 2" Exhaust Clamp | JM0037668 |
| 7 | 3/8-16 x 1" Gr5 Z SF Hex Bolt | JM0002092 |
| 8 | Large Talc Box Screen | JM0037456 |
| 9 | 17 Deg. Talc Box Weldment | JM0037538 |
| 10 | Large Agitator 17 Degree | JM0037241 |
| 11 | 3/4" x 2-1/2" Shoulder Bolt | JM0003181 |
| 12 | 3/4" USS Flat Washer | JM0010006 |
| 13 | 5/8"-18 Gr5 Z SF Hex Nut | JM0043101 |
| 14 | C4-50 & 535 Flex Auger Flighting Weldment | JM0043060 |
| 15 | 3/4" Flatwasher Nylon | JM0035079 |
| 16 | 5/8" Keyed Shaft Coupling | JM0042842 |
| 17 | 1/4"-28 x 3/8" Gr5 Z Hex Bolt | JM0043100 |
| 18 | 2" Pipe Loop Clamp | JM0043498 |
| 19 | 535/C4-50 Flex Auger Heat Bent PVC Pipe | JM0043049 |
| 20 | 535 Bolt on Plate Talc Valve | JM0025400 |
| 21 | 1/4"-20 Gr5 Centerlock Hex Nut | JM0001505 |
| 22 | 1/4"-20 x 2-1/2" Gr5Z Hex Bolt | JM0001506 |
| 23 | Talc Rotation Bracket Weldment | JM0038395 |
| 24 | 1/2"-13 Gr5 Z Hex Nut | JM0002124 |
| 25 | 1/2"-13 x 1" Gr5 Z Hex Bolt | JM0010225 |
| 26 | 535 Talc Mounting Bracket Weldment | JM0037641 |